

#4-40 UNC TAP x .25 DP., 6 HOLES  
SP. AS SHOWN ON A Ø1.812 B.C.

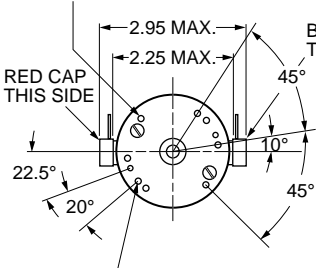

#2-56 UNC-2B TAP x .20 MIN. DP.,  
4 HOLES SPACED AS SHOWN  
ON A Ø1.812 B.C.

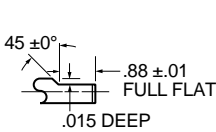
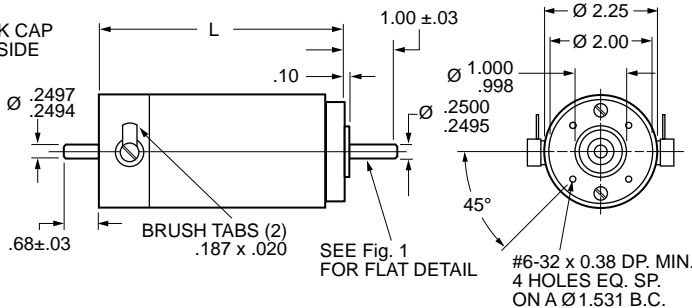

Fig. 1

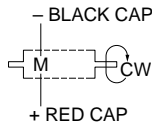
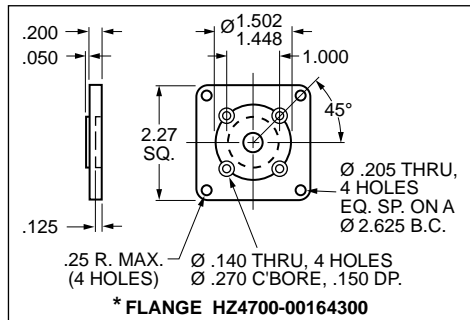

Fig. 2

**CATALOG NUMBER DESIGNATION:**

D 5 0 R 1 0 - [ ] [ ] [ ] [ ]

**Model Code: 0242, 0243**



SPECIFICATIONS	Units	Model Code	
		0242	0243
Continuous Stall Torque	oz. in.	50	55
Peak Stall Torque	oz. in.	300	400
Max. Terminal Voltage	V	60	60
Max. Operating Speed	rpm	6000	3100
L, Length	in.	5.51	5.50

**Winding Data**

Torque Constant ± 10%	oz. in. / Amp	11.76	26
Voltage Constant ± 10%	V / krpm	8.71	17.5
Resistance ± 15%	Ohms	1.30	5
Electrical Time Constant	mS	2.3	3.1
Mechanical Time Constant	mS	9.0	7.5
Max. Continuous Current	A	4.2	2.2
Max. Pulse Current	A	31	17.8
Armature Inductance	mH	1.8	15.1

**Mechanical Data**

Rotor Inertia	oz. in. sec. <sup>2</sup>	.0055	.008
Damping Constant	oz. in. / krpm	.4	.25
Thermal Resistance	°C / watt	4.2	4
Max. Armature Temperature	°C	155	155
Max. Friction Torque	oz. in.	4	3
Max. Radial Load (1" from Bearing)	lb.	10	10
Weight	lb.	3	3.5

\*Flange must be ordered separately when motors are used with NEMA gearheads.



### ■ WITH BRAKE

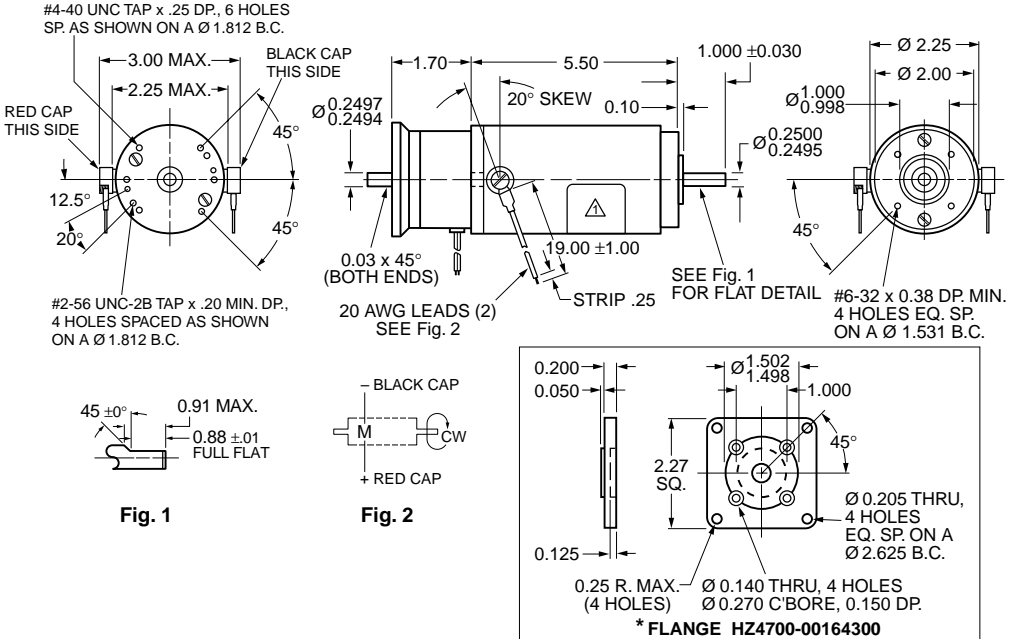

SPECIFICATIONS	Units	Catalog Number
		D50R11-0243
Continuous Stall Torque	oz. in.	55
Peak Stall Torque	oz. in.	400
Max. Terminal Voltage	V	60
Max. Operating Speed	rpm	3100

### Winding Data

Torque Constant ± 10%	oz. in. / Amp	26
Voltage Constant ± 10%	V / krpm	17.5
Resistance ± 15%	Ohms	5
Electrical Time Constant	mS	3.1
Mechanical Time Constant	mS	7.5
Max. Continuous Current	A	2.2
Max. Pulse Current	A	17.8
Armature Inductance	mH	15.1

### Mechanical Data

Rotor Inertia	oz. in. sec. <sup>2</sup>	.008
Damping Constant	oz. in. / krpm	.25
Thermal Resistance	°C / watt	4
Max. Armature Temperature	°C	155
Max. Friction Torque	oz. in.	3
Max. Radial Load (1" from Bearing)	lb.	10
Weight	lb.	3.5

\* Flange must be ordered separately when motors are used with NEMA gearheads.

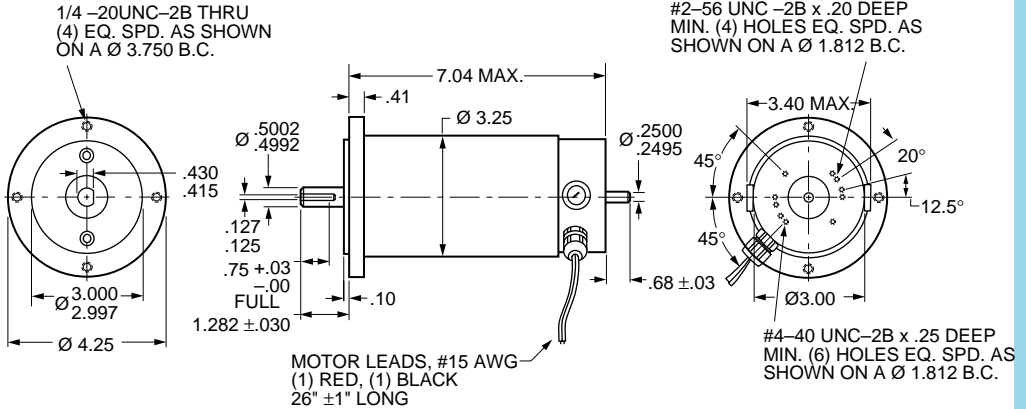

CATALOG NUMBER	D50R10-067
SPECIFICATIONS	
Continuous Stall Torque	170 oz. in.
Peak Stall Torque	850 oz. in.
Max. Terminal Voltage	90 V
Max. Operating Speed	4800 rpm
L, Length	6.52 in.

### Winding Data

Torque Constant ± 10%	25.24 oz. in. / Amp
Voltage Constant ± 10%	18.7 V / krpm
Resistance ± 15%	1 Ohm
Electrical Time Constant	3.4 mS
Mechanical Time Constant	13.5 mS
Max. Continuous Current	6.4 A
Max. Pulse Current	38 A
Armature Inductance	2.4 mH

### Mechanical Data

Rotor Inertia	.049 oz. in. sec. <sup>2</sup>
Damping Constant	.8 oz. in. / krpm
Thermal Resistance	2.1 °C / watt
Max. Armature Temperature	155 °C
Max. Friction Torque	7 oz. in.
Max. Radial Load (1" from Bearing)	30 lb.
Weight	8.6 lb.

- NOTE:** 1. This motor requires a nonstandard pinion to mate with our size 34 gearhead. The correct pinion will be supplied if ordered with our gearhead.
2. **Rotation:** With positive voltage applied to the red lead, rotation will be clockwise as viewed from output shaft end.