



■ 12 VOLTS

■ FLAT ON SHAFT

■ 20 mm DIAMETER

**MOTOR SPECIFICATIONS:**

- Rated Voltage – 12V
- Rated Torque – 0.59 N • mm
- Rated Speed – 3500 rpm
- Rated Current – ≤ 60 mA
- No Load Speed – 4700 rpm
- No Load Current – ≤ 30 mA
- Rated Output – 0.21W
- Operating Temp. – -10°C to +60°C

For replacement gearheads, see **A 2G10M...**Series.

See **D33S20ME20...**Series for the same gearmotor with no flat on output shaft.

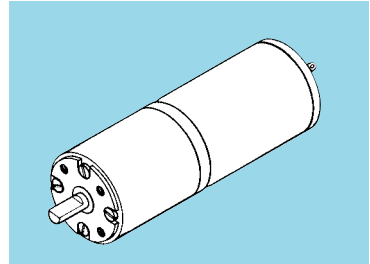

The projections shown are per ISO convention.

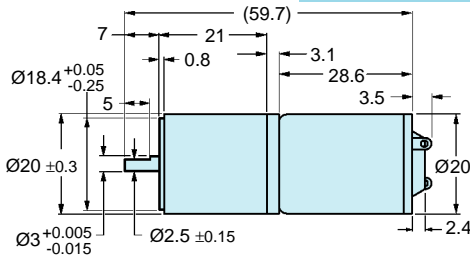

- MATERIAL:**
- Housing – Aluminum
  - Shafts – Steel
  - Gears – Steel
  - Bearings – Bronze

Catalog Number	Ratio to 1	Rated Torque N • mm (oz. in.)	Speed rpm	
			Rated	No Load
D33S57M20K0005	5		716	940
D33S57M20K0010	10	4.4 (0.6)	359	470
D33S57M20K0015	15		237	313
D33S57M20K0020	20	7.4 (1.1)	178	235
D33S57M20K0025	25		142	188
D33S57M20K0030	30	9.8 (1.4)	123	157
D33S57M20K0040	40		98	117
D33S57M20K0045	45	9.8 (1.4)	82	104
D33S57M20K0050	50		74	94
D33S57M20K0060	60	19.6 (2.8)	61	78
D33S57M20K0075	75		49	63
D33S57M20K0100	100		36	47
D33S57M20K0120	120	29.4 (4.2)	30	39
D33S57M20K0150	150		26	31

Continued on the next page

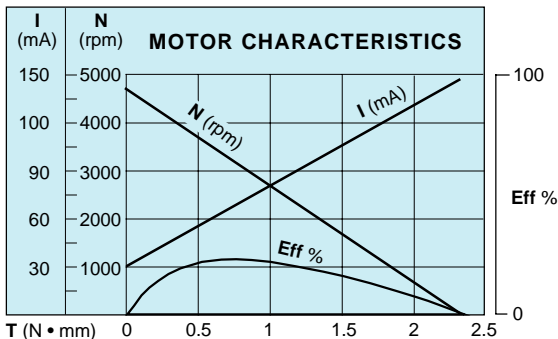



■ 12 VOLTS

■ FLAT ON SHAFT

■ 20 mm DIAMETER

**MOTOR SPECIFICATIONS:**

- Rated Voltage – 12V
- Rated Torque – 0.59 N • mm
- Rated Speed – 3500 rpm
- Rated Current – ≤ 60 mA
- No Load Speed – 4700 rpm
- No Load Current – ≤ 30 mA
- Rated Output – 0.21W
- Operating Temp. – -10°C to +60°C

For replacement gearheads, see **A 2G10M....Series**.

See **D33S20ME20...Series** for the same gearmotor with no flat on output end.

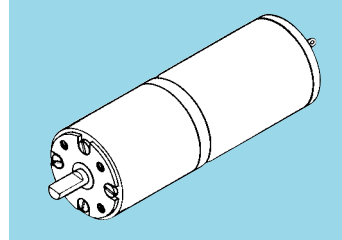

The projections shown are per ISO convention.

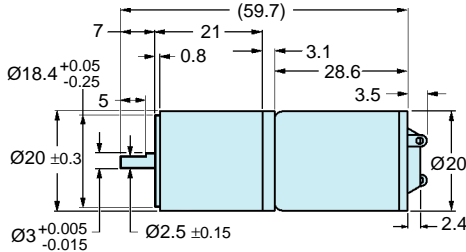

- MATERIAL:**
- Housing – Aluminum
  - Shafts – Steel
  - Gears – Steel
  - Bearings – Bronze

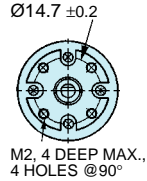

Catalog Number	Ratio to 1	Rated Torque N • mm (oz. in.)	Speed rpm	
			Rated	No Load
D33S57M20K0180	180	29.4 (4.2)	23	26
D33S57M20K0200	200		21	24
D33S57M20K0250	250	49 (6.9)	17	19
D33S57M20K0300	300		14	16
D33S57M20K0360	360	49 (6.9)	12	13
D33S57M20K0450	450		9.6	10.4
D33S57M20K0500	500	49 (6.9)	8.6	9.4
D33S57M20K0750	750		6	6.3
D33S57M20K1000	1000	49 (6.9)	4.5	4.7
D33S57M20K1500	1500		3	3.1
D33S57M20K1800	1800		2.5	2.6
D33S57M20K3000	3000	49 (6.9)	1.5	1.6
D33S57M20K4000	4000		1.12	1.17
D33S57M20K6000	6000		0.78	0.78

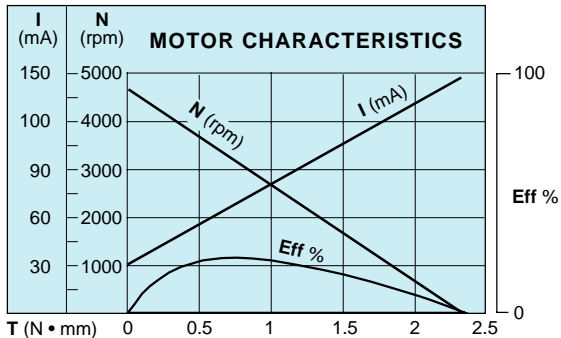



■ 12 VOLTS

■ ROUND SHAFT

■ 20 mm DIAMETER

**MOTOR SPECIFICATIONS:**

- Rated Voltage – 12V
- Rated Torque – 0.59 N · mm
- Rated Speed – 3500 rpm
- Rated Current – ≤ 60 mA
- No Load Speed – 4700 rpm
- No Load Current – ≤ 30 mA
- Rated Output – 0.21W
- Operating Temp. – -10°C to +60°C

For replacement gearheads, see **A 2G10M...** Series.

See **D33S57M20K...**Series for the same gearmotor with a flat on the output shaft.

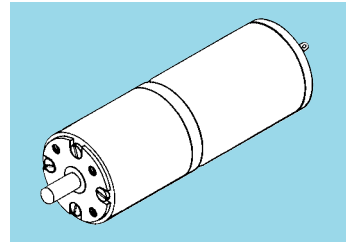

The projections shown are per ISO convention.

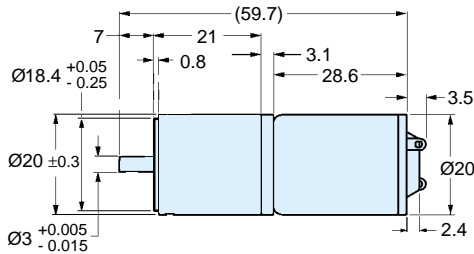

- MATERIAL:**
- Housing – Aluminum
  - Shafts – Steel
  - Gears – Steel
  - Bearings – Bronze

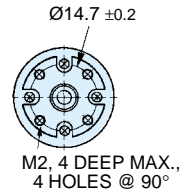

Catalog Number	Ratio to 1	Rated Torque N · mm (oz. in.)	Speed rpm	
			Rated	No Load
D33S20ME200005D	5	4.4 (0.6)	716	940
D33S20ME200010D	10		359	470
D33S20ME200015D	15	7.4 (1.1)	237	313
D33S20ME200020D	20		178	235
D33S20ME200025D	25	9.8 (1.4)	142	188
D33S20ME200030D	30		123	157
D33S20ME200040D	40	9.8 (1.4)	98	117
D33S20ME200045D	45		82	104
D33S20ME200050D	50	19.6 (2.8)	74	94
D33S20ME200060D	60		61	78
D33S20ME200075D	75	49	63	
D33S20ME200100D	100	29.4 (4.2)	36	47
D33S20ME200120D	120		30	39
D33S20ME200150D	150	26	31	

Continued on the next page

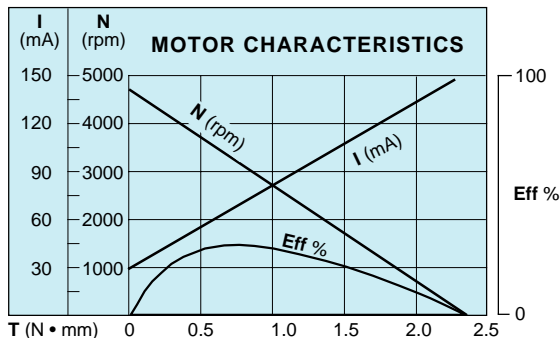



■ 12 VOLTS

■ ROUND SHAFT

■ 20 mm DIAMETER

**MOTOR SPECIFICATIONS:**

- Rated Voltage – 12V
- Rated Torque – 0.59 N · mm
- Rated Speed – 3500 rpm
- Rated Current – ≤ 60 mA
- No Load Speed – 4700 rpm
- No Load Current – ≤ 30 mA
- Rated Output – 0.21W
- Operating Temp. – -10°C to +60°C

For replacement gearheads, see **A 2G10M....** Series.

See **D33S57M20K...** Series for the same gearmotor with a flat on the output shaft.

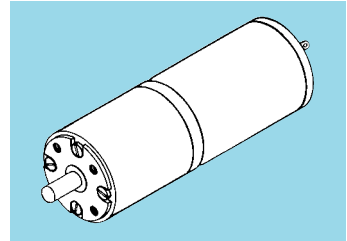

The projections shown are per ISO convention.

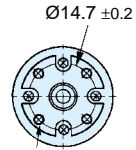
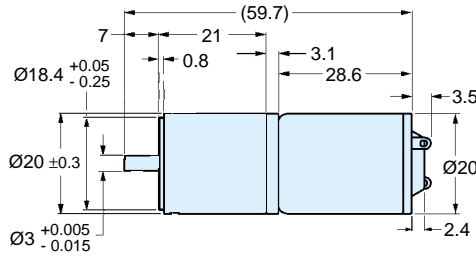

M2, 4 DEEP MAX., 4 HOLES @ 90°

**MATERIAL:**

- Housing – Aluminum
- Shafts – Steel
- Gears – Steel
- Bearings – Bronze

Catalog Number	Ratio to 1	Rated Torque N · mm (oz. in.)	Speed rpm	
			Rated	No Load
D33S20ME200180D	180	29.4 (4.2)	23	26
D33S20ME200200D	200		21	24
D33S20ME200250D	250	49 (6.9)	17	19
D33S20ME200300D	300		14	16
D33S20ME200360D	360	49 (6.9)	12	13
D33S20ME200450D	450		9.6	10.4
D33S20ME200500D	500	49 (6.9)	8.6	9.4
D33S20ME200750D	750		6	6.3
D33S20ME201000D	1000	49 (6.9)	4.5	4.7
D33S20ME201500D	1500		3	3.1
D33S20ME201800D	1800		2.5	2.6
D33S20ME203000D	3000	49 (6.9)	1.5	1.6
D33S20ME204000D	4000		1.12	1.17
D33S20ME206000D	6000		0.78	0.78

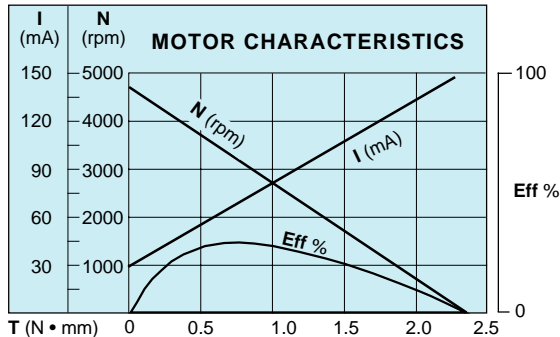



■ 12 VOLTS

■ ROUND SHAFT

■ 20 mm DIAMETER

### MOTOR SPECIFICATIONS:

- Rated Voltage – 12V
- Rated Torque – 1.47 N • mm
- Rated Speed – 5800 rpm
- Rated Current – ≤ 170 mA
- No Load Speed – 7400 rpm
- No Load Current – ≤ 65 mA
- Weight – 30 g
- Rated Output – 0.8W
- Operating Temp. – -10°C to +60°C

For replacement gearheads, see A 2G10M....Series.

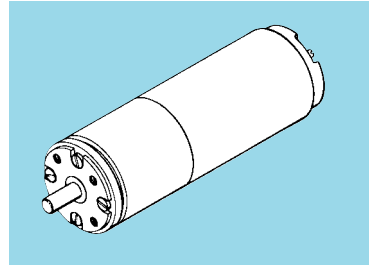

The projections shown are per ISO convention.

### MATERIAL:

- Housing – Aluminum
- Shafts – Steel
- Gears – Steel
- Bearings – Bronze

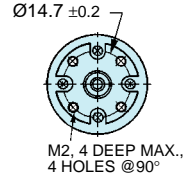
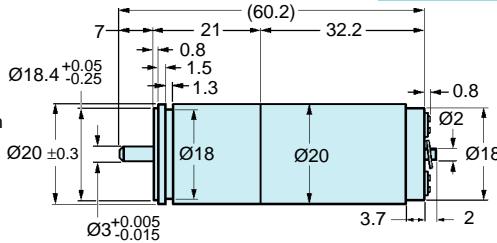

* Catalog Number	Ratio to 1	Rated Torque N • mm (oz. in.)	Speed rpm	
			Rated	No Load
D33S57M68K0005	5	9.8 (1.4)	1164	1480
D33S57M68K0010	10		608	740
D33S57M68K0015	15	9.8 (1.4)	422	493
D33S57M68K0020	20		330	370
D33S57M68K0025	25	14.7 (2.1)	257	296
D33S57M68K0030	30		220	247
D33S57M68K0040	40	14.7 (2.1)	170	185
D33S57M68K0045	45		152	164
D33S57M68K0050	50	19.6 (2.8)	135	148
D33S57M68K0060	60		114	123
D33S57M68K0075	75		93	98
D33S57M68K0100	100	29.4 (4.2)	68	74
D33S57M68K0120	120		57	62
D33S57M68K0150	150		47	49

\* Will be discontinued when present stock is depleted.

Continued on the next page

Same gearhead with different motor is offered as D33S57M20K...series. See index.

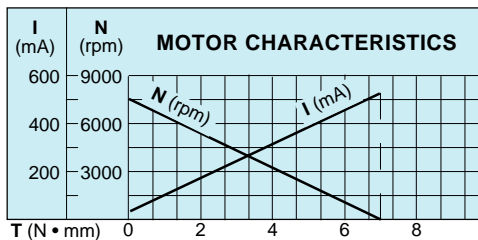



# METRIC

## Heavy-Duty D.C. Gearmotors - Size 20

■ 12 VOLTS

■ 20 mm DIAMETER

### MOTOR SPECIFICATIONS:

- Rated Voltage – 12V
- Rated Torque – 1.47 N • mm
- Rated Speed – 5800 rpm
- Rated Current –  $\leq 170$  mA
- No Load Speed – 7400 rpm
- No Load Current –  $\leq 65$  mA
- Weight – 30 g
- Rated Output – 0.8W
- Operating Temp. –  $-10^{\circ}\text{C}$  to  $+60^{\circ}\text{C}$

For replacement gearheads, see A 2G10M....Series.

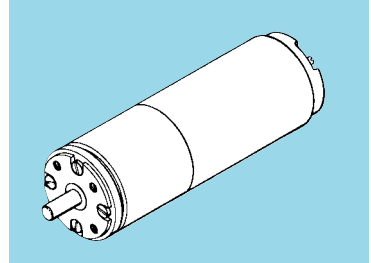

The projections shown are per ISO convention.

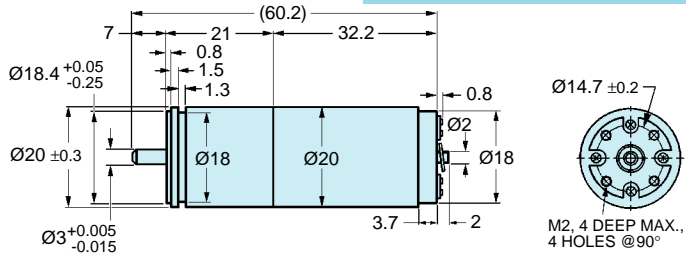

- MATERIAL:**
- Housing – Aluminum
  - Shafts – Steel
  - Gears – Steel
  - Bearings – Bronze

*Catalog Number	Ratio to 1	Rated Torque N • mm (oz. in.)	Speed rpm	
			Rated	No Load
D33S57M68K0180	180	29.4 (4.2)	39	41
D33S57M68K0200	200		35	37
D33S57M68K0250	250		29	30
D33S57M68K0300	300	49 (6.9)	24	25
D33S57M68K0360	360		19	20
D33S57M68K0450	450	49 (6.9)	16	16.4
D33S57M68K0500	500		14	14.4
D33S57M68K0750	750	49 (6.9)	9	9.8
D33S57M68K1000	1000		7.3	7.4
D33S57M68K1500	1500	49 (6.9)	4.88	4.93
D33S57M68K1800	1800		4.07	4.11
D33S57M68K3000	3000	49 (6.9)	2.45	2.47
D33S57M68K4000	4000		1.84	1.85
D33S57M68K6000	6000		1.23	1.23

\* Will be discontinued when present stock is depleted.

Same gearhead with different motor is offered as D33S57M20K...series. See index.

