



■ 6 VOLTS

■ 42 mm DIAMETER

MOTOR SPECIFICATIONS:

- Rated Voltage – 6V
- Rated Torque – 0.98 N • mm
- Rated Speed – 1250 rpm
- Rated Current – ≤ 60 mA
- No Load Speed – 2000 rpm
- No Load Current – ≤ 20 mA
- Weight – 70 g
- Rated Output – 1.25W
- Operating Temperature – -10°C to +60°C

For replacement gearheads, see A 2G15M... Series.

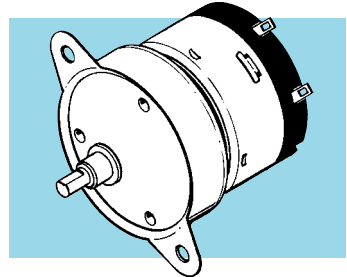

The projections shown are per ISO convention.

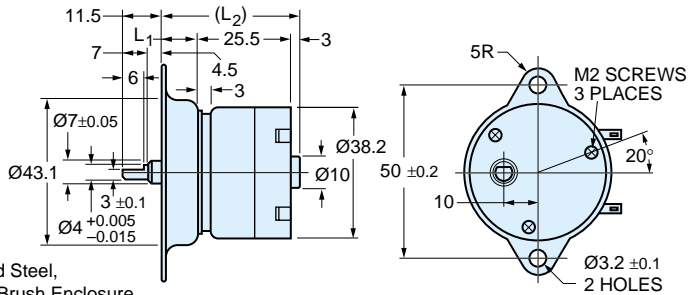

MATERIAL:

Housing – Stamped Steel,
Molded Brush Enclosure

Finish – Zinc Chromate

Catalog Number	Ratio to 1	L ₁	L ₂	Rated Torque N • mm (oz. in.)	Speed rpm	
					Rated	No Load
A 3Z15M00400C	400	11.3	39.8	78.5 (11.1)	4.4	5
A 3Z15M00500C	500	11.3	39.8	98.1 (13.9)	3.5	4
A 3Z15M00750C	750				2.5	2.7
A 3Z15M01000C	1000				1.9	2
A 3Z15M01500C	1500	11.3	39.8	98.1 (13.9)	1.2	1.3
A 3Z15M02000C	2000				1	1
A 3Z15M03000C	3000				0.65	0.67
* A 3Z15M07500C	7500	14.4	42.9	98.1 (13.9)	0.25	0.27
* A 3Z15M15000C	15000				0.13	0.13
* A 3Z15M30000C	30000				0.07	0.07

* To be discontinued when present stock is depleted.

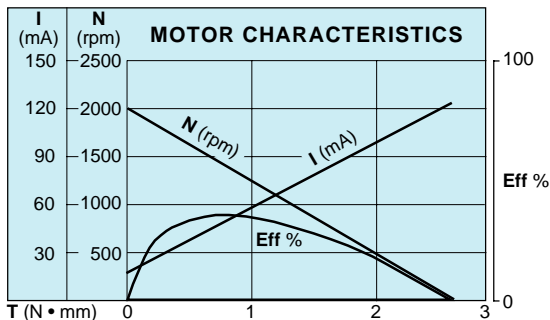



■ 12 VOLTS

■ 42 mm DIAMETER

MOTOR SPECIFICATIONS:

- Rated Voltage – 12V
- Rated Torque – 0.98 N • mm
- Rated Speed – 1200 rpm
- Rated Current – ≤ 39 mA
- No Load Speed – 2000 rpm
- No Load Current – ≤ 15 mA
- Weight – 60 g
- Rated Output – 1.20W
- Gearmotor Weight – 105 g
- Operating Temp. – -10°C to +60°C

For replacement gearheads, see A 2G15M... Series.

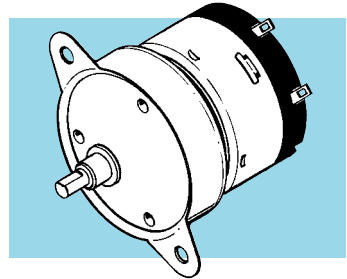

The projections shown are per ISO convention.

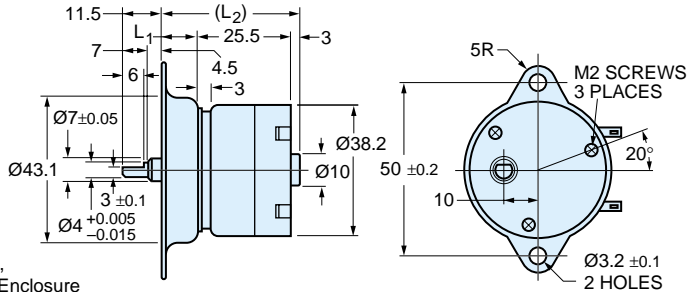

MATERIAL:

Housing – Stamped Steel,
Molded Brush Enclosure

Finish – Zinc Chromate

Catalog Number	Ratio to 1	L ₁	L ₂	Rated Torque N • mm (oz. in.)	Speed rpm	
					Rated	No Load
A 3Z15M00010D	10			7.8 (1.1)	121	200
A 3Z15M00020D	20	11.3	39.8	9.8 (1.4)	75	100
A 3Z15M00030D	30			19.6 (2.8)	45	67
A 3Z15M00050D	50	11.3	39.8	34.3 (4.9)	25	40
A 3Z15M00060D	60			39.2 (5.6)	21	33
A 3Z15M00100D	100	11.3	39.8	58.8 (8.3)	13	20
A 3Z15M00150D	150				10	13.3
A 3Z15M00200D	200				7.6	10
* A 3Z15M00250D	250	11.3	39.8	78.5 (11.1)	6.3	8
A 3Z15M00300D	300				5.6	6.7

*To be discontinued when present stock is depleted.

Continued on the next page

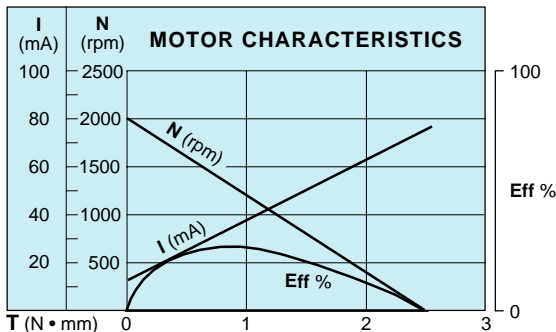



■ 24 VOLTS

■ 42 mm DIAMETER

MOTOR SPECIFICATIONS:

- Rated Voltage – 24V
- Rated Torque – 0.98 N • mm
- Rated Speed – 2500 rpm
- Rated Current – ≤ 26 mA
- No Load Speed – 3000 rpm
- No Load Current – ≤ 10 mA
- Weight – 60 g
- Rated Output – 2.5W
- Gearmotor Weight – 105 g
- Operating Temp. – -10°C to $+60^{\circ}\text{C}$

For replacement gearheads, see **A 2G15M...** Series.

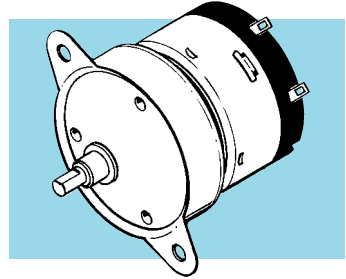

The projections shown are per ISO convention.

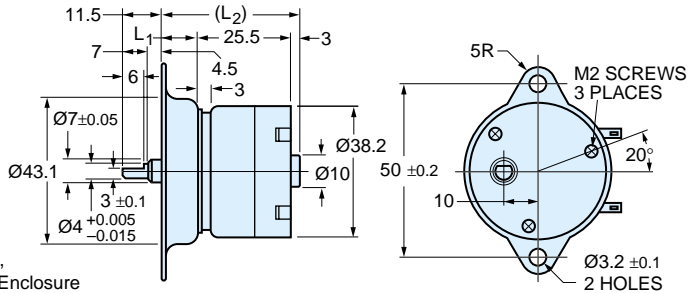

MATERIAL:

- Housing – Stamped Steel,
- Molded Brush Enclosure

Finish – Zinc Chromate

Catalog Number	Ratio to 1	L ₁	L ₂	Rated Torque N • mm (oz. in.)	Speed rpm	
					Rated	No Load
A 3Z15M00400E	400	11.3	39.8	78.5 (11.1)	7.1	7.5
A 3Z15M00500E	500	11.3	39.8	98.1 (13.9)	5.7	6
A 3Z15M00750E	750				3.9	4
A 3Z15M01000E	1000	11.3	39.8	98.1 (13.9)	2.9	3
A 3Z15M01500E	1500				1.9	2
A 3Z15M02000E	2000	11.3	39.8	98.1 (13.9)	1.48	1.5
A 3Z15M03000E	3000				0.99	1
* A 3Z15M07500E	7500	14.4	42.9	98.1 (13.9)	0.4	0.4
* A 3Z15M15000E	15000				0.2	0.2
* A 3Z15M30000E	30000				0.1	0.1

* To be discontinued when present stock is depleted.

