



■ 12 VOLTS

■ 43 mm SQUARE HOUSING

MOTOR SPECIFICATIONS:

- Rated Voltage – 12V
- Rated Torque – 9.81 N • mm
- Rated Speed – 3750 rpm
- Rated Current – ≤ 650 mA
- No Load Speed – 4850 rpm
- No Load Current – ≤ 91 mA
- Weight – 100 g
- Rated Output – 3.75W
- Operating Temperature – -10°C to +60°C

For replacement gearheads, see A 2G32ME.... Series.

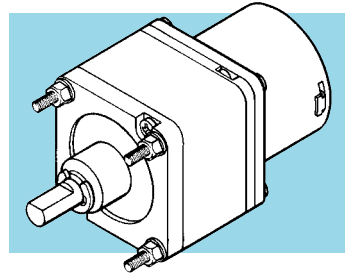

The projections shown are per ISO convention.

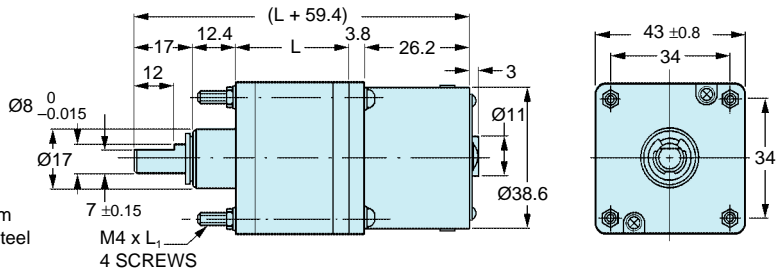

MATERIAL:

- Housing – Aluminum
- Shafts & Gears – Steel
- Bearings – Bronze

Catalog Number	Ratio to 1	L	L ₁ Screw Length	Rated Torque N • m (lb. in.)	Speed rpm	
					Rated	No Load
D33S43ME380014D	14	25.9	45	0.088 (0.78)	254	331
D33S43ME380017D	17.4			0.11 (0.95)	206	268
D33S43ME380024D	24			0.15 (1.3)	150	193
D33S43ME380049D	49	32.7	45	0.25 (2.2)	73	94
D33S43ME380061D	60.7			0.31 (2.8)	58	76
D33S43ME380084D	84			0.44 (3.9)	42	55
D33S43ME380104D	104	32.7	45	0.54 (4.8)	34	45
D33S43ME380144D	144			0.74 (6.5)	25	32
D33S43ME380212D	212.3			0.89 (7.9)	17	22
D33S43ME380294D	294	39.4	55	1.24 (10.9)	12	16
D33S43ME380504D	504			1.96 (17.4)	7	9
D33S43ME380624D	624			1.96 (17.4)	6	7
D33S43ME380864D	864			1.96 (17.4)	5	5

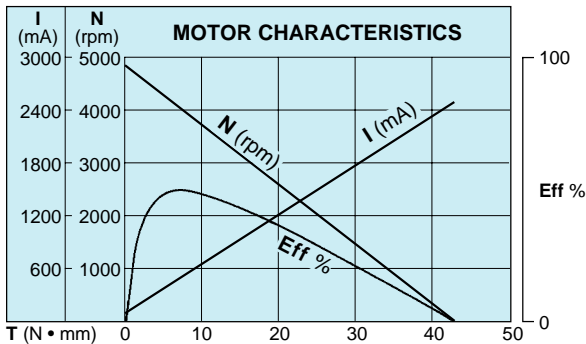



■ 12 VOLTS

■ 43 mm SQUARE HOUSING

MOTOR SPECIFICATIONS:

- Rated Voltage – 12V
- Rated Torque – 14.72 N • mm
- Rated Speed – 2560 rpm
- Rated Current – ≤ 520 mA
- No Load Speed – 3310 rpm
- No Load Current – ≤ 30 mA
- Weight – 240 g
- Rated Output – 3.84W
- Operating Temperature – -10°C to +60°C

For replacement gearheads, see A 2G32ME... Series.

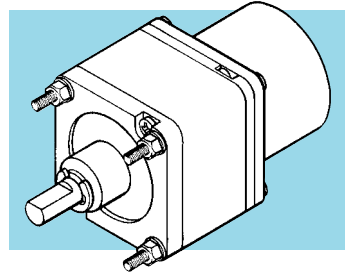

The projections shown are per ISO convention.

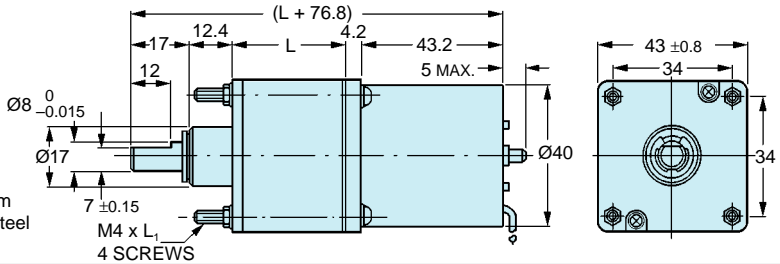

Catalog Number	Ratio to 1	L	L ₁ Screw Length	Rated Torque N • m (lb. in.)	Speed rpm	
					Rated	No Load
D33S43MFST0014D	14	25.9	45	0.128 (1.13)	179	229
D33S43MFST0017D	17.4			0.17 (1.5)	143	186
D33S43MFST0024D	24			0.23 (2)	103	134
D33S43MFST0049D	49	32.7	45	0.37 (3.3)	51	66
D33S43MFST0061D	60.7			0.47 (4.2)	41	53
D33S43MFST0084D	84			0.65 (5.7)	29	38
D33S43MFST0104D	104	32.7	45	0.80 (7.1)	24	31
D33S43MFST0144D	144			1.12 (9.9)	17	22
D33S43MFST0212D	212.3			39.4	55	1.33 (11.8)
D33S43MFST0294D	294	39.4	55	1.85 (16.4)	8	11
D33S43MFST0504D	504			1.96 (17.4)	5	6
D33S43MFST0624D	624			1.96 (17.4)	5	5
D33S43MFST0864D	864			1.96 (17.4)	3	4

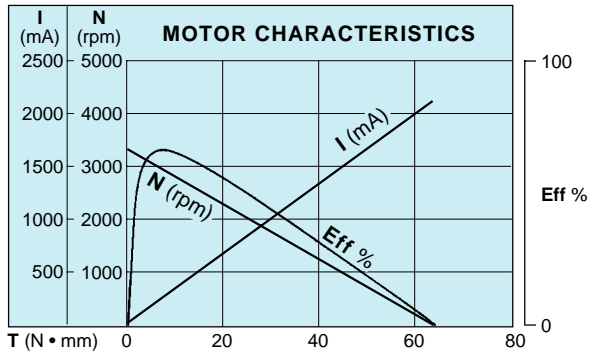



■ 24 VOLTS

■ 43 mm SQUARE HOUSING

MOTOR SPECIFICATIONS:

- Rated Voltage – 24V
- Rated Torque – 9.81 N • mm
- Rated Speed – 3590 rpm
- Rated Current – ≤ 319 mA
- No Load Speed – 4650 rpm
- No Load Current – ≤ 50 mA
- Weight – 100 g
- Rated Output – 3.59W
- Operating Temperature – -10°C to $+60^{\circ}\text{C}$

For replacement gearheads, see **A 2G32ME...** Series.

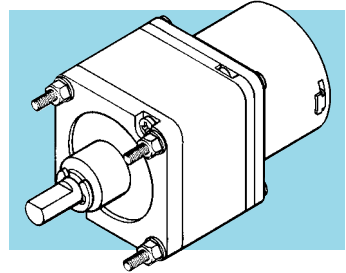

The projections shown are per ISO convention.

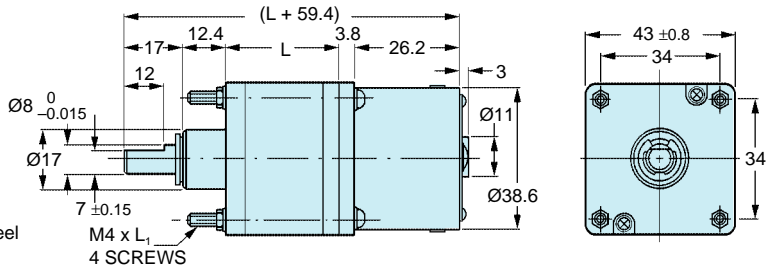

MATERIAL:

- Housing – Aluminum
- Shafts & Gears – Steel
- Bearings – Bronze

Catalog Number	Ratio to 1	L	L ₁ Screw Length	Rated Torque N • m (lb. in.)	Speed rpm	
					Rated	No Load
D33S43ME380014E	14	25.9	45	0.088 (0.78)	243	317
D33S43ME380017E	17.4			0.11 (0.95)	198	257
D33S43ME380024E	24			0.15 (1.3)	143	185
D33S43ME380049E	49	32.7	45	0.25 (2.2)	70	91
D33S43ME380061E	60.7			0.31 (2.8)	56	73
D33S43ME380084E	84			0.44 (3.9)	40	53
D33S43ME380104E	104	32.7	45	0.54 (4.8)	33	43
D33S43ME380144E	144			0.74 (6.5)	23	31
D33S43ME380213E	212.3			0.89 (7.9)	16	21
D33S43ME380294E	294	39.4	55	1.24 (10.9)	12	15
D33S43ME380504E	504			1.96 (17.4)	7	9
D33S43ME380624E	624			1.96 (17.4)	6	7
D33S43ME380864E	864			1.96 (17.4)	4	5

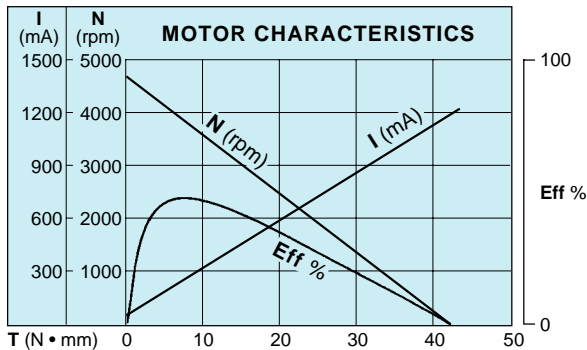



METRIC

Heavy-Duty D.C. Gearmotors - Size 43

■ 24 VOLTS

■ 43 mm SQUARE HOUSING

MOTOR SPECIFICATIONS:

- Rated Voltage – 24V
- Rated Torque – 14.72 N • mm
- Rated Speed – 2560 rpm
- Rated Current – ≤ 265 mA
- No Load Speed – 3310 rpm
- No Load Current – ≤ 30 mA
- Weight – 240 g
- Rated Output – 3.84W
- Operating Temperature – -10°C to +60°C

For replacement gearheads, see A 2G32ME... Series.

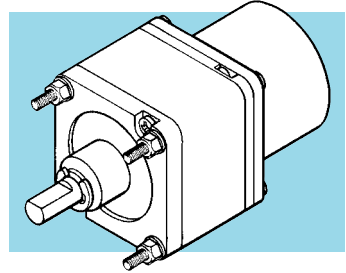

The projections shown are per ISO convention.

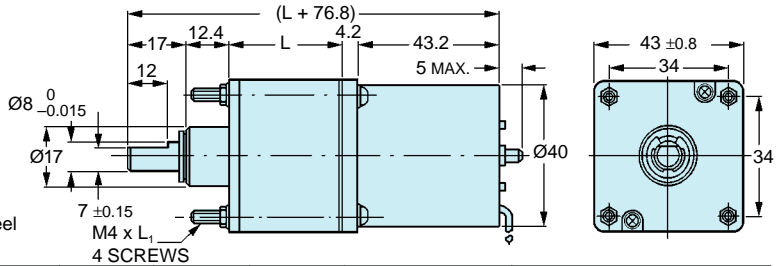

MATERIAL:

- Housing – Aluminum
- Shafts & Gears – Steel
- Bearings – Bronze

Catalog Number	Ratio to 1	L	L ₁ Screw Length	Rated Torque N • m (lb. in.)	Speed rpm	
					Rated	No Load
D33S43MFST0014E	14	25.9	45	0.128 (1.13)	179	229
D33S43MFST0017E	17.4			0.17 (1.5)	143	186
D33S43MFST0024E	24			0.23 (2)	103	134
D33S43MFST0049E	49	32.7	45	0.37 (3.3)	51	66
D33S43MFST0061E	60.7			0.47 (4.2)	41	53
D33S43MFST0084E	84			0.65 (5.7)	29	38
D33S43MFST0104E	104	32.7	45	0.80 (7.1)	24	31
D33S43MFST0144E	144			1.12 (9.9)	17	22
D33S43MFST0212E	212.3			1.33 (11.8)	12	15
D33S43MFST0294E	294	39.4	55	1.85 (16.4)	8	11
D33S43MFST0504E	504			1.96 (17.4)	5	6
D33S43MFST0624E	624			1.96 (17.4)	5	5
D33S43MFST0864E	864			1.96 (17.4)	3	4

