

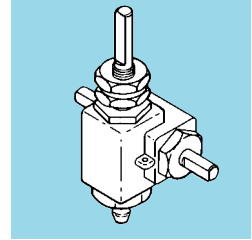

INCH

Right Angle Helical Gear Speed Reducers

- RATED SPEEDS UP TO 1800 RPM ■ PANEL-MOUNTED ■ LIGHT-DUTY ■ MULTIPLE RATIOS

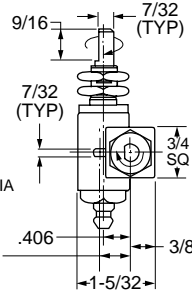
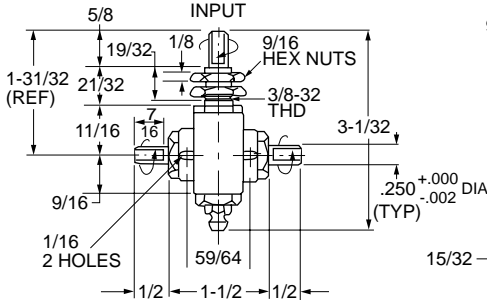

3DR SERIES

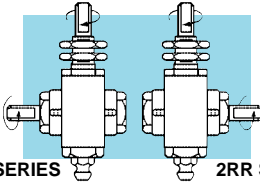

2SR SERIES

2RR SERIES

Output Power @ 1800 rpm Input

Duty	From 1:1 to 5:1 Ratio	From 10:1 to 25:1 Ratio
Intermittent	1/8 HP	1/12 HP
Continuous	1/5 HP	1/20 HP

For mounting pin location dimensions, see diagram on page 5-10.

MATERIAL:

Housing and Base – Aluminum Alloy, Black Anodized

Gears – Hardened Steel Helical

Shafts – Steel, Plated

BACKLASH:

3° Nominal

8° Including End Play

WEIGHT: Approx. 4 oz.

Catalog Number	Shaft Extension	Gear Ratio	Torque Capacity lb. in.		
			Ultimate Static	Manual	Dynamic
A 2Z23-3DR0108	Left & Right	1:1	35	28	4.2
A 2Z23-2SR0108	Left				
A 2Z23-2RR0108	Right				
A 2Z23-3DR0208	Left & Right	2:1			
A 2Z23-2SR0208	Left				
A 2Z23-2RR0208	Right				
A 2Z23-3DR0308	Left & Right	3:1			
A 2Z23-2SR0308	Left				
A 2Z23-2RR0308	Right				
A 2Z23-3DR0408	Left & Right	4:1			
A 2Z23-2SR0408	Left				
A 2Z23-2RR0408	Right				
A 2Z23-3DR0508	Left & Right	5:1			
A 2Z23-2SR0508	Left				
A 2Z23-2RR0508	Right				
A 2Z23-3DR1008	Left & Right	10:1	25	20	3
A 2Z23-2SR1008	Left				
A 2Z23-2RR1008	Right				
A 2Z23-3DR1508	Left & Right	15:1			
A 2Z23-2SR1508	Left				
A 2Z23-2RR1508	Right				
*A 2Z23-3DR2508	Left & Right	25:1			
*A 2Z23-2SR2508	Left				
*A 2Z23-2RR2508	Right				

NOTE: For 1:1 ratio, any shaft may be used as input.

*Only available on special order.



METRIC

Right Angle Helical Gear Speed Reducers

- RATED SPEEDS UP TO 1800 RPM
- PANEL-MOUNTED
- LIGHT-DUTY
- MULTIPLE RATIOS

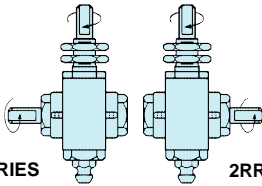
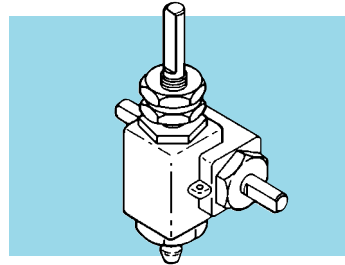
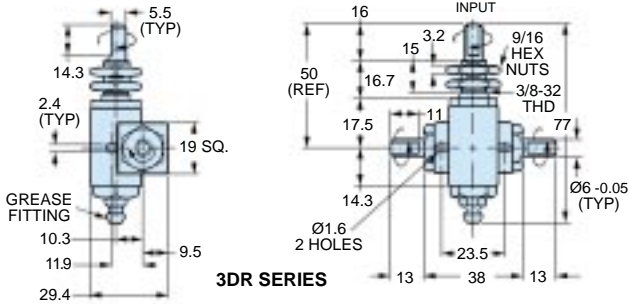

2SR SERIES

2RR SERIES

The projections shown are per ISO convention.

Output Power @ 1800 rpm Input		
Duty	From 1:1 to 5:1 Ratio	From 10:1 to 25:1 Ratio
Intermittent	93W (1/8 HP)	62W (1/12 HP)
Continuous	50W (1/15 HP)	37W (1/20 HP)

For mounting pin location dimensions, see diagram on page 5-9.

MATERIAL:

Housing and Base – Aluminum Alloy, Black Anodized
Gears – Hardened Steel Helical
Shafts – Steel-Plated

BACKLASH:

3° Nominal
 8° Including End Play
WEIGHT: Approx. 113 grams

Catalog Number	Shaft Extension	Gear Ratio	Torque Capacity N • m					
			Ultimate Static	Manual	Dynamic			
A 2Z23M3DR0106 A 2Z23M2SR0106 A 2Z23M2RR0106	Left & Right Left Right	1:1	4	3.2	0.5			
A 2Z23M3DR0206 A 2Z23M2SR0206 A 2Z23M2RR0206	Left & Right Left Right	2:1						
A 2Z23M3DR0306 A 2Z23M2SR0306 A 2Z23M2RR0306	Left & Right Left Right	3:1						
A 2Z23M3DR0406 A 2Z23M2SR0406 A 2Z23M2RR0406	Left & Right Left Right	4:1						
A 2Z23M3DR0506 A 2Z23M2SR0506 A 2Z23M2RR0506	Left & Right Left Right	5:1						
A 2Z23M3DR1006 A 2Z23M2SR1006 A 2Z23M2RR1006	Left & Right Left Right	10:1				2.8	2.3	0.35
A 2Z23M3DR1506 A 2Z23M2SR1506 A 2Z23M2RR1506	Left & Right Left Right	15:1						
Δ A 2Z23M3DR2506 Δ A 2Z23M2SR2506 Δ A 2Z23M2RR2506	Left & Right Left Right	25:1						

NOTE: For 1:1 ratio, any shaft may be used as input.
 Δ Only available on special order.



INCH

Right Angle Helical Gear Speed Reducers

- RATED SPEEDS UP TO 1800 RPM
■ BASE-MOUNTED
■ LIGHT-DUTY
■ MULTIPLE RATIOS

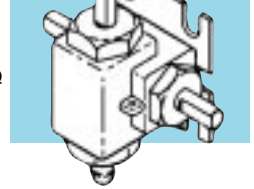
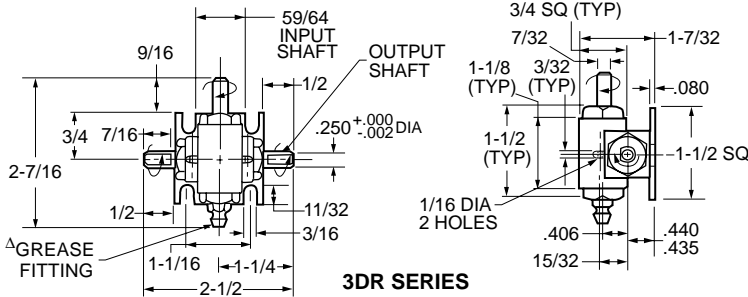

^ΔNOTE: Shaft extension may be provided here in lieu of grease fitting (special item).

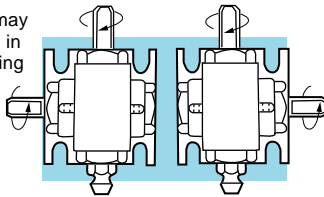

Output Power @ 1800 rpm Input		
Duty	From 1:1 to 5:1 Ratio	From 10:1 to 25:1 Ratio
Intermittent	1/8 HP	1/12 HP
Continuous	1/5 HP	1/20 HP

For mounting pin location dimensions, see diagram on page 5-10.

MATERIAL:

- Housing and Base** – Aluminum Alloy, Black Anodized
- Gears** – Hardened Steel Helical
- Shafts** – Steel, Plated

BACKLASH:

- 3° Nominal
- 8° Including End Play
- WEIGHT:** Approx. 4 oz.

Catalog Number	Shaft Extension	Gear Ratio	Torque Capacity lb. in.		
			Ultimate Static	Manual	Dynamic
A 2Z22-3DR0108	Left & Right	1:1	35	28	4.2
A 2Z22-2SR0108	Left				
A 2Z22-2RR0108	Right				
A 2Z22-3DR0208	Left & Right	2:1			
A 2Z22-2SR0208	Left				
A 2Z22-2RR0208	Right				
A 2Z22-3DR0308	Left & Right	3:1			
A 2Z22-2SR0308	Left				
A 2Z22-2RR0308	Right				
A 2Z22-3DR0408	Left & Right	4:1			
A 2Z22-2SR0408	Left				
A 2Z22-2RR0408	Right				
A 2Z22-3DR0508	Left & Right	5:1			
A 2Z22-2SR0508	Left				
A 2Z22-2RR0508	Right				
A 2Z22-3DR1008	Left & Right	10:1	25	20	3
A 2Z22-2SR1008	Left				
A 2Z22-2RR1008	Right				
A 2Z22-3DR1508	Left & Right	15:1			
A 2Z22-2SR1508	Left				
A 2Z22-2RR1508	Right				
*A 2Z22-3DR2508	Left & Right	25:1			
*A 2Z22-2SR2508	Left				
*A 2Z22-2RR2508	Right				

NOTE: For 1:1 ratio, any shaft may be used as input.
 *Only available on special order.



- RATED SPEEDS UP TO 1800 RPM ■ BASE-MOUNTED ■ LIGHT-DUTY ■ MULTIPLE RATIOS

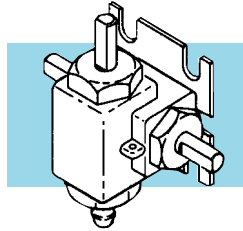
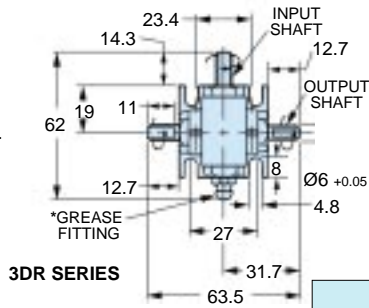
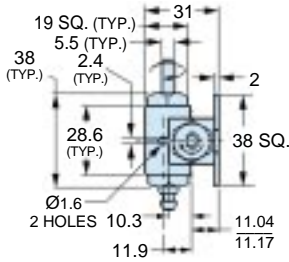

3DR SERIES

***NOTE:** Shaft extension may be provided here in lieu of grease fitting (special item).

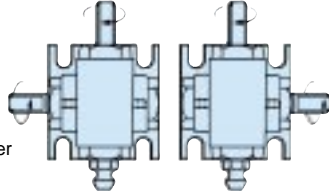

2SR SERIES

2RR SERIES

The projections shown are per ISO convention.

Output Power @ 1800 rpm Input		
Duty	From 1:1 to 5:1 Ratio	From 10:1 to 25:1 Ratio
Intermittent	93W (1/8 HP)	62W (1/12 HP)
Continuous	50W (1/15 HP)	37W (1/20 HP)

For mounting pin location dimensions, see diagram on page 5-9.

MATERIAL:
Housing and Base – Aluminum Alloy, Black Anodized
Gears – Hardened Steel Helical
Shafts – Steel-Plated

BACKLASH:
 3° Nominal
 8° Including End Play
WEIGHT: Approx. 113 grams

Catalog Number	Shaft Extension	Gear Ratio	Torque Capacity N • m		
			Ultimate Static	Manual	Dynamic
A 2Z22M3DR0106	Left & Right	1:1	4	3.2	0.5
A 2Z22M2SR0106	Left				
A 2Z22M2RR0106	Right				
A 2Z22M3DR0206	Left & Right	2:1			
A 2Z22M2SR0206	Left				
A 2Z22M2RR0206	Right				
A 2Z22M3DR0306	Left & Right	3:1			
A 2Z22M2SR0306	Left				
A 2Z22M2RR0306	Right				
A 2Z22M3DR0406	Left & Right	4:1			
A 2Z22M2SR0406	Left				
A 2Z22M2RR0406	Right				
A 2Z22M3DR0506	Left & Right	5:1			
A 2Z22M2SR0506	Left				
A 2Z22M2RR0506	Right				
A 2Z22M3DR1006	Left & Right	10:1	2.8	2.3	0.35
A 2Z22M2SR1006	Left				
A 2Z22M2RR1006	Right				
A 2Z22M3DR1506	Left & Right	15:1			
A 2Z22M2SR1506	Left				
A 2Z22M2RR1506	Right				
ΔA 2Z22M3DR2506	Left & Right	25:1			
ΔA 2Z22M2SR2506	Left				
ΔA 2Z22M2RR2506	Right				

NOTE: For 1:1 ratio, any shaft may be used as input.
 Δ Only available on special order.



INCH

Right Angle and Dual Helical Gear Drives

- 1:1 RATIO
- HEAVY-DUTY
- BALL BEARING
- RATED SPEEDS UP TO 1725 RPM

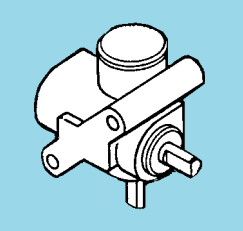
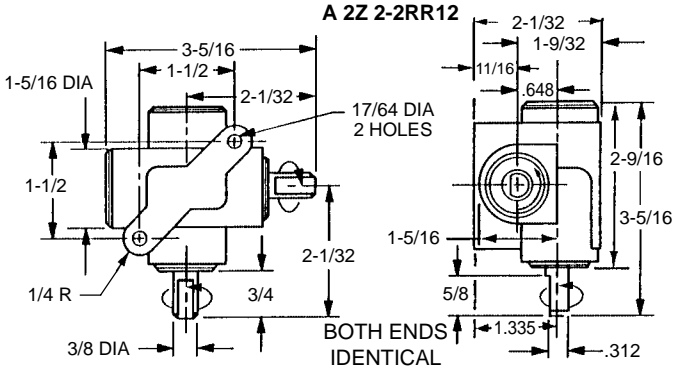

RIGHT ANGLE DRIVE

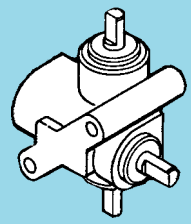

DUAL DRIVE

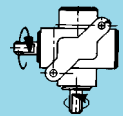

A 2Z 2-2SR12

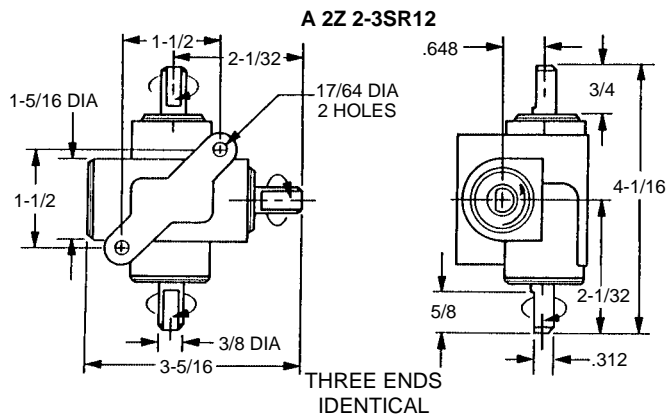

MATERIAL:

- Housing** – Aluminum Alloy
- Gears** – Alloy Steel, Helical
- Shafts** – Steel
- Bearings** – Steel Ball

BACKLASH: 3° Nominal

Catalog Number	Shaft Extension	Shaft Dia.	Gear Ratio	Torque Capacity lb. in.			Approx. Weight lb.
				Ultimate Static	Manual	Dynamic	
RIGHT ANGLE DRIVES							
A 2Z 2-2SR12	Left	3/8	1:1	150	75	15	1.2
A 2Z 2-2RR12	Right						
DUAL DRIVES							
A 2Z 2-3SR12	Left or Right	3/8	1:1	150	75	15	1.3

NOTE: Any shaft can be used as input.