

■ **WITHOUT BEARING**

■ **URETHANE SURFACE**

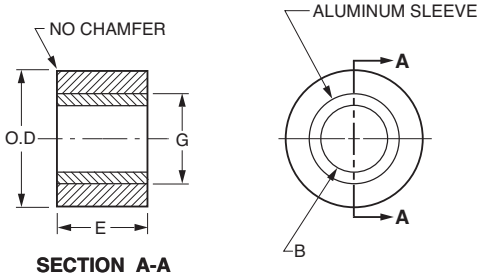
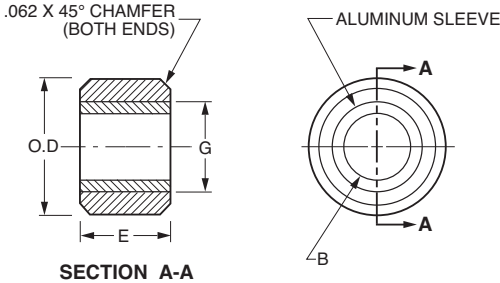

**Fig. 1 (WITHOUT CHAMFER)**



**Fig. 1**

**Fig. 2**



**Fig. 2 (WITH CHAMFER)**

**MATERIAL:** Roller – Urethane 60 Durometer  
Ground Outside Diameter  
Sleeve – Aluminum

Catalog Number	Fig.	O.D. ±.003	B Bore +.0005 -.0000	E Face Width ±.010	G Sleeve O.D.
A 7M 5-UR05025A	1	.500	.2500	.250	.344
A 7M 5-UR05025B				.718	
A 7M 5-UR05025C				.500	
A 7M 5-UR06737	1	.672	.3750	.250	.500
A 7M 5-UR07537				.750	
A 7M 5-UR08137	2	.813	.3750	.500	.500
A 7M 5-UR09237	1	.922	.3750	.484	.688
A 7M 5-UR11237A				1.125	
A 7M 5-UR11237B	1	1.125	.3750	.438	.500
A 7M 5-UR19837				.688	
A 7M 5-UR19850A	1	1.988	.5000	.750	1.375
A 7M 5-UR19850B				1.000	

**NEW****SDPSI**

Metric Metric Metric Metric Metric

**Feed Rollers**

Stock Drive Products/Sterling Instrument

Phone: 516-328-3300

Fax: 516-326-8827

■ WITHOUT BEARING

■ URETHANE SURFACE

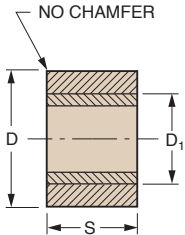
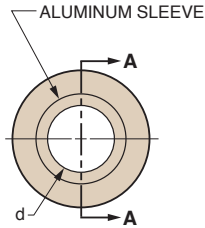
**SECTION A-A**

**MATERIAL:** Roller – Urethane 60 Durometer  
Ground Outside Diameter  
Sleeve – Aluminum

Catalog Number	D $\pm 0.075$	d Bore $+0.013$	S Face Width $\pm 0.25$	D <sub>i</sub> Sleeve O.D.	
A 7M 5MUR1206A	12	6	6.35	8.74	
A 7M 5MUR1206B			18.2		
A 7M 5MUR1206C			12.7		
A 7M 5MUR1710	17	10	6.35	12.7	
A 7M 5MUR1910	19		12.7		
A 7M 5MUR2010	20		12.7		
A 7M 5MUR2310	23		12.3		17.47
A 7M 5MUR2810A	28		11.12		12.7
A 7M 5MUR2810B		17.47			
A 7M 5MUR5010	50	12	17.47	34.92	
A 7M 5MUR5012A	50		19.05	34.92	
A 7M 5MUR5012B			25.4		

**Feed Rollers**

■ **WITHOUT BEARING**

■ **URETHANE SURFACE**

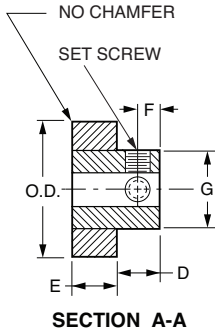

**Fig. 1**

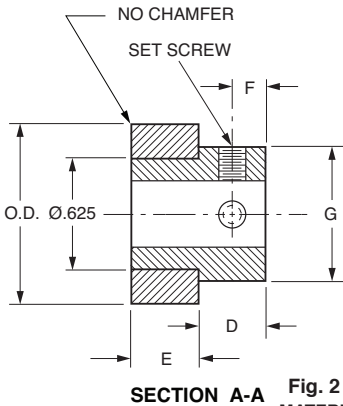
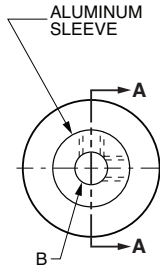

**Fig. 2**

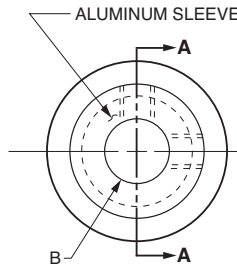

**MATERIAL:** Roller - Urethane 60 Durometer  
 Ground Outside Diameter  
 Sleeve - Aluminum

Catalog Number	Fig.	O.D. ± .003	B Bore + .0005 - .0000	E Face Width ± .010	D Hub Proj.	F	G Sleeve O.D.	Set Screw
A 7T 5-UR05618	1	.562	.1875	.250	.250	.125	.437	#4-40
A 7T 5-UR07518		.750						
A 7T 5-UR06225		.625						
A 7T 5-UR07525		.750						
A 7T 5-UR08725		.875						
A 7T 5-UR10037	2	1.000	.3750	.375	.375	.187	.750	#10-32
A 7T 5-UR12537	1	1.250	.3750	.375	.375	.187	.812	#10-32
A 7T 5-UR15037		1.500						
A 7T 5-UR15050		1.500						
A 7T 5-UR17550		1.750						
A 7T 5-UR20050		2.000						
			.5000	.500	.500	.250	1.250	1/4-20
							1.375	

**NOTE:** All feed rollers supplied with 2 set screws.

**NEW**



Metric Metric Metric Metric Metric

**Feed Rollers**

Stock Drive Products/Sterling Instrument ■ Phone: 516-328-3300 ■ Fax: 516-326-8827

■ WITHOUT BEARING

■ URETHANE SURFACE

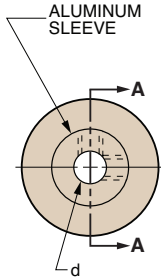
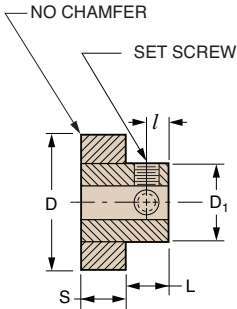

Fig. 1



**SECTION A-A**

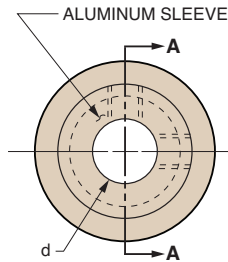
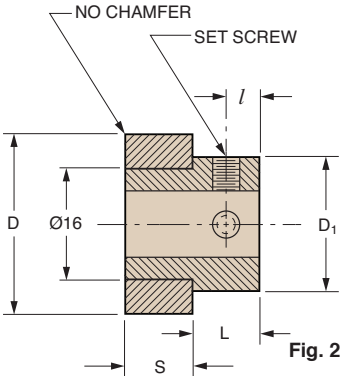

Fig. 2

**SECTION A-A**

**MATERIAL:** Roller - Urethane 60 Durometer  
Ground Outside Diameter  
Sleeve - Aluminum

Catalog Number	Fig.	D ±0.075	d Bore +0.0127	S Face Width ± 0.25	L Hub Proj.	l	D <sub>1</sub> Sleeve O.D.	Set Screw
A 7T 5MUR1405	1	14	5	6.35	6.35	3.17	11.1	M3
A 7T 5MUR1905		19						
A 7T 5MUR1606		16						
A 7T 5MUR1906		19						
A 7T 5MUR2206	2	22	10	9.52	9.52	4.76	19	M4
A 7T 5MUR2510		25						
A 7T 5MUR3210	1	32	10	9.52	9.52	4.76	20.62	M5
A 7T 5MUR3810		38					25.4	
A 7T 5MUR3812		38					25.4	
A 7T 5MUR4412		44					31.75	
A 7T 5MUR5012		50					34.9	

NOTE: All feed rollers supplied with 2 set screws.