

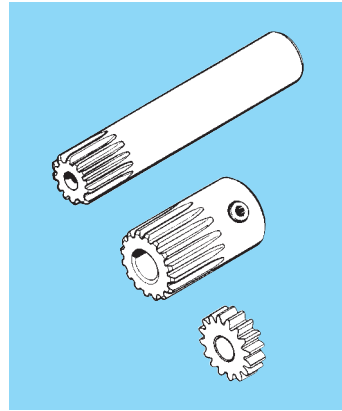

■ 20° PRESSURE ANGLE

■ BRASS

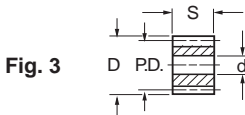
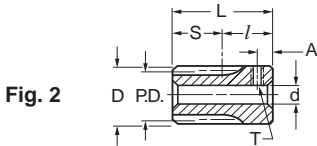
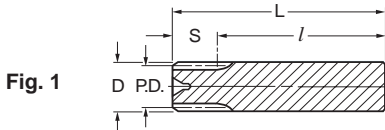

MATERIAL: Brass

Catalog Number	Module	Fig. No.	No. of Teeth	P.D.	D	d Bore H8	S Face Width	L Length	l	A	T Set Screw
◇ A 1B 8MYSH1012	0.15		12	1.905	2.205	1*	4	—	—	—	—
◇ A 1B 8MYSH1013			13	2.055	2.355	1*	2.5				
◇ A 1B 8MYSH1015			15	2.31	2.61	1.5*	3.2				
◇ A 1B 8MYS02010	0.2	3	10	2.24	2.64	1.2*	2	—	—	—	—
◇ A 1B 8MYS02014			14	2.9	3.3	2¶	2.8				
◇ A 1B 8MYS02020			20	4.1	4.5	2¶	2.8				
◇ A 1B 8MYSH2015	0.25		15	3.75	4.25	2¶	2.8	—	—	—	—
◇ A 1B 8MYS03010	0.3		10	3.15	3.75	2*	2				
◇ A 1B 8MYS04012	0.4		12	4.88	5.68	3**	4				
A 1B 8MYK05010	0.5	1	10	5	6	—	10	55	45	—	—
◇ A 1B 8MYS05010		3	10	5.24	6.24	2*	4	—	—	—	—
◇ A 1B 8MYS05012			12	6.2	7.2	4*	—	—	—	—	—
A 1B 8MYK05012	1	12	6	7	—	—	10	55	45	—	—
A 1B 8MYK05015	2		15	7.5	8.5§	3Δ	8	18	10	3	M3X0.5
A 1B 8MYK05016			16	8	9						
A 1B 8MYK05018			18	9	10						
A 1B 8MYKH7010	0.75	1	10	7.5	9	—	8	55	47	—	—
A 1B 8MYKH7012			12	9	10.5						
A 1B 8MYKH7015	2	15	11.25	12.75	5Δ	8	20	12	3	M3X0.5	
A 1B 8MYK08014	0.8	2	14	11.2	12.8	4Δ	7	20	13	3	M3X0.5
A 1B 8MYK08015			15	12	13.6						

◇ Suitable for use with speed reducers.

§ Hub end is 9mm O.D.

* Bore Tolerance: 1 & 1.5 mm +0.012, +0.004
1.2, 2 & 4 mm -0.02, -0.04

¶ Bore Tolerance: 2 mm -0.01, -0.03

** Bore Tolerance: 3 mm -0.014, -0.03

Δ Bore Tolerance: 3 mm +0.014
4 & 5 mm +0.018