

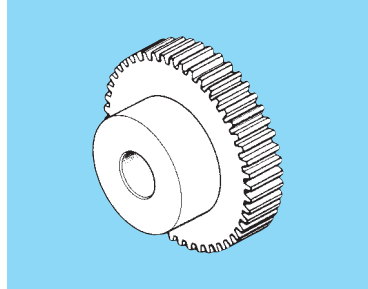

■ ISO CLASS 8

■ 20° PRESSURE ANGLE

■ 5 mm FACE WIDTH

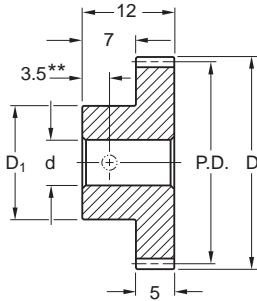

1 GEARS

CATALOG NUMBER DESIGNATION:

QUALITY CLASS

A 1 2 M Y 0 4

Material Code

Brass ASTM 8A

Steel SAE 1109

Acetal

Stainless Steel AISI 416
Prehardened to HRC 25

B

C

P

Y

No. of
Teeth

No. of Teeth	P.D.	D	d* Bore H8	D1 Hub Dia.	Set** Screw	Sub** Drill
12	4.8	5.6	3	4.5 5.5 5.5 6	M1.6	0.9
15	6	6.8				
16	6.4	7.2				
20	8	8.8				
24	9.6	10.4	4	8	M2	1.3
25	10	10.8				
30	12	12.8				
32	12.8	13.6				
35	14	14.8				
36	14.4	15.2				
40	16	16.8				
45	18	18.8	6	10	M2	1.3
48	19.2	20				
50	20	20.8				
55	22	22.8				
60	24	24.8				
64	25.6	26.4	15	15	M3	1.8
65	26	26.8				
70	28	28.8				
72	28.8	29.6				
75	30	30.8				
80	32	32.8				
84	33.6	34.4				
85	34	34.8				
90	36	36.8				
95	38	38.8				
96	38.4	39.2				
100	40	40.8				
108	43.2	44				
120	48	48.8				

*Bore Tolerance: 3 mm + 0.014
4 & 6 mm + 0.018

**NOTE: Set screw and location are shown for information only.
They are supplied as special order.

■ ISO CLASS 7

■ 20° PRESSURE ANGLE

■ 5 & 7 mm FACE WIDTH

1

GEARS

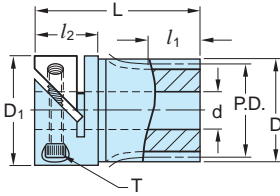

Fig. 1

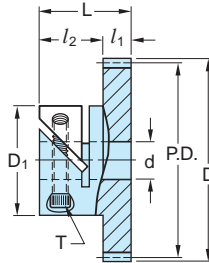
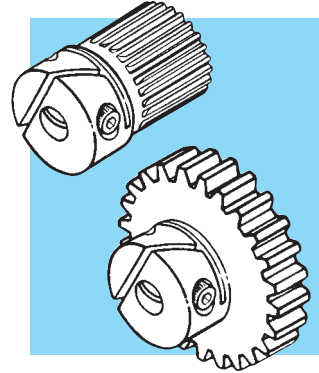

Fig. 2



NOTE: Socket Head Cap Screw Supplied.

MATERIAL: 303 Stainless Steel

S Precision Component

Catalog Number	Fig. No.	No. of Teeth	P.D.	D	d* Bore H7	l_1 Face Width	L	D_1	l_2	T	Hub Clear. Rad.
S1VS05M016F0704	1	16	8	9	4	7	22	14	8	M2.5	8.3
S1VS05M018F0704		18	9	10							
S1VS05M020F0704		20	10	11							
S1VS05M024F0705	1	24	12	13	5	7	22	14	8	M2.5	8.3
S1VS05M025F0705		25	12.5	13.5							
S1VS05M028F0705		28	14	15							
S1VS05M030F0705		30	15	16							
S1VS05M032F0506	2	32	16	17	6	5	15	17	10	M3	11.3
S1VS05M036F0506		36	18	19							
S1VS05M040F0506		40	20	21							
S1VS05M045F0506		45	22.5	23.5							
S1VS05M048F0506		48	24	25							
S1VS05M050F0506		50	25	26							
S1VS05M054F0506		54	27	28							
S1VS05M056F0506		56	28	29							
S1VS05M060F0508		60	30	31							
S1VS05M064F0508	64	32	33								
S1VS05M070F0508	70	35	36	8	5	15	17	10	M3	11.3	
S1VS05M072F0508	72	36	37								
S1VS05M075F0508	75	37.5	38.5								
S1VS05M080F0510	2	80	40	41	10	5	19	24	14	M4	14
S1VS05M090F0510		90	45	46							
S1VS05M096F0510		96	48	49							
S1VS05M100F0510		100	50	51							
S1VS05M112F0510		112	56	57							
S1VS05M120F0510		120	60	61							

*Bore Tolerance: 4, 5 & 6 mm + 0.012
8 & 10 mm + 0.015

Gears larger than 90 teeth have two-piece construction.

■ ISO CLASS 7

■ 20° PRESSURE ANGLE

■ 3 mm FACE

■ 3 mm BORE

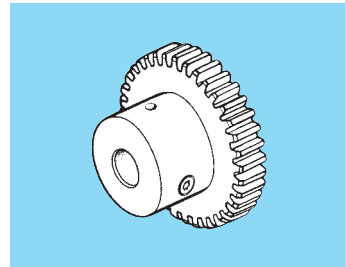
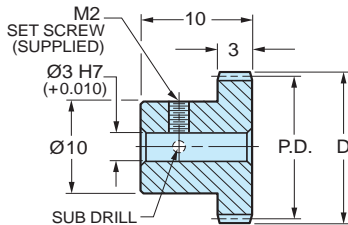

S Precision
Component

Catalog Number		No. of Teeth	P.D.	D
303 Stainless Steel	2024 Aluminum* Anodized			
S10T05M020S0303	S10T05M020A0303	20	10	11
S10T05M021S0303	S10T05M021A0303	21	10.5	11.5
S10T05M022S0303	S10T05M022A0303	22	11	12
S10T05M024S0303	S10T05M024A0303	24	12	13
S10T05M025S0303	S10T05M025A0303	25	12.5	13.5
S10T05M026S0303	S10T05M026A0303	26	13	14
S10T05M028S0303	S10T05M028A0303	28	14	15
S10T05M030S0303	S10T05M030A0303	30	15	16
S10T05M032S0303	S10T05M032A0303	32	16	17
S10T05M034S0303	S10T05M034A0303	34	17	18
S10T05M036S0303	S10T05M036A0303	36	18	19
S10T05M040S0303	S10T05M040A0303	40	20	21
S10T05M042S0303	S10T05M042A0303	42	21	22
S10T05M046S0303	S10T05M046A0303	46	23	24
S10T05M048S0303	S10T05M048A0303	48	24	25
S10T05M050S0303	S10T05M050A0303	50	25	26
S10T05M055S0303	S10T05M055A0303	55	27.5	28.5
S10T05M056S0303	S10T05M056A0303	56	28	29
S10T05M060S0303	S10T05M060A0303	60	30	31
S10T05M064S0303	S10T05M064A0303	64	32	33
S10T05M065S0303	S10T05M065A0303	65	32.5	33.5
S10T05M070S0303	S10T05M070A0303	70	35	36
S10T05M072S0303	S10T05M072A0303	72	36	37
S10T05M075S0303	S10T05M075A0303	75	37.5	38.5
S10T05M080S0303	S10T05M080A0303	80	40	41
S10T05M084S0303	S10T05M084A0303	84	42	43
S10T05M090S0303	S10T05M090A0303	90	45	46
S10T05M096S0303	S10T05M096A0303	96	48	49
S10T05M100S0303	S10T05M100A0303	100	50	51
S10T05M105S0303	S10T05M105A0303	105	52.5	53.5

* T4 or T351 Aluminum Alloy, anodized before cutting.

Available as special order: Number of teeth not listed, different bore size and/or material, passivation for stainless steel.

■ ISO CLASS 7

■ 20° PRESSURE ANGLE

■ 3 mm FACE

■ 5 mm BORE

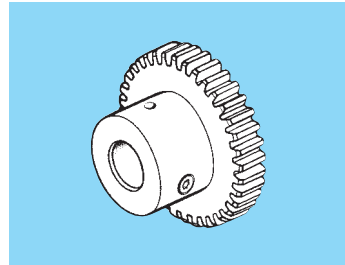
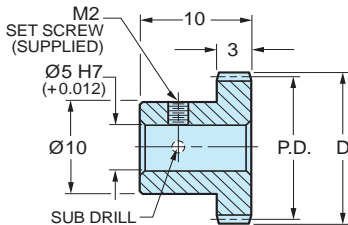

S Precision
Component

Catalog Number		No. of Teeth	P.D.	D
303 Stainless Steel	2024 Aluminum* Anodized			
S10T05M020S0305	S10T05M020A0305	20	10	11
S10T05M021S0305	S10T05M021A0305	21	10.5	11.5
S10T05M022S0305	S10T05M022A0305	22	11	12
S10T05M024S0305	S10T05M024A0305	24	12	13
S10T05M025S0305	S10T05M025A0305	25	12.5	13.5
S10T05M028S0305	S10T05M028A0305	28	14	15
S10T05M030S0305	S10T05M030A0305	30	15	16
S10T05M032S0305	S10T05M032A0305	32	16	17
S10T05M034S0305	S10T05M034A0305	34	17	18
S10T05M036S0305	S10T05M036A0305	36	18	19
S10T05M040S0305	S10T05M040A0305	40	20	21
S10T05M042S0305	S10T05M042A0305	42	21	22
S10T05M046S0305	S10T05M046A0305	46	23	24
S10T05M048S0305	S10T05M048A0305	48	24	25
S10T05M050S0305	S10T05M050A0305	50	25	26
S10T05M060S0305	S10T05M060A0305	60	30	31
S10T05M064S0305	S10T05M064A0305	64	32	33
S10T05M070S0305	S10T05M070A0305	70	35	36
S10T05M072S0305	S10T05M072A0305	72	36	37
S10T05M080S0305	S10T05M080A0305	80	40	41
S10T05M084S0305	S10T05M084A0305	84	42	43
S10T05M090S0305	S10T05M090A0305	90	45	46
S10T05M096S0305	S10T05M096A0305	96	48	49
S10T05M105S0305	S10T05M105A0305	105	52.5	53.5
S10T05M120S0305	S10T05M120A0305	120	60	61
S10T05M132S0305	S10T05M132A0305	132	66	67
S10T05M144S0305	S10T05M144A0305	144	72	73
S10T05M156S0305	S10T05M156A0305	156	78	79
S10T05M168S0305	S10T05M168A0305	168	84	85
S10T05M192S0305	S10T05M192A0305	192	96	97

* T4 or T351 Aluminum Alloy, anodized before cutting.

Available as special order: Number of teeth not listed, different bore size and/or material, passivation for stainless steel.

■ ISO CLASS 7

■ 20° PRESSURE ANGLE

■ 3 mm FACE

■ 8 mm BORE

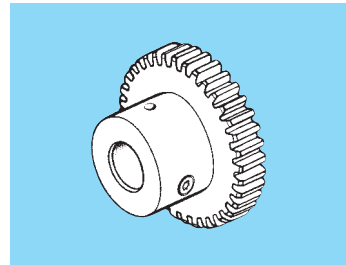
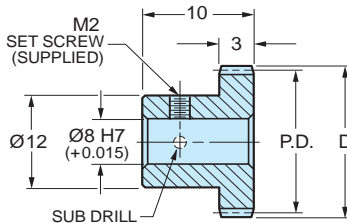

S Precision Component

Catalog Number		No. of Teeth	P.D.	D
303 Stainless Steel	2024 Aluminum* Anodized			
S10T05M024S0308	S10T05M024A0308	24	12	13
S10T05M025S0308	S10T05M025A0308	25	12.5	13.5
S10T05M028S0308	S10T05M028A0308	28	14	15
S10T05M030S0308	S10T05M030A0308	30	15	16
S10T05M032S0308	S10T05M032A0308	32	16	17
S10T05M036S0308	S10T05M036A0308	36	18	19
S10T05M040S0308	S10T05M040A0308	40	20	21
S10T05M042S0308	S10T05M042A0308	42	21	22
S10T05M048S0308	S10T05M048A0308	48	24	25
S10T05M050S0308	S10T05M050A0308	50	25	26
S10T05M054S0308	S10T05M054A0308	54	27	28
S10T05M056S0308	S10T05M056A0308	56	28	29
S10T05M060S0308	S10T05M060A0308	60	30	31
S10T05M064S0308	S10T05M064A0308	64	32	33
S10T05M070S0308	S10T05M070A0308	70	35	36
S10T05M072S0308	S10T05M072A0308	72	36	37
S10T05M075S0308	S10T05M075A0308	75	37.5	38.5
S10T05M080S0308	S10T05M080A0308	80	40	41
S10T05M090S0308	S10T05M090A0308	90	45	46
S10T05M096S0308	S10T05M096A0308	96	48	49
S10T05M100S0308	S10T05M100A0308	100	50	51
S10T05M105S0308	S10T05M105A0308	105	52.5	53.5
S10T05M120S0308	S10T05M120A0308	120	60	61
S10T05M132S0308	S10T05M132A0308	132	66	67
S10T05M140S0308	S10T05M140A0308	140	70	71
S10T05M150S0308	S10T05M150A0308	150	75	76
S10T05M160S0308	S10T05M160A0308	160	80	81
S10T05M168S0308	S10T05M168A0308	168	84	85
S10T05M180S0308	S10T05M180A0308	180	90	91
S10T05M192S0308	S10T05M192A0308	192	96	97

* T4 or T351 Aluminum Alloy, anodized before cutting.

Available as special order: Number of teeth not listed, different bore size and/or material, passivation for stainless steel.

■ ISO CLASS 7

■ 20° PRESSURE ANGLE

■ 5 mm FACE

■ 5 mm BORE

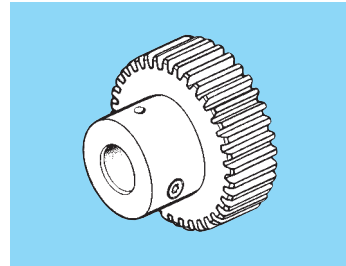
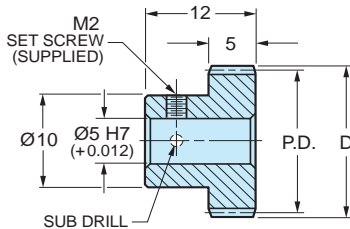

S Precision
Component

Catalog Number		No. of Teeth	P.D.	D
303 Stainless Steel	2024 Aluminum* Anodized			
S10T05M020S0505	S10T05M020A0505	20	10	11
S10T05M021S0505	S10T05M021A0505	21	10.5	11.5
S10T05M022S0505	S10T05M022A0505	22	11	12
S10T05M024S0505	S10T05M024A0505	24	12	13
S10T05M025S0505	S10T05M025A0505	25	12.5	13.5
S10T05M026S0505	S10T05M026A0505	26	13	14
S10T05M028S0505	S10T05M028A0505	28	14	15
S10T05M030S0505	S10T05M030A0505	30	15	16
S10T05M032S0505	S10T05M032A0505	32	16	17
S10T05M036S0505	S10T05M036A0505	36	18	19
S10T05M040S0505	S10T05M040A0505	40	20	21
S10T05M044S0505	S10T05M044A0505	44	22	23
S10T05M048S0505	S10T05M048A0505	48	24	25
S10T05M050S0505	S10T05M050A0505	50	25	26
S10T05M055S0505	S10T05M055A0505	55	27.5	28.5
S10T05M060S0505	S10T05M060A0505	60	30	31
S10T05M064S0505	S10T05M064A0505	64	32	33
S10T05M065S0505	S10T05M065A0505	65	32.5	33.5
S10T05M072S0505	S10T05M072A0505	72	36	37
S10T05M084S0505	S10T05M084A0505	84	42	43
S10T05M085S0505	S10T05M085A0505	85	42.5	43.5
S10T05M090S0505	S10T05M090A0505	90	45	46
S10T05M096S0505	S10T05M096A0505	96	48	49
S10T05M100S0505	S10T05M100A0505	100	50	51
S10T05M108S0505	S10T05M108A0505	108	54	55
S10T05M120S0505	S10T05M120A0505	120	60	61
S10T05M144S0505	S10T05M144A0505	144	72	73
S10T05M156S0505	S10T05M156A0505	156	78	79
S10T05M180S0505	S10T05M180A0505	180	90	91
S10T05M192S0505	S10T05M192A0505	192	96	97

* T4 or T351 Aluminum Alloy, anodized before cutting.

Available as special order: Number of teeth not listed, different bore size and/or material, passivation for stainless steel.

■ ISO CLASS 7

■ 20° PRESSURE ANGLE

■ 5 mm FACE

■ 8 mm BORE

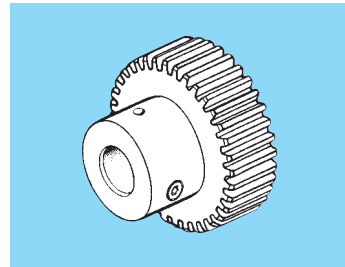
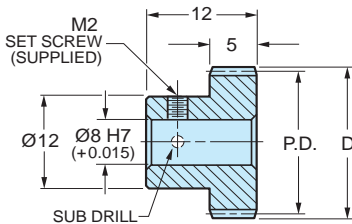

S Precision Component

Catalog Number		No. of Teeth	P.D.	D
303 Stainless Steel	2024 Aluminum* Anodized			
S10T05M020S0508	S10T05M020A0508	20	10	11
S10T05M021S0508	S10T05M021A0508	21	10.5	11.5
S10T05M022S0508	S10T05M022A0508	22	11	12
S10T05M024S0508	S10T05M024A0508	24	12	13
S10T05M025S0508	S10T05M025A0508	25	12.5	13.5
S10T05M026S0508	S10T05M026A0508	26	13	14
S10T05M028S0508	S10T05M028A0508	28	14	15
S10T05M030S0508	S10T05M030A0508	30	15	16
S10T05M032S0508	S10T05M032A0508	32	16	17
S10T05M036S0508	S10T05M036A0508	36	18	19
S10T05M042S0508	S10T05M042A0508	42	21	22
S10T05M048S0508	S10T05M048A0508	48	24	25
S10T05M050S0508	S10T05M050A0508	50	25	26
S10T05M055S0508	S10T05M055A0508	55	27.5	28.5
S10T05M060S0508	S10T05M060A0508	60	30	31
S10T05M064S0508	S10T05M064A0508	64	32	33
S10T05M070S0508	S10T05M070A0508	70	35	36
S10T05M072S0508	S10T05M072A0508	72	36	37
S10T05M075S0508	S10T05M075A0508	75	37.5	38.5
S10T05M080S0508	S10T05M080A0508	80	40	41
S10T05M084S0508	S10T05M084A0508	84	42	43
S10T05M090S0508	S10T05M090A0508	90	45	46
S10T05M096S0508	S10T05M096A0508	96	48	49
S10T05M100S0508	S10T05M100A0508	100	50	51
S10T05M108S0508	S10T05M108A0508	108	54	55
S10T05M110S0508	S10T05M110A0508	110	55	56
S10T05M120S0508	S10T05M120A0508	120	60	61
S10T05M128S0508	S10T05M128A0508	128	64	65
S10T05M168S0508	S10T05M168A0508	168	84	85
S10T05M198S0508	S10T05M198A0508	198	99	100

* T4 or T351 Aluminum Alloy, anodized before cutting.

Available as special order: Number of teeth not listed, different bore size and/or material, passivation for stainless steel.



■ ISO CLASS 8

■ 20° PRESSURE ANGLE

■ 2 & 3 mm FACE WIDTH

1

GEARS

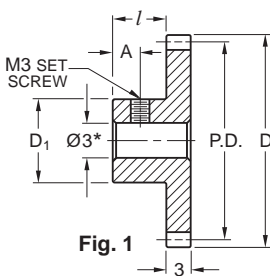

Fig. 1

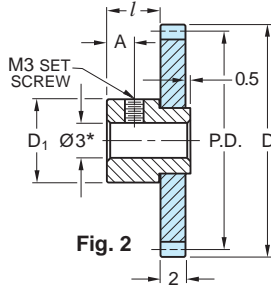
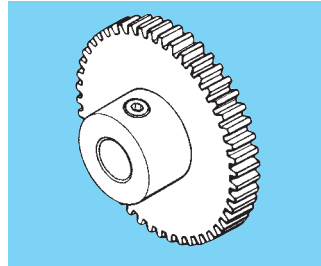

Fig. 2



QUALITY CLASS

MATERIAL: Brass

Catalog Number	Fig. No.	No. of Teeth	P.D.	D	D ₁ Hub Dia.	l Hub Proj.	A	
A 1B 2MYK05020H	1	20	10	11	8.5	5	2.5	
A 1B 2MYK05024H		24	12	13				
A 1B 2MYK05025		25	12.5	13.5				
A 1B 2MYK05026		26	13	14				
A 1B 2MYK05028		1	28	14	15	10	5	2.5
A 1B 2MYK05030H			30	15	16			
A 1B 2MYK05032			32	16	17			
A 1B 2MYK05035			35	17.5	18.5			
A 1B 2MYK05036	36		18	19	10	5	2.5	
A 1B 2MYK05040	40		20	21				
A 1B 2MYK05042	42		21	22				
A 1B 2MYK05045	45		22.5	23.5				
A 1B 2MYK05048	2	48	24	25	10	5	2.5	
A 1B 2MYK05050		50	25	26				
A 1B 2MYK05055		55	27.5	28.5				
A 1B 2MYK05056		56	28	29				
A 1B 2MYK05058		2	58	29	30	10	5	2.5
A 1B 2MYK05060			60	30	31			
A 1B 2MYK05062			62	31	32			
A 1B 2MYK05064			64	32	33			
A 1B 2MYK05065	2		65	32.5	33.5	10	5	2.5
A 1B 2MYK05066			66	33	34			
A 1B 2MYK05068			68	34	35			
A 1B 2MYK05070			70	35	36			
A 1B 2MYK05072		2	72	36	37	10	5	2.5
A 1B 2MYK05075			75	37.5	38.5			
A 1B 2MYK05080			80	40	41			
A 1B 2MYK05084			84	42	43			
A 1B 2MYK05085	2		85	42.5	43.5	10	5	2.5
A 1B 2MYK05090			90	45	46			
A 1B 2MYK05095			95	47.5	48.5			
A 1B 2MYK05100			100	50	51			
A 1B 2MYK05105		2	105	52.5	53.5	15	7	3.5
A 1B 2MYK05110			110	55	56			

*Gears with 3 mm bore have a tolerance of + 0.014 (H8)

See "Pinion" section for smaller numbers of teeth.

■ ISO CLASS 8

■ 20° PRESSURE ANGLE

■ 5 mm FACE WIDTH

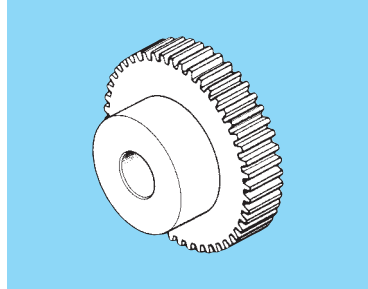
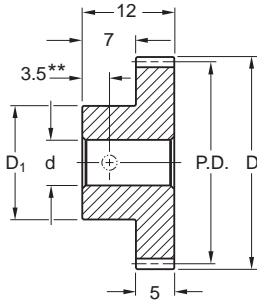

1 GEARS

QUALITY CLASS

CATALOG NUMBER DESIGNATION:

Material Code
 Brass F.M. 360
 Steel SAE 12L14
 Stainless Steel AISI 416
 Prehardened to HRC 25

A 1 2 M Y 0 5

B
 C
 Y

No. of Teeth

No. of Teeth	P.D.	D	d* Bore H8	D ₁ Hub Dia.	Set** Screw	Sub** Drill
12	6	7	3	5	M2	1.3
15	7.5	8.5	3	6	M2	1.3
16	8	9				
20	10	11	4	8	M2	1.3
24	12	13				
25	12.5	13.5				
30	15	16	4	10	M2	1.3
32	16	17				
35	17.5	18.5				
36	18	19				
40	20	21				
48	24	25	6	15	M3	1.8
50	25	26				
55	27.5	28.5				
60	30	31				
64	32	33				
65	32.5	33.5				
72	36	37				
75	37.5	38.5				
80	40	41				
90	45	46				
96	48	49				
100	50	51				
120	60	61				

*Bore Tolerance: 3 mm + 0.014
 4 & 6 mm + 0.018

**NOTE: Gears are sold without set screw and sub drill holes.
 They are shown for information only and are supplied as a special order.

■ ISO CLASS 7 ■ 20° PRESSURE ANGLE ■ 3 mm FACE ■ 10 mm BORE

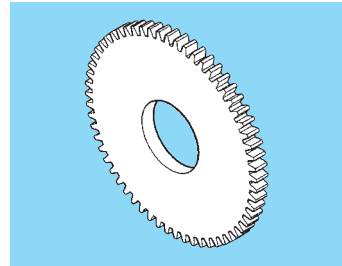
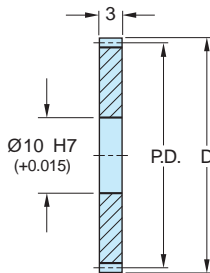

S Precision
Component

Catalog Number		No. of Teeth	P.D.	D
303 Stainless Steel	2024 Aluminum* Anodized			
S12N05M030S0310	S12N05M030A0310	30	15	16
S12N05M032S0310	S12N05M032A0310	32	16	17
S12N05M036S0310	S12N05M036A0310	36	18	19
S12N05M040S0310	S12N05M040A0310	40	20	21
S12N05M042S0310	S12N05M042A0310	42	21	22
S12N05M045S0310	S12N05M045A0310	45	22.5	23.5
S12N05M048S0310	S12N05M048A0310	48	24	25
S12N05M050S0310	S12N05M050A0310	50	25	26
S12N05M056S0310	S12N05M056A0310	56	28	29
S12N05M060S0310	S12N05M060A0310	60	30	31
S12N05M064S0310	S12N05M064A0310	64	32	33
S12N05M070S0310	S12N05M070A0310	70	35	36
S12N05M072S0310	S12N05M072A0310	72	36	37
S12N05M080S0310	S12N05M080A0310	80	40	41
S12N05M084S0310	S12N05M084A0310	84	42	43
S12N05M090S0310	S12N05M090A0310	90	45	46
S12N05M096S0310	S12N05M096A0310	96	48	49
S12N05M100S0310	S12N05M100A0310	100	50	51
S12N05M108S0310	S12N05M108A0310	108	54	55
S12N05M110S0310	S12N05M110A0310	110	55	56
S12N05M120S0310	S12N05M120A0310	120	60	61
S12N05M130S0310	S12N05M130A0310	130	65	66
S12N05M132S0310	S12N05M132A0310	132	66	67
S12N05M138S0310	S12N05M138A0310	138	69	70
S12N05M140S0310	S12N05M140A0310	140	70	71
S12N05M150S0310	S12N05M150A0310	150	75	76
S12N05M160S0310	S12N05M160A0310	160	80	81
S12N05M180S0310	S12N05M180A0310	180	90	91
S12N05M186S0310	S12N05M186A0310	186	93	94
S12N05M192S0310	S12N05M192A0310	192	96	97

* T4 or T351 Aluminum Alloy, anodized before cutting.

Available as special order: Number of teeth not listed, different bore size and/or material, passivation for stainless steel.

■ ISO CLASS 7 ■ 20° PRESSURE ANGLE ■ 3.2 mm FACE ■ 10 mm BORE

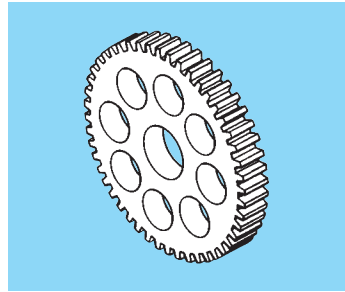
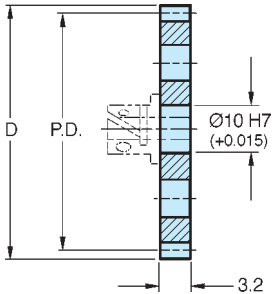

- All gears over 54 mm diameter supplied with lightening holes.
- See index for hubs. Assembled upon request at nominal charge.

Catalog Number		No. of Teeth	P.D.	D
303 Stainless Steel	2024 Aluminum* Anodized			
S12S05M029N0310	S12A05M029N0310	29	14.5	15.5
S12S05M030N0310	S12A05M030N0310	30	15	16
S12S05M032N0310	S12A05M032N0310	32	16	17
S12S05M040N0310	S12A05M040N0310	40	20	21
S12S05M044N0310	S12A05M044N0310	44	22	23
S12S05M048N0310	S12A05M048N0310	48	24	25
S12S05M050N0310	S12A05M050N0310	50	25	26
S12S05M054N0310	S12A05M054N0310	54	27	28
S12S05M060N0310	S12A05M060N0310	60	30	31
S12S05M064N0310	S12A05M064N0310	64	32	33
S12S05M065N0310	S12A05M065N0310	65	32.5	33.5
S12S05M070N0310	S12A05M070N0310	70	35	36
S12S05M072N0310	S12A05M072N0310	72	36	37
S12S05M075N0310	S12A05M075N0310	75	37.5	38.5
S12S05M080N0310	S12A05M080N0310	80	40	41
S12S05M084N0310	S12A05M084N0310	84	42	43
S12S05M090N0310	S12A05M090N0310	90	45	46
S12S05M096N0310	S12A05M096N0310	96	48	49
S12S05M100N0310	S12A05M100N0310	100	50	51
S12S05M105N0310	S12A05M105N0310	105	52.5	53.5
S12S05M110N0310	S12A05M110N0310	110	55	56
S12S05M120N0310	S12A05M120N0310	120	60	61
S12S05M130N0310	S12A05M130N0310	130	65	66
S12S05M140N0310	S12A05M140N0310	140	70	71
S12S05M144N0310	S12A05M144N0310	144	72	73
S12S05M150N0310	S12A05M150N0310	150	75	76
S12S05M180N0310	S12A05M180N0310	180	90	91
S12S05M186N0310	S12A05M186N0310	186	93	94
S12S05M192N0310	S12A05M192N0310	192	96	97
S12S05M198N0310	S12A05M198N0310	198	99	100

*T4 or T351 Aluminum Alloy, anodized before cutting.

Available as special order: 14-1/2° P.A., teeth not listed, different bore size and/or material, passivation for Stainless Steel.

■ ISO CLASS 7 ■ 20° PRESSURE ANGLE ■ 5 mm FACE ■ 10 mm BORE

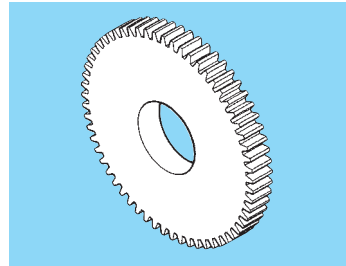
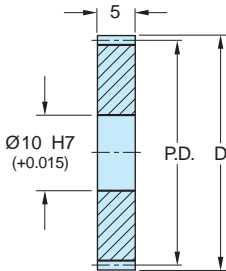

S Precision Component

Catalog Number		No. of Teeth	P.D.	D
303 Stainless Steel	2024 Aluminum* Anodized			
S12N05M030S0510	S12N05M030A0510	30	15	16
S12N05M032S0510	S12N05M032A0510	32	16	17
S12N05M036S0510	S12N05M036A0510	36	18	19
S12N05M040S0510	S12N05M040A0510	40	20	21
S12N05M042S0510	S12N05M042A0510	42	21	22
S12N05M045S0510	S12N05M045A0510	45	22.5	23.5
S12N05M048S0510	S12N05M048A0510	48	24	25
S12N05M050S0510	S12N05M050A0510	50	25	26
S12N05M056S0510	S12N05M056A0510	56	28	29
S12N05M060S0510	S12N05M060A0510	60	30	31
S12N05M064S0510	S12N05M064A0510	64	32	33
S12N05M070S0510	S12N05M070A0510	70	35	36
S12N05M072S0510	S12N05M072A0510	72	36	37
S12N05M080S0510	S12N05M080A0510	80	40	41
S12N05M084S0510	S12N05M084A0510	84	42	43
S12N05M090S0510	S12N05M090A0510	90	45	46
S12N05M096S0510	S12N05M096A0510	96	48	49
S12N05M100S0510	S12N05M100A0510	100	50	51
S12N05M108S0510	S12N05M108A0510	108	54	55
S12N05M110S0510	S12N05M110A0510	110	55	56
S12N05M120S0510	S12N05M120A0510	120	60	61
S12N05M130S0510	S12N05M130A0510	130	65	66
S12N05M132S0510	S12N05M132A0510	132	66	67
S12N05M138S0510	S12N05M138A0510	138	69	70
S12N05M140S0510	S12N05M140A0510	140	70	71
S12N05M150S0510	S12N05M150A0510	150	75	76
S12N05M160S0510	S12N05M160A0510	160	80	81
S12N05M180S0510	S12N05M180A0510	180	90	91
S12N05M186S0510	S12N05M186A0510	186	93	94
S12N05M192S0510	S12N05M192A0510	192	96	97

* T4 or T351 Aluminum Alloy, anodized before cutting.

Available as special order: Number of teeth not listed, different bore size and/or material, passivation for stainless steel.



■ ISO CLASS 8

■ 20° PRESSURE ANGLE

■ 2 mm FACE WIDTH

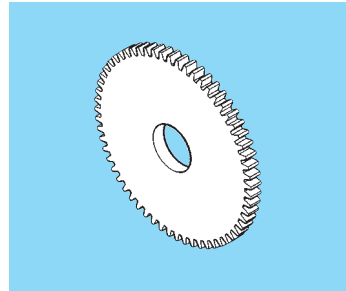
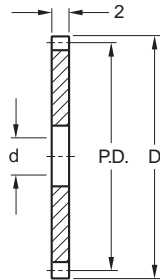

QUALITY CLASS

MATERIAL: Brass

Catalog Number	No. of Teeth	P.D.	D	d* Bore H8
A 1B 1MYK05040	40	20	21	8
A 1B 1MYK05042	42	21	22	
A 1B 1MYK05045	45	22.5	23.5	
A 1B 1MYK05048	48	24	25	
A 1B 1MYK05050	50	25	26	
A 1B 1MYK05055	55	27.5	28.5	
A 1B 1MYK05056	56	28	29	
A 1B 1MYK05058	58	29	30	
A 1B 1MYK05060	60	30	31	
A 1B 1MYK05062	62	31	32	
A 1B 1MYK05064	64	32	33	
A 1B 1MYK05065	65	32.5	33.5	
A 1B 1MYK05068	68	34	35	
A 1B 1MYK05070	70	35	36	
A 1B 1MYK05072	72	36	37	
A 1B 1MYK05075	75	37.5	38.5	
A 1B 1MYK05080	80	40	41	
A 1B 1MYK05084	84	42	43	
A 1B 1MYK05085	85	42.5	43.5	
A 1B 1MYK05090	90	45	46	
A 1B 1MYK05095	95	47.5	48.5	
A 1B 1MYK05100	100	50	51	12
A 1B 1MYK05105	105	52.5	53.5	
A 1B 1MYK05110	110	55	56	

*Bore Tolerance: 8 mm + 0.022

12 mm + 0.027

See also "Pinions - Module 0.5".