

■ ISO CLASS 7

■ 20° PRESSURE ANGLE

■ 5 & 7 mm FACE WIDTH

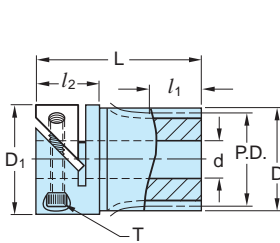

Fig. 1

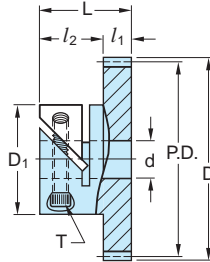
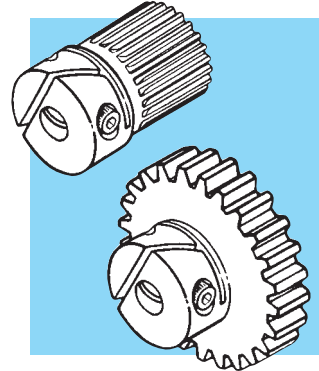

Fig. 2



NOTE: Socket Head Cap Screw Supplied.

MATERIAL: 303 Stainless Steel

S Precision Component

Catalog Number	Fig. No.	No. of Teeth	P.D.	D	d* Bore H7	l_1 Face Width	L	D_1	l_2	T	Hub Clear. Rad.
S1VS08M014F0704	1	14	11.2	12.8	4	7	22	14	8	M2.5	8.3
S1VS08M015F0704		15	12	13.6							
S1VS08M016F0704		16	12.8	14.4							
S1VS08M018F0704		18	14.4	16							
S1VS08M020F0504	2	20	16	17.6	5	5	13	14	8	M2.5	8.3
S1VS08M022F0504		22	17.6	19.2							
S1VS08M024F0505		24	19.2	20.8							
S1VS08M025F0505		25	20	21.6							
S1VS08M028F0505		28	22.4	24							
S1VS08M030F0505		30	24	25.6							
S1VS08M032F0505		32	25.6	27.2							
S1VS08M036F0506		36	28.8	30.4							
S1VS08M040F0506		40	32	33.6							
S1VS08M045F0506		45	36	37.6							
S1VS08M048F0506	48	38.4	40								
S1VS08M050F0506	50	40	41.6								
S1VS08M054F0506	54	43.2	44.8								
S1VS08M056F0506	56	44.8	46.4								
S1VS08M060F0508	60	48	49.6								
S1VS08M064F0508	64	51.2	52.8								
S1VS08M072F0508	72	57.6	59.2								
S1VS08M080F0510	80	64	65.6								
S1VS08M090F0510	90	72	73.6								
S1VS08M100F0510	100	80	81.6								

*Bore Tolerance: 4, 5 & 6 mm +0.012
8 & 10 mm +0.015

Gears larger than 56 teeth have two-piece construction.

■ ISO CLASS 7

■ 20° PRESSURE ANGLE

■ 5 mm FACE

■ 5 mm BORE

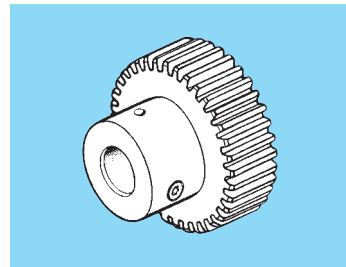
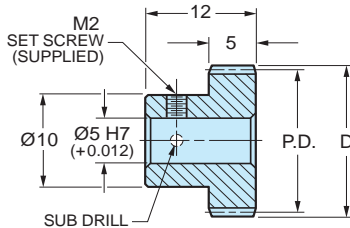

S Precision
Component

Catalog Number		No. of Teeth	P.D.	D
303 Stainless Steel	2024 Aluminum* Anodized			
S10T08M012S0505	S10T08M012A0505	12	9.6	11.2
S10T08M015S0505	S10T08M015A0505	15	12	13.6
S10T08M016S0505	S10T08M016A0505	16	12.8	14.4
S10T08M017S0505	S10T08M017A0505	17	13.6	15.2
S10T08M018S0505	S10T08M018A0505	18	14.4	16
S10T08M020S0505	S10T08M020A0505	20	16	17.6
S10T08M022S0505	S10T08M022A0505	22	17.6	19.2
S10T08M024S0505	S10T08M024A0505	24	19.2	20.8
S10T08M026S0505	S10T08M026A0505	26	20.8	22.4
S10T08M028S0505	S10T08M028A0505	28	22.4	24
S10T08M030S0505	S10T08M030A0505	30	24	25.6
S10T08M032S0505	S10T08M032A0505	32	25.6	27.2
S10T08M036S0505	S10T08M036A0505	36	28.8	30.4
S10T08M040S0505	S10T08M040A0505	40	32	33.6
S10T08M048S0505	S10T08M048A0505	48	38.4	40
S10T08M052S0505	S10T08M052A0505	52	41.6	43.2
S10T08M056S0505	S10T08M056A0505	56	44.8	46.4
S10T08M060S0505	S10T08M060A0505	60	48	49.6
S10T08M064S0505	S10T08M064A0505	64	51.2	52.8
S10T08M068S0505	S10T08M068A0505	68	54.4	56
S10T08M072S0505	S10T08M072A0505	72	57.6	59.2
S10T08M080S0505	S10T08M080A0505	80	64	65.6
S10T08M084S0505	S10T08M084A0505	84	67.2	68.8
S10T08M092S0505	S10T08M092A0505	92	73.6	75.2
S10T08M096S0505	S10T08M096A0505	96	76.8	78.4
S10T08M100S0505	S10T08M100A0505	100	80	81.6
S10T08M108S0505	S10T08M108A0505	108	86.4	88
S10T08M112S0505	S10T08M112A0505	112	89.6	91.2
S10T08M116S0505	S10T08M116A0505	116	92.8	94.4
S10T08M120S0505	S10T08M120A0505	120	96	97.6

* T4 or T351 Aluminum Alloy, anodized before cutting.

Available as special order: Number of teeth not listed, different bore size and/or material, passivation for stainless steel.

■ ISO CLASS 7

■ 20° PRESSURE ANGLE

■ 5 mm FACE

■ 8 mm BORE

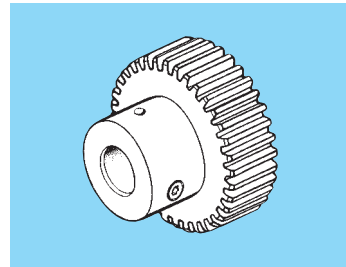
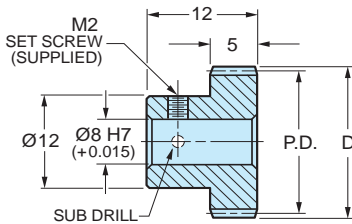

S Precision Component

Catalog Number		No. of Teeth	P.D.	D
303 Stainless Steel	2024 Aluminum* Anodized			
S10T08M014S0508	S10T08M014A0508	14	11.2	12.8
S10T08M015S0508	S10T08M015A0508	15	12	13.6
S10T08M016S0508	S10T08M016A0508	16	12.8	14.4
S10T08M018S0508	S10T08M018A0508	18	14.4	16
S10T08M020S0508	S10T08M020A0508	20	16	17.6
S10T08M024S0508	S10T08M024A0508	24	19.2	20.8
S10T08M026S0508	S10T08M026A0508	26	20.8	22.4
S10T08M028S0508	S10T08M028A0508	28	22.4	24
S10T08M030S0508	S10T08M030A0508	30	24	25.6
S10T08M032S0508	S10T08M032A0508	32	25.6	27.2
S10T08M036S0508	S10T08M036A0508	36	28.8	30.4
S10T08M040S0508	S10T08M040A0508	40	32	33.6
S10T08M048S0508	S10T08M048A0508	48	38.4	40
S10T08M052S0508	S10T08M052A0508	52	41.6	43.2
S10T08M056S0508	S10T08M056A0508	56	44.8	46.4
S10T08M060S0508	S10T08M060A0508	60	48	49.6
S10T08M064S0508	S10T08M064A0508	64	51.2	52.8
S10T08M065S0508	S10T08M065A0508	65	52	53.6
S10T08M072S0508	S10T08M072A0508	72	57.6	59.2
S10T08M075S0508	S10T08M075A0508	75	60	61.6
S10T08M080S0508	S10T08M080A0508	80	64	65.6
S10T08M085S0508	S10T08M085A0508	85	68	69.6
S10T08M088S0508	S10T08M088A0508	88	70.4	72
S10T08M092S0508	S10T08M092A0508	92	73.6	75.2
S10T08M096S0508	S10T08M096A0508	96	76.8	78.4
S10T08M100S0508	S10T08M100A0508	100	80	81.6
S10T08M108S0508	S10T08M108A0508	108	86.4	88
S10T08M112S0508	S10T08M112A0508	112	89.6	91.2
S10T08M120S0508	S10T08M120A0508	120	96	97.6
S10T08M128S0508	S10T08M128A0508	128	102.4	104

* T4 or T351 Aluminum Alloy, anodized before cutting.

Available as special order: Number of teeth not listed, different bore size and/or material, passivation for stainless steel.



■ ISO CLASS 8

■ 20° PRESSURE ANGLE

■ 5 & 7 mm FACE WIDTH

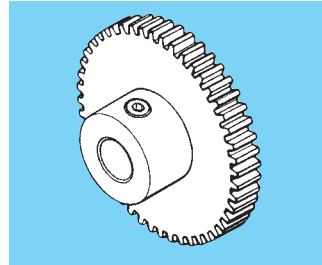
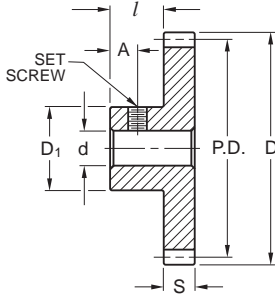

QUALITY CLASS

1 GEARS

MATERIAL: Brass

Catalog Number	No. of Teeth	P.D.	D	d* Bore H8	S Face Width	D ₁ Hub Dia.	l Hub Proj.	A	Set Screw
A 1B 2MYK08016	16	12.8	14.4						
A 1B 2MYK08018	18	14.4	16	4	7	10	7	3	M3
A 1B 2MYK08020	20	16	17.6						
A 1B 2MYK08024	24	19.2	20.8						
A 1B 2MYK08025	25	20	21.6	5	7	12.5	7	3	M3
A 1B 2MYK08028	28	22.4	24						
A 1B 2MYK08030	30	24	25.6						
A 1B 2MYK08032	32	25.6	27.2	5	5	12.5	7	3	M3
A 1B 2MYK08036	36	28.8	30.4						
A 1B 2MYK08040	40	32	33.6	6	5	14	9	4	M4
A 1B 2MYK08045	45	36	37.6						
A 1B 2MYK08048	48	38.4	40						
A 1B 2MYK08050	50	40	41.6						
A 1B 2MYK08056	56	44.8	46.4	6	5	14	9	4	M4
A 1B 2MYK08060	60	48	49.6						
A 1B 2MYK08064	64	51.2	52.8	6	5	16	9	4	M4
A 1B 2MYK08070	70	56	57.6						
A 1B 2MYK08072	72	57.6	59.2	8	5	16	9	4	M4
A 1B 2MYK08080	80	64	65.6						
A 1B 2MYK08090	90	72	73.6	8	5	20	9	4	M4
A 1B 2MYK08100	100	80	81.6			24			
A 1B 2MYK08108	108	86.4	88						
A 1B 2MYK08112	112	89.6	91.2	8	5	30	9	4	M4
A 1B 2MYK08120	120	96	97.6						

*Bore Tolerance: 4 & 5 mm + 0.018
6 & 8 mm + 0.022

See "Pinion" section for smaller numbers of teeth.

■ ISO CLASS 8

■ 20° PRESSURE ANGLE

■ 6 mm FACE WIDTH

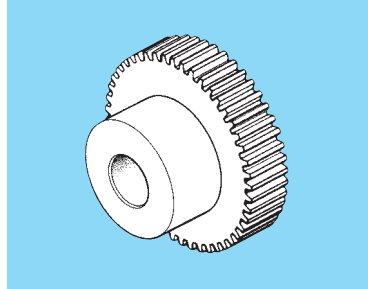
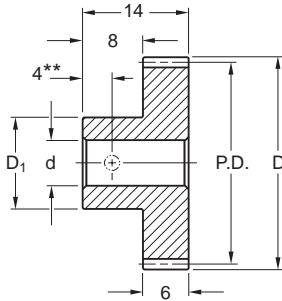

QUALITY CLASS

CATALOG NUMBER DESIGNATION:

Material Code
 Brass F.M. 360
 Steel 12L14
 Stainless Steel AISI 416
 Prehardened to Rc25

A 1 **2 M Y 0 8**
B |
C |
Y |

No. of Teeth

No. of Teeth	P.D.	D	d* Bore H8	D ₁ Hub Dia.	Set** Screw	Sub** Drill				
10	8	9.6	4	9.6	M2	1.3				
15	12	13.6	4	13.6	M2	1.3				
16	12.8	14.4		10						
20	16	17.6		6			12	M3	1.8	
24	19.2	20.8								
25	20	21.6								
30	24	25.6								
32	25.6	27.2								
35	28	29.6	8		19	M4				2.3
40	32	33.6								
45	36	37.6								
50	40	41.6								
55	44	45.6								
60	48	49.6	10	22	M5	2.8				
64	51.2	52.8								
65	52	53.6								
70	56	57.6								
75	60	61.6								
80	64	65.6					10	22	M5	2.8
90	72	73.6								
95	76	77.6								
96	76.8	78.4								
100	80	81.6	10	26	M5	2.8				
120	96	97.6								

*Bore Tolerance: 4 & 6 mm + 0.018
 8 & 10 mm + 0.022

**NOTE: Gears are sold without set screw and sub drill holes.
 They are shown for information only and are supplied as a special order.

■ ISO CLASS 7

■ 20° PRESSURE ANGLE

■ 3 mm FACE

■ 10 mm BORE

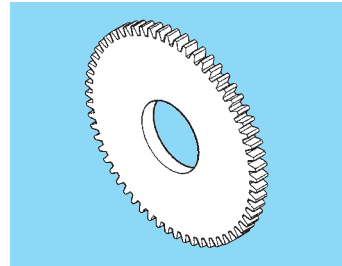
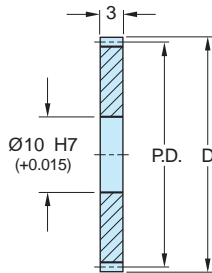

S Precision Component

Catalog Number		No. of Teeth	P.D.	D
303 Stainless Steel	2024 Aluminum* Anodized			
S12N08M020S0310	S12N08M020A0310	20	16	17.6
S12N08M024S0310	S12N08M024A0310	24	19.2	20.8
S12N08M025S0310	S12N08M025A0310	25	20	21.6
S12N08M028S0310	S12N08M028A0310	28	22.4	24
S12N08M032S0310	S12N08M032A0310	32	25.6	27.2
S12N08M036S0310	S12N08M036A0310	36	28.8	30.4
S12N08M040S0310	S12N08M040A0310	40	32	33.6
S12N08M048S0310	S12N08M048A0310	48	38.4	40
S12N08M050S0310	S12N08M050A0310	50	40	41.6
S12N08M054S0310	S12N08M054A0310	54	43.2	44.8
S12N08M056S0310	S12N08M056A0310	56	44.8	46.4
S12N08M060S0310	S12N08M060A0310	60	48	49.6
S12N08M064S0310	S12N08M064A0310	64	51.2	52.8
S12N08M065S0310	S12N08M065A0310	65	52	53.6
S12N08M070S0310	S12N08M070A0310	70	56	57.6
S12N08M072S0310	S12N08M072A0310	72	57.6	59.2
S12N08M075S0310	S12N08M075A0310	75	60	61.6
S12N08M080S0310	S12N08M080A0310	80	64	65.6
S12N08M084S0310	S12N08M084A0310	84	67.2	68.8
S12N08M085S0310	S12N08M085A0310	85	68	69.6
S12N08M090S0310	S12N08M090A0310	90	72	73.6
S12N08M096S0310	S12N08M096A0310	96	76.8	78.4
S12N08M100S0310	S12N08M100A0310	100	80	81.6
S12N08M108S0310	S12N08M108A0310	108	86.4	88
S12N08M110S0310	S12N08M110A0310	110	88	89.6
S12N08M115S0310	S12N08M115A0310	115	92	93.6
S12N08M120S0310	S12N08M120A0310	120	96	97.6
S12N08M126S0310	S12N08M126A0310	126	100.8	102.4
S12N08M128S0310	S12N08M128A0310	128	102.4	104
S12N08M132S0310	S12N08M132A0310	132	105.6	107.2

* T4 or T351 Aluminum Alloy, anodized before cutting.

Available as special order: Number of teeth not listed, different bore size and/or material, passivation for stainless steel.

■ ISO CLASS 7 ■ 20° PRESSURE ANGLE ■ 3.2 mm FACE ■ 10 mm BORE

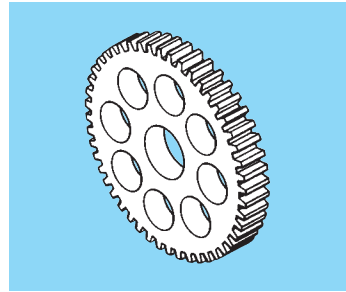
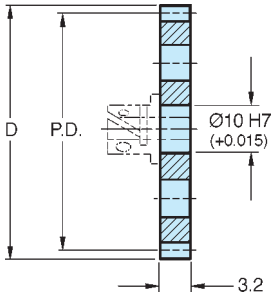

- All gears over 54 mm diameter supplied with lightening holes.
- See index for hubs. Assembled upon request at nominal charge.

Catalog Number		No. of Teeth	P.D.	D
303 Stainless Steel	2024 Aluminum* Anodized			
S12S08M019N0310	S12A08M019N0310	19	15.2	16.8
S12S08M020N0310	S12A08M020N0310	20	16	17.6
S12S08M024N0310	S12A08M024N0310	24	19.2	20.8
S12S08M026N0310	S12A08M026N0310	26	20.8	22.4
S12S08M028N0310	S12A08M028N0310	28	22.4	24
S12S08M030N0310	S12A08M030N0310	30	24	25.6
S12S08M032N0310	S12A08M032N0310	32	25.6	27.2
S12S08M036N0310	S12A08M036N0310	36	28.8	30.4
S12S08M040N0310	S12A08M040N0310	40	32	33.6
S12S08M042N0310	S12A08M042N0310	42	33.6	35.2
S12S08M044N0310	S12A08M044N0310	44	35.2	36.8
S12S08M048N0310	S12A08M048N0310	48	38.4	40
S12S08M050N0310	S12A08M050N0310	50	40	41.6
S12S08M052N0310	S12A08M052N0310	52	41.6	43.2
S12S08M054N0310	S12A08M054N0310	54	43.2	44.8
S12S08M056N0310	S12A08M056N0310	56	44.8	46.4
S12S08M060N0310	S12A08M060N0310	60	48	49.6
S12S08M064N0310	S12A08M064N0310	64	51.2	52.8
S12S08M066N0310	S12A08M066N0310	66	52.8	54.4
S12S08M070N0310	S12A08M070N0310	70	56	57.6
S12S08M072N0310	S12A08M072N0310	72	57.6	59.2
S12S08M080N0310	S12A08M080N0310	80	64	65.6
S12S08M084N0310	S12A08M084N0310	84	67.2	68.8
S12S08M086N0310	S12A08M086N0310	86	68.8	70.4
S12S08M088N0310	S12A08M088N0310	88	70.4	72
S12S08M092N0310	S12A08M092N0310	92	73.6	75.2
S12S08M096N0310	S12A08M096N0310	96	76.8	78.4
S12S08M120N0310	S12A08M120N0310	120	96	97.6
S12S08M128N0310	S12A08M128N0310	128	102.4	104
S12S08M132N0310	S12A08M132N0310	132	105.6	107.2

*T4 or T351 Aluminum Alloy, anodized before cutting.

Available as special order: 14-1/2° P.A., teeth not listed, different bore size and/or material, passivation for Stainless Steel.

■ ISO CLASS 7

■ 20° PRESSURE ANGLE

■ 5 mm FACE

■ 10 mm BORE

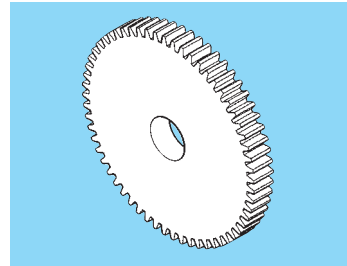
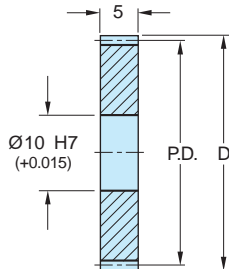

S Precision Component

Catalog Number		No. of Teeth	P.D.	D
303 Stainless Steel	2024 Aluminum* Anodized			
S12N08M020S0510	S12N08M020A0510	20	16	17.6
S12N08M024S0510	S12N08M024A0510	24	19.2	20.8
S12N08M025S0510	S12N08M025A0510	25	20	21.6
S12N08M028S0510	S12N08M028A0510	28	22.4	24
S12N08M032S0510	S12N08M032A0510	32	25.6	27.2
S12N08M036S0510	S12N08M036A0510	36	28.8	30.4
S12N08M040S0510	S12N08M040A0510	40	32	33.6
S12N08M048S0510	S12N08M048A0510	48	38.4	40
S12N08M050S0510	S12N08M050A0510	50	40	41.6
S12N08M054S0510	S12N08M054A0510	54	43.2	44.8
S12N08M056S0510	S12N08M056A0510	56	44.8	46.4
S12N08M060S0510	S12N08M060A0510	60	48	49.6
S12N08M064S0510	S12N08M064A0510	64	51.2	52.8
S12N08M065S0510	S12N08M065A0510	65	52	53.6
S12N08M070S0510	S12N08M070A0510	70	56	57.6
S12N08M072S0510	S12N08M072A0510	72	57.6	59.2
S12N08M075S0510	S12N08M075A0510	75	60	61.6
S12N08M080S0510	S12N08M080A0510	80	64	65.6
S12N08M084S0510	S12N08M084A0510	84	67.2	68.8
S12N08M085S0510	S12N08M085A0510	85	68	69.6
S12N08M090S0510	S12N08M090A0510	90	72	73.6
S12N08M096S0510	S12N08M096A0510	96	76.8	78.4
S12N08M100S0510	S12N08M100A0510	100	80	81.6
S12N08M108S0510	S12N08M108A0510	108	86.4	88
S12N08M110S0510	S12N08M110A0510	110	88	89.6
S12N08M115S0510	S12N08M115A0510	115	92	93.6
S12N08M120S0510	S12N08M120A0510	120	96	97.6
S12N08M126S0510	S12N08M126A0510	126	100.8	102.4
S12N08M128S0510	S12N08M128A0510	128	102.4	104
S12N08M132S0510	S12N08M132A0510	132	105.6	107.2

* T4 or T351 Aluminum Alloy, anodized before cutting.

Available as special order: Number of teeth not listed, different bore size and/or material, passivation for stainless steel.