

■ ISO CLASS 7

■ 20° PRESSURE ANGLE

■ 6 & 8 mm FACE WIDTH

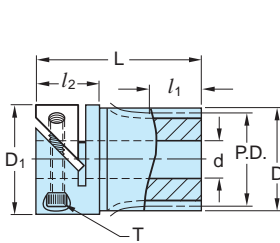

Fig. 1

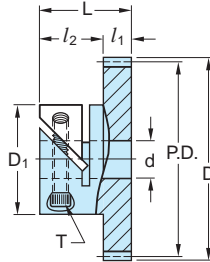
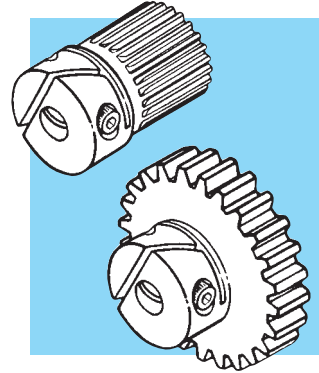

Fig. 2



NOTE: Socket Head Cap Screw Supplied.

MATERIAL: 303 Stainless Steel

**S** Precision Component

Catalog Number	Fig. No.	No. of Teeth	P.D.	D	d* Bore H7	$l_1$ Face Width	L	$D_1$	$l_2$	T	Hub Clear. Rad.
S1VS10M014F0806	1	14	14	16	6	8	25	17	10	M3	11.3
S1VS10M015F0806		15	15	17							
S1VS10M016F0806		16	16	18							
S1VS10M018F0806		18	18	20							
S1VS10M020F0606	2	20	20	22	6	6	16	17	10	M3	11.3
S1VS10M024F0606		24	24	26							
S1VS10M025F0606		25	25	27							
S1VS10M028F0606		28	28	30							
S1VS10M030F0608	2	30	30	32	8	6	16	17	10	M3	11.3
S1VS10M032F0608		32	32	34							
S1VS10M035F0608		35	35	37							
S1VS10M036F0608		36	36	38							
S1VS10M040F0608		40	40	42							
S1VS10M045F0608		45	45	47							
S1VS10M048F0608	48	48	50								
S1VS10M050F0610	2	50	50	52	10	6	20	24	14	M4	14
S1VS10M056F0610		56	56	58							
S1VS10M060F0610		60	60	62							
S1VS10M064F0610		64	64	66							
S1VS10M070F0610		70	70	72							
S1VS10M072F0610		72	72	74							
S1VS10M080F0610		80	80	82							
S1VS10M090F0610		90	90	92							
S1VS10M100F0610		100	100	102							

\*Bore Tolerance: 6 mm + 0.012  
8 & 10 mm + 0.015

Gears larger than 45 teeth have two-piece construction.

■ ISO CLASS 7

■ 20° PRESSURE ANGLE

■ 5 mm FACE

■ 5 mm BORE

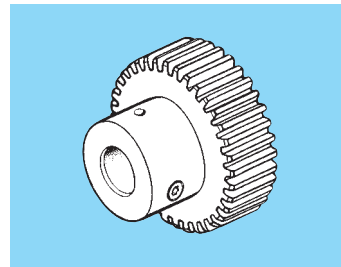
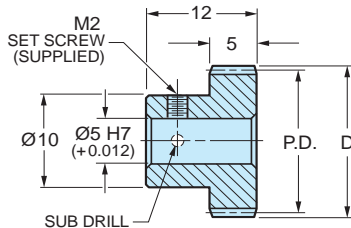
**S** Precision Component

Catalog Number		No. of Teeth	P.D.	D
303 Stainless Steel	2024 Aluminum* Anodized			
S10T10M015S0505	S10T10M015A0505	15	15	17
S10T10M016S0505	S10T10M016A0505	16	16	18
S10T10M018S0505	S10T10M018A0505	18	18	20
S10T10M020S0505	S10T10M020A0505	20	20	22
S10T10M022S0505	S10T10M022A0505	22	22	24
S10T10M024S0505	S10T10M024A0505	24	24	26
S10T10M030S0505	S10T10M030A0505	30	30	32
S10T10M036S0505	S10T10M036A0505	36	36	38
S10T10M042S0505	S10T10M042A0505	42	42	44
S10T10M048S0505	S10T10M048A0505	48	48	50
S10T10M054S0505	S10T10M054A0505	54	54	56
S10T10M060S0505	S10T10M060A0505	60	60	62
S10T10M072S0505	S10T10M072A0505	72	72	74
S10T10M084S0505	S10T10M084A0505	84	84	86
S10T10M096S0505	S10T10M096A0505	96	96	98

\* T4 or T351 Aluminum Alloy, anodized before cutting.

Available as special order: Number of teeth not listed, different bore size and/or material, passivation for stainless steel.

## Did You Know?

...You can obtain additional literature by viewing our "home page" on the INTERNET?

<http://www.sdp-si.com>

■ ISO CLASS 7

■ 20° PRESSURE ANGLE

■ 5 mm FACE

■ 8 mm BORE

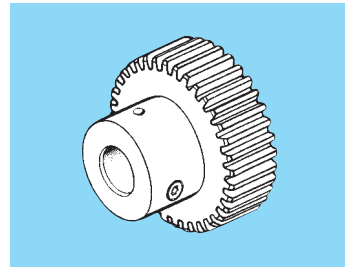
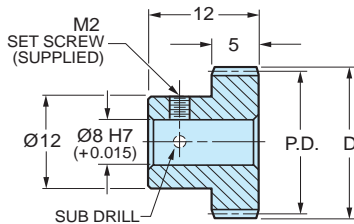

**S** Precision  
Component

Catalog Number		No. of Teeth	P.D.	D
303 Stainless Steel	2024 Aluminum* Anodized			
S10T10M012S0508	S10T10M012A0508	12	12	14
S10T10M015S0508	S10T10M015A0508	15	15	17
S10T10M016S0508	S10T10M016A0508	16	16	18
S10T10M018S0508	S10T10M018A0508	18	18	20
S10T10M020S0508	S10T10M020A0508	20	20	22
S10T10M021S0508	S10T10M021A0508	21	21	23
S10T10M022S0508	S10T10M022A0508	22	22	24
S10T10M024S0508	S10T10M024A0508	24	24	26
S10T10M027S0508	S10T10M027A0508	27	27	29
S10T10M030S0508	S10T10M030A0508	30	30	32
S10T10M033S0508	S10T10M033A0508	33	33	35
S10T10M036S0508	S10T10M036A0508	36	36	38
S10T10M042S0508	S10T10M042A0508	42	42	44
S10T10M045S0508	S10T10M045A0508	45	45	47
S10T10M048S0508	S10T10M048A0508	48	48	50
S10T10M051S0508	S10T10M051A0508	51	51	53
S10T10M054S0508	S10T10M054A0508	54	54	56
S10T10M057S0508	S10T10M057A0508	57	57	59
S10T10M060S0508	S10T10M060A0508	60	60	62
S10T10M063S0508	S10T10M063A0508	63	63	65
S10T10M066S0508	S10T10M066A0508	66	66	68
S10T10M069S0508	S10T10M069A0508	69	69	71
S10T10M072S0508	S10T10M072A0508	72	72	74
S10T10M075S0508	S10T10M075A0508	75	75	77
S10T10M078S0508	S10T10M078A0508	78	78	80
S10T10M081S0508	S10T10M081A0508	81	81	83
S10T10M084S0508	S10T10M084A0508	84	84	86
S10T10M087S0508	S10T10M087A0508	87	87	89
S10T10M090S0508	S10T10M090A0508	90	90	92
S10T10M096S0508	S10T10M096A0508	96	96	98

\* T4 or T351 Aluminum Alloy, anodized before cutting.

Available as special order: Number of teeth not listed, different bore size and/or material, passivation for stainless steel.

■ ISO CLASS 7

■ 20° PRESSURE ANGLE

■ 10 mm FACE

■ 8 mm BORE

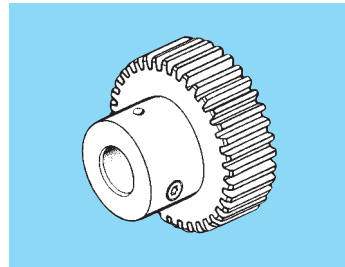
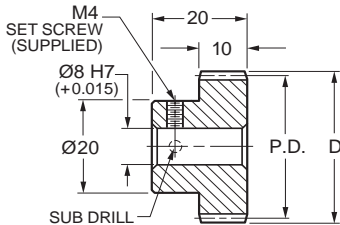

**S** Precision  
Component

MATERIAL: 303 Stainless Steel

Catalog Number	No. of Teeth	P.D.	D
S10T10M015S1008	15	15	17
S10T10M016S1008	16	16	18
S10T10M018S1008	18	18	20
S10T10M020S1008	20	20	22
S10T10M022S1008	22	22	24
S10T10M024S1008	24	24	26
S10T10M025S1008	25	25	27
S10T10M028S1008	28	28	30
S10T10M030S1008	30	30	32
S10T10M032S1008	32	32	34
S10T10M035S1008	35	35	37
S10T10M036S1008	36	36	38

Available as special order: Number of teeth not listed, different bore size and/or material, passivation.

## Did You Know?

... **SDP/SI's ON-LINE** computer system was designed with customer service in mind! It provides instantaneous information on:

- Availability of inventory
- Status of customer orders
- Quantity pricing
- Allocation of materials
- Status of production releases

■ ISO CLASS 7

■ 20° PRESSURE ANGLE

■ 10 mm FACE

■ 10 mm BORE

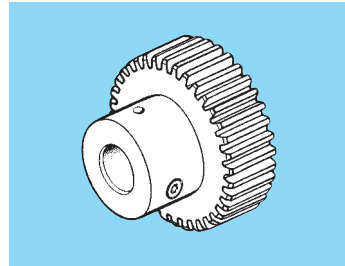
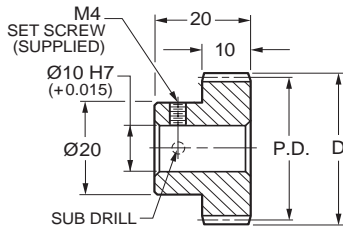

**S** Precision  
Component

MATERIAL: 303 Stainless Steel

Catalog Number	No. of Teeth	P.D.	D
S10T10M036S1010	36	36	38
S10T10M040S1010	40	40	42
S10T10M042S1010	42	42	44
S10T10M045S1010	45	45	47
S10T10M048S1010	48	48	50
S10T10M050S1010	50	50	52
S10T10M055S1010	55	55	57
S10T10M056S1010	56	56	58
S10T10M060S1010	60	60	62
S10T10M064S1010	64	64	66
S10T10M070S1010	70	70	72
S10T10M075S1010	75	75	77
S10T10M080S1010	80	80	82
S10T10M090S1010	90	90	92
S10T10M096S1010	96	96	98

Available as special order: Number of teeth not listed, different bore size and/or material, passivation.

## Did You Know?

...That SUPER-PLAST® plastic gears reinforced with metal inserts are available from stock exclusively from SDP?



■ ISO CLASS 8

■ 20° PRESSURE ANGLE

■ 6 & 8 mm FACE WIDTH

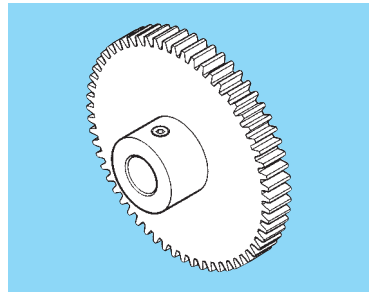
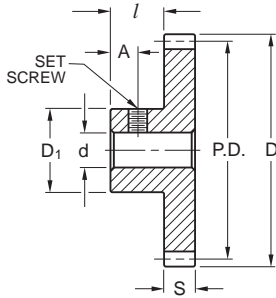

**QUALITY CLASS**

GEARS

1

MATERIAL: Steel

Catalog Number	No. of Teeth	P.D.	D	d* Bore H7	S Face Width	D <sub>1</sub> Hub Dia.	l Hub Proj.	A	Set Screw
A 1C 2MYK10018	18	18	20	6	8	14	8	4	M4
A 1C 2MYK10020H	20	20	22	6 8	8	16	8	4	
A 1C 2MYK10020A									
A 1C 2MYK10024	24	24	26	8	8	16	8	4	
A 1C 2MYK10025	25	25	27						
A 1C 2MYK10028	28	28	30						
A 1C 2MYK10030	30	30	32	10	6	20	10	5	M5
A 1C 2MYK10032H	32	32	34						
A 1C 2MYK10035H	35	35	37						
A 1C 2MYK10036H	36	36	38						
A 1C 2MYK10040H	40	40	42						
A 1C 2MYK10045H	45	45	47						
A 1C 2MYK10048H	48	48	50						
A 1C 2MYK10050	50	50	52						
A 1C 2MYK10056	56	56	58						
A 1C 2MYK10060H	60	60	62						
A 1C 2MYK10064	64	64	66						
A 1C 2MYK10072	72	72	74						
A 1C 2MYK10080H	80	80	82						
A 1C 2MYK10100H	100	100	102						
A 1C 2MYK10120H	120	120	122						

\*Bore Tolerance: 6 mm + 0.012  
8 & 10 mm + 0.015



■ ISO CLASS 8

■ 20° PRESSURE ANGLE

■ 10 & 12 mm FACE WIDTH

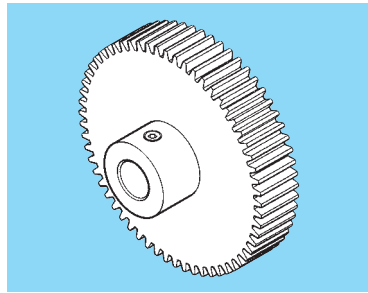
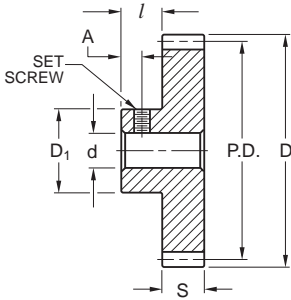

**QUALITY CLASS**

MATERIAL: Steel

Catalog Number	No. of Teeth	P.D.	D	d* Bore H7	S Face Width	D <sub>1</sub> Hub Dia.	l Hub Proj.	A	Set Screw
A 1C 2MYKW10018	18	18	20	8	10	15	10	5	M5
A 1C 2MYKX10020	20	20	22	8	12	16	8	4	M4
A 1C 2MYKW10020					10	16	10	5	M5
A 1C 2MYKX10024	24	24	26	8	12	16	8	4	M4
A 1C 2MYKW10024					10	20	10	5	M5
A 1C 2MYKX10025	25	25	27	8	12	16	8	4	M4
A 1C 2MYKW10025					10	20	10	5	M5
A 1C 2MYKX10028H	28	28	30	10	12	20	8	4	M4
A 1C 2MYKW10028H					10	24	10	5	M5
A 1C 2MYKX10030H	30	30	32	10	12	20	8	4	M4
A 1C 2MYKW10030					10	25	10	5	M5
A 1C 2MYKW10032H	32	32	34	10	10	20	10	5	M5
A 1C 2MYKW10035H	35	35	37						
A 1C 2MYKW10036H	36	36	38						
A 1C 2MYKW10040H	40	40	42						
A 1C 2MYKW10045H	45	45	47						
A 1C 2MYKW10048H	48	48	50						
A 1C 2MYKW10050H	50	50	52						
A 1C 2MYKW10056	56	56	58						
A 1C 2MYKW10060H	60	60	62						
A 1C 2MYKW10064	64	64	66						
A 1C 2MYKW10072	72	72	74						
A 1C 2MYKW10080H	80	80	82						
A 1C 2MYKW10100H	100	100	102	12	10	24	10	5	M5
A 1C 2MYKW10120H	120	120	122						

\*Bore Tolerance: 8 & 10 mm + 0.015  
12 mm + 0.018

See also "Pinions - Module 1".



■ ISO CLASS 8

■ 20° PRESSURE ANGLE  
■ WITH KEYWAY

■ 6 & 10 mm FACE WIDTH

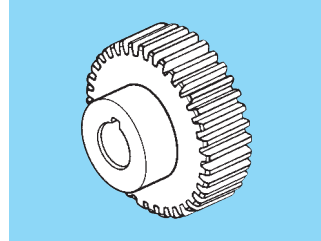
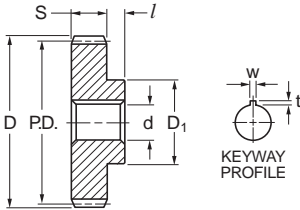

**QUALITY CLASS**

1 GEARS

MATERIAL: Steel

Catalog Number	No. of Teeth	P.D.	D	d* Bore H7	S Face Width	D <sub>1</sub> Hub Dia.	l Hub Proj.	w	t
ΔA 1C22MYK10050	50	50	52	12	6	22.4	5.2	4	1.8
ΔA 1C22MYKW10050				14	10	25	4	3	1.4
ΔA 1C22MYK10060	60	60	62	12	6	22.4	5.2	4	1.8
ΔA 1C22MYKW10060				14	10	25	4	3	1.4
ΔA 1C22MYK10080	80	80	82	14	6	25	5.2	3	1.4
ΔA 1C22MYKW10080				16	10	30	6	4	1.8
ΔA 1C22MYK10100	100	100	102	14	6	25	8	3	1.4
ΔA 1C22MYK10120				120	120	14	6	25	8

\* Bore Tolerance: 12, 14 & 16 mm + 0.018

Δ To be discontinued when present stock is depleted.

### Did You Know?

... That the selection of components for this catalog was done by engineers...for engineers? It is our aim to enable the designer to spend their time designing rather than looking for components.

■ ISO CLASS 8

■ 20° PRESSURE ANGLE

■ 8 mm FACE WIDTH

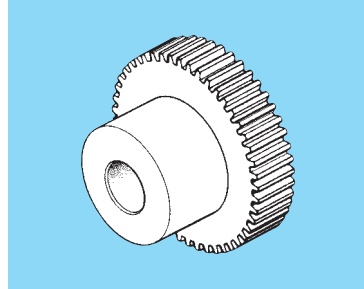
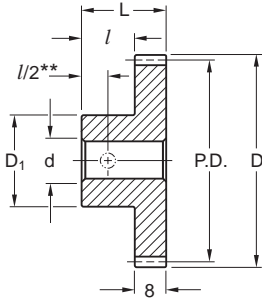

### CATALOG NUMBER DESIGNATION:

**QUALITY CLASS**

#### Material Code

Brass ASTM 8A

Steel SAE 1109

Stainless Steel AISI 416

Prehardened to Rc25

A 1  2 M Y 1 0

B ————

C ————

Y ————

No. of Teeth

Number of Teeth	P.D.	D	d* Bore H8	L Length	D <sub>1</sub> Hub Dia.	l Hub Proj.	Set** Screw	Sub** Drill
15	15	17	8	22	12	14	M4	2.3
20	20	22			16			
25	25	27			21			
30	30	32	10	22	25	14	M5	2.8
35	35	37						
40	40	42						
45	45	47						
50	50	52						
55	55	57	10	22	25	14	M5	2.8
60	60	62						
63	63	65						
65	65	67						
70	70	72	10	22	25	14	M5	2.8
75	75	77						
80	80	82						
85	85	87						
90	90	92						
95	95	97	12	24	32	16	M6	3.75
100	100	102						
120	120	122						

\*Bore Tolerance: 8 & 10 mm + 0.022  
12 mm + 0.027

\*\*NOTE: Gears are sold without set screw and sub drill holes. They are shown for information only and are supplied as a special order.

■ ISO CLASS 7

■ 20° PRESSURE ANGLE

■ 3 mm FACE

■ 10 mm BORE

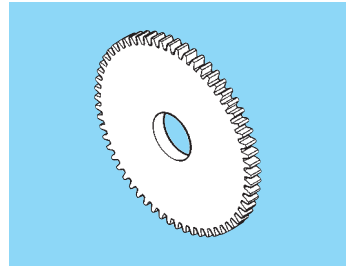
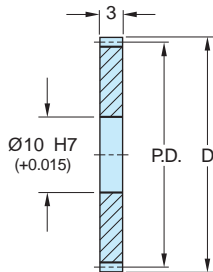

S Precision Component

Catalog Number		No. of Teeth	P.D.	D
303 Stainless Steel	2024 Aluminum* Anodized			
S12N10M018S0310	S12N10M018A0310	18	18	20
S12N10M020S0310	S12N10M020A0310	20	20	22
S12N10M022S0310	S12N10M022A0310	22	22	24
S12N10M024S0310	S12N10M024A0310	24	24	26
S12N10M025S0310	S12N10M025A0310	25	25	27
S12N10M027S0310	S12N10M027A0310	27	27	29
S12N10M028S0310	S12N10M028A0310	28	28	30
S12N10M030S0310	S12N10M030A0310	30	30	32
S12N10M032S0310	S12N10M032A0310	32	32	34
S12N10M035S0310	S12N10M035A0310	35	35	37
S12N10M036S0310	S12N10M036A0310	36	36	38
S12N10M040S0310	S12N10M040A0310	40	40	42
S12N10M042S0310	S12N10M042A0310	42	42	44
S12N10M045S0310	S12N10M045A0310	45	45	47
S12N10M048S0310	S12N10M048A0310	48	48	50
S12N10M050S0310	S12N10M050A0310	50	50	52
S12N10M054S0310	S12N10M054A0310	54	54	56
S12N10M056S0310	S12N10M056A0310	56	56	58
S12N10M060S0310	S12N10M060A0310	60	60	62
S12N10M064S0310	S12N10M064A0310	64	64	66
S12N10M065S0310	S12N10M065A0310	65	65	67
S12N10M070S0310	S12N10M070A0310	70	70	72
S12N10M072S0310	S12N10M072A0310	72	72	74
S12N10M075S0310	S12N10M075A0310	75	75	77
S12N10M080S0310	S12N10M080A0310	80	80	82
S12N10M084S0310	S12N10M084A0310	84	84	86
S12N10M085S0310	S12N10M085A0310	85	85	87
S12N10M090S0310	S12N10M090A0310	90	90	92
S12N10M096S0310	S12N10M096A0310	96	96	98
S12N10M100S0310	S12N10M100A0310	100	100	102

\* T4 or T351 Aluminum Alloy, anodized before cutting.

Available as special order: Number of teeth not listed, different bore size and/or material, passivation for stainless steel.



■ ISO CLASS 7

■ 20° PRESSURE ANGLE

■ 5 mm FACE

■ 10 mm BORE

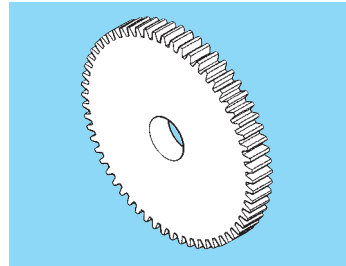
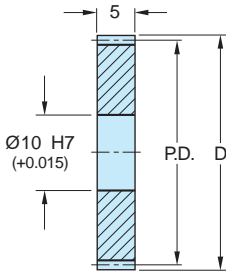

S Precision Component

Catalog Number		No. of Teeth	P.D.	D
303 Stainless Steel	2024 Aluminum* Anodized			
S12N10M018S0510	S12N10M018A0510	18	18	20
S12N10M020S0510	S12N10M020A0510	20	20	22
S12N10M022S0510	S12N10M022A0510	22	22	24
S12N10M024S0510	S12N10M024A0510	24	24	26
S12N10M025S0510	S12N10M025A0510	25	25	27
S12N10M027S0510	S12N10M027A0510	27	27	29
S12N10M028S0510	S12N10M028A0510	28	28	30
S12N10M030S0510	S12N10M030A0510	30	30	32
S12N10M032S0510	S12N10M032A0510	32	32	34
S12N10M035S0510	S12N10M035A0510	35	35	37
S12N10M036S0510	S12N10M036A0510	36	36	38
S12N10M040S0510	S12N10M040A0510	40	40	42
S12N10M042S0510	S12N10M042A0510	42	42	44
S12N10M045S0510	S12N10M045A0510	45	45	47
S12N10M048S0510	S12N10M048A0510	48	48	50
S12N10M050S0510	S12N10M050A0510	50	50	52
S12N10M054S0510	S12N10M054A0510	54	54	56
S12N10M056S0510	S12N10M056A0510	56	56	58
S12N10M060S0510	S12N10M060A0510	60	60	62
S12N10M064S0510	S12N10M064A0510	64	64	66
S12N10M065S0510	S12N10M065A0510	65	65	67
S12N10M070S0510	S12N10M070A0510	70	70	72
S12N10M072S0510	S12N10M072A0510	72	72	74
S12N10M075S0510	S12N10M075A0510	75	75	77
S12N10M080S0510	S12N10M080A0510	80	80	82
S12N10M084S0510	S12N10M084A0510	84	84	86
S12N10M085S0510	S12N10M085A0510	85	85	87
S12N10M090S0510	S12N10M090A0510	90	90	92
S12N10M096S0510	S12N10M096A0510	96	96	98
S12N10M100S0510	S12N10M100A0510	100	100	102

\* T4 or T351 Aluminum Alloy, anodized before cutting.

Available as special order: Number of teeth not listed, different bore size and/or material, passivation for stainless steel.



■ ISO CLASS 8

■ 20° PRESSURE ANGLE

■ 6 & 8 mm FACE WIDTH

1

GEARS

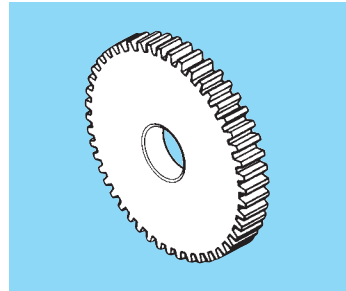
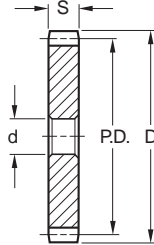

**QUALITY CLASS**

MATERIAL: Steel

Catalog Number	No. of Teeth	P.D.	D	d* Bore H7	S Face Width
A 1C 1MYK10014S	14	14	16	5	8
A 1C 1MYK10014				6	
A 1C 1MYK10015S	15	15	17	5	
A 1C 1MYK10015				6	
A 1C 1MYK10016S	16	16	18	5	
A 1C 1MYK10016				6	
A 1C 1MYK10018S	18	18	20	5	
A 1C 1MYK10018				6	
A 1C 1MYK10020	20	20	22	6	
A 1C 1MYK10024S	24	24	26	6	
A 1C 1MYK10024				8	
A 1C 1MYK10025S	25	25	27	6	
A 1C 1MYK10025				8	
A 1C 1MYK10028S	28	28	30	6	
A 1C 1MYK10028				8	
A 1C 1MYK10030	30	30	32	8	
A 1C 1MYK10032	32	32	34	8	6
A 1C 1MYK10035	35	35	37		
A 1C 1MYK10036	36	36	38		
A 1C 1MYK10040S	40	40	42		
A 1C 1MYK10045S	45	45	47	10	6
A 1C 1MYK10048S	48	48	50		
A 1C 1MYK10050	50	50	52		
A 1C 1MYK10056	56	56	58		
A 1C 1MYK10060	60	60	62	10	6
A 1C 1MYK10064	64	64	66		
A 1C 1MYK10072	72	72	74		
A 1C 1MYK10080	80	80	82		
A 1C 1MYK10100	100	100	102	10	6
A 1C 1MYK10120	120	120	122		

\*Bore Tolerance: 5 & 6 mm + 0.012  
8 & 10 mm + 0.015



■ ISO CLASS 8

■ 20° PRESSURE ANGLE  
■ WITH KEYWAY

■ 6 & 10 mm FACE WIDTH

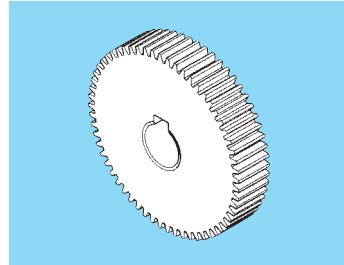
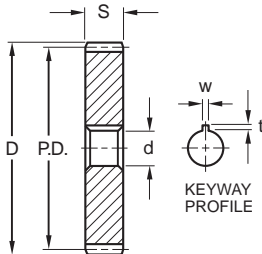

**QUALITY CLASS**

MATERIAL: Steel

Catalog Number	No. of Teeth	P.D.	D	d* Bore H7	S Face Width	w	t
<b>6 mm FACE WIDTH</b>							
A 1C11MYK10040K	40	40	42	10	6	3	1.4
A 1C11MYK10045K	45	45	47				
A 1C11MYK10048K	48	48	50				
ΔA 1C11MYK10050	50	50	52	12	6	3	1.4
A 1C11MYK10050K						4	1.8
ΔA 1C11MYK10060	60	60	62	12	6	3	1.4
A 1C11MYK10060K						4	1.8
ΔA 1C11MYK10080	80	80	82	14	6	3	1.4
A 1C11MYK10080K						5	2.3
ΔA 1C11MYK10100	100	100	102	14	6	3	1.4
A 1C11MYK10100K						5	2.3
A 1C11MYK10120L	120	120	122	16	6	5	2.3

<b>10 mm FACE WIDTH</b>							
A 1C11MYKW10030	30	30	32	10	10	3	1.4
A 1C11MYKW10032K	32	32	34	10			
A 1C11MYKW10035K	35	35	37		10	10	3
A 1C11MYKW10036K	36	36	38				
A 1C11MYKW10040	40	40	42	10	10	3	1.4
A 1C11MYKW10045K	45	45	47				
A 1C11MYKW10050S	50	50	52	14	10	3	1.4
ΔA 1C11MYKW10050	50	50	52				
A 1C11MYKW10060S	60	60	62	10	10	3	1.4
ΔA 1C11MYKW10060				14		3	1.4
ΔA 1C11MYKW10060K	60	60	62	14	10	5	2.3
A 1C11MYKW10080S				10		3	1.4
ΔA 1C11MYKW10080K	80	80	82	16	10	3	1.4
A 1C11MYKW10080L				16		5	2.3
A 1C11MYKW10100S	100	100	102	10	10	3	1.4
A 1C11MYKW10100L				16		5	2.3
A 1C11MYKW10120S	120	120	122	10	10	3	1.4
ΔA 1C11MYKW10120K				16		4	1.8
A 1C11MYKW10120L	16	5	2.3				

Δ To be discontinued when present stock is depleted.

\*Bore Tolerance: 10 mm +0.015  
12, 14 & 16 mm +0.018



■ ISO CLASS 8

■ 20° PRESSURE ANGLE

■ 10 & 12 mm FACE WIDTH

1

GEARS

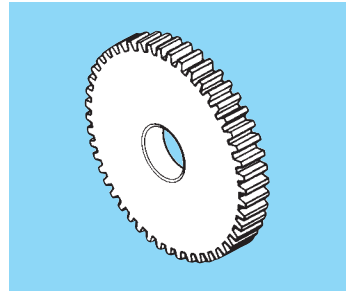
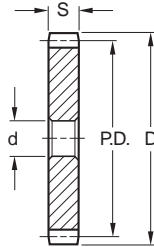

**QUALITY CLASS**

MATERIAL: Steel

Catalog Number	No. of Teeth	P.D.	D	d* Bore H7	S Face Width
A 1C 1MYKW10015	15	15	17	6	12
A 1C 1MYKW10016	16	16	18		
A 1C 1MYKW10018	18	18	20		
A 1C 1MYKW10020	20	20	22		
A 1C 1MYKW10024	24	24	26	8	12
A 1C 1MYKW10025	25	25	27		
A 1C 1MYKW10028B	28	28	30		
A 1C 1MYKW10030B	30	30	32		
A 1C 1MYKW10032S	32	32	34		
A 1C 1MYKW10035S	35	35	37		
A 1C 1MYKW10036S	36	36	38	8	10
A 1C 1MYKW10040S	40	40	42		
A 1C 1MYKW10045S	45	45	47		
A 1C 1MYKW10048	48	48	50		
A 1C 1MYKW10056	56	56	58	10	10
A 1C 1MYKW10064	64	64	66		
A 1C 1MYKW10072	72	72	74		

\*Bore Tolerance: 6 mm +0.012  
8 & 10 mm +0.015

### Did You Know?

... We have a staff of experienced engineers who will gladly assist you with your design problems. Call between 9 AM and 5 PM E.S.T. or fax anytime.

**CALL: 516-328-3300**

**or FAX: 516-328-9029**