

■ ISO CLASS 7 ■ 20° PRESSURE ANGLE ■ 10 mm FACE ■ 10 mm BORE

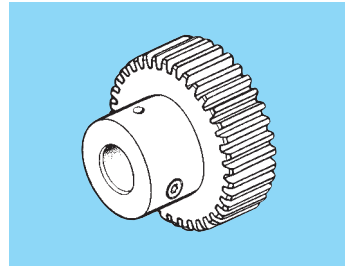
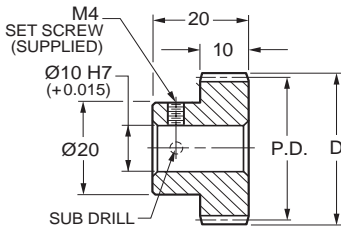

S Precision Component

MATERIAL: 303 Stainless Steel

Catalog Number	No. of Teeth	P.D.	D
S10T12M014S1010	14	17.5	20
S10T12M015S1010	15	18.75	21.25
S10T12M016S1010	16	20	22.5
S10T12M018S1010	18	22.5	25
S10T12M020S1010	20	25	27.5
S10T12M024S1010	24	30	32.5
S10T12M025S1010	25	31.25	33.75
S10T12M028S1010	28	35	37.5
S10T12M030S1010	30	37.5	40
S10T12M035S1010	35	43.75	46.25
S10T12M036S1010	36	45	47.5
S10T12M040S1010	40	50	52.5
S10T12M045S1010	45	56.25	58.75
S10T12M048S1010	48	60	62.5
S10T12M050S1010	50	62.5	65
S10T12M056S1010	56	70	72.5
S10T12M060S1010	60	75	77.5
S10T12M070S1010	70	87.5	90
S10T12M072S1010	72	90	92.5
S10T12M080S1010	80	100	102.5
S10T12M084S1010	84	105	107.5

Available as special order: Number of teeth not listed, different bore size and/or material, passivation.

Did You Know?

That the Bearing Section of this catalog contains ball bearings and oil impregnated sintered bronze bearings in addition to many linear bearings and pillow blocks?

■ ISO CLASS 7 ■ 20° PRESSURE ANGLE ■ 10 mm FACE ■ 12 mm BORE

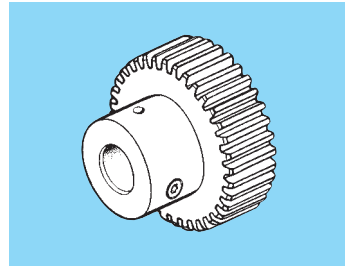
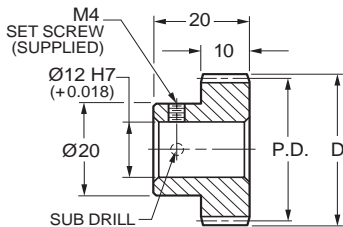

S Precision
Component

MATERIAL: 303 Stainless Steel

Catalog Number	No. of Teeth	P.D.	D
S10T12M024S1012	24	30	32.5
S10T12M025S1012	25	31.25	33.75
S10T12M030S1012	30	37.5	40
S10T12M035S1012	35	43.75	46.25
S10T12M040S1012	40	50	52.5
S10T12M045S1012	45	56.25	58.75
S10T12M050S1012	50	62.5	65
S10T12M060S1012	60	75	77.5
S10T12M070S1012	70	87.5	90
S10T12M080S1012	80	100	102.5

Available as special order: Number of teeth not listed, different bore size and/or material, passivation.

Did You Know?

... That pricing for any component in this catalog is available through the Sales Department? Simply call, fax or write in your request for a quote for any component that you think you might want to use in your design.

CALL: 516-328-3300

or FAX: 516-326-8827

■ ISO CLASS 7

■ 20° PRESSURE ANGLE

■ 10 mm FACE

■ 16 mm BORE

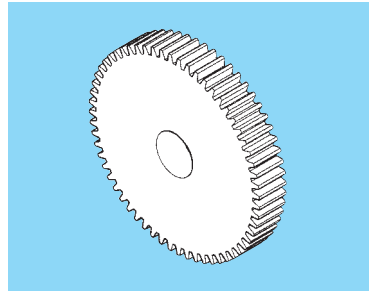
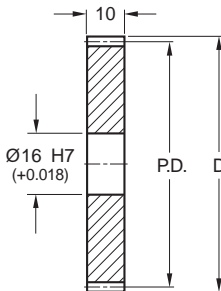

MATERIAL: 303 Stainless Steel

Catalog Number	No. of Teeth	P.D.	D
S12N12M024S1016	24	30	32.5
S12N12M025S1016	25	31.25	33.75
S12N12M030S1016	30	37.5	40
S12N12M035S1016	35	43.75	46.25
S12N12M040S1016	40	50	52.5
S12N12M045S1016	45	56.25	58.75
S12N12M050S1016	50	62.5	65
S12N12M060S1016	60	75	77.5
S12N12M070S1016	70	87.5	90
S12N12M080S1016	80	100	102.5

Available as special order: Number of teeth not listed, different bore size and/or material, passivation.

Did You Know?

... That our inch size gears are offered in 120 Diametral Pitch to 16 Diametral Pitch?
See section 1 in our **Inch Drive Components Catalog 787**.