



■ ISO CLASS 8

■ 20° PRESSURE ANGLE

■ 10 & 12 mm FACE WIDTH

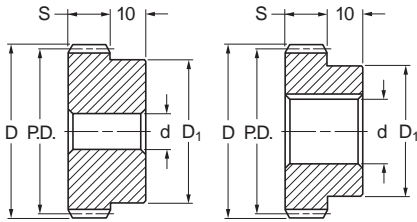
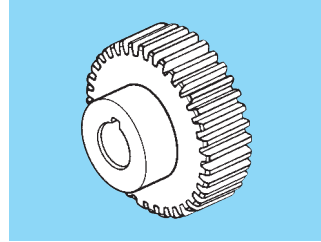

Fig. 1

Fig. 2



QUALITY CLASS

FIG. 1 • WITHOUT KEYWAY

MATERIAL: Steel

Catalog Number	No. of Teeth	P.D.	D	d* Bore H7	S Face Width	D ₁ Hub Dia.
A 1C 2MYK15015	15	22.5	25.5	8	12	18
A 1C 2MYK15016	16	24	27			20
A 1C 2MYK15018	18	27	30	10	12	22
A 1C 2MYK15020	20	30	33			25
A 1C 2MYK15024	24	36	39			30
A 1C 2MYK15025B	25	37.5	40.5			32
A 1C 2MYK15028B	28	42	45	10	12	36
A 1C 2MYK15030B	30	45	48			40
A 1C 2MYK15032B	32	48	51	12	10	40
A 1C 2MYK15036B	36	54	57			50
A 1C 2MYK15040B	40	60	63	12	10	50
A 1C 2MYK15048B	48	72	75			
A 1C 2MYK15050B	50	75	78			
A 1C 2MYK15056	56	84	87	14	10	50
A 1C 2MYK15060	60	90	93			
A 1C 2MYK15064	64	96	99			
A 1C 2MYK15070	70	105	108			
A 1C 2MYK15072B	72	108	111	16	10	50
A 1C 2MYK15080	80	120	123			60
A 1C 2MYK15100	100	150	153			60

FIG. 2 • WITH KEYWAY

MATERIAL: Steel

Catalog Number	No. of Teeth	P.D.	D	d* Bore H7	S Face Width	D ₁ Hub Dia.	w	t
A 1C22MYK15025A	25	37.5	40.5	16	12	32	5	2.3
A 1C22MYK15028A	28	42	45	18	12	32	6	2.8
A 1C22MYK15030A	30	45	48	18	10	36	5	2.3
A 1C22MYK15032A	32	48	51	16	10	32	5	2.3
A 1C22MYK15040A	40	60	63	18	10	36	6	2.8
A 1C22MYK15048A	48	72	75	18	10	36	6	2.8
A 1C22MYK15050A	50	75	78	18	10	36	6	2.8
A 1C22MYK15056A	56	84	87	16	10	32	5	2.3
A 1C22MYK15060A	60	90	93	18	10	36	6	2.8
A 1C22MYK15064A	64	96	99	16	10	32	5	2.3
A 1C22MYK15070A	70	105	108	16	10	32	5	2.3
A 1C22MYK15072A	72	108	111	18	10	36	6	2.8
A 1C22MYK15100A	100	150	153	20	10	40	6	2.8

*Bore Tolerance: 8 & 10 mm + 0.015
 12, 14, 16 & 18 mm + 0.018
 20 mm + 0.021

These gears are made using STANDARDIZED BLANK SIZES, and are not available from stock. Due to availability of blanks, however, delivery is short.

- ISO CLASS 8 ■ 20° PRESSURE ANGLE ■ 12 mm FACE ■ 10 mm BORE

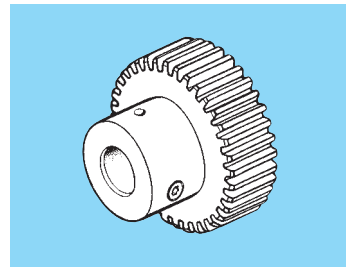
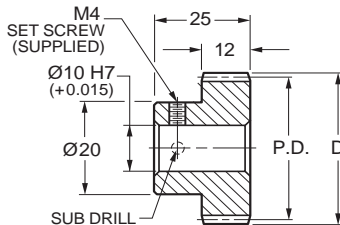
QUALITY CLASS
MATERIAL: 303 Stainless Steel

Catalog Number	No. of Teeth	P.D.	D
S10T15M018S1210	18	27	30
S10T15M020S1210	20	30	33
S10T15M024S1210	24	36	39
S10T15M028S1210	28	42	45
S10T15M030S1210	30	45	48
S10T15M032S1210	32	48	51
S10T15M036S1210	36	54	57
S10T15M040S1210	40	60	63
S10T15M042S1210	42	63	66
S10T15M045S1210	45	67.5	70.5
S10T15M048S1210	48	72	75
S10T15M050S1210	50	75	78
S10T15M056S1210	56	84	87
S10T15M060S1210	60	90	93
S10T15M064S1210	64	96	99

Available as special order: Number of teeth not listed, different bore size and/or material, passivation.

Did You Know?

... That there are dozens of **NEW** products in this catalog that were not offered in our previous **METRIC** catalog **777**! Some of them are Hydro-Dynamic Pressure Bearings, Magnetic Particle Slip Clutches, Neo-Flex Couplings and more! Look for the pages with **NEW** at top.

■ ISO CLASS 8 ■ 20° PRESSURE ANGLE ■ 12 mm FACE ■ 12 mm BORE

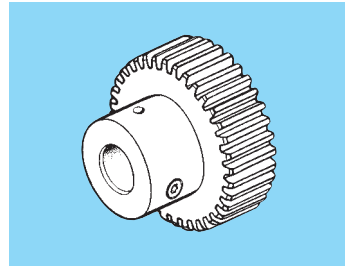
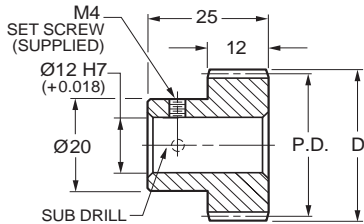

QUALITY CLASS

MATERIAL: 303 Stainless Steel

Catalog Number	No. of Teeth	P.D.	D
S10T15M018S1212	18	27	30
S10T15M020S1212	20	30	33
S10T15M024S1212	24	36	39
S10T15M028S1212	28	42	45
S10T15M030S1212	30	45	48
S10T15M032S1212	32	48	51
S10T15M036S1212	36	54	57
S10T15M040S1212	40	60	63
S10T15M042S1212	42	63	66
S10T15M045S1212	45	67.5	70.5
S10T15M048S1212	48	72	75
S10T15M050S1212	50	75	78
S10T15M056S1212	56	84	87
S10T15M060S1212	60	90	93
S10T15M064S1212	64	96	99

Available as special order: Number of teeth not listed, different bore size and/or material, passivation.

Did You Know?

... That Frelon® Lined Linear Bearings in Section 5 offer low cost alternatives to recirculating ball linear bearings?



■ ISO CLASS 8

■ 20° PRESSURE ANGLE

■ 16 & 18 mm FACE WIDTH

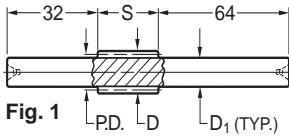

Fig. 1

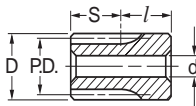

Fig. 2

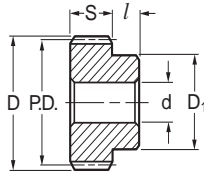
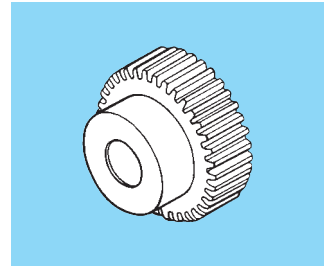

Fig. 3



QUALITY CLASS

1 GEARS

• **WITHOUT KEYWAY**

MATERIAL: Steel

Catalog Number	Fig. No.	No. of Teeth	P.D.	D	d* Bore	S Face Width	D ₁ Dim.	l Hub Proj.
A 1C 8MYK15008L	1	8	**	15.96	—	18	9(h8)*	—
A 1C 8MYK15010L		10	**	19	—		12(h8)*	—
A 1C 8MYK15012	2	12	18	21	8(H8)	18	—	—
A 1C 8MYK15014		14	21	24			22	
A 1C 2MYKW15015	3	15	22.5	25.5	8(H8)	18	18	14
A 1C 2MYKW15016		16	24	27			20	
A 1C 2MYKW15018		18	27	30			22	
A 1C 2MYKW15020		20	30	33			25	
A 1C 2MYKW15024		24	36	39	10(H8)	18	30	14
A 1C 2MYKW15025B		25	37.5	40.5			32	
A 1C 2MYKW15028B		28	42	45			36	
A 1C 2MYKW15030B		30	45	48			40	
A 1C 2MYKW15032B		32	48	51	12(H7)	16	44	14
A 1C 2MYKW15036B		36	54	57			48	
A 1C 2MYKW15040B		40	60	63			52	
A 1C 2MYKW15048B		48	72	75			60	
A 1C 2MYKW15050B		50	75	78	15(H7)	16	60	14
A 1C 2MYKW15056		56	84	87			64	
A 1C 2MYKW15060B		60	90	93			68	
A 1C 2MYKW15064		64	96	99			72	
A 1C 2MYKW15070B	70	105	108	16(H7)	16	60	14	
A 1C 2MYKW15072	72	108	111			64		
A 1C 2MYKW15080B	80	120	123			72		
A 1C 2MYKW15100B	100	150	153			90		

*Bore Tolerance: 8 & 10 mm +0.022
12, 15, 16 & 18 mm +0.018

Shaft Tolerance: 9 mm -0.022
12 mm -0.027

** To obtain additional tooth strength these pinions are produced by shifting the tooth profile which results in a long addendum. The center distance for these pinions has to be increased, therefore please consult our Engineering Department.

These gears are made using STANDARDIZED BLANK SIZES, and are not available from stock. Due to availability of blanks, however, delivery is short.



■ ISO CLASS 8

■ 20° PRESSURE ANGLE

■ 16 & 18 mm FACE WIDTH

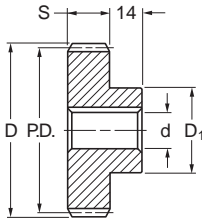

Fig. 1

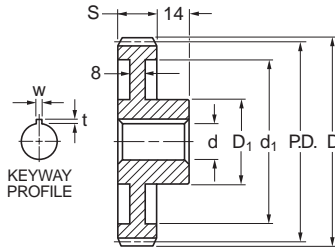
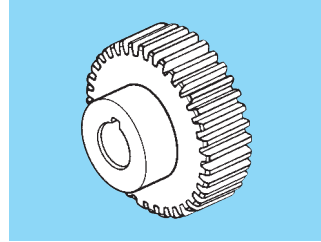

Fig. 2



QUALITY CLASS

● WITH KEYWAY

MATERIAL: Steel

Catalog Number	Fig. No.	No. of Teeth	P.D.	D	d* Bore H7	S Face Width	D ₁ Hub Dia.	d ₁ Dia.	w	t
A 1C22MYKW15024A	1	24	36	39	16	18	30	—	5	2.3
A 1C22MYKW15025A		25	37.5	40.5	18	18	32	—	6	2.8
A 1C22MYKW15028A		28	42	45	18	18	36	—	6	2.8
A 1C22MYKW15030A		30	45	48	20	16	40	—	6	2.8
A 1C22MYKW15032A		32	48	51	20	16	40	—	6	2.8
A 1C22MYKW15036A		36	54	57	20	16	40	—	6	2.8
A 1C22MYKW15040A		40	60	63	20	16	40	—	6	2.8
A 1C22MYKW15048A		48	72	75	20	16	40	—	6	2.8
A 1C22MYKW15050A		50	75	78	20	16	40	—	6	2.8
A 1C22MYKW15056A		56	84	87	20	16	40	—	6	2.8
A 1C22MYKW15060A	2	60	90	93	20	16	40	76	6	2.8
A 1C22MYKW15064A		64	96	99	20	16	40	82	6	2.8
A 1C22MYKW15070A		70	105	108	20	16	40	91	6	2.8
A 1C22MYKW15072A		72	108	111	20	16	40	94	6	2.8
A 1C22MYKW15080A		80	120	123	25	16	50	106	8	3.3
A 1C22MYKW15100A		100	150	153	25	16	50	136	8	3.3

*Bore Tolerance: 14, 16 & 18 mm + 0.018
20 & 25 mm + 0.021

These gears are made using STANDARDIZED BLANK SIZES, and are not available from stock. Due to availability of blanks, however, delivery is short.

Did You Know?

... That the gears featured in this catalog are available in both prototype as well as production quantities?

■ ISO CLASS 8

■ 20° PRESSURE ANGLE

■ 10 mm FACE

■ 16 mm BORE

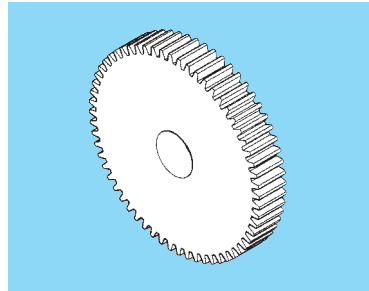
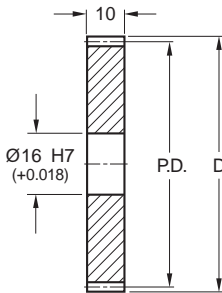

QUALITY CLASS

MATERIAL: 303 Stainless Steel

Catalog Number	No. of Teeth	P.D.	D
S12N15M018S1016	18	27	30
S12N15M020S1016	20	30	33
S12N15M024S1016	24	36	39
S12N15M028S1016	28	42	45
S12N15M030S1016	30	45	48
S12N15M032S1016	32	48	51
S12N15M036S1016	36	54	57
S12N15M040S1016	40	60	63
S12N15M042S1016	42	63	66
S12N15M045S1016	45	67.5	70.5
S12N15M048S1016	48	72	75
S12N15M050S1016	50	75	78
S12N15M056S1016	56	84	87
S12N15M060S1016	60	90	93
S12N15M064S1016	64	96	99

Available as special order: Number of teeth not listed, different bore size and/or material, passivation.

Did You Know?

... That Sterling Instrument is equipped to handle an entire project from the design and manufacturing of individual components to the assembly of final products? We are dedicated to quality products and on time delivery.



■ ISO CLASS 8

■ 20° PRESSURE ANGLE

■ 10 & 12 mm FACE WIDTH

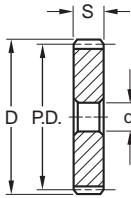

Fig. 1

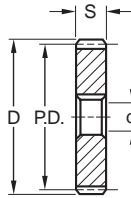
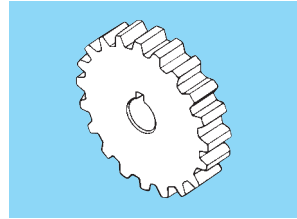
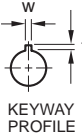

Fig. 2



QUALITY CLASS

FIG. 1 • WITHOUT KEYWAY

MATERIAL: Steel

Catalog Number	No. of Teeth	P.D.	D	d* Bore H7	S Face Width
A 1C 1MYK15016	16	24	27	8	12
A 1C 1MYK15018	18	27	30		
A 1C 1MYK15020	20	30	33	10	12
A 1C 1MYK15024	24	36	39		
A 1C 1MYK15025	25	37.5	40.5		
A 1C 1MYK15028	28	42	45	12	12
A 1C 1MYK15030A	30	45	48		
A 1C 1MYK15032	32	48	51	12	10
A 1C 1MYK15036	36	54	57		
A 1C 1MYK15040	40	60	63		
A 1C 1MYK15048	48	72	75		
A 1C 1MYK15050	50	75	78	14	10
A 1C 1MYK15056	56	84	87		
A 1C 1MYK15060	60	90	93		
A 1C 1MYK15064	64	96	99	14	10
A 1C 1MYK15070	70	105	108		
A 1C 1MYK15072	72	108	111		
A 1C 1MYK15080	80	120	123	16	10
A 1C 1MYK15100	100	150	153		

FIG. 2 • WITH KEYWAY

MATERIAL: Steel

Catalog Number	No. of Teeth	P.D.	D	d* Bore H7	S Face Width	w	t
A 1C11MYK15030A	30	45	48		12		
A 1C11MYK15036A	36	54	57	16	10	5	2.3
A 1C11MYK15040A	40	60	63		10		
A 1C11MYK15048A	48	72	75				
A 1C11MYK15050A	50	75	78				
A 1C11MYK15056A	56	84	87	18	10	6	2.8
A 1C11MYK15060A	60	90	93				
A 1C11MYK15064A	64	96	99				
Δ A 1C11MYK15070	70	105	108	18	10	5	2.8
A 1C11MYK15070A	70	105	108		6		
A 1C11MYK15072A	72	108	111				
A 1C11MYK15080A	80	120	123	20	10	6	2.8
A 1C11MYK15100A	100	150	153				

ΔTo be discontinued when present stock is depleted.

*Bore Tolerance: 8 & 10 mm + 0.015
12, 14, 16 & 18 mm + 0.018
20 mm + 0.021



■ ISO CLASS 8

■ 20° PRESSURE ANGLE

■ 16 & 18 mm FACE WIDTH

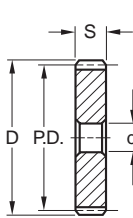

Fig. 1

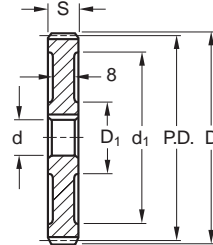
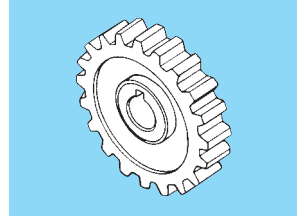
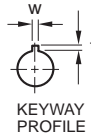

Fig. 2



QUALITY CLASS

1 GEARS

FIG. 1 • WITHOUT KEYWAY

MATERIAL: Steel

Catalog Number	No. of Teeth	P.D.	D	d* Bore H7	S Face Width
A 1C 1MYKW15016	16	24	27	8	18
A 1C 1MYKW15018	18	27	30	10	18
A 1C 1MYKW15020	20	30	33		
A 1C 1MYKW15024	24	36	39		
A 1C 1MYKW15025	25	37.5	40.5	12	18
A 1C 1MYKW15028	28	42	45		
A 1C 1MYKW15030	30	45	48		18
A 1C 1MYKW15032	32	48	51	14	16
A 1C 1MYKW15036	36	54	57		16
A 1C 1MYKW15040	40	60	63		16
A 1C 1MYKW15048	48	72	75		
A 1C 1MYKW15050	50	75	78		
A 1C 1MYKW15056	56	84	87	16	16
A 1C 1MYKW15060A	60	90	93		
A 1C 1MYKW15064	64	96	99		
A 1C 1MYKW15070	70	105	108		
A 1C 1MYKW15072	72	108	111		
A 1C 1MYKW15080A	80	120	123	18	16
A 1C 1MYKW15100A	100	150	153		

FIG. 2 • WITH KEYWAY

MATERIAL: Steel

Catalog Number	No. of Teeth	P.D.	D	d* Bore H7	S Face Width	D ₁ Dia.	d ₁ Dia.	w	t
A 1C11MYKW15020	20	30	33	14	18	No Web	No Web	4	1.8
A 1C11MYKW15024	24	36	39						
A 1C11MYKW15025	25	37.5	40.5	16	18	No Web	No Web	5	2.3
A 1C11MYKW15028	28	42	45						
A 1C11MYKW15030	30	45	48		18				
A 1C11MYKW15032	32	48	51	18	16	No Web	No Web	5	2.3
A 1C11MYKW15036	36	54	57		16				
A 1C11MYKW15040	40	60	63		16				
A 1C11MYKW15048	48	72	75						
A 1C11MYKW15050A	50	75	78	20	16	No Web	No Web	6	2.8
A 1C11MYKW15056A	56	84	87						
A 1C11MYKW15060A	60	90	93				76		
A 1C11MYKW15064A	64	96	99	20	16	40	82	6	2.8
A 1C11MYKW15070A	70	105	108				91		
A 1C11MYKW15072	72	108	111				94		
A 1C 1MYKW15080	80	120	123	25	16	50	106	8	3.3
A 1C 1MYKW15100	100	150	153				136		

*Bore Tolerance: 8 & 10 mm + 0.015
 12, 14, 16 & 18 mm + 0.018
 20 & 25 mm + 0.021

These gears are made using STANDARDIZED BLANK SIZES, and are not available from stock. Due to availability of blanks, however, delivery is short.