

■ ISO CLASS 8

■ 20° PRESSURE ANGLE

■ 20 mm FACE

■ 12 mm BORE

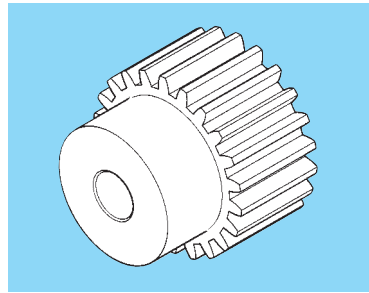
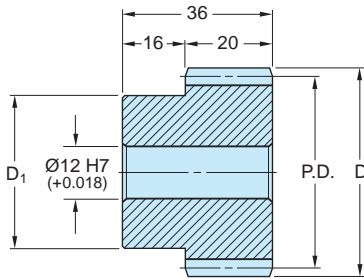

QUALITY CLASS

MATERIAL: 303 Stainless Steel

Catalog Number	No. of Teeth	P.D.	D	D <sub>1</sub> Hub Dia.
S10P20M015S2012	15	30	34	24
S10P20M016S2012	16	32	36	26
S10P20M018S2012	18	36	40	30
S10P20M020S2012	20	40	44	32
S10P20M022S2012	22	44	48	36
S10P20M024S2012	24	48	52	38
S10P20M025S2012	25	50	54	40
S10P20M028S2012	28	56	60	45
S10P20M030S2012	30	60	64	50

Available as special order: Number of teeth not listed, different bore size and/or material, passivation.

### Did You Know?

... That this catalog contains the world's largest selection of metric pulleys and timing belts?



■ ISO CLASS 8

■ 20° PRESSURE ANGLE

■ 12 & 14 mm FACE WIDTH

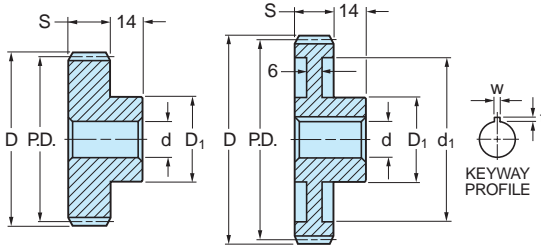
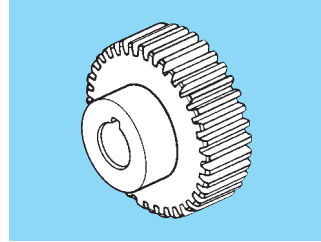

Fig. 1

Fig. 2



**QUALITY CLASS**

FIG. 1 • WITHOUT KEYWAY

MATERIAL: Steel

Catalog Number	No. of Teeth	P.D.	D	d* Bore H7	S Face Width	D <sub>1</sub> Hub Dia.
A 1C 2MYK20014	14	28	32	10	14	22
A 1C 2MYK20015	15	30	34			24
A 1C 2MYK20016	16	32	36			26
A 1C 2MYK20018	18	36	40	12	14	30
A 1C 2MYK20020	20	40	44			34
A 1C 2MYK20024	24	48	52			42
A 1C 2MYK20025	25	50	54	14	14	44
A 1C 2MYK20028B	28	56	60			50
A 1C 2MYK20030B	30	60	64			54
A 1C 2MYK20032B	32	64	68			58
A 1C 2MYK20036B	36	72	76	14	12	60
A 1C 2MYK20040B	40	80	84			60
A 1C 2MYK20048B	48	96	100			
A 1C 2MYK20050B	50	100	104	16	12	60
A 1C 2MYK20056	56	112	116			
A 1C 2MYK20064	64	128	132			
A 1C 2MYK20072	72	144	148	18	12	60

FIG. 2 • WITH KEYWAY

MATERIAL: Steel

Catalog Number	No. of Teeth	P.D.	D	d* Bore H7	S Face Width	D <sub>1</sub> Hub Dia.	d <sub>1</sub>	w	t
A 1C22MYK20020A	20	40	44			34			
A 1C22MYK20024A	24	48	52	18	14	36	—	6	2.8
A 1C22MYK20025A	25	50	54			36			
A 1C22MYK20028A	28	56	60						
A 1C22MYK20030A	30	60	64	20	14	40	—	6	2.8
A 1C22MYK20032A	32	64	68						
A 1C22MYK20036A	36	72	76	20	12	40	—	6	2.8
A 1C22MYK20040A	40	80	84						
A 1C22MYK20048A	48	96	100						
A 1C22MYK20050A	50	100	104	20	12	40	—	6	2.8
A 1C22MYK20056A	56	112	116						
A 1C22MYK20060A	60	120	124	20	12	40	102	6	2.8
A 1C22MYK20060B				25		50		8	3.3
A 1C22MYK20064A	64	128	132	20	12	40	110	6	2.8
A 1C22MYK20072A	72	144	148	20	12	40	126	6	2.8
A 1C22MYK20080A				20		40		6	2.8
A 1C22MYK20080B	80	160	164	25	12	50	142	8	3.3
A 1C22MYK20100A				20		40		6	2.8
A 1C22MYK20100B	100	200	204	25	12	50	182	8	3.3

\*Bore Tolerance: 10 mm + 0.015  
 12,14, 16 & 18 mm + 0.018  
 20 & 25 mm + 0.021

These gears are made using STANDARDIZED BLANK SIZES, and are not available from stock. Due to availability of blanks, however, delivery is short.



■ ISO CLASS 8

■ 20° PRESSURE ANGLE

■ 20 & 22 mm FACE WIDTH

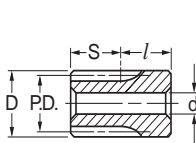
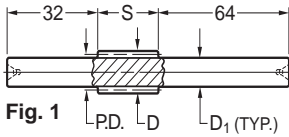

Fig. 2

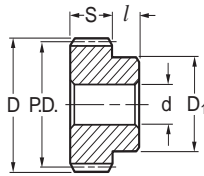
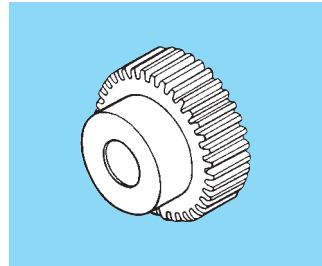

Fig. 3



**QUALITY CLASS**

• WITHOUT KEYWAY

MATERIAL: Steel

Catalog Number	Fig. No.	No. of Teeth	P.D.	D	d* Bore	S Face Width	D <sub>1</sub> Dia.	l
A 1C 8MYK20008L	1	8	**	21.28	—	22	12 (h8)*	—
A 1C 8MYK20010L		10	**	25.33			16 (h8)*	
A 1C 8MYK20012L	2	12	24	28	10(H8)	22	—	28
A 1C 2MYKW20014		14	28	32				
A 1C 2MYKW20015	3	15	30	34	12(H8)	20	22	20
A 1C 2MYKW20016		16	32	36				
A 1C 2MYKW20018	4	18	36	40	14(H7)	20	24	20
A 1C 2MYKW20020		20	40	44				
A 1C 2MYKW20024A	5	24	48	52	16(H7)	20	26	20
A 1C 2MYKW20025A		25	50	54				
A 1C 2MYKW20028	6	28	56	60	18(H7)	20	28	20
A 1C 2MYKW20030		30	60	64				
A 1C 2MYKW20032B	7	32	64	68	18(H7)	20	30	20
A 1C 2MYKW20036B		36	72	76				
A 1C 2MYKW20040B	8	40	80	84	20(H7)	20	32	20
A 1C 2MYKW20048B		48	96	100				
A 1C 2MYKW20050B	9	50	100	104	20(H7)	20	34	20
A 1C 2MYKW20056		56	112	116				
A 1C 2MYKW20060B	10	60	120	124	20(H7)	20	36	20
A 1C 2MYKW20064		64	128	132				
A 1C 2MYKW20072	11	72	144	148	20(H7)	20	38	20
A 1C 2MYKW20080B		80	160	164				
A 1C 2MYKW20100B	12	100	200	204	20(H7)	20	40	20

\*Bore Tolerance:  
 10 mm + 0.022  
 12 mm + 0.027  
 14, 16 & 18 mm + 0.018  
 20 mm + 0.021

Shaft Tolerance: 12 & 16 mm - 0.027

\*\*To obtain additional tooth strength, these pinions are produced by shifting the tooth profile which results in a long addendum. The center distance for these pinions has to be increased; therefore, please consult our Engineering Department.



■ ISO CLASS 8

■ 20° PRESSURE ANGLE

■ 20 & 22 mm FACE WIDTH

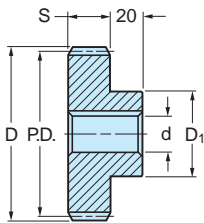

Fig. 1

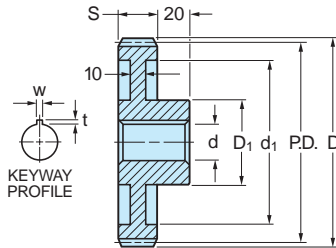
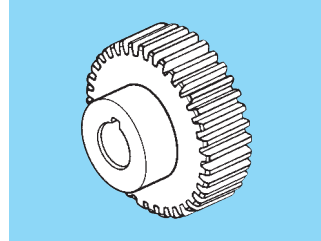

Fig. 2



**QUALITY CLASS**

1 GEARS

• WITH KEYWAY

MATERIAL: Steel

Catalog Number	Fig. No.	No. of Teeth	P.D.	D	d* Bore H7	S Face Width	D <sub>1</sub> Hub Dia.	d <sub>1</sub>	w	t
A 1C22MYKW20020A	1	20	40	44	20	22	34	—	6	2.8
A 1C22MYKW20024A		24	48	52						
A 1C22MYKW20025A		25	50	54	20	22	40	—	6	2.8
A 1C22MYKW20028A		28	56	60						
A 1C22MYKW20030A		30	60	64						
A 1C22MYKW20032A		32	64	68						
A 1C22MYKW20036A		36	72	76						
A 1C22MYKW20040A		40	80	84	25	20	50	—	8	3.3
A 1C22MYKW20048A		48	96	100						
A 1C22MYKW20050A		50	100	104						
A 1C22MYKW20056A	56	112	116							
A 1C22MYKW20060A	2	60	120	124	25	20	50	102	8	3.3
△ A 1C22MYKW20060H					30		60		7	2
A 1C22MYKW20064A		64	128	132	25	20	50	110	8	3.3
A 1C22MYKW20072A		72	144	148					126	
A 1C22MYKW20080A		80	160	164	30	20	60	142	8	3.3
A 1C22MYKW20100A		100	200	204				182		

\* Tolerance for these bores is +0.021.

△ To be discontinued when present stock is depleted.

### Did You Know?

... That there are over 3,700 items in this gear section? If you don't see what you need, please call our engineering department for assistance.

**CALL: 516-328-3300**

**or FAX: 516-326-8827**



■ ISO CLASS 8

■ 20° PRESSURE ANGLE

■ 12 & 14 mm FACE WIDTH

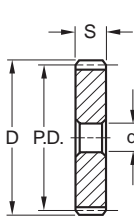

Fig. 1

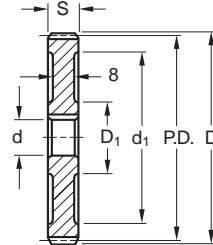
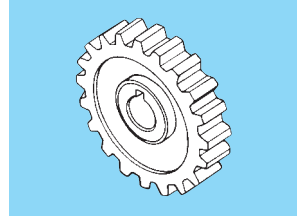
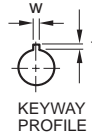

Fig. 2



**QUALITY CLASS**

FIG. 1 • WITHOUT KEYWAY

MATERIAL: Steel

Catalog Number	No. of Teeth	P.D.	D	d* Bore H7	S Face Width
A 1C 1MYK20014	14	28	32	10	14
A 1C 1MYK20015	15	30	34	10	14
A 1C 1MYK20016	16	32	36	12	14
A 1C 1MYK20018	18	36	40	12	14
A 1C 1MYK20020	20	40	44	12	14
A 1C 1MYK20024	24	48	52	14	14
A 1C 1MYK20025	25	50	54	14	14
A 1C 1MYK20028	28	56	60	16	14
A 1C 1MYK20030	30	60	64	16	14
A 1C 1MYK20032	32	64	68	14	12
A 1C 1MYK20036	36	72	76	16	12
A 1C 1MYK20040	40	80	84	16	12
A 1C 1MYK20048	48	96	100	18	12
A 1C 1MYK20050	50	100	104	18	12
A 1C 1MYK20056	56	112	116	20	12
A 1C 1MYK20060	60	120	124	20	12
A 1C 1MYK20064	64	128	132	20	12
A 1C 1MYK20072	72	144	148	20	12
A 1C 1MYK20080	80	160	164	20	12
A 1C 1MYK20100	100	200	204	20	12

FIG. 2 • WITH KEYWAY

MATERIAL: Steel

Catalog Number	No. of Teeth	P.D.	D	d* Bore H7	S Face Width	D <sub>1</sub> Dia.	d <sub>1</sub> Dia.	w	t
A 1C11MYK20020A	20	40	44	16	14	No Web	No Web	5	2.3
A 1C11MYK20024A	24	48	52	16	14	No Web	No Web	5	2.3
Δ A 1C11MYK20025	25	50	54	18	14	No Web	No Web	5	2.3
A 1C11MYK20025A	25	50	54	18	14	No Web	No Web	6	2.8
A 1C11MYK20028A	28	56	60	18	14	No Web	No Web	6	2.8
A 1C11MYK20030A	30	60	64	18	14	No Web	No Web	6	2.8
A 1C11MYK20032A	32	64	68	12	12	No Web	No Web	6	2.8
A 1C11MYK20036A	36	72	76	20	12	No Web	No Web	6	2.8
A 1C11MYK20040A	40	80	84	20	12	No Web	No Web	6	2.8
A 1C11MYK20048A	48	96	100	20	12	No Web	No Web	6	2.8
Δ A 1C11MYK20050	50	100	104	20	12	No Web	No Web	5	2.3
A 1C11MYK20050A	50	100	104	20	12	No Web	No Web	6	2.8
A 1C11MYK20056A	56	112	116	20	12	No Web	No Web	6	2.8
A 1C11MYK20060A	60	120	124	25	12	50	102	8	3.3
A 1C11MYK20064A	64	128	132	25	12	50	110	8	3.3
A 1C11MYK20072A	72	144	148	25	12	50	126	8	3.3
A 1C11MYK20080A	80	160	164	25	12	50	142	8	3.3
A 1C11MYK20100A	100	200	204	25	12	50	182	8	3.3

Δ Not available after current stock is depleted

\*Bore Tolerance: 10 mm + 0.015  
12, 14, 16 & 18 mm + 0.018  
20 & 25 mm + 0.021

■ ISO CLASS 8

■ 20° PRESSURE ANGLE

■ 20 mm FACE

■ 15 mm BORE

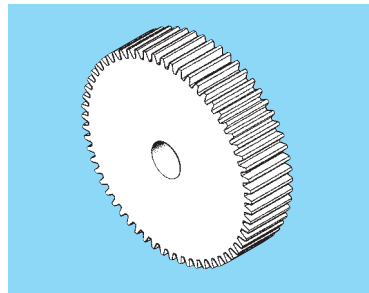
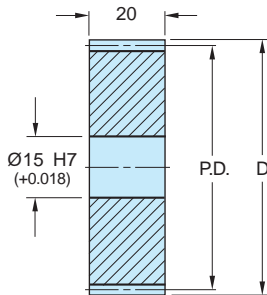

QUALITY CLASS

MATERIAL: 303 Stainless Steel

Catalog Number	No. of Teeth	P.D.	D
S12N20M032S2015	32	64	68
S12N20M035S2015	35	70	74
S12N20M036S2015	36	72	76
S12N20M040S2015	40	80	84
S12N20M042S2015	42	84	88
S12N20M045S2015	45	90	94
S12N20M048S2015	48	96	100
S12N20M050S2015	50	100	104
S12N20M056S2015	56	112	116
S12N20M060S2015	60	120	124
S12N20M064S2015	64	128	132
S12N20M070S2015	70	140	144

Available as special order: Number of teeth not listed, different bore size and/or material, passivation.

## Did You Know?

At SDP/Sterling we are dedicated to manufacturing plastic drive components that are standardized or custom designed by the inch or by the millimeter?



■ ISO CLASS 8

■ 20° PRESSURE ANGLE

■ 20 & 22 mm FACE WIDTH

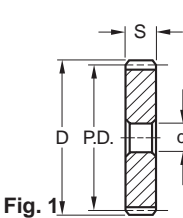

Fig. 1

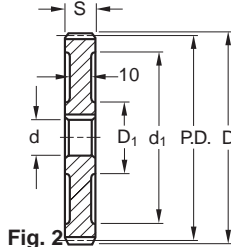
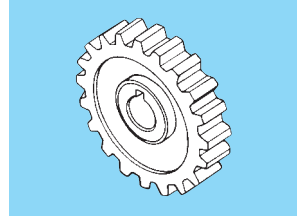
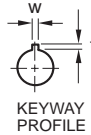

Fig. 2



**QUALITY CLASS**

● WITHOUT KEYWAY FIG. 1

MATERIAL: Steel

Catalog Number	No. of Teeth	P.D.	D	d* Bore H7	S Face Width
A 1C 1MYKW20014	14	28	32		
A 1C 1MYKW20015	15	30	34	10	22
A 1C 1MYKW20016	16	32	36		
A 1C 1MYKW20018	18	36	40	12	22
A 1C 1MYKW20020	20	40	44		
A 1C 1MYKW20024	24	48	52	14	22
A 1C 1MYKW20025	25	50	54		
A 1C 1MYKW20028	28	56	60		22
A 1C 1MYKW20030	30	60	64	16	
A 1C 1MYKW20032A	32	64	68		20
A 1C 1MYKW20036	36	72	76		
A 1C 1MYKW20048	48	96	100	20	20
A 1C 1MYKW20056	56	112	116		
A 1C 1MYKW20064	64	128	132	18	20
A 1C 1MYKW20072	72	144	148		

● WITH KEYWAY FIG. 2

MATERIAL: Steel

Catalog Number	No. of Teeth	P.D.	D	d* Bore H7	S Face Width	D <sub>1</sub> Dia.	d <sub>1</sub> Dia.	w	t		
A 1C11MYKW20020A	20	40	44	18	22	No Web	No Web	6	2.8		
A 1C11MYKW20024A	24	48	52	20	22			6	2.8		
A 1C11MYKW20025A	25	50	54								
A 1C11MYKW20028A	28	56	60	20	20			6	2.8		
A 1C11MYKW20030A	30	60	64								
A 1C11MYKW20032A	32	64	68	25	20			8	3.3		
A 1C11MYKW20036A	36	72	76								
A 1C11MYKW20040A	40	80	84	20	20			6	2.8		
A 1C11MYKW20040B				25	20					8	3.3
A 1C11MYKW20048A	48	96	100	25	20			8	3.3		
A 1C11MYKW20050A				20	20					6	2.8
A 1C11MYKW20050B	25	20	8	3.3							
A 1C11MYKW20056A	56	112			116			25	20	8	3.3
A 1C11MYKW20060A	60	120	124	20	20			40	102	6	2.8
A 1C11MYKW20060B	60	120	124	25	20			50	102	8	3.3
A 1C11MYKW20064A	64	128	132	25	20			50	110	8	3.3
A 1C11MYKW20072A	72	144	148								
A 1C11MYKW20080A	80	160	164	20	20	40	142	6	2.8		
A 1C11MYKW20080B				25	20	50	142	8	3.3		
A 1C11MYKW20100A	100	200	204	20	20	40		6	2.8		
ΔA 1C11MYKW20100				30	20	60	182	7	3		
A 1C11MYKW20100B				30	20	60	182	8	3.3		

ΔTo be discontinued when present stock is depleted.

\*Bore Tolerance  
 10 mm + 0.015  
 12, 14, 16 & 18 mm + 0.018  
 20, 25 & 30 mm + 0.021



■ ISO CLASS 8

■ 20° PRESSURE ANGLE

■ 16 & 18 mm FACE WIDTH

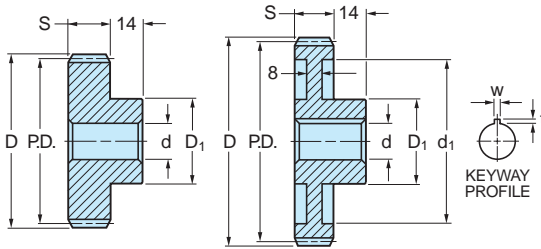
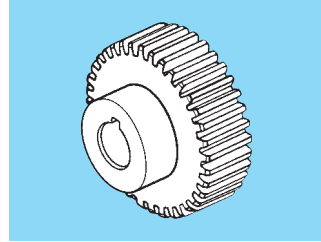

Fig. 1

Fig. 2



**QUALITY CLASS**

1 GEARS

FIG. 1 • WITHOUT KEYWAY

MATERIAL: Steel

Catalog Number	No. of Teeth	P.D.	D	d* Bore H7	S Face Width	D <sub>1</sub> Hub Dia.
A 1C 2MYK25014	14	35	40			28
A 1C 2MYK25015	15	37.5	42.5	12	18	30
A 1C 2MYK25016	16	40	45			32
A 1C 2MYK25018	18	45	50	14	18	36
A 1C 2MYK25020B	20	50	55	12		42
A 1C 2MYK25024B	24	60	65			
A 1C 2MYK25025B	25	62.5	67.5	14	18	50
A 1C 2MYK25028B	28	70	75			
A 1C 2MYK25030B	30	75	80			
A 1C 2MYK25032B	32	80	85			
A 1C 2MYK25036B	36	90	95			
A 1C 2MYK25040B	40	100	105	16	16	60
A 1C 2MYK25048B	48	120	125			
A 1C 2MYK25050B	50	125	130			
A 1C 2MYK25056	56	140	145			
A 1C 2MYK25060B	60	150	155	18	16	60
A 1C 2MYK25064	64	160	165			
A 1C 2MYK25072	72	180	185	18	16	70
A 1C 2MYK25080B	80	200	205			

FIG. 2 • WITH KEYWAY

MATERIAL: Steel

Catalog Number	No. of Teeth	P.D.	D	d* Bore H7	S Face Width	D <sub>1</sub> Hub Dia.	d <sub>1</sub> Dia.	w	t
A 1C22MYK25020A	20	50	55						
A 1C22MYK25024A	24	60	65						
A 1C22MYK25025A	25	62.5	67.5	20	18	40	No Web	6	2.8
A 1C22MYK25028A	28	70	75						
A 1C22MYK25030A	30	75	80						
A 1C22MYK25032A	32	80	85						
A 1C22MYK25036A	36	90	95				No Web		
A 1C22MYK25040A	40	100	105	25	16	50		8	3.3
A 1C22MYK25048A	48	120	125						
A 1C22MYK25050A	50	125	130						
A 1C22MYK25056A	56	140	145	20	16	40	No Web	6	2.8
A 1C22MYK25060A	60	150	155	25		50	127	8	3.3
A 1C22MYK25064A	64	160	165	20	16	40	137	6	2.8
A 1C22MYK25072A	72	180	185				157		
A 1C22MYK25080A	80	200	205	25	16	50	177	8	3.3

\*Bore Tolerance: 12,14,16 & 18 mm + 0.018  
20 & 25 mm + 0.021

These gears are made using STANDARDIZED BLANK SIZES, and are not available from stock. Due to availability of blanks, however, delivery is short.

■ ISO CLASS 8

■ 20° PRESSURE ANGLE

■ 25 mm FACE

■ 15 mm BORE

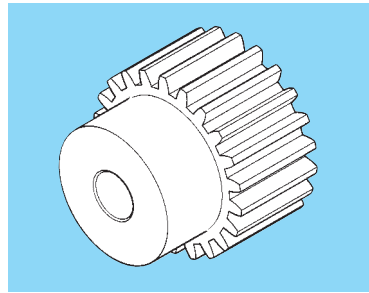
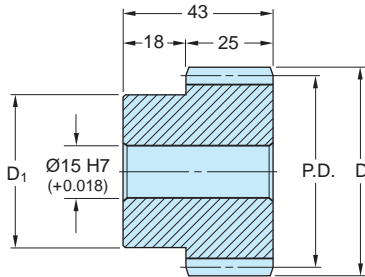

QUALITY CLASS

MATERIAL: 303 Stainless Steel

Catalog Number	No. of Teeth	P.D.	D	D <sub>1</sub> Hub Dia.
S10P25M015S2515	15	37.5	42.5	30
S10P25M016S2515	16	40	45	32
S10P25M018S2515	18	45	50	38
S10P25M020S2515	20	50	55	40
S10P25M022S2515	22	55	60	44
S10P25M024S2515	24	60	65	48
S10P25M025S2515	25	62.5	67.5	50
S10P25M028S2515	28	70	75	60
S10P25M030S2515	30	75	80	65

Available as special order: Number of teeth not listed, different bore size and/or material, passivation.

### Did You Know?

... That the gears offered in this catalog are available in both prototype as well as production quantities?



■ ISO CLASS 8

■ 20° PRESSURE ANGLE

■ 25 & 28 mm FACE WIDTH

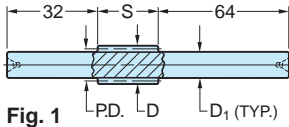

Fig. 1

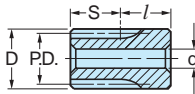

Fig. 2

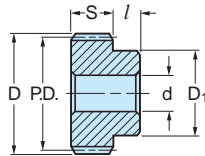
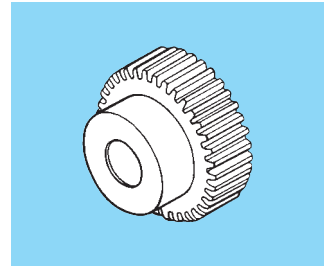

Fig. 3



**QUALITY CLASS**

• WITHOUT KEYWAY

MATERIAL: Steel

Catalog Number	Fig. No.	No. of Teeth	P.D.	D	d* Bore	S Face Width	D <sub>1</sub> Hub Dia.	l Hub Proj.
A 1C 8MYK25008L	1	8	**	26.59	—	28	15 (h8)*	—
A 1C 8MYK25010L		10	**	31.66	—		20 (h8)*	—
A 1C 8MYK25012	2	12	30	35	12(H8)	28	—	32
A 1C 2MYKW25014	3	14	35	40	12(H8)	28	28	20
A 1C 2MYKW25015		15	37.5	42.5				
A 1C 2MYKW25016		16	40	45				
A 1C 2MYKW25018		18	45	50				
A 1C 2MYKW25020		20	50	55	14(H8)	28	36	42
A 1C 2MYKW25024B		24	60	65	15(H8)	28	50	20
A 1C 2MYKW25025B		25	62.5	67.5				
A 1C 2MYKW25028B		28	70	75	16(H8)	28	60	20
A 1C 2MYKW25030B		30	75	80				
A 1C 2MYKW25032B		32	80	85	16(H7)	25	60	20
A 1C 2MYKW25036B		36	90	95	18(H7)	25	60	20
A 1C 2MYKW25040B		40	100	105				
A 1C 2MYKW25048B		48	120	125				
A 1C 2MYKW25050B		50	125	130				
A 1C 2MYKW25056		56	140	145	20(H7)	25	70	20
A 1C 2MYKW25060B		60	150	155				
A 1C 2MYKW25064	64	160	165					
A 1C 2MYKW25072	72	180	185	20(H7)				
A 1C 2MYKW25080B	80	200	205	22(H7)	25	80	20	

\* Bore Tolerance: 12, 14, 15 & 16 mm + 0.027 (H8)  
 16 & 18 mm + 0.018 (H7)  
 20 & 22 mm + 0.021 (H7)

Shaft Tolerance: 15 mm -0.027 (h8)  
 20 mm -0.033 (h8)

\*\* To obtain additional tooth strength, these pinions are produced by shifting the tooth profile which results in a long addendum. The center distance for these pinions has to be increased; therefore, please consult our Engineering Department.



■ ISO CLASS 8

■ 20° PRESSURE ANGLE

■ 25 & 28 mm FACE WIDTH

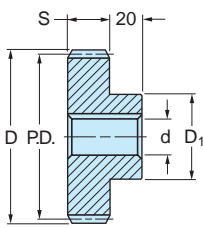

Fig. 1

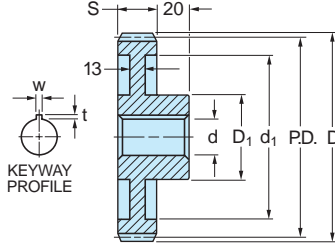
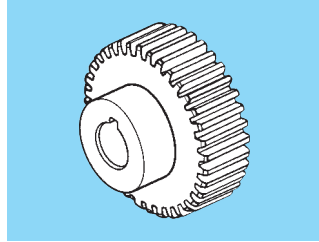

Fig. 2



**QUALITY CLASS**

• WITH KEYWAY

MATERIAL: Steel

Catalog Number	Fig. No.	No. of Teeth	P.D.	D	d* Bore H7	S Face Width	D <sub>1</sub> Hub Dia.	d <sub>1</sub> Dia.	w	t
A 1C22MYKW25020A	1	20	50	55	20	28	40	—	6	2.8
A 1C22MYKW25024A		24	60	65	25	28	50	—	8	3.3
A 1C22MYKW25025A		25	62.5	67						
A 1C22MYKW25028A		28	70	75	30	25	60	—	8	3.3
A 1C22MYKW25030A		30	75	80						
A 1C22MYKW25032A		32	80	85						
A 1C22MYKW25036A		36	90	95	35	25	70	127	10	3.3
A 1C22MYKW25040A		40	100	105						
A 1C22MYKW25048A		48	120	125						
A 1C22MYKW25050A		50	125	130						
A 1C22MYKW25056A	56	140	145	25	25	50	—	8	3.3	
A 1C22MYKW25060A	60	150	155							
A 1C22MYKW25064A	64	160	165							
A 1C22MYKW25072A	72	180	185							
A 1C22MYKW25080A	80	200	205							

\*Bore Tolerance: 20, 25 & 30 mm + 0.021  
35 mm + 0.025

These gears are made using STANDARDIZED BLANK SIZES, and are not available from stock. Due to availability of blanks, however, delivery is short.

### Did You Know?

... That our inch size gears are offered in 120 Diametral Pitch to 16 Diametral Pitch? See section 1 in our **Inch Drive Components Catalog 787**.



■ ISO CLASS 8

■ 20° PRESSURE ANGLE

■ 16 & 18 mm FACE WIDTH

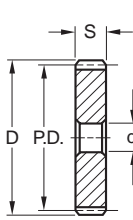

Fig. 1

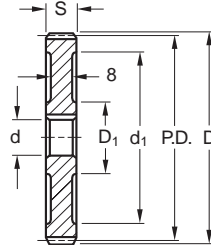
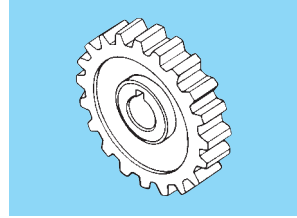
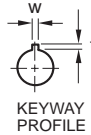

Fig. 2



**QUALITY CLASS**

FIG. 1 • WITHOUT KEYWAY

MATERIAL: Steel

Catalog Number	No. of Teeth	P.D.	D	d* Bore H7	S Face Width
A 1C 1MYK25014	14	35	40		
A 1C 1MYK25015	15	37.5	42.5		
A 1C 1MYK25016	16	40	45	12	18
A 1C 1MYK25018	18	45	50		
A 1C 1MYK25020	20	50	55		
A 1C 1MYK25024	24	60	65		
A 1C 1MYK25025	25	62.5	67.5	14	18
A 1C 1MYK25028	28	70	75		
A 1C 1MYK25030	30	75	80	16	18
A 1C 1MYK25032	32	80	85		
A 1C 1MYK25036A	36	90	95	16	16
A 1C 1MYK25040A	40	100	105		
A 1C 1MYK25048A	48	120	125		
A 1C 1MYK25050A	50	125	130	16	16
A 1C 1MYK25056	56	140	145		
A 1C 1MYK25060A	60	150	155		
A 1C 1MYK25064	64	160	165	16	16
A 1C 1MYK25072	72	180	185		
A 1C 1MYK25080	80	200	205	18	16

FIG. 2 • WITH KEYWAY

MATERIAL: Steel

Catalog Number	No. of Teeth	P.D.	D	d* Bore H7	S Face Width	D <sub>1</sub> Dia.	d <sub>1</sub> Dia.	w	t
A 1C11MYK25020A	20	50	55	16	18	No Web	No Web	5	2.3
A 1C11MYK25024A	24	60	65						
A 1C11MYK25025A	25	62.5	67	18	18	No Web	No Web	6	2.8
A 1C11MYK25028A	28	70	75						
A 1C11MYK25030A	30	75	80	20	18	No Web	No Web	6	2.8
A 1C11MYK25032A	32	80	85						
A 1C11MYK25036A	36	90	95	20	16	No Web	No Web	6	2.8
A 1C11MYK25040A	40	100	105						
A 1C11MYK25048A	48	120	125						
A 1C11MYK25050A	50	125	130	20	16	No Web	No Web	6	2.8
A 1C11MYK25056A	56	140	145						
A 1C11MYK25060A	60	150	155	25	16	50	127	8	3.3
A 1C11MYK25064A	64	160	165				137		
A 1C11MYK25072A	72	180	185	20	16	40	157	6	2.8
A 1C11MYK25080A	80	200	205				177		

\*Bore Tolerance: 12, 14, 16 & 18 mm + 0.018  
20 & 25 mm + 0.021

These gears are made using STANDARDIZED BLANK SIZES, and are not available from stock. Due to availability of blanks, however, delivery is short.

■ ISO CLASS 8

■ 20° PRESSURE ANGLE

■ 20 mm FACE

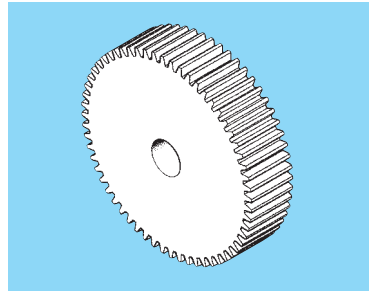
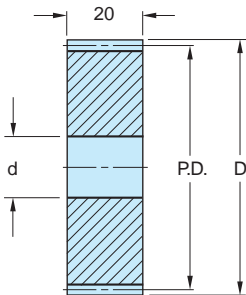

QUALITY CLASS

MATERIAL: 303 Stainless Steel

Catalog Number	No. of Teeth	P.D.	D	d* Bore H7
S12N25M032S2015	32	80	85	20
S12N25M035S2015	35	87.5	92.5	
S12N25M036S2015	36	90	95	
S12N25M040S2020	40	100	105	
S12N25M042S2020	42	105	110	
S12N25M045S2020	45	112.5	117.5	
S12N25M048S2020	48	120	125	
S12N25M050S2020	50	125	130	
S12N25M055S2020	55	137.5	142.5	
S12N25M056S2020	56	140	145	
S12N25M060S2020	60	150	155	
S12N25M064S2020	64	160	165	

\*Bore Tolerance: 15 mm +0.018  
20 mm +0.021

Available as special order: Number of teeth not listed, different bore size and/or material, passivation.

## Did You Know?

... That Fairloc® is a specially designed hub fastening device that has many unique advantages over set screw or keyway methods? See **Section 6** for a full explanation.



■ ISO CLASS 8

■ 20° PRESSURE ANGLE

■ 25 & 28 mm FACE WIDTH

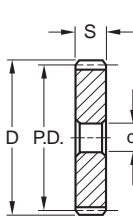

Fig. 1

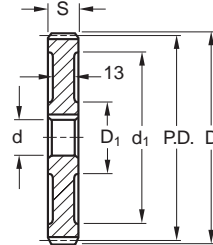
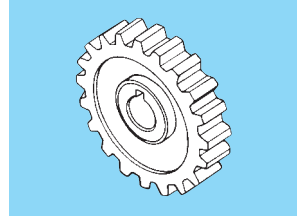
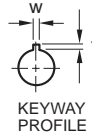

Fig. 2



**QUALITY CLASS**

FIG. 1 • WITHOUT KEYWAY

MATERIAL: Steel

Catalog Number	No. of Teeth	P.D.	D	d* Bore H7	S Face Width
A 1C 1MYKW25014	14	35	40		
A 1C 1MYKW25015	15	37.5	42.5	12	28
A 1C 1MYKW25016	16	40	45		
A 1C 1MYKW25018	18	45	50		
A 1C 1MYKW25020	20	50	55	14	28
A 1C 1MYKW25024	24	60	65		
A 1C 1MYKW25025	25	62.5	67.5		
A 1C 1MYKW25028	28	70	75	16	28
A 1C 1MYKW25030	30	75	80		
A 1C 1MYKW25032	32	80	85		
A 1C 1MYKW25036A	36	90	95	18	25
A 1C 1MYKW25040A	40	100	105		
A 1C 1MYKW25048A	48	120	125		
A 1C 1MYKW25050A	50	125	130		
A 1C 1MYKW25056	56	140	145	18	25
A 1C 1MYKW25060A	60	150	155		
A 1C 1MYKW25064	64	160	165		
A 1C 1MYKW25072	72	180	185		
A 1C 1MYKW25080A	80	200	205	20	25

FIG. 2 • WITH KEYWAY

MATERIAL: Steel

Catalog Number	No. of Teeth	P.D.	D	d* Bore H7	S Face Width	D <sub>1</sub> Dia.	d <sub>1</sub> Dia.	w	t
A 1C11MYKW25020A	20	50	55	18	28	No Web	No Web	6	2.8
A 1C11MYKW25024A	24	60	65						
A 1C11MYKW25025A	25	62.5	67	20	28	No Web	No Web	6	2.8
A 1C11MYKW25028A	28	70	75						
A 1C11MYKW25030A	30	75	80						
A 1C11MYKW25032A	32	80	85						
A 1C11MYKW25036A	36	90	95						
A 1C11MYKW25040A	40	100	105	25	25	No Web	No Web	8	8
A 1C11MYKW25048A	48	120	125						
A 1C11MYKW25050A	50	125	130						
A 1C11MYKW25056A	56	140	145	20	25	No Web	No Web	6	2.8
A 1C11MYKW25060A	60	150	155	25	25	50	127	8	3.3
A 1C11MYKW25064A	64	160	165						
A 1C11MYKW25072A	72	180	185	20	25	40	137	6	6
ΔA 1C11MYKW25080X								7	3
A 1C11MYKW25080A	80	200	205	25	25	50	177	8	3.3

ΔTo be discontinued when current stock is depleted.

\*Bore Tolerance: 12, 14, 16 & 18 mm + 0.018  
20 & 25 mm + 0.021

These gears are made using STANDARDIZED BLANK SIZES, and are not available from stock. Due to availability of blanks, however, delivery is short.