



■ ISO CLASS 8

■ 20° PRESSURE ANGLE

■ 20 & 22 mm FACE WIDTH

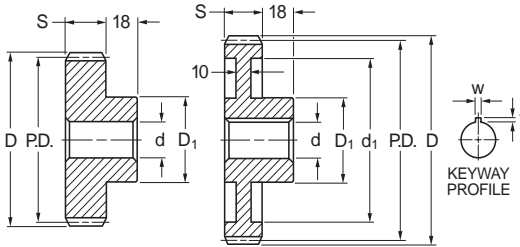
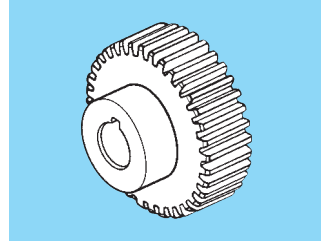

Fig. 1

Fig. 2



**QUALITY CLASS**

FIG. 1 • WITHOUT KEYWAY

MATERIAL: Steel

Catalog Number	No. of Teeth	P.D.	D	d* Bore H7	S Face Width	D <sub>1</sub> Hub Dia.
A 1C 2MYK30014	14	42	48			34
A 1C 2MYK30015	15	45	51	16	22	36
A 1C 2MYK30016	16	48	54			40
A 1C 2MYK30018	18	54	60			46
A 1C 2MYK30020	20	60	66	18	22	50
A 1C 2MYK30024	24	72	78			50
A 1C 2MYK30025	25	75	81			50
A 1C 2MYK30028	28	84	90	20	22	50
A 1C 2MYK30030	30	90	96			60
A 1C 2MYK30032A	32	96	102	18	22	70
A 1C 2MYK30036A	36	108	114			70
A 1C 2MYK30040A	40	120	126			70
A 1C 2MYK30048A	48	144	150	20	20	70
A 1C 2MYK30050A	50	150	156			70
A 1C 2MYK30056	56	168	174			70
A 1C 2MYK30060A	60	180	186	22	20	70
A 1C 2MYK30064	64	192	198			70

FIG. 2 • WITH KEYWAY

MATERIAL: Steel

Catalog Number	No. of Teeth	P.D.	D	d* Bore H7	S Face Width	D <sub>1</sub> Hub Dia.	d <sub>1</sub>	w	t
A 1C22MYK30020A	20	60	66	20	22	40	—	6	2.8
A 1C22MYK30024A	24	72	78						
A 1C22MYK30025A	25	75	81						
A 1C22MYK30028A	28	84	90	25	22	50	—	8	3.3
A 1C22MYK30030A	30	90	96						
A 1C22MYK30032A	32	96	102						
A 1C22MYK30036A	36	108	114	25	20	50	—	8	3.3
A 1C22MYK30040A	40	120	126						
A 1C22MYK30048A	48	144	150				116		
A 1C22MYK30050A	50	150	156	25	20	50	122	8	3.3
A 1C22MYK30056A	56	168	174				140		
A 1C22MYK30060A	60	180	186				152		
A 1C22MYK30064A	64	192	198	30	20	60	164	8	3.3

Bore Tolerance: 16 & 18 mm + 0.018  
20,22,25 & 30 mm + 0.021

These gears are made using STANDARDIZED BLANK SIZES, and are not available from stock. Due to availability of blanks, however, delivery is short.

■ ISO CLASS 8

■ 20° PRESSURE ANGLE

■ 30 mm FACE

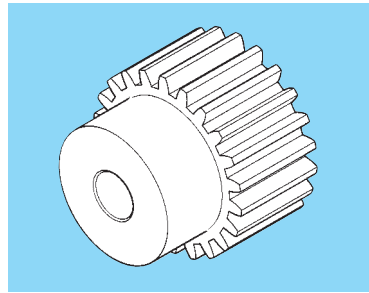
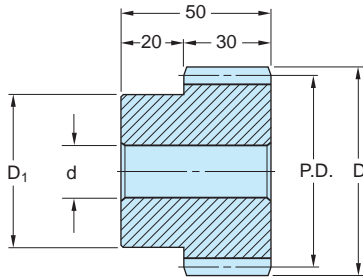

QUALITY CLASS

MATERIAL: 303 Stainless Steel

Catalog Number	No. of Teeth	P.D.	D	d* Bore H7	D <sub>1</sub> Hub Dia.
S10P30M015S3015	15	45	51	15	36
S10P30M016S3015	16	48	54		38
S10P30M018S3015	18	54	60		40
S10P30M020S3015	20	60	66		50
S10P30M022S3015	22	66	72		54
S10P30M024S3015	24	72	78	20	58
S10P30M025S3020	25	75	81		60
S10P30M028S3020	28	84	90		70
S10P30M030S3020	30	90	96		75

\*Bore Tolerance: 15 mm +0.018  
20 mm +0.021

Available as special order: Number of teeth not listed, different bore size and/or material, passivation.



■ ISO CLASS 8

■ 20° PRESSURE ANGLE

■ 30 & 35 mm FACE WIDTH

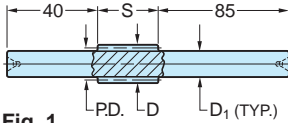

Fig. 1

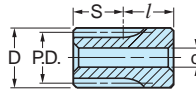
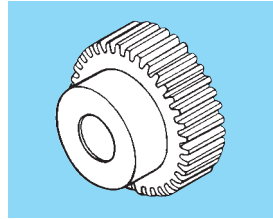

Fig. 2



**QUALITY CLASS**

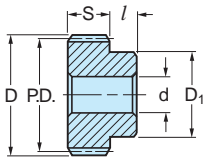

Fig. 3

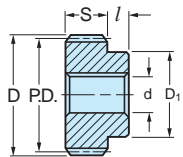

Fig. 4

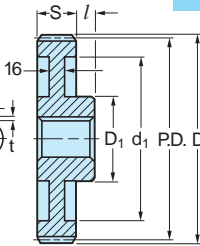

Fig. 5

• WITHOUT KEYWAY

MATERIAL: Steel

Catalog Number	Fig. No.	No. of Teeth	P.D.	D	d* Bore	S Face Width	D <sub>1</sub> Hub Dia.	l Hub Proj.
A 1C 8MYK30008	1	8	**	31.91	—	35	18 (h8)*	—
A 1C 8MYK30010		10	**	37.99	—	35	24 (h8)*	—
A 1C 8MYK30012L	2	12	36	42	14(H8)	35	—	35
A 1C 2MYKW30014		14	42	48	—	—	34	—
A 1C 2MYKW30015	3	15	45	51	16(H8)	30	36	20
A 1C 2MYKW30016		16	48	54	—	—	40	—
A 1C 2MYKW30018		18	54	60	18(H7)	30	46	20
A 1C 2MYKW30020		20	60	66	—	—	52	—
A 1C 2MYKW30024		24	72	78	20(H7)	30	60	20
A 1C 2MYKW30025		25	75	81	—	—	—	—
A 1C 2MYKW30028		28	84	90	—	—	—	—
A 1C 2MYKW30030		30	90	96	22(H7)	30	60	20

• WITH KEYWAY

MATERIAL: Steel

Catalog Number	Fig. No.	No. of Teeth	P.D.	D	d* Bore H7	S Face Width	D <sub>1</sub> Hub Dia.	l Hub Proj.	d <sub>1</sub>	w	t
A 1C 2MYKW30020A	4	20	60	66	25	35	50	15	—	8	3.3
A 1C 2MYKW30024A		24	72	78	—	—	—	—	—	—	—
A 1C 2MYKW30025A		25	75	81	30	35	60	15	—	8	3.3
A 1C 2MYKW30028A		28	84	90	—	—	—	—	—	—	—
A 1C 2MYKW30030A		30	90	96	—	—	—	—	—	—	—
A 1C 2MYKW30036A	5	36	108	114	35	30	70	15	—	10	3.3
A 1C 2MYKW30040A		40	120	126	—	—	—	—	—	—	—
A 1C 2MYKW30048B	5	48	144	150	40	30	80	15	116	—	—
A 1C 2MYKW30050B		50	150	156	—	—	—	—	122	12	3.3
A 1C 2MYKW30060B		60	180	186	—	—	—	—	152	—	—

\* Bore Tolerance: 14 & 16 mm + 0.027  
 18 mm + 0.018  
 20, 22, 25 & 30 mm + 0.021  
 35 & 40 mm + 0.025

Shaft Tolerance: 18 mm - 0.027  
 24 mm - 0.033

\*\* To obtain additional tooth strength these pinions are produced by shifting the tooth profile which results in a long addendum. The center distance for these pinions has to be increased, therefore, please consult our Engineering Department.



■ ISO CLASS 8

■ 20° PRESSURE ANGLE

■ 20 & 22 mm FACE WIDTH

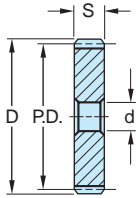

Fig. 1

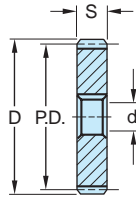

Fig. 2  
No Web

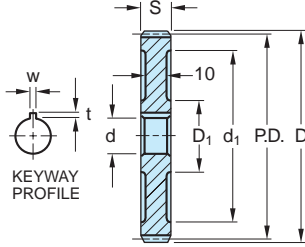
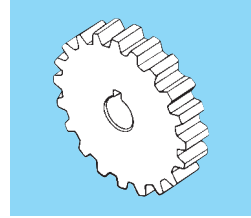

Fig. 2  
With Web



**QUALITY CLASS**

FIG. 1 • WITHOUT KEYWAY

MATERIAL: Steel

Catalog Number	No. of Teeth	P.D.	D	d* Bore H7	S Face Width
A 1C 1MYK30014	14	42	48		
A 1C 1MYK30015	15	45	51	16	22
A 1C 1MYK30016	16	48	54		
A 1C 1MYK30018	18	54	60		
A 1C 1MYK30020	20	60	66	16	22
A 1C 1MYK30024	24	72	78		
A 1C 1MYK30025	25	75	81		
A 1C 1MYK30028	28	84	90	18	22
A 1C 1MYK30030	30	90	96	20	22
A 1C 1MYK30032	32	96	102		
A 1C 1MYK30036A	36	108	114		
A 1C 1MYK30040A	40	120	126	20	20
A 1C 1MYK30048A	48	144	150		
A 1C 1MYK30050A	50	150	156	20	20
A 1C 1MYK30056A	56	168	174		
A 1C 1MYK30060A	60	180	186		

FIG. 2 • WITH KEYWAY

MATERIAL: Steel

Catalog Number	No. of Teeth	P.D.	D	d* Bore H7	S Face Width	D <sub>1</sub> Dia.	d <sub>1</sub> Dia.	w	t
A 1C11MYK30020A	20	60	66						
A 1C11MYK30024A	24	72	78	20	22	No Web	No Web	6	2.8
A 1C11MYK30025A	25	75	81						
A 1C11MYK30028A	28	84	90						
A 1C11MYK30030A	30	90	96	25	22	No Web	No Web	8	3.3
A 1C11MYK30032A	32	96	102						
A 1C11MYK30036A	36	108	114	25	20	No Web	No Web	8	3.3
A 1C11MYK30040A	40	120	126						
A 1C11MYK30048A	48	144	150	25	20	50	116	8	3.3
A 1C11MYK30050A	50	150	156				122		
A 1C11MYK30056A	56	168	174				140		
A 1C11MYK30060A	60	180	186	25	20	50	152	8	3.3
△ A 1C 1MYK30060				28		56		7	3

△To be discontinued when current stock is depleted.

\*Bore Tolerance: 16 & 18 mm + 0.018  
20, 25 & 28 mm + 0.021

These gears are made using STANDARDIZED BLANK SIZES, and are not available from stock. Due to availability of blanks, however, delivery is short.

■ ISO CLASS 8

■ 20° PRESSURE ANGLE

■ 30 mm FACE

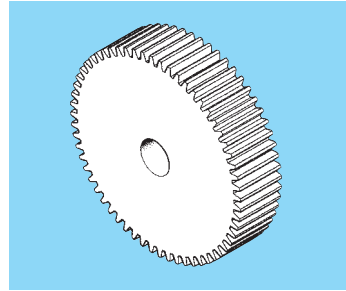
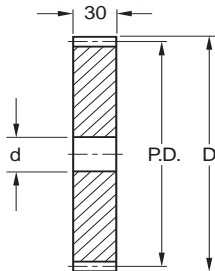

QUALITY CLASS

MATERIAL: 303 Stainless Steel

Catalog Number	No. of Teeth	P.D.	D	d* Bore H7
S12N30M032S3020	32	96	102	20
S12N30M035S3020	35	105	111	
S12N30M036S3020	36	108	114	
S12N30M040S3025	40	120	126	25
S12N30M042S3025	42	126	132	
S12N30M045S3025	45	135	141	
S12N30M048S3025	48	144	150	
S12N30M050S3025	50	150	156	
S12N30M055S3025	55	165	171	
S12N30M056S3025	56	168	174	
S12N30M060S3025	60	180	186	

\*Bore Tolerance: 20 &amp; 25 mm +0.021

Available as special order: Number of teeth not listed, different bore size and/or material, passivation.

## Did You Know?

...We have a well-equipped machine shop with state-of-the-art machinery.  
We can customize to your specifications for a nominal fee.



■ ISO CLASS 8

■ 20° PRESSURE ANGLE

■ 30 & 35 mm FACE WIDTH

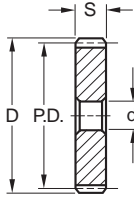

Fig. 1

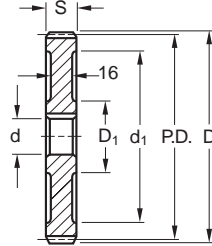
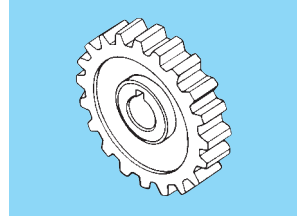
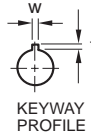

Fig. 2



**QUALITY CLASS**

FIG. 1 • WITHOUT KEYWAY

MATERIAL: Steel

Catalog Number	No. of Teeth	P.D.	D	d* Bore H7	S Face Width
A 1C 1MYKW30014	14	42	48		
A 1C 1MYKW30015	15	45	51	16	35
A 1C 1MYKW30016	16	48	54		
A 1C 1MYKW30018	18	54	60		
A 1C 1MYKW30020	20	60	66	18	35
A 1C 1MYKW30024	24	72	78		
A 1C 1MYKW30025	25	75	81	20	35
A 1C 1MYKW30028	28	84	90		
A 1C 1MYKW30030	30	90	96	22	30
A 1C 1MYKW30032	32	96	102		

FIG. 2 • WITH KEYWAY

MATERIAL: Steel

Catalog Number	No. of Teeth	P.D.	D	d* Bore H7	S Face Width	D <sub>1</sub> Dia.	d <sub>1</sub> Dia.	w Dim.	t Dim.
A 1C11MYKW30020	20	60	66	20	35	No Web	No Web	6	2.8
A 1C11MYKW30024	24	72	78						
A 1C11MYKW30025	25	75	81	25	35	No Web	No Web	8	3.3
A 1C11MYKW30028	28	84	90						
A 1C11MYKW30032	32	96	102						
A 1C11MYKW30036	36	108	114		30	No Web	No Web	8	3.3
A 1C11MYKW30040	40	120	126						
A 1C11MYKW30048	48	144	150	30			116		
A 1C11MYKW30050	50	150	156		30	60	122	8	3.3
A 1C11MYKW30060	60	180	186				152		

\*Bore Tolerance: 16 & 18 mm + 0.018  
20, 25 & 30 mm + 0.021

These gears are made using STANDARDIZED BLANK SIZES, and are not available from stock. Due to availability of blanks, however, delivery is short.