

- ISO CLASS 7
- 5 mm FACE WIDTH

- 20° PRESSURE ANGLE
- 5, 8 & 10 mm BORE

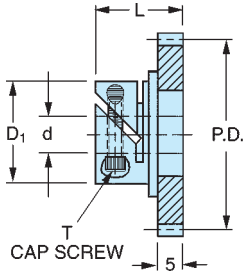

Fig. 1

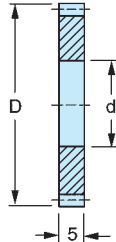
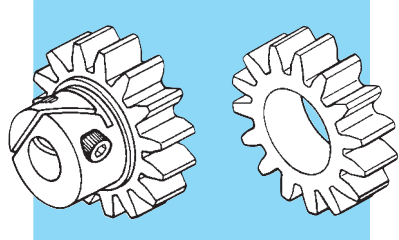

Fig. 2



1 GEARS

Fig.	Bore Ref.	T	D ₁	L
1	5	M2.5	14	13.5
	8	M3	17	14.8

MATERIALS: Gear – Acetal
Hub – 303 Stainless Steel

Catalog Number			No. of Teeth	P.D.	D
FAIRLOC® TYPE HUB GEAR (Fig. 1)		HUBLESS (Fig. 2)			
d = ø5 H7	d = ø8 H7	d = ø10 H8			
S1VZ05M028T0505	S1VZ05M028T0508	S12M05M028N0510	28	14	15
S1VZ05M029T0505	S1VZ05M029T0508	S12M05M029N0510	29	14.5	15.5
S1VZ05M030T0505	S1VZ05M030T0508	S12M05M030N0510	30	15	16
S1VZ05M032T0505	S1VZ05M032T0508	S12M05M032N0510	32	16	17
S1VZ05M036T0505	S1VZ05M036T0508	S12M05M036N0510	36	18	19
S1VZ05M040T0505	S1VZ05M040T0508	S12M05M040N0510	40	20	21
S1VZ05M044T0505	S1VZ05M044T0508	S12M05M044N0510	44	22	23
S1VZ05M045T0505	S1VZ05M045T0508	S12M05M045N0510	45	22.5	23.5
S1VZ05M048T0505	S1VZ05M048T0508	S12M05M048N0510	48	24	25
S1VZ05M050T0505	S1VZ05M050T0508	S12M05M050N0510	50	25	26
S1VZ05M056T0505	S1VZ05M056T0508	S12M05M056N0510	56	28	29
S1VZ05M060T0505	S1VZ05M060T0508	S12M05M060N0510	60	30	31
S1VZ05M064T0505	S1VZ05M064T0508	S12M05M064N0510	64	32	33
S1VZ05M068T0505	S1VZ05M068T0508	S12M05M068N0510	68	34	35
S1VZ05M070T0505	S1VZ05M070T0508	S12M05M070N0510	70	35	36
S1VZ05M072T0505	S1VZ05M072T0508	S12M05M072N0510	72	36	37
S1VZ05M075T0505	S1VZ05M075T0508	S12M05M075N0510	75	37.5	38.5
S1VZ05M080T0505	S1VZ05M080T0508	S12M05M080N0510	80	40	41
S1VZ05M084T0505	S1VZ05M084T0508	S12M05M084N0510	84	42	43
S1VZ05M090T0505	S1VZ05M090T0508	S12M05M090N0510	90	45	46
S1VZ05M092T0505	S1VZ05M092T0508	S12M05M092N0510	92	46	47
S1VZ05M096T0505	S1VZ05M096T0508	S12M05M096N0510	96	48	49
S1VZ05M100T0505	S1VZ05M100T0508	S12M05M100N0510	100	50	51
S1VZ05M110T0505	S1VZ05M110T0508	S12M05M110N0510	110	55	56
S1VZ05M120T0505	S1VZ05M120T0508	S12M05M120N0510	120	60	61
S1VZ05M138T0505	S1VZ05M138T0508	S12M05M138N0510	138	69	70
S1VZ05M144T0505	S1VZ05M144T0508	S12M05M144N0510	144	72	73
S1VZ05M168T0505	S1VZ05M168T0508	S12M05M168N0510	168	84	85
S1VZ05M180T0505	S1VZ05M180T0508	S12M05M180N0510	180	90	91
S1VZ05M186T0505	S1VZ05M186T0508	S12M05M186N0510	186	93	94

■ ISO CLASS 7

■ 20° PRESSURE ANGLE

■ 5 mm FACE WIDTH

■ 5, 8 & 10 mm BORE

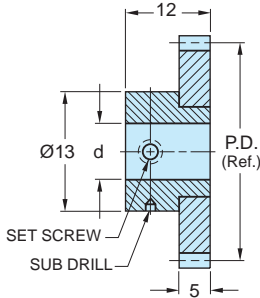

Fig. 1

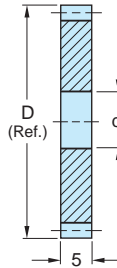
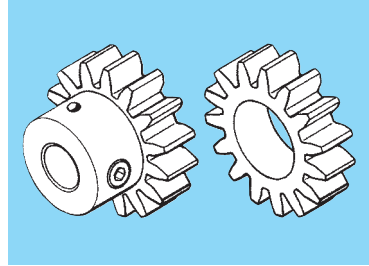

Fig. 2



S Precision Component

MATERIALS: Gear – Acetal
Hub – 303 Stainless Steel

Catalog Number			No. of Teeth	P.D. (Ref.)	D (Ref.)
PIN TYPE HUB GEAR (Fig. 1)		HUBLESS (Fig. 2)			
d = ø5 H7	d = ø8 H7	d = ø10 H8			
S10Z05M028T0505	S10Z05M028T0508	S12M05M028N0510	28	14	15
S10Z05M029T0505	S10Z05M029T0508	S12M05M029N0510	29	14.5	15.5
S10Z05M030T0505	S10Z05M030T0508	S12M05M030N0510	30	15	16
S10Z05M032T0505	S10Z05M032T0508	S12M05M032N0510	32	16	17
S10Z05M036T0505	S10Z05M036T0508	S12M05M036N0510	36	18	19
S10Z05M040T0505	S10Z05M040T0508	S12M05M040N0510	40	20	21
S10Z05M044T0505	S10Z05M044T0508	S12M05M044N0510	44	22	23
S10Z05M045T0505	S10Z05M045T0508	S12M05M045N0510	45	22.5	23.5
S10Z05M048T0505	S10Z05M048T0508	S12M05M048N0510	48	24	25
S10Z05M050T0505	S10Z05M050T0508	S12M05M050N0510	50	25	26
S10Z05M056T0505	S10Z05M056T0508	S12M05M056N0510	56	28	29
S10Z05M060T0505	S10Z05M060T0508	S12M05M060N0510	60	30	31
S10Z05M064T0505	S10Z05M064T0508	S12M05M064N0510	64	32	33
S10Z05M068T0505	S10Z05M068T0508	S12M05M068N0510	68	34	35
S10Z05M070T0505	S10Z05M070T0508	S12M05M070N0510	70	35	36
S10Z05M072T0505	S10Z05M072T0508	S12M05M072N0510	72	36	37
S10Z05M075T0505	S10Z05M075T0508	S12M05M075N0510	75	37.5	38.5
S10Z05M080T0505	S10Z05M080T0508	S12M05M080N0510	80	40	41
S10Z05M084T0505	S10Z05M084T0508	S12M05M084N0510	84	42	43
S10Z05M090T0505	S10Z05M090T0508	S12M05M090N0510	90	45	46
S10Z05M092T0505	S10Z05M092T0508	S12M05M092N0510	92	46	47
S10Z05M096T0505	S10Z05M096T0508	S12M05M096N0510	96	48	49
S10Z05M100T0505	S10Z05M100T0508	S12M05M100N0510	100	50	51
S10Z05M110T0505	S10Z05M110T0508	S12M05M110N0510	110	55	56
S10Z05M120T0505	S10Z05M120T0508	S12M05M120N0510	120	60	61
S10Z05M138T0505	S10Z05M138T0508	S12M05M138N0510	138	69	70
S10Z05M144T0505	S10Z05M144T0508	S12M05M144N0510	144	72	73
S10Z05M168T0505	S10Z05M168T0508	S12M05M168N0510	168	84	85
S10Z05M180T0505	S10Z05M180T0508	S12M05M180N0510	180	90	91
S10Z05M186T0505	S10Z05M186T0508	S12M05M186N0510	186	93	94

- ISO CLASS 7
- 20° PRESSURE ANGLE
- 3.2 mm FACE
- 10 mm BORE

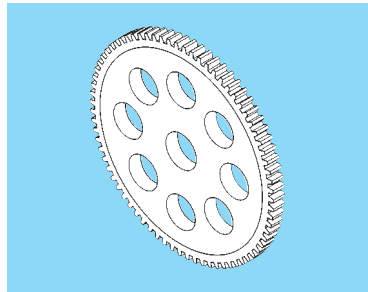
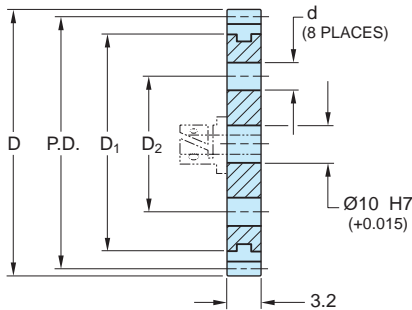

1 GEARS

MATERIAL: Core – Aluminum 2024-T3, Chemical Filmed
Rim – Acetal

Catalog Number	No. of Teeth	P.D.	D	D ₁ Dia.	d Dia.	D ₂ Dia.
S12Z05M048N0310	48	24	25	16	—	—
S12Z05M054N0310	54	27	28	22.3	—	—
S12Z05M060N0310	60	30	31	22.3	—	—
S12Z05M064N0310	64	32	33	28.6	—	—
S12Z05M065N0310	65	32.5	33.5	—	—	—
S12Z05M070N0310	70	35	36	28.6	—	—
S12Z05M072N0310	72	36	37	—	—	—
S12Z05M075N0310	75	37.5	38.5	—	—	—
S12Z05M080N0310	80	40	41	34.9	—	—
S12Z05M084N0310	84	42	43	—	—	—
S12Z05M085N0310	85	42.5	43.5	—	—	—
S12Z05M090N0310	90	45	46	41.3	5.5	20.6
S12Z05M092N0310	92	46	47	—	—	—
S12Z05M095N0310	95	47.5	48.5	—	—	—
S12Z05M096N0310	96	48	49	—	—	—
S12Z05M100N0310	100	50	51	47.7	8	27.8
S12Z05M105N0310	105	52.5	53.5	—	—	—
S12Z05M110N0310	110	55	56	—	—	—
S12Z05M115N0310	115	57.5	58.5	54	9.5	35
S12Z05M120N0310	120	60	61	54	—	—
S12Z05M130N0310	130	65	66	60.4	9.5	44.5
S12Z05M140N0310	140	70	71	66.7	—	—
S12Z05M144N0310	144	72	73	66.7	—	—
S12Z05M150N0310	150	75	76	73.1	—	—

See Index for hubs. Assembled upon request at a nominal charge.