

SOCKET HEAD CAP SCREWS

SDPSI

MATERIAL:

303 Stainless Steel

PHONE: 516.328.3300 • FAX: 516.326.8827 • WWW.SDP-SI.COM

SPECIFICATION:

Priced Per 100 Pieces

* Head may be supplied with or without knurl at SDP option.

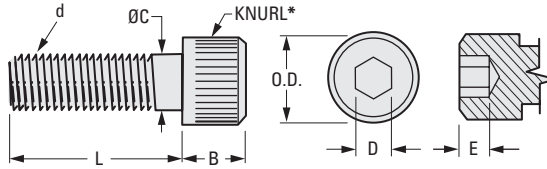

Thread Size Ref.	O.D. Max.	B Max.	C Max.	D Nom.	E Min.
#0-80	.096	.060	.060	.050	.025
#2-56	.140	.086	.086	5/64	.038
#4-40	.183	.112	.112	3/32	.051
#6-32	.226	.138	.138	7/64	.064
#8-32	.270	.164	.164	9/64	.077
#10-32	.312	.190	.190	5/32	.090

INCH COMPONENT

Catalog Number	d Thread Size	L Length
A 9X26-008004	#0-80	1/8
A 9X26-008006	#0-80	3/16
A 9X26-008008	#0-80	1/4
A 9X26-025604	#2-56	1/8
A 9X26-025606	#2-56	3/16
A 9X26-025608	#2-56	1/4
A 9X26-025610	#2-56	5/16
A 9X26-025612	#2-56	3/8
A 9X26-025616	#2-56	1/2
A 9X26-044006	#4-40	3/16
A 9X26-044008	#4-40	1/4
A 9X26-044010	#4-40	5/16
A 9X26-044012	#4-40	3/8
A 9X26-044014	#4-40	7/16
A 9X26-044016	#4-40	1/2
A 9X26-044020	#4-40	5/8
A 9X26-063206	#6-32	3/16
A 9X26-063208	#6-32	1/4
A 9X26-063210	#6-32	5/16
A 9X26-063212	#6-32	3/8
A 9X26-063214	#6-32	7/16

Catalog Number	d Thread Size	L Length
A 9X26-063216	#6-32	1/2
A 9X26-063220	#6-32	5/8
A 9X26-063224	#6-32	3/4
A 9X26-083208	#8-32	1/4
A 9X26-083210	#8-32	5/16
A 9X26-083212	#8-32	3/8
A 9X26-083214	#8-32	7/16
A 9X26-083216	#8-32	1/2
A 9X26-083220	#8-32	5/8
A 9X26-083224	#8-32	3/4
A 9X26-083228	#8-32	7/8
A 9X26-083232	#8-32	1
A 9X26-103208	#10-32	1/4
A 9X26-103210	#10-32	5/16
A 9X26-103212	#10-32	3/8
A 9X26-103214	#10-32	7/16
A 9X26-103216	#10-32	1/2
A 9X26-103220	#10-32	5/8
A 9X26-103224	#10-32	3/4
A 9X26-103228	#10-32	7/8
A 9X26-103232	#10-32	1

SOCKET HEAD CAP SCREWS



> MATERIAL:

Alloy Steel, Black Oxide

PHONE: 516.328.3300 • FAX: 516.326.8827 • WWW.SDP-SI.COM

> SPECIFICATION:

Priced Per 100 Pieces

* Head may be supplied with or without knurl at SDP option.

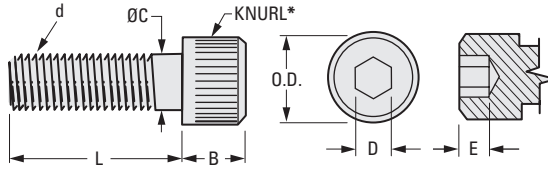

INCH COMPONENT

Catalog Number	d Thread Size	L Length	O.D. Max.	B Max.	C Max.	D Nom.	E Min.
A 9026-025608	#2-56	1/4	.140	.086	.086	5/64	.038
A 9026-025612	#2-56	3/8	.140	.086	.086	5/64	.038
A 9026-034812	#3-48	3/8	.161	.099	.099	5/64	.044
A 9026-034816	#3-48	1/2	.161	.099	.099	5/64	.044
A 9026-044008	#4-40	1/4	.183	.112	.112	3/32	.051
A 9026-044012	#4-40	3/8	.183	.112	.112	3/32	.051
A 9026-044016	#4-40	1/2	.183	.112	.112	3/32	.051
A 9026-044024	#4-40	3/4	.183	.112	.112	3/32	.051
A 9026-063208	#6-32	1/4	.226	.138	.138	7/64	.064
A 9026-063216	#6-32	1/2	.226	.138	.138	7/64	.064
A 9026-063220	#6-32	5/8	.226	.138	.138	7/64	.064
A 9026-063224	#6-32	3/4	.226	.138	.138	7/64	.064
A 9026-064008	#6-40	1/4	.226	.138	.138	7/64	.064
A 9026-064016	#6-40	1/2	.226	.138	.138	7/64	.064
A 9026-064020	#6-40	5/8	.226	.138	.138	7/64	.064
A 9026-064024	#6-40	3/4	.226	.138	.138	7/64	.064
A 9026-083212	#8-32	3/8	.270	.164	.164	9/64	.077
A 9026-083216	#8-32	1/2	.270	.164	.164	9/64	.077
A 9026-083224	#8-32	3/4	.270	.164	.164	9/64	.077
A 9026-083232	#8-32	1	.270	.164	.164	9/64	.077
A 9026-102416	#10-24	1/2	.312	.190	.190	5/32	.090
A 9026-102420	#10-24	5/8	.312	.190	.190	5/32	.090
A 9026-102424	#10-24	3/4	.312	.190	.190	5/32	.090
A 9026-102432	#10-24	1	.312	.190	.190	5/32	.090
A 9026-103212	#10-32	3/8	.312	.190	.190	5/32	.090
A 9026-103216	#10-32	1/2	.312	.190	.190	5/32	.090
A 9026-103224	#10-32	3/4	.312	.190	.190	5/32	.090
A 9026-103232	#10-32	1	.312	.190	.190	5/32	.090
A 9026-252016	1/4-20	1/2	.375	.250	.250	3/16	.120
A 9026-252024	1/4-20	3/4	.375	.250	.250	3/16	.120
A 9026-252032	1/4-20	1	.375	.250	.250	3/16	.120
A 9026-252048	1/4-20	1-1/2	.375	.250	.250	3/16	.120
A 9026-311816	5/16-18	1/2	.468	.312	.312	1/4	.151
A 9026-311824	5/16-18	3/4	.468	.312	.312	1/4	.151
A 9026-311832	5/16-18	1	.468	.312	.312	1/4	.151
A 9026-311848	5/16-18	1-1/2	.468	.312	.312	1/4	.151
A 9026-311856	5/16-18	1-3/4	.468	.312	.312	1/4	.151
A 9026-371624	3/8-16	3/4	.562	.375	.375	5/16	.182
A 9026-371632	3/8-16	1	.562	.375	.375	5/16	.182
A 9026-371648	3/8-16	1-1/2	.562	.375	.375	5/16	.182



MOLY COATED SOCKET HEAD CAP SCREWS

SDPSI

› MATERIAL:

Alloy Steel, Black Oxide, coated with Dry Molybdenum Disulfide

PHONE: 516.328.3300 • FAX: 516.326.8827 • WWW.SDP-SI.COM

› SPECIFICATION:

Priced Per 100 Pieces



* Head may be supplied with or without knurl at SDP option.

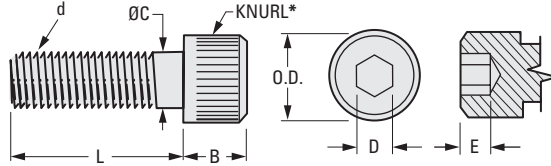

INCH COMPONENT

Catalog Number	d Thread Size	L Length	O.D. Max.	B Max.	C Max. Dia.	D Nom.	E Min.
A 9Q26-M025608	#2-56	1/4	.140	.086	.086	5/64	.038
A 9Q26-M025612	#2-56	3/8	.140	.086	.086	5/64	.038
A 9Q26-M034812	#3-48	3/8	.161	.099	.099	5/64	.044
A 9Q26-M034816	#3-48	1/2	.161	.099	.099	5/64	.044
A 9Q26-M044008	#4-40	1/4	.183	.112	.112	3/32	.051
A 9Q26-M044012	#4-40	3/8	.183	.112	.112	3/32	.051
A 9Q26-M044016	#4-40	1/2	.183	.112	.112	3/32	.051
A 9Q26-M044024	#4-40	3/4	.183	.112	.112	3/32	.051
A 9Q26-M063208	#6-32	1/4	.226	.138	.138	7/64	.064
A 9Q26-M063216	#6-32	1/2	.226	.138	.138	7/64	.064
A 9Q26-M063220	#6-32	5/8	.226	.138	.138	7/64	.064
A 9Q26-M063224	#6-32	3/4	.226	.138	.138	7/64	.064
A 9Q26-M064008	#6-40	1/4	.226	.138	.138	7/64	.064
A 9Q26-M064016	#6-40	1/2	.226	.138	.138	7/64	.064
A 9Q26-M064020	#6-40	5/8	.226	.138	.138	7/64	.064
A 9Q26-M064024	#6-40	3/4	.226	.138	.138	7/64	.064
A 9Q26-M083216	#8-32	1/2	.270	.164	.164	9/64	.077
A 9Q26-M083224	#8-32	3/4	.270	.164	.164	9/64	.077
A 9Q26-M083232	#8-32	1	.270	.164	.164	9/64	.077
A 9Q26-M103216	#10-32	1/2	.312	.190	.190	5/32	.090
A 9Q26-M103224	#10-32	3/4	.312	.190	.190	5/32	.090
A 9Q26-M103232	#10-32	1	.312	.190	.190	5/32	.090
A 9Q26-M252016	1/4-20	1/2	.375	.250	.250	3/16	.120
A 9Q26-M252024	1/4-20	3/4	.375	.250	.250	3/16	.120
A 9Q26-M252032	1/4-20	1	.375	.250	.250	3/16	.120
A 9Q26-M252048	1/4-20	1-1/2	.375	.250	.250	3/16	.120

SOCKET HEAD CAP SCREW KIT & HEX. WRENCHES



SOCKET HEAD CAP SCREW KIT

PHONE: 516.328.3300 • FAX: 516.326.8827 • WWW.SDP-SI.COM

> MATERIAL:

Alloy Steel, Black Oxide

> SPECIFICATION:

18 popular sizes - 360 Pieces



INCH COMPONENT

Catalog Number	Kit Contains 20 Each of the Following Socket Head Cap Screws		
A 9Q26-KIT001	#4-40 x 1/4	#8-32 x 1/2	1/4-20 x 1/2
	#4-40 x 1/2	#8-32 x 3/4	1/4-20 x 3/4
	#4-40 x 3/4	#8-32 x 1	1/4-20 x 1
	#6-32 x 1/4	#10-32 x 1/2	5/16-18 x 1/2
	#6-32 x 1/2	#10-32 x 3/4	5/16-18 x 3/4
	#6-32 x 3/4	#10-32 x 1	5/16-18 x 1

HEXAGONAL WRENCHES

> MATERIAL:

Steel, Plated

Hex Key Set available: **A 4Z15-HEXSET** contains 15 keys (.028 to 3/8).

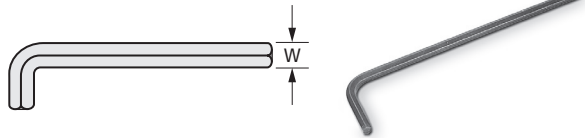

INCH COMPONENT

Catalog Number	W Across Flats	Cap Screw Size	Set Screw Size
A 4T15-028	.028	—	#0
A 4T15-035	.035	—	#1 & #2
A 4T15-050	.050	#0	#3 & #4
A 4T15-062	1/16	#1	#5 & #6
A 4T15-078	5/64	#2 & #3	#8
A 4T15-094	3/32	#4 & #5	#10
A 4T15-109	7/64	#6	—
A 4T15-125	1/8	—	1/4
A 4T15-140	9/64	#8	—
A 4T15-156	5/32	#10	5/16
A 4T15-188	3/16	1/4	3/8
A 4T15-218	7/32	—	7/16
A 4T15-250	1/4	5/16	1/2
A 4T15-312	5/16	3/8	5/8
A 4T15-375	3/8	1/2	3/4

I

R

T

1

2

3

4

5

6

7

8

9

10

11

12

13

14

15

16

NYLON SOCKET HEAD CAP SCREWS

SDP/SI

LIGHTWEIGHT
NONCORROSIVE
VIBRATION-RESISTANT
NONCONDUCTIVE
ANTIMAGNETIC

PHONE: 516.328.3300 • FAX: 516.326.8827 • WWW.SDP-SI.COM



› MATERIAL:

Nylon (Zytel 101)

› SPECIFICATION:

Priced Per 100 Pieces

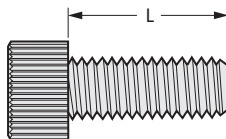

INCH COMPONENT

Catalog Number	Thread Size	L Length
A 9M52-044006	#4-40	3/8
A 9M52-044008	#4-40	1/2
A 9M52-044012	#4-40	3/4
A 9M52-044016	#4-40	1
A 9M52-063204	#6-32	1/4
A 9M52-063206	#6-32	3/8
A 9M52-063208	#6-32	1/2
A 9M52-063212	#6-32	3/4
A 9M52-063216	#6-32	1
A 9M52-083204	#8-32	1/4
A 9M52-083206	#8-32	3/8
A 9M52-083208	#8-32	1/2
A 9M52-083212	#8-32	3/4
A 9M52-083216	#8-32	1
A 9M52-103204	#10-32	1/4
A 9M52-103206	#10-32	3/8
A 9M52-103208	#10-32	1/2
A 9M52-103212	#10-32	3/4
A 9M52-103216	#10-32	1
A 9M52-252006	1/4-20	3/8
A 9M52-252010	1/4-20	5/8
A 9M52-252016	1/4-20	1
A 9M52-252020	1/4-20	1-1/4
A 9M52-252024	1/4-20	1-1/2
*A 9M52-252032	1/4-20	2
A 9M52-311816	5/16-18	1
*A 9M52-371616	3/8-16	1
*A 9M52-501324	1/2-13	1-1/2
A 9M52-501332	1/2-13	2

* Not fully threaded.

NYLON HEXAGONAL HEAD CAP SCREWS



LIGHTWEIGHT
NONCORROSIVE
VIBRATION-RESISTANT
NONCONDUCTIVE
ANTIMAGNETIC

PHONE: 516.328.3300 • FAX: 516.326.8827 • WWW.SDP-SI.COM

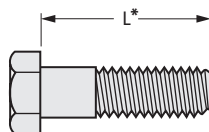

> MATERIAL:

Nylon (Zytel 101)

INCH COMPONENT

Catalog Number	Thread Size	L Length
*A 9P54-252008	1/4-20	1/2
*A 9P54-252010	1/4-20	5/8
*A 9P54-252012	1/4-20	3/4
A 9P54-252016	1/4-20	1
A 9P54-252020	1/4-20	1-1/4
A 9P54-252024	1/4-20	1-1/2
A 9P54-252032	1/4-20	2
A 9P54-252040	1/4-20	2-1/2
A 9P54-252048	1/4-20	3
A 9P54-252080	1/4-20	5
*A 9P54-311812	5/16-18	3/4
A 9P54-311816	5/16-18	1
A 9P54-311820	5/16-18	1-1/4
A 9P54-311824	5/16-18	1-1/2
A 9P54-311832	5/16-18	2
A 9P54-311840	5/16-18	2-1/2
*A 9P54-371608	3/8-16	1/2
*A 9P54-371612	3/8-16	3/4
A 9P54-371616	3/8-16	1
A 9P54-371620	3/8-16	1-1/4
A 9P54-371624	3/8-16	1-1/2
A 9P54-371632	3/8-16	2
A 9P54-371640	3/8-16	2-1/2
A 9P54-371648	3/8-16	3
A 9P54-371656	3/8-16	3-1/2
A 9P54-371664	3/8-16	4

Catalog Number	Thread Size	L Length
A 9P54-371672	3/8-16	4-1/2
A 9P54-371680	3/8-16	5
A 9P54-371688	3/8-16	5-1/2
A 9P54-371696	3/8-16	6
*A 9P54-501312	1/2-13	3/4
A 9P54-501316	1/2-13	1
A 9P54-501320	1/2-13	1-1/4
A 9P54-501324	1/2-13	1-1/2
A 9P54-501332	1/2-13	2
A 9P54-501340	1/2-13	2-1/2
A 9P54-501348	1/2-13	3
A 9P54-501356	1/2-13	3-1/2
A 9P54-501364	1/2-13	4
A 9P54-501372	1/2-13	4-1/2
A 9P54-501380	1/2-13	5
A 9P54-501388	1/2-13	5-1/2
A 9P54-501396	1/2-13	6
A 9P54-621132	5/8-11	2
A 9P54-621140	5/8-11	2-1/2
A 9P54-621148	5/8-11	3
A 9P54-621156	5/8-11	3-1/2
A 9P54-621164	5/8-11	4
A 9P54-621172	5/8-11	4-1/2
A 9P54-621180	5/8-11	5
A 9P54-621188	5/8-11	5-1/2
A 9P54-621196	5/8-11	6

* These screws are fully threaded.