



FOR COMPRESSION LOADS OF 18 TO 34 kgf  
SHEAR LOADS OF 9 TO 19 kgf

PHONE: 516.328.3300 • FAX: 516.326.8827 • WWW.SDP-SI.COM

**> MATERIAL:**

**Fastener** - Steel, Zinc Plated  
**Isolator** - Natural Rubber

**> NOTE:**

Maximum unthreaded portion of stud does not exceed 1.59 mm.

**> LOAD DEFLECTION GRAPHS:**

Deflections below the line x-x are considered safe practice for static loads; data above that line are useful for calculating deflections under dynamic loads.

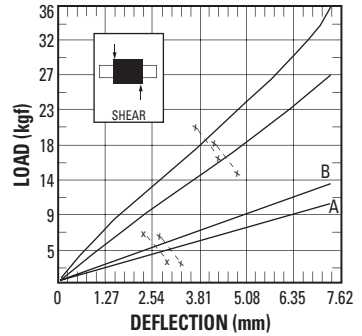
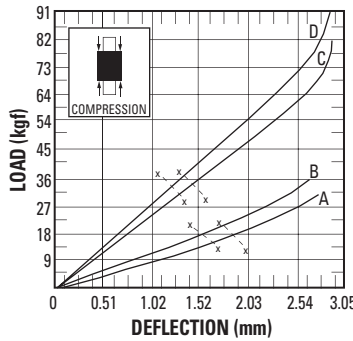
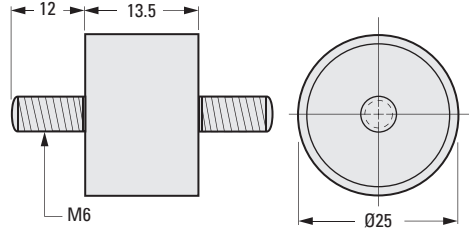

**METRIC COMPONENT CATALOG NUMBER**

**A 10Z 2 M 305 M 06**

Load Rating

A, B, C or D

Compression		Forcing Frequency in Cycles per Minute									
Load Rating	Maximum Load kgf	1100	1250	1500	1750	2000	2250	2500	2750	3000	3600
		Minimum Load for 81% Isolation (kgf)									
A	18.2	-	-	-	-	13.8	10.9	8.8	7.3	6.1	4.5
B	19.5	-	-	-	-	17.2	13.6	11.3	9.3	7.9	5.7
C	33.6	-	-	-	-	33.6	26.5	21.6	17.9	15	10.7
D	34	-	-	-	-	-	30.6	25.2	20.6	17.5	12.5

Shear		Forcing Frequency in Cycles per Minute									
Load Rating	Maximum Load kgf	1100	1250	1500	1750	2000	2250	2500	2750	3000	3600
		Minimum Load for 81% Isolation (kgf)									
A	8.6	7.1	5.7	3.8	2.9	*	*	*	*	*	*
B	9.5	8.6	7	4.8	3.6	2.9	2.3	*	*	*	*
C	16.8	-	14.3	10.2	7.7	6.4	5.2	4.3	*	*	*
D	19	-	18.1	13.3	10	8.4	7.2	5.9	5	4.3	*

\* At these forcing frequencies, lesser loads will yield 81% isolation.

FOR COMPRESSION LOADS OF 15 TO 36 kgf  
SHEAR LOADS OF 8 TO 18 kgf

PHONE: 516.328.3300 • FAX: 516.326.8827 • WWW.SDP-SI.COM



► **MATERIAL:**

**Fastener** - Steel, Zinc Plated  
**Isolator** - Natural Rubber

► **NOTE:**

Maximum unthreaded portion of stud does not exceed 1.59 mm.



► **LOAD DEFLECTION GRAPHS:**

Deflections below the line x-x are considered safe practice for static loads; data above that line are useful for calculating deflections under dynamic loads.

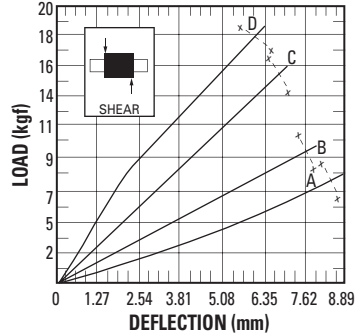
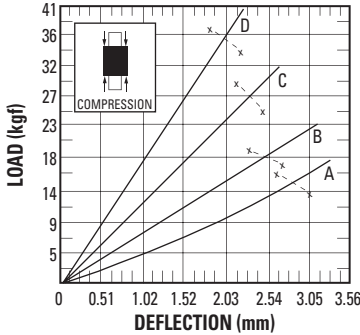
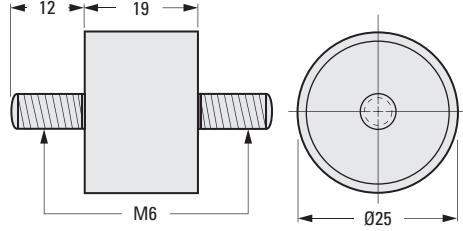

**METRIC COMPONENT CATALOG NUMBER**

**A 10Z 2 M 300 □ M 06**

Load Rating  
A, B, C or D

Compression		Forcing Frequency in Cycles per Minute									
Load Rating	Maximum Load kgf	850	1100	1250	1500	1750	2000	2250	2500	3000	3600
		Minimum Load for 81% Isolation (kgf)									
A	15	-	-	-	13.2	9.5	7.3	5.7	4.8	3.2	2.3
B	18.1	-	-	-	17.9	12.9	9.8	7.7	6.4	4.3	3.2
C	27.2	-	-	-	-	22.2	16.8	13.4	10.9	7.7	5.2
D	35.9	-	-	-	-	32.9	25	19.7	16.3	11.1	7.7

Shear		Forcing Frequency in Cycles per Minute									
Load Rating	Maximum Load kgf	850	1100	1250	1500	1750	2000	2250	2500	3000	3600
		Minimum Load for 81% Isolation (kgf)									
A	8.2	7.3	4.2	3.3	2.3	1.7	1.3	1	0.8	0.5	*
B	9.5	-	5.9	4.6	3.2	2.3	1.8	1.4	1.2	0.8	*
C	15.4	-	11.1	9.1	6.7	5.1	4.1	3.4	2.8	2	1.6
D	18.1	-	14.5	11.8	8.6	6.7	5.5	4.5	3.8	2.7	2.3

\* At these forcing frequencies, lesser loads will yield 81% isolation.



FOR COMPRESSION LOADS OF 21 TO 48 kgf  
SHEAR LOADS OF 12 TO 30 kgf

PHONE: 516.328.3300 • FAX: 516.326.8827 • WWW.SDP-SI.COM



► **MATERIAL:**

**Fastener** - Steel, Zinc Plated  
**Isolator** - Natural Rubber



► **LOAD DEFLECTION GRAPHS:**

Deflections below the line x-x are considered safe practice for static loads; data above that line are useful for calculating deflections under dynamic loads.

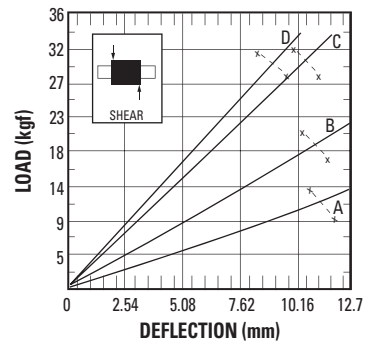
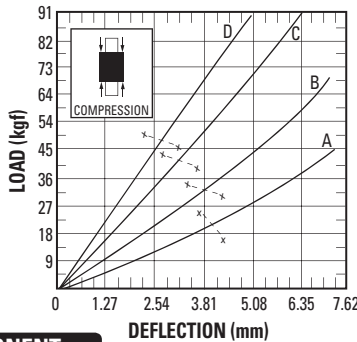
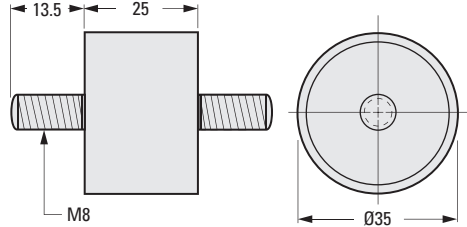

**METRIC COMPONENT  
CATALOG NUMBER**

**A 10 Z 2 M 3 11 □ M 08**

Load Rating  
A, B, C or D

Compression		Forcing Frequency in Cycles per Minute									
Load Rating	Maximum Load kgf	700	850	1100	1250	1500	1750	2000	2250	2500	3000
		Minimum Load for 81% Isolation (kgf)									
A	21.3	-	-	-	20.2	13.6	10	8.2	6.1	5	-
B	33.6	-	-	-	32.9	22	16.1	12.3	9.5	7.9	5.7
C	43.5	-	-	-	-	34.3	25.5	19.5	15.4	12.7	8.8
D	47.6	-	-	-	-	45.4	33.1	25.6	20.4	17.2	11.6

Shear		Forcing Frequency in Cycles per Minute									
Load Rating	Maximum Load kgf	700	850	1100	1250	1500	1750	2000	2250	2500	3000
		Minimum Load for 81% Isolation (kgf)									
A	12.3	12.3	8.8	5.2	4.1	2.7	*	*	*	*	*
B	18.6	-	14.1	8.6	6.6	4.8	3.6	*	*	*	*
C	29.9	-	24.3	15	12	8.6	6.4	5.2	4.1	*	*
D	29.9	-	27.7	17.2	13.8	10	8.8	5.9	4.8	3.9	*

\* At these forcing frequencies, lesser loads will yield 81% isolation.

FOR COMPRESSION LOADS OF 19 TO 54 kgf  
SHEAR LOADS OF 10 TO 29 kgf

PHONE: 516.328.3300 • FAX: 516.326.8827 • WWW.SDP-SI.COM

**> MATERIAL:**

**Fastener** - Steel, Zinc Plated  
**Isolator** - Natural Rubber

**> LOAD DEFLECTION GRAPHS:**

Deflections below the line x-x are considered safe practice for static loads; data above that line are useful for calculating deflections under dynamic loads.

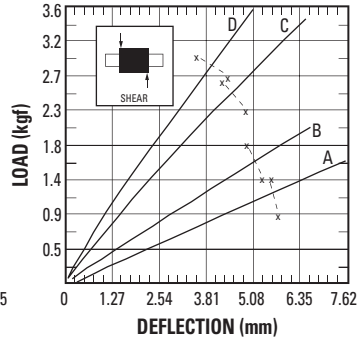
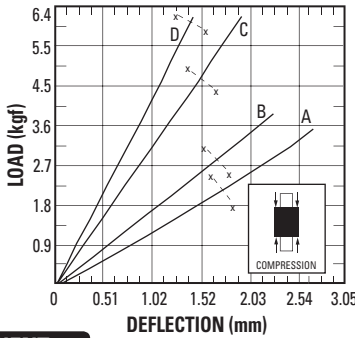
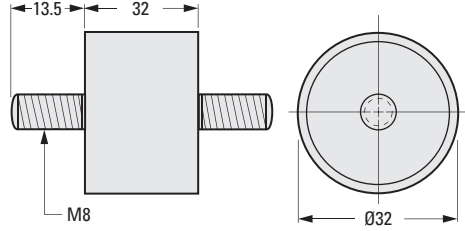

**METRIC COMPONENT CATALOG NUMBER**

**A 10Z 2 M 310 □ M 08**

Load Rating  
A, B, C or D

Compression		Forcing Frequency in Cycles per Minute									
Load Rating	Maximum Load kgf	600	850	950	1100	1250	1500	1750	2000	2500	3000
		Minimum Load for 81% Isolation (kgf)									
A	18.6	-	-	-	15.7	12.5	8.6	6.4	4.5	3.2	-
B	29	-	-	-	-	21.8	14.5	10.9	7.9	5.5	3.9
C	40.8	-	-	-	-	36.3	25	18.8	13.6	9.1	6.4
D	54.4	-	-	-	-	-	40.4	32	24	17.5	12

Shear		Forcing Frequency in Cycles per Minute									
Load Rating	Maximum Load kgf	600	850	950	1100	1250	1500	1750	2000	2500	3000
		Minimum Load for 81% Isolation (kgf)									
A	9.5	9.1	5	3.9	3	2.5	*	*	*	*	*
B	14.1	-	8.2	6.4	4.8	3.6	2.5	*	*	*	*
C	21.8	-	14.3	11.3	8.8	7	5	3.9	*	*	*
D	28.6	-	22.7	18.6	14.8	12.5	9.3	7.3	6.4	3.6	*

\* At these forcing frequencies, lesser loads will yield 81% isolation.

I  
R  
T  
1  
2  
3  
4  
5  
6  
7  
8  
9  
10  
11  
12  
13  
14  
15  
A

# CYLINDRICAL MOUNTINGS • TO 64 kgf



FOR COMPRESSION LOADS OF 25 TO 64 kgf  
SHEAR LOADS OF 15 TO 29 kgf

PHONE: 516.328.3300 • FAX: 516.326.8827 • WWW.SDP-SI.COM



**► MATERIAL:**

**Fastener** - Steel, Zinc Plated  
**Isolator** - Natural Rubber

**► LOAD DEFLECTION GRAPHS:**

Deflections below the line x-x are considered safe practice for static loads; data above that line are useful for calculating deflections under dynamic loads.

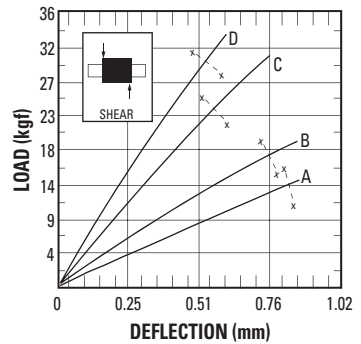
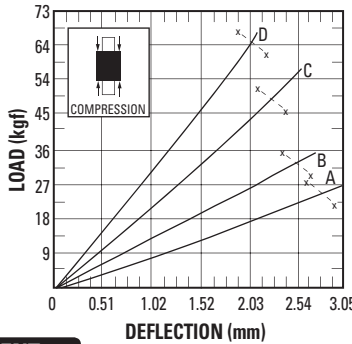
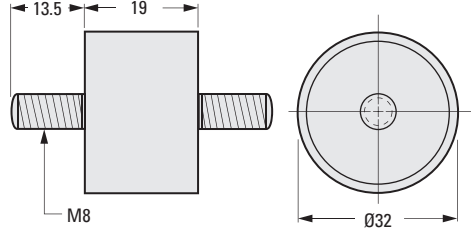

**METRIC COMPONENT CATALOG NUMBER**

**A 10 Z 2 M 3 1 4 □ M 0 8**

Load Rating  
A, B, C or D

Compression		Forcing Frequency in Cycles per Minute									
Load Rating	Maximum Load kgf	950	1100	1250	1500	1750	2000	2250	2500	3000	3600
		Minimum Load for 81% Isolation (kgf)									
A	25.4	-	-	-	22.7	17.2	12.9	10.2	8.2	5.7	-
B	33.1	-	-	-	33.1	23.1	17.7	13.8	11.1	7.5	5.5
C	49.5	-	-	-	-	38.6	28.8	22.7	18.6	12.7	9.1
D	64.4	-	-	-	-	58.5	44.9	35.4	29	20	13.6

Shear		Forcing Frequency in Cycles per Minute									
Load Rating	Maximum Load kgf	950	1100	1250	1500	1750	2000	2250	2500	3000	3600
		Minimum Load for 81% Isolation (kgf)									
A	14.5	10.4	8.2	6.6	4.5	3.4	*	*	*	*	*
B	17.2	14.5	11.1	8.6	5.9	4.3	3.2	*	*	*	*
C	23.1	-	20.2	16.3	11.8	8.8	6.4	5.5	4.5	*	*
D	29	-	26.3	21.1	15.4	12.3	9.3	7.7	6.4	4.3	*

\* At these forcing frequencies, lesser loads will yield 81% isolation.

FOR COMPRESSION LOADS OF 42 TO 84 kgf  
SHEAR LOADS OF 16 TO 30 kgf

PHONE: 516.328.3300 • FAX: 516.326.8827 • WWW.SDP-SI.COM

► **MATERIAL:**

**Fastener** - Steel, Zinc Plated  
**Isolator** - Natural Rubber

► **LOAD DEFLECTION GRAPHS:**

Deflections below the line x-x are considered safe practice for static loads; data above that line are useful for calculating deflections under dynamic loads.

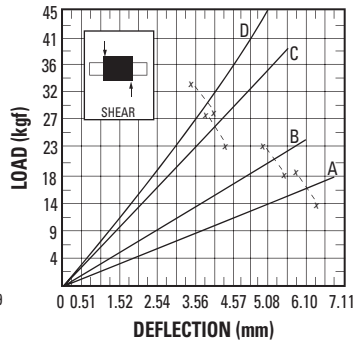
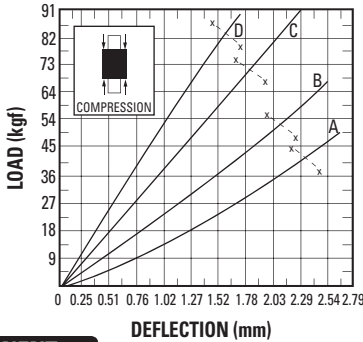
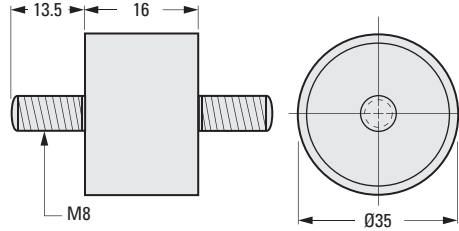

**METRIC COMPONENT CATALOG NUMBER**

**A 10Z 2M 312 M 08**

Load Rating  
A, B, C or D

Compression		Forcing Frequency in Cycles per Minute									
Load Rating	Maximum Load kgf	950	1100	1250	1500	1750	2000	2250	2500	2750	3000
		Minimum Load for 81% Isolation (kgf)									
A	42.2	-	-	-	-	32.2	23.1	17.7	14.1	11.3	-
B	53.5	-	-	-	-	48.1	36.7	29	23.6	19.5	15.9
C	71.7	-	-	-	-	-	54.9	43.5	35.8	29.5	24.5
D	83.9	-	-	-	-	-	74.4	59.4	49.5	40.8	33.6

Shear		Forcing Frequency in Cycles per Minute									
Load Rating	Maximum Load kgf	950	1100	1250	1500	1750	2000	2250	2500	2750	3000
		Minimum Load for 81% Isolation (kgf)									
A	16.3	15.4	11.3	8.6	6.1	4.5	*	*	*	*	*
B	20.9	-	17.2	13.6	9.5	7.3	5.5	4.3	*	*	*
C	25.9	-	-	22.7	15.9	11.8	9.1	7.3	5.9	*	*
D	30.4	-	-	29.9	20.9	15.4	11.8	9.5	8.2	6.4	*

\* At these forcing frequencies, lesser loads will yield 81% isolation.

- I
- R
- T
- 1
- 2
- 3
- 4
- 5
- 6
- 7
- 8
- 9
- 10
- 11
- 12
- 13
- 14
- 15
- A

# CYLINDRICAL MOUNTINGS • TO 95 kgf



FOR COMPRESSION LOADS OF 43 TO 95 kgf  
NOT RECOMMENDED FOR STATIC SHEAR LOADS

PHONE: 516.328.3300 • FAX: 516.326.8827 • WWW.SDP-SI.COM



➤ **MATERIAL:**

**Fastener** - Steel, Zinc Plated  
**Isolator** - Natural Rubber



➤ **LOAD DEFLECTION GRAPHS:**

Deflections below the line x-x are considered safe practice for static loads; data above that line are useful for calculating deflections under dynamic loads.

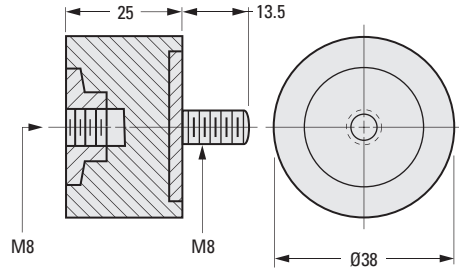

The projections shown are per ISO convention.

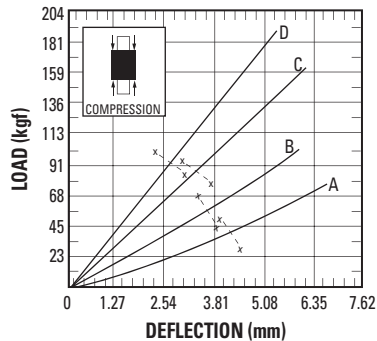

**METRIC COMPONENT CATALOG NUMBER**

**A 1 0 Z 2 M 3 0 8 □ M 0 8**

Load Rating  
A, B, C or D

Compression		Forcing Frequency in Cycles per Minute						
Load Rating	Maximum Load kgf	1150	1250	1500	1750	2000	2750	3500
Minimum Load for 81% Isolation (kgf)								
A	43.1	43.1	36.3	25	18.2	13.6	6.8	—
B	61.2	—	56.7	38.6	27.2	20.4	10	—
C	83.9	—	—	63.5	45.4	34	18.2	11.3
D	95.3	—	—	83.9	61.2	47.6	25	15.9