

SHAFT DIAMETERS - 5/64, 3/32 & 1/8

PHONE: 516.328.3300 • FAX: 516.326.8827 • WWW.SDP-SI.COM

**> MATERIAL:**

- Stainless Steel
- Ball Bearings



Sterling Instrument standard catalog end gears which are ordered at the same time as the below differential(s) will be assembled to the differential free of charge. See the Alphabetical Index for available standard end gears. 10 arc minutes maximum backlash between end gears.

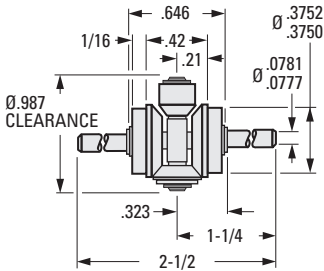

**Fig. 1**

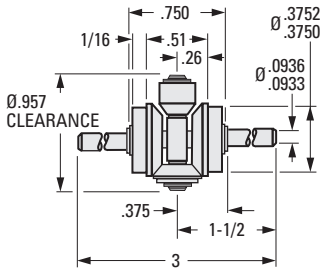

**Fig. 2**

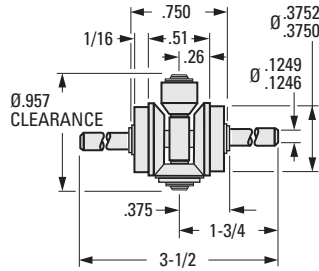

**Fig. 3**

**INCH COMPONENT**

Catalog Number	Fig. No.	Pitch	Shaft Dia.	Max. Torque Rating ozf in.	Max. Operating Speed rpm	Breakaway Torque ozf in.	Weight oz.
S9590A-TS4	1	96	5/64	20	1000	.05	.5
S9520A-TS5	2	96	3/32	20	1000	.05	.6
S9540A-TS6	3	96	1/8	17	1000	.05	.7

SHAFT DIAMETERS – 1/8, 3/16 & 1/4

PHONE: 516.328.3300 • FAX: 516.326.8827 • WWW.SDP-SI.COM

**MATERIAL:**

- Stainless Steel
- Ball Bearings



Sterling Instrument standard catalog end gears which are ordered at the same time as the below differential(s) will be assembled to the differential free of charge. Consult the differential end gear section of this catalog for available standard end gears. 10 arc minutes maximum backlash between end gears.

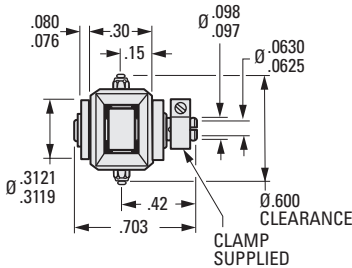

Fig. 1 96 PITCH

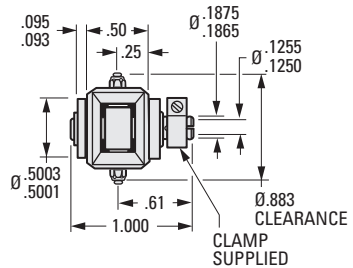

Fig. 2 64 PITCH

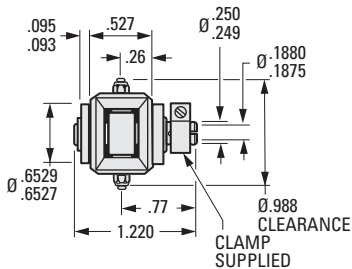

Fig. 3 64 PITCH

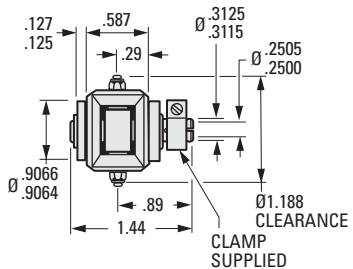

Fig. 4 64 PITCH

**INCH COMPONENT**

Catalog Number	Fig. No.	Pitch	Shaft Dia.	Max. Torque Rating ozf in.	Max. Operating Speed rpm	Breakaway Torque ozf in.	Weight oz.
S9490A-T700	1	96	1/16	8	700	.07	.5
S9430A-T701	2	64	1/8	25	900	.07	.6
S9440A-T702	3	64	3/16	27	900	.07	.8
S9460A-T703	4	64	1/4	28	900	.15	1.7

**> MATERIAL:**

- Stainless Steel
- Ball Bearings



Sterling Instrument standard catalog end gears which are ordered at the same time as the below differential(s) will be assembled to the differential free of charge. Consult the differential end gear section of this catalog for available standard end gears. 10 arc minutes maximum backlash between end gears.

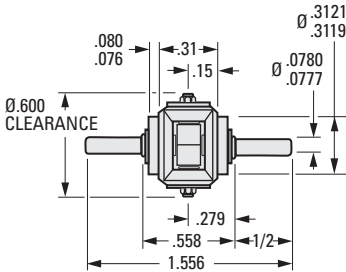

Fig. 1 96 Pitch

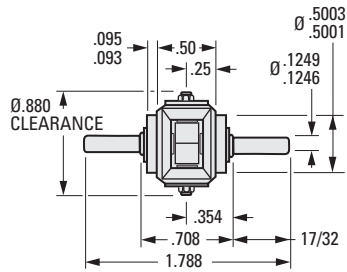

Fig. 2 64 Pitch

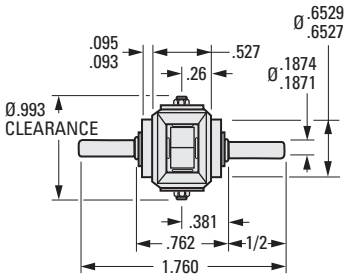

Fig. 3 64 Pitch

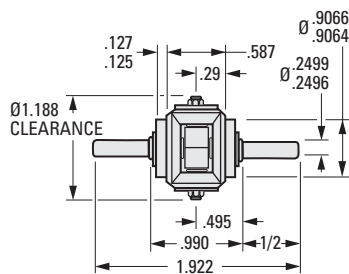

Fig. 4 64 Pitch

**INCH COMPONENT**

Catalog Number	Fig. No.	Pitch	Shaft Dia.	Max. Torque Rating ozf in.	Max. Operating Speed rpm	Breakaway Torque ozf in.	Weight oz.
S9590A-T708	1	96	5/64	10	1000	.05	.5
S9540A-T709	2	64	1/8	25	1000	.07	.6
S9550A-T710	3	64	3/16	25	1000	.07	.8
S9570A-T711	4	64	1/4	30	1000	.15	1.9

- I
- R
- T
- 1
- 2
- 3
- 4
- 5
- 6
- 7
- 8
- 9
- 10
- 11
- 12
- 13
- 14
- 15
- 16

SHAFT DIAMETERS - 1/8, 3/16 & 1/4

PHONE: 516.328.3300 • FAX: 516.326.8827 • WWW.SDP-SI.COM

**MATERIAL:**

Stainless Steel with Anodized Aluminum Spider Gear  
Ball Bearings



Sterling Instrument standard catalog end gears which are ordered at the same time as the below differential(s) will be assembled to the differential free of charge. Consult the differential end gear section of this catalog for available standard end gears. 10 arc minutes maximum backlash between end gears.

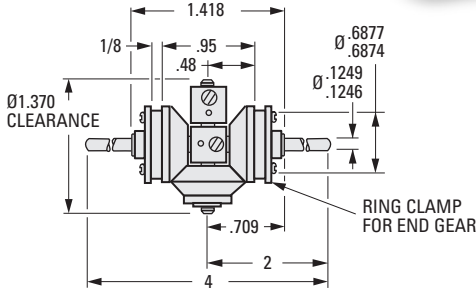

Fig. 1 72 Pitch

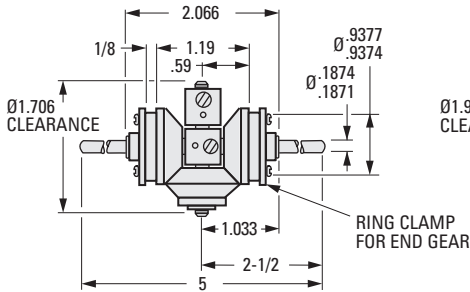

Fig. 2 64 Pitch

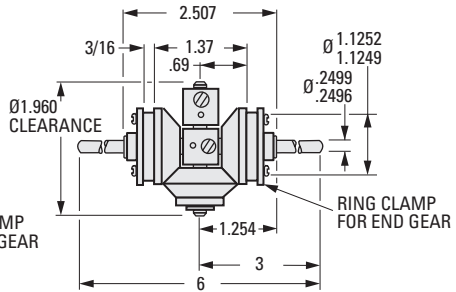

Fig. 3 48 Pitch

**INCH COMPONENT**

Catalog Number	Fig. No.	Pitch	Shaft Dia.	Max. Torque Rating ozf in.	Max. Operating Speed rpm	Breakaway Torque ozf in.	Weight oz.
S9540A-TS1	1	72	1/8	49	600	.2	2.3
S9550A-TS2	2	64	3/16	80	2400	.2	5.2
S9570A-TS3	3	48	1/4	80	2400	.09	7.5

## ANTI-BACKLASH DIFFERENTIAL - 72 PITCH

PHONE: 516.328.3300 • FAX: 516.326.8827 • WWW.SDP-SI.COM

PATENT NO. 3,137,181

**> MATERIAL:**

- Stainless Steel
- Ball Bearings

Sterling Instrument standard catalog end gears which are ordered at the same time as the below differential will be assembled to the differential free of charge. Consult the differential end gear section of this catalog for available standard end gears. Zero backlash between end gears.

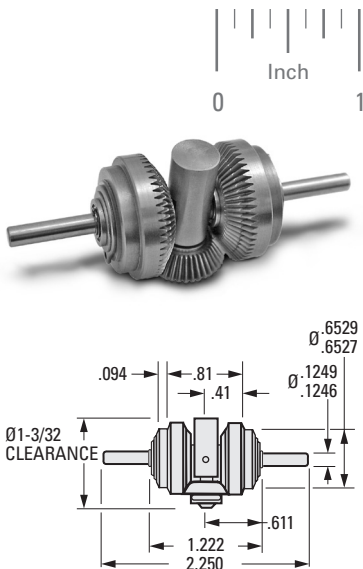

### INCH COMPONENT

Catalog Number	Pitch	Max. Torque Rating ozf in.	Max. Operating Speed rpm	Breakaway Torque (One Tooth Load) ozf in.	Breakaway Torque (Three Tooth Load) ozf in.	Weight oz.
S9540A-TS9	72	50	1000	.15	.3	1.8

## STANDARD DIFFERENTIAL - 64 PITCH

**> MATERIAL:**

- Stainless Steel
- Ball Bearings

Sterling Instrument standard catalog end gears which are ordered at the same time as the below differential will be assembled to the differential free of charge. Consult the differential end gear section of this catalog for available standard end gears. 10 arc minutes maximum backlash between end gears.

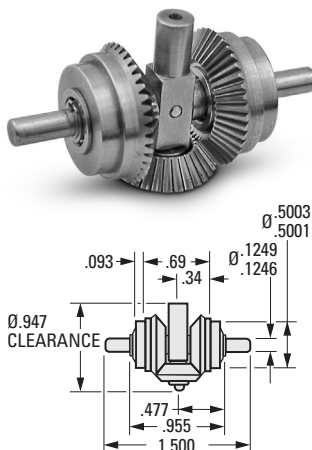

### INCH COMPONENT

Catalog Number	Pitch	Max. Torque Rating ozf in.	Max. Operating Speed rpm	Breakaway Torque ozf in.	Weight oz.
S9540A-TS7	64	26	800	.08	.9

Rev: 9.11.13 JC