

NONMARRING  
ADJUSTABLE  
RIGID

PHONE: 516.328.3300 • FAX: 516.326.8827 • WWW.SDP-SI.COM



► **MATERIAL:**  
303 Stainless Steel

Other sizes material, available on special order.

Fairloc® hubs require controlled shaft tolerances.  
Suggested clearance fit between the bore and shaft is .001/.0008.

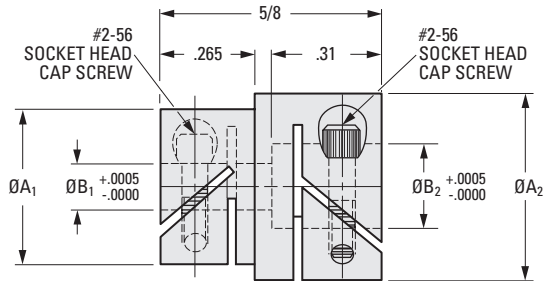

**NOTE:**  $B_1$  &  $B_2$  concentric with .001 T.I.R.

## INCH COMPONENT

Catalog Number	$B_1$ Bore	$A_1$ Dia.	Clear. Radius	$B_2$ Bore	$A_2$ Dia.	Clear. Radius
S51FCZ-090120	.0900	.437	.273	.1200	.437	.273
S51FCZ-090125	.0900	.437	.273	.1248	.437	.273
S51FCZ-090187	.0900	.437	.273	.1873	.437	.273
S51FCZ-090250	.0900	.437	.273	.2498	.530	.304
S51FCZ-094125	.0937	.437	.273	.1248	.437	.273
S51FCZ-094187	.0937	.437	.273	.1873	.437	.273
S51FCZ-094250	.0937	.437	.273	.2498	.530	.304
S51FCZ-120120	.1200	.437	.273	.1200	.437	.273
S51FCZ-120125	.1200	.437	.273	.1248	.437	.273
S51FCZ-120187	.1200	.437	.273	.1873	.437	.273
S51FCZ-120241	.1200	.437	.273	.2405	.530	.304
S51FCZ-120250	.1200	.437	.273	.2498	.530	.304
S51FCZ-125125	.1248	.437	.273	.1248	.437	.273
S51FCZ-125187	.1248	.437	.273	.1873	.437	.273
S51FCZ-125241	.1248	.437	.273	.2405	.530	.304
S51FCZ-125250	.1248	.437	.273	.2498	.530	.304
S51FCZ-187187	.1873	.437	.273	.1873	.437	.273
S51FCZ-187241	.1873	.437	.273	.2405	.530	.304
S51FCZ-187250	.1873	.437	.273	.2498	.530	.304
S51FCZ-250250	.2498	.530	.304	.2498	.530	.304