

WITHOUT CASING

PHONE: 516.328.3300 • FAX: 516.326.8827 • WWW.SDP-SI.COM

> MATERIAL:

Flexible Cable - Stainless Steel
End Fittings - Stainless Steel



> PERFORMANCE DATA:

Shaft Dia.	Mode of Operation	Operating Torque Capacity, Winding and Unwinding Directions (N•m) Input								Maximum Torsional Deflection at Load Indicated (Degrees per 30 cm of Shaft)		
		Radius of Curvature								N•m	Winding	Unwinding
		625	500	375	300	250	200	150	100			
3.3	Manual	1.12	1.08	1.01	0.94	0.87	0.76	0.59	0.24	0.113	11	20
3.3	Dynamic	0.65	0.63	0.59	0.55	0.51	0.44	0.34	0.14	0.113	11	20
3.8	Manual	1.69	1.63	1.52	1.42	1.31	1.15	0.89	0.36	0.113	7	10
3.8	Dynamic	0.99	0.95	0.89	0.83	0.77	0.67	0.52	0.21	0.113	7	10
4.8	Manual	2.89	2.78	2.6	2.42	2.24	1.97	1.52	0.62	0.113	2.7	4.8
4.8	Dynamic	1.69	1.62	1.52	1.41	1.31	1.15	0.89	0.36	0.113	2.7	4.8
6.4	Manual	7.32	6.94	6.32	5.69	5.06	4.12	2.55	—	1.13	9	12.6
6.4	Dynamic	4.27	4.05	3.68	3.32	2.95	2.4	1.49	—	1.13	9	12.6

SPECIAL ORDERS for Many Combinations of Fittings and Lengths Accepted.

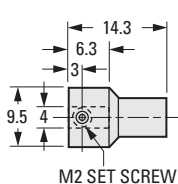
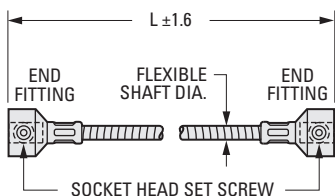

M2 SET SCREW

End Fitting No. 1

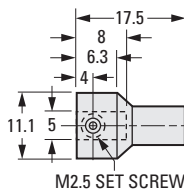

M2.5 SET SCREW

End Fitting No. 2

The projections shown are per ISO convention.

METRIC COMPONENT

Catalog Number	Flexible Shaft Diameter	L Length mm	End Fitting Number	Screw Size
S55S7MFSF33075	3.3	75	1	M2
S55S7MFG33075	3.3	75	2	M2.5
S55S7MFSF33100	3.3	100	1	M2
S55S7MFG33100	3.3	100	2	M2.5
S55S7MFG33125	3.3	125	2	M2.5
S55S7MFSH33125	3.3	125	3	M3
S55S7MFSH33150	3.3	150	3	M3
S55S7MFSH33200	3.3	200	3	M3
S55S7MFG38100	3.8	100	2	M2.5
S55S7MFG38125	3.8	125	2	M2.5
S55S7MFSH38125	3.8	125	3	M3
S55S7MFSH38150	3.8	150	3	M3
S55S7MFSH38200	3.8	200	3	M3
S55S7MFSH38250	3.8	250	3	M3
S55S7MFSH38300	3.8	300	3	M3
S55S7MFG48200	4.8	200	2	M2.5
S55S7MFSH48250	4.8	250	3	M3
S55S7MFSH48300	4.8	300	3	M3
S55S7MFSH64300	6.4	300	3	M3
S55S7MFSK64350	6.4	350	4	M4

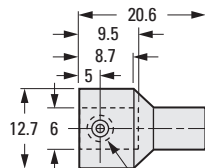

M3 SET SCREW

End Fitting No. 3

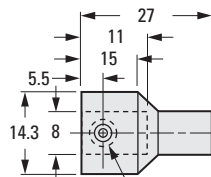

M4 2 SET SCREWS

End Fitting No. 4

WITHOUT CASING

PHONE: 516.328.3300 • FAX: 516.326.8827 • WWW.SDP-SI.COM

> MATERIAL:

Flexible Cable - Steel
End Fittings - Plated Steel



> PERFORMANCE DATA:

Shaft Dia.	Mode of Operation	Operating Torque Capacity, Winding and Unwinding Directions (N•m) Input											Maximum Torsional Deflection at Load Indicated (Degrees per 30 cm of Shaft)		
		Radius of Curvature											N•m	Winding	Unwinding
		625	500	375	300	250	200	150	100	62	50	38			
1.7	Dynamic	-	-	-	-	0.07	0.06	0.05	0.04	*	-	-	0.113	80	250
Δ 3.3A	Manual	-	-	-	-	-	-	-	0.22	0.17	0.13	0.06	0.113	40	50
3.3	Manual	-	-	-	0.86	0.8	0.75	0.63	0.41	-	-	-	0.113	13	13
3.3	Dynamic	-	-	-	0.43	0.41	0.37	0.32	0.2	-	-	-	0.113	13	13
3.8	Manual	-	2.36	2.2	2.08	1.94	1.73	1.37	0.7	-	-	-	0.113	6	6
3.8	Dynamic	-	1.19	1.11	1.04	0.97	0.87	0.69	0.35	-	-	-	0.113	6	6
4.8	Manual	-	3.77	3.55	3.22	3.12	2.8	2.24	1.13	-	-	-	0.113	3	3.3
4.8	Dynamic	-	1.89	1.77	1.66	1.56	1.4	1.12	0.57	-	-	-	0.113	3	3.3
6.4	Manual	10.51	9.79	9.38	8.59	7.91	7.01	5.09	-	-	-	-	1.13	10	13
6.4	Dynamic	5.31	4.63	4.63	4.29	3.96	3.5	2.6	-	-	-	-	1.13	10	13

SPECIAL ORDERS for Many Combinations of Fittings and Lengths Accepted.

* Can be operated manually to radius indicated with torsional breaking strength of 0.68 N • m clockwise.

Δ Can be used in dynamic mode if shaft length is shortened (approximately 50 mm long).

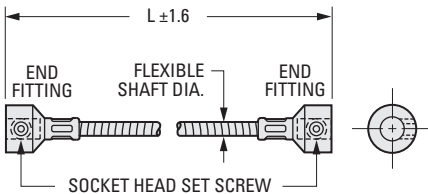

The projections shown are per ISO convention.

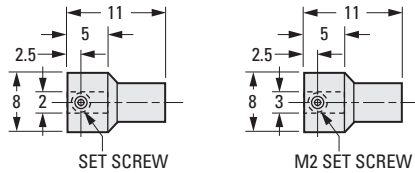

End Fitting No. 1A

End Fitting No. 1B

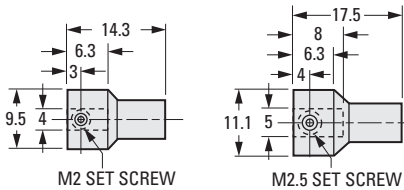

End Fitting No. 1

End Fitting No. 2

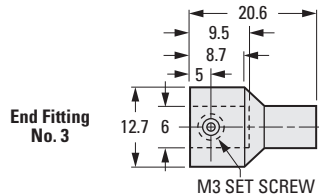

End Fitting No. 3

M3 SET SCREW

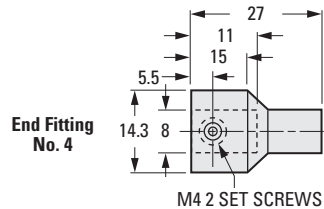

End Fitting No. 4

M4 2 SET SCREWS

METRIC COMPONENT

Catalog Number	Flexible Shaft Diameter	L Length mm	End Fitting Number
A 7C12M1705011	1.7	50	1A
A 7C12M1707611	1.7	76	1B
A 7C12M1710211	1.7	102	1B
A 7C12M3307611A	3.3A	76	1
A 7C12M3312722A	3.3A	127	2
A 7C12M3320333A	3.3A	203	3
A 7C12M3307622	3.3	76	2
A 7C12M3312733	3.3	127	3
A 7C12M3320333	3.3	203	3
A 7C12M3810222	3.8	102	2
A 7C12M3815233	3.8	152	3
A 7C12M3820333	3.8	203	3
A 7C12M3830533	3.8	305	3
A 7C12M4825433	4.8	254	3
A 7C12M4830533	4.8	305	3
A 7C12M6430533	6.4	305	3
A 7C12M6435544	6.4	355	4

NOTE: 3.3A diameter shaft has a greater degree of flexibility.

WITHOUT CASING
PANEL MOUNTING

PHONE: 516.328.3300 • FAX: 516.326.8827 • WWW.SDP-SI.COM

➤ **MATERIAL:**

Flexible Cable - Steel
End Fittings - Plated Steel



➤ **PERFORMANCE DATA:**

Shaft Dia.	Mode of Operation	Operating Torque Capacity, Winding and Unwinding Directions (N • m) Input										Maximum Torsional Deflection at Load Indicated (Degrees per 30 cm of Shaft)		
		Radius of Curvature										N • m	Winding	Unwinding
		500	375	300	250	200	150	100	62	50	38			
3.3A	Manual	-	-	-	-	-	-	0.22	0.17	0.13	0.06	0.113	40	50
3.3	Manual	-	-	0.86	0.8	0.75	0.63	0.41	-	-	-	0.113	13	13
3.8	Manual	2.36	2.2	2.08	1.94	1.72	1.36	0.7	-	-	-	0.113	6	6
4.8	Manual	3.78	3.55	3.32	3.12	2.8	2.24	1.13	-	-	-	0.113	3	3.3

SPECIAL ORDERS for Many Combinations of Fittings and Lengths Accepted.

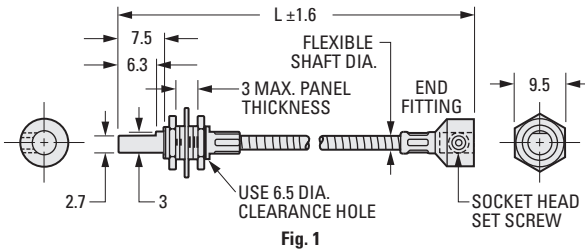
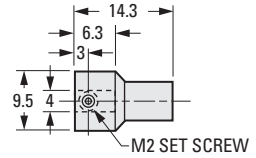

Fig. 1



End Fitting No. 1

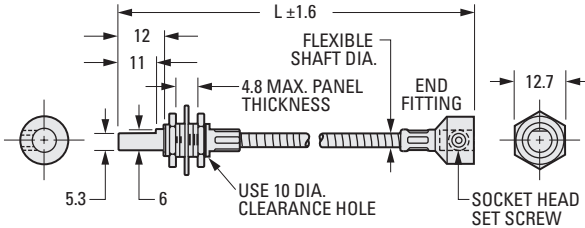
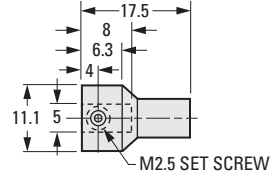

Fig. 2



End Fitting No. 2

The projections shown are per ISO convention.

METRIC COMPONENT

Catalog Number	Flexible Shaft Diameter	L Length mm	End Fitting Number
Fig. 1			
A 7C13M3307611A	3.3A	76	1
A 7C13M3310222A	3.3A	102	2
Fig. 2			
A 7C13M3307611	3.3	76	1
A 7C13M3310222	3.3	102	2
A 7C13M3812722	3.8	127	2
A 7C13M3820333	3.8	203	3
A 7C13M4822822	4.8	228	2
A 7C13M4820333	4.8	203	3
A 7C13M4835533	4.8	355	3

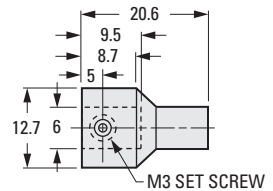

End Fitting No. 3

NOTE: 3.3A diameter shaft has a greater degree of flexibility.