

RIGHT- AND LEFT-HAND  
MODULE 1, 1.5 & 2  
45° HELIX  
20° PRESSURE ANGLE

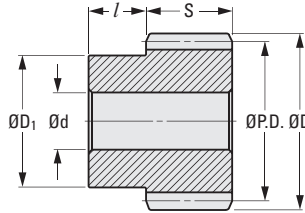

➤ **MATERIAL:**  
Steel



**METRIC COMPONENT**

Catalog Number		No of Teeth	P.D.	D Dia.	d Bore H8	d Tolerance	S Face Width	D <sub>1</sub> Hub Dia.	l Hub Proj.
Right-Hand	Left-Hand								
<b>Module 1</b>									
A 1C 7MYK10013R	A 1C 7MYK10013L	13	18.4	20.4	8	+0.022/0	12	15	10
A 1C 7MYK10026R	A 1C 7MYK10026L	26	36.8	38.8	10	+0.022/0	12	32	10
<b>Module 1.5</b>									
A 1C 7MYK15013R	A 1C 7MYK15013L	13	27.6	30.6	10	+0.022/0	15	23	10
A 1C 7MYK15026R	A 1C 7MYK15026L	26	55.2	58.2	12	+0.027/0	15	40	10
<b>Module 2</b>									
A 1C 7MYK20013R	A 1C 7MYK20013L	13	36.8	40.8	12	+0.027/0	20	30	13
A 1C 7MYK20026R	A 1C 7MYK20026L	26	73.5	77.5	16	+0.027/0	20	55	13

**INTERNAL GEARS - MODULE 1**

20° PRESSURE ANGLE

➤ **MATERIAL:**  
Steel

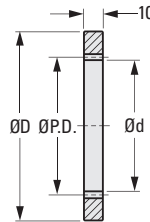

**METRIC COMPONENT**

Catalog Number	No. of Teeth	P.D.	D Dia.	d I.D.
A 1C10MYK10060	60	60	90	58
A 1C10MYK10072	72	72	100	70
A 1C10MYK10080	80	80	110	78
A 1C10MYK10084	84	84	115	82
A 1C10MYK10090	90	90	120	88
A 1C10MYK10096	96	96	125	94
A 1C10MYK10100	100	100	130	98
A 1C10MYK10108	108	108	140	106
A 1C10MYK10120	120	120	150	118