

DIN 6888

PHONE: 516.328.3300 • FAX: 516.326.8827 • WWW.SDP-SI.COM

> MATERIAL:  
Carbon Steel

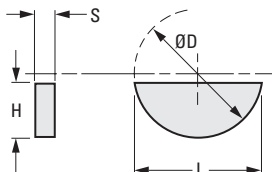

**METRIC COMPONENT**

Catalog Number	Width		Height		L Length	D Dia.	For Shaft Dia.	
	S	Tol.	H	Tol.			Over	To
A 9C49M01507	1.5	0/-0.025	2.6	0/-0.1	6.76	7	4	6
A 9C49M02007	2	0/-0.025	2.6	0/-0.1	6.76	7	6	8
A 9C49M02010	2	0/-0.025	3.7	0/-0.12	9.66	10	6	8
A 9C49M02013	2	0/-0.025	5	0/-0.12	12.65	13	6	8
A 9C49M02510	2.5	0/-0.025	3.7	0/-0.12	9.66	10	8	10
A 9C49M03010	3	0/-0.025	3.7	0/-0.12	9.66	10	8	10
A 9C49M03013	3	0/-0.025	5	0/-0.12	12.65	13	8	10
A 9C49M03016	3	0/-0.025	6.5	0/-0.15	15.72	16	8	10
A 9C49M03019	3	0/-0.025	7.5	0/-0.15	18.57	19	8	10
A 9C49M04013	4	0/-0.03	5	0/-0.12	12.65	13	10	12
A 9C49M04016	4	0/-0.03	6.5	0/-0.15	15.72	16	10	12
A 9C49M04019	4	0/-0.03	7.5	0/-0.15	18.57	19	10	12
A 9C49M04022	4	0/-0.03	9	0/-0.15	21.63	22	10	12
A 9C49M05016	5	0/-0.03	6.5	0/-0.15	15.72	16	12	17
A 9C49M05019	5	0/-0.03	7.5	0/-0.15	18.57	19	12	17
A 9C49M05022	5	0/-0.03	9	0/-0.15	21.63	22	12	17
A 9C49M05025	5	0/-0.03	10	0/-0.15	24.49	25	12	17
A 9C49M06022	6	0/-0.03	9	0/-0.15	21.63	22	17	22
A 9C49M06025	6	0/-0.03	10	0/-0.15	24.49	25	17	22
A 9C49M06028	6	0/-0.03	11	0/-0.18	27.35	28	17	22
A 9C49M08028	8	0/-0.036	11	0/-0.18	27.35	28	22	30
A 9C49M08032	8	0/-0.036	13	0/-0.18	31.43	32	22	30
A 9C49M10032	10	0/-0.036	13	0/-0.18	31.43	32	30	38
A 9C49M10045	10	0/-0.036	16	0/-0.18	43.08	45	30	38

DIN 6885A  
ROUND ENDED

PHONE: 516.328.3300 • FAX: 516.326.8827 • WWW.SDP-SI.COM

► **MATERIAL:**  
Carbon Steel

► **SPECIFICATION:**  
b Tolerance:

- 3 mm 0/-0.025
- 4 to 6 mm 0/-0.030
- 8 & 10 mm 0/-0.036
- 12, 14 & 16 mm 0/-0.043

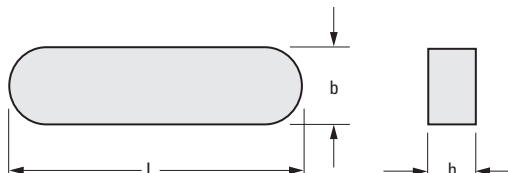

**METRIC COMPONENT**

Catalog Number	b Width h9	h Height	L Length
A 9C39M030306	3	3	6
A 9C39M030308	3	3	8
A 9C39M030310	3	3	10
A 9C39M030314	3	3	14
A 9C39M030320	3	3	20
A 9C39M030325	3	3	25
A 9C39M040408	4	4	8
A 9C39M040410	4	4	10
A 9C39M040414	4	4	14
A 9C39M040416	4	4	16
A 9C39M040420	4	4	20
A 9C39M040425	4	4	25
A 9C39M050510	5	5	10
A 9C39M050514	5	5	14
A 9C39M050516	5	5	16
A 9C39M050520	5	5	20
A 9C39M050525	5	5	25
A 9C39M050536	5	5	36
A 9C39M060610	6	6	10
A 9C39M060614	6	6	14
A 9C39M060616	6	6	16
A 9C39M060620	6	6	20
A 9C39M060628	6	6	28

Catalog Number	b Width h9	h Height	L Length
A 9C39M060636	6	6	36
A 9C39M080710	8	7	10
A 9C39M080716	8	7	16
A 9C39M080720	8	7	20
A 9C39M080725	8	7	25
A 9C39M080736	8	7	36
A 9C39M080845	8	7	45
A 9C39M100825	10	8	25
A 9C39M100828	10	8	28
A 9C39M100836	10	8	36
A 9C39M100845	10	8	45
A 9C39M100856	10	8	56
A 9C39M120828	12	8	28
A 9C39M120836	12	8	36
A 9C39M120845	12	8	45
A 9C39M120856	12	8	56
A 9C39M120863	12	8	63
A 9C39M140936	14	9	36
A 9C39M140945	14	9	45
A 9C39M140956	14	9	56
A 9C39M140963	14	9	63
A 9C39M161056	16	10	56
A 9C39M161063	16	10	63

- I
- R
- T
- 1
- 2
- 3
- 4
- 5
- 6
- 7
- 8
- 9
- 10**
- 11
- 12
- 13
- 14
- 15
- A