

QUIET RUNNING
 SELF-LUBRICATING
 TOLERATES SHOCK LOADS
 CORROSION-RESISTANT
 DAMPENS VIBRATION

PHONE: 516.328.3300 • FAX: 516.326.8827 • WWW.SDP-SI.COM

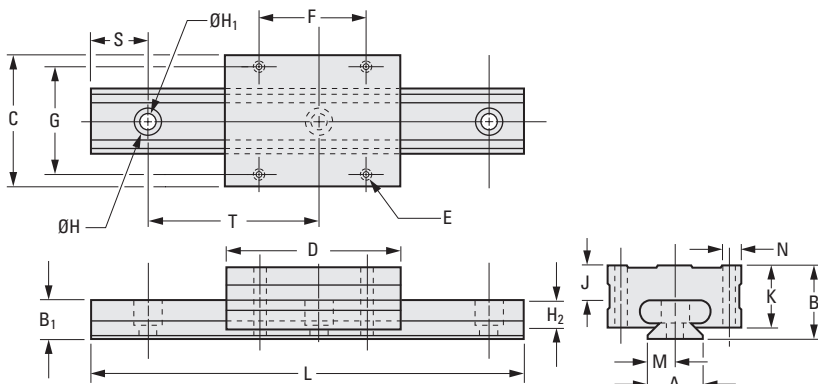
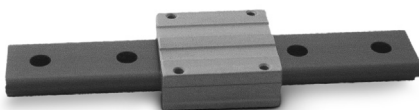

INCH COMPONENT CATALOG NUMBER

S 6 4 A M R -

Type Size Code Length Code

A – Precision .0010 – .0020 running clearance. FrelonGOLD® material on Rc 70 ceramic-coated aluminum
B – Compensated Precision .0025 – .0035 running clearance. FrelonGOLD® material on Rc 70 ceramic-coated aluminum

Size Code	Length Code (Length in Inches)						
	0157	0276	0335	0394	0512	—	—
07	1.57	2.76	3.35	3.94	5.12	—	—
	0217	0295	0374	0453	0610	0768	1083
09	2.17	2.95	3.74	4.53	6.10	7.68	10.83
	0472	0669	0866	1063	1260	1457	1850
12	4.72	6.69	8.66	10.63	12.60	14.57	18.50
	0591	0906	1220	1693	1850	2638	—
15	5.91	9.06	12.20	16.93	18.50	26.38	—
	0866	1102	1339	1811	2520	3465	—
20	8.66	11.02	13.39	18.11	25.20	34.65	—

Size (Ref.)	A	B	B ₁	C	D	E	F	G	H Dia.	H ₁ Dia.	H ₂	K	J	M	N	S	T
07	.28	.31	.24	.67	.94	M2	.31	.47	.17	.09	.09	.24	.07	.14	.09	.20	.59
09	.35	.39	.29	.79	1.18	M3	.51	.59	.18	.10	.12	.31	.09	.18	.10	.30	.79
12	.47	.51	.31	1.06	1.34	M3	.59	.79	.24	.14	.14	.42	.18	.24	.14	.39	.98
15	.59	.63	.37	1.26	1.65	M3	.79	.98	.24	.14	.18	.56	.25	.30	.14	.59	1.57
20	.79	.98	.53	1.81	2.44	M4	1.50	1.50	.37	.24	.33	.83	.44	.39	.16	.79	2.36

NOTES: 1. Longer lengths are available on special order (maximum length 141.7 inches).
 2. If more than one carriage is needed per track, contact our engineering department.



Size	Force N (lbf)	Max. Static Load N (lbf)
7	445 (100.04)	734 (165.00)
9	667 (149.94)	1557 (350.01)
12	1334 (299.88)	1957 (439.93)
15	2224 (499.96)	3114 (700.03)
20	3559 (800.06)	6005 (1349.92)

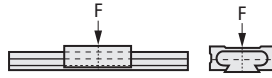

Size	Force N (lbf)
7	89 (20.01)
9	125 (28.10)
12	222 (49.91)
15	356 (80.03)
20	578 (129.93)

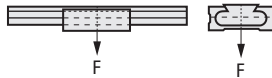

Size	Mx Nm (lbf in.)	My Nm (lbf in.)	Mz Nm (lbf in.)
7	2.3 (20.36)	1.8 (15.93)	1.8 (15.93)
9	5 (44.25)	3.2 (28.32)	3.2 (28.32)
12	9 (79.66)	5.6 (49.56)	5.6 (49.56)
15	15.1 (133.65)	9 (79.66)	9 (79.66)
20	24.9 (220.38)	14.7 (130.11)	14.7 (130.11)

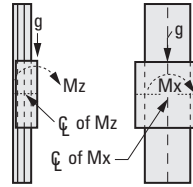

Size	Force N (lbf)	Mx Nm (lbf in.)	My Nm (lbf in.)	Mz Nm (lbf in.)
7	133 (29.90)	2.3 (20.36)	1.8 (15.93)	1.8 (15.93)
9	222 (49.91)	5 (44.25)	3.2 (28.32)	3.2 (28.32)
12	400 (89.92)	9 (79.66)	5.6 (49.56)	5.6 (49.56)
15	667 (149.94)	15.1 (133.65)	9 (79.66)	9 (79.66)
20	1112 (249.98)	24.9 (220.38)	14.7 (130.11)	14.7 (130.11)

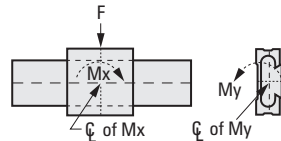

Plane bearings are rated by their limiting PV, which is a combination of load over a given surface area and the velocity.

Bearing Material	Max. "PV"	Max. "P"	Max. "V" (No Lubrication)
FrelonGOLD®	20000 (psi x ft./min.)	3000 (psi)	300 (ft./min.)
	or 430 (kgf/cm ² x m/min.)	or 210.9 (kgf/cm ²)	or 91.44 (m/min.)
FrelonJ™	10000 (psi x ft./min.)	1500 (psi)	140 (ft./min.)
	or 215 (kgf/cm ² x m/min.)	or 105.45 (kgf/cm ²)	or 42.66 (m/min.)

PV = The performance measurement of plane bearings

PV = P x V where P = pressure (load) in psi (kgf/cm²), V = velocity (speed) in ft./min. (m/min.)

NOTES: 1. All three parameters must be met by an application for the bearing to perform properly.
2. Dimensions in () are inch.

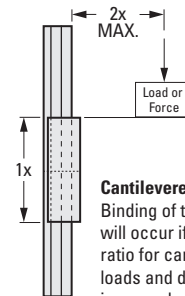

Cantilevered Loads
Binding of the carriage will occur if the 2:1 ratio for cantilevered loads and drive forces is exceeded. This principle is not load or force dependent. It is a product of the coefficient of frictions associated with plane bearings.

I
R
T
1
2
3
4
5
6
7
8
9
10
11
12
13
14
15
16