

> MATERIAL:

Brass

> SPECIFICATION:

Δ Pinions are suitable for use with speed reducers.

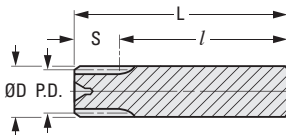

Fig. 1

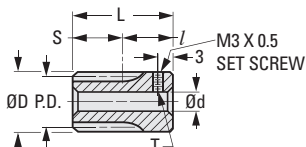

Fig. 2

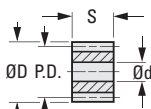

Fig. 3

METRIC COMPONENT

Catalog Number	Mod.	Fig. No.	No. of Teeth	P.D.	D Dia.	d Bore	d Tolerance	S Face Width	L	l
Δ A 1B 8MYSH1012	0.15	3	12	1.905	2.205	1	+0.012/+0.004	2.5	—	—
Δ A 1B 8MYSH1013	0.15	3	13	2.055	2.355	1	+0.012/+0.004	2.5	—	—
Δ A 1B 8MYS01515	0.15	3	15	2.295	2.595	1.5	-0.01/-0.03	1.7	—	—
Δ A 1B 8MYSH1015	0.15	3	15	2.31	2.61	1.5	+0.012/+0.004	3.2	—	—
Δ A 1B 8MYS02010	0.2	3	10	2.24	2.64	1.2	-0.02/-0.04	2	—	—
Δ A 1B 8MYS01512	0.2	3	12	2.452	2.852	1.5	-0.01/-0.0	1.7	—	—
Δ A 1B 8MYS02014	0.2	3	14	2.9	3.3	2	-0.01/-0.03	2.8	—	—
Δ A 1B 8MYS02020	0.2	3	20	4.1	4.5	2	-0.01/-0.03	2.8	—	—
Δ A 1B 8MYSH2015	0.25	3	15	3.75	4.25	2	-0.01/-0.03	2.8	—	—
Δ A 1B 8MYS03010	0.3	3	10	3.15	3.75	2	-0.02/-0.04	2	—	—
Δ A 1B 8MYS04014A	0.4	3	14	5.84	6.64	3	-0.014/-0.03	4.5	—	—
Δ A 1B 8MYS04014B	0.4	3	14	5.84	6.64	4	-0.014/-0.03	4.5	—	—
Δ A 1B 8MYK05010	0.5	1	10	5	6	—	—	10	55	45
Δ A 1B 8MYS05010	0.5	3	10	5.24	6.24	2	-0.02/-0.04	4	—	—
Δ A 1B 8MYS05012	0.5	3	12	6.2	7.2	4	-0.02/-0.04	4	—	—
A 1B 8MYK05012	0.5	1	12	6	7	—	—	10	55	45
A 1B 8MYS05012A	0.5	3	12	6.2	7.2	3	-0.02/-0.04	4	—	—
A 1B 8MYK05015	0.5	2	15	7.5	8.5*	3	+0.014/0	8	18	10
A 1B 8MYK05016	0.5	2	16	8	9	3	+0.014/0	8	18	10
A 1B 8MYK05018	0.5	2	18	9	10	3	+0.014/0	8	18	10
A 1B 8MYKH7010	0.75	1	10	7.5	9	—	—	8	55	47
A 1B 8MYKH7012	0.75	1	12	9	10.5	—	—	8	55	47
A 1B 8MYKH7015	0.75	2	15	11.25	12.75	5	+0.018/0	8	20	12
A 1B 8MYK08014	0.8	2	14	11.2	12.8	4	+0.018/0	7	20	13
A 1B 8MYK08015	0.8	2	15	12	13.6	4	+0.018/0	7	20	13

* Hub end is 9 mm O.D.

I
R
T
1
2
3
4
5
6
7
8
9
10
11
12
13
14
15
A

MODULE 0.25, 0.4, 0.5, 0.6, 1
20° PRESSURE ANGLE

PHONE: 516.328.3300 • FAX: 516.326.8827 • WWW.SDP-SI.COM

> MATERIAL:
Steel

> SPECIFICATION:

** Shaft Tolerance: 6 mm 0/-0.018
8 mm 0/-0.022

Δ To obtain additional tooth strength, these pinions are produced by shifting the tooth profile which results in a long addendum. The center distance for these pinions has to be increased. Therefore, please consult our Engineering Department.

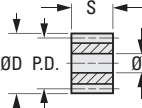

Fig. 1



Fig. 2

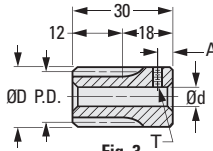

Fig. 3

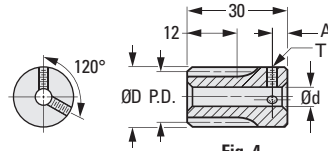

Fig. 4

The projections shown are per ISO convention.

METRIC COMPONENT

Catalog Number	No. of Teeth	P.D.	D Dia.	d Bore	d Tolerance	S Face Width	D ^{**} Shaft Dia. h8	A	T Set Screw
Module 0.25 Fig. 1									
A 1C 8MYSH2013	13	3.25	3.75	2	-0.01/-0.03	2.5	—	—	—
A 1C 8MYSH2013A	13	3.25	3.75	1.5	-0.01/-0.03	4	—	—	—
A 1C 8MYSH2016	16	3.9	4.4	2	-0.01/-0.03	2.5	—	—	—
A 1C 8MYSH2016A	16	3.9	4.4	1.5	-0.01/-0.03	4	—	—	—
A 1C 8MYSH2019	19	4.75	5.25	2	-0.01/-0.03	2.5	—	—	—
A 1C 8MYSH2019A	19	4.75	5.25	1.5	-0.01/-0.03	4	—	—	—
Module 0.4 Fig. 1									
A 1C 8MYS04012	12	4.88	5.68	3	-0.014/-0.03	4	—	—	—
A 1C 8MYS04014A	14	5.84	6.64	3	-0.014/-0.03	4.5	—	—	—
A 1C 8MYS04014B	14	5.84	6.64	4	-0.014/-0.03	4.5	—	—	—
Module 0.5 Fig. 1									
A 1C 8MYS05012	12	6.2	7.2	4	-0.02/-0.04	4	—	—	—
Module 0.6 Fig. 1									
* A 1C 8MYS06012	12	7.2	8.4	4	-0.015/-0.035	4	—	—	—
* A 1C 8MYS06012B	12	7.2	8.4	2	-0.010/-0.025	4	—	—	—
* A 1C 8MYS06018	18	10.7	11.9	4	-0.015/-0.035	4	—	—	—
* A 1C 8MYS06018A	18	10.7	11.9	3	-0.015/-0.035	4	—	—	—
* A 1C 8MYS06018B	18	10.7	11.9	2	-0.010/-0.025	4	—	—	—
Module 1 Fig. 2									
Δ A 1C 8MYK10008	8	8	10.64	—	—	—	6	—	—
Δ A 1C 8MYK10010	10	10	12.66	—	—	—	8	—	—
Module 1 Fig. 3									
** A 1C 8MYK10012	12	12	14	6	+0.018/0	—	—	5	M4
** A 1C 8MYK10014	14	14	16	6	+0.018/0	—	—	5	M5
** A 1C 8MYK10016	16	16	18	8	+0.022/0	—	—	5	M5
Module 1 Fig. 4									
A 1C 8MYK10012S	12	12	14	6	+0.018/0	—	—	5	M4
A 1C 8MYK10014S	14	14	16	6	+0.018/0	—	—	5	M5
A 1C 8MYK10015S	15	15	17	6	+0.018/0	—	—	5	M5
A 1C 8MYK10016S	16	16	18	8	+0.022/0	—	—	5	M5
A 1C 8MYK10018S	18	18	20	8	+0.022/0	—	—	4	M4

* To be discontinued when present stock is depleted.

** To be discontinued when present stock is depleted.

A new style with two set screws will be offered in its place - see Fig. 4.

PINIONS – MODULE 0.4

PHONE: 516.328.3300 • FAX: 516.326.8827 • WWW.SDP-SI.COM

HUBLESS
4 mm FACE WIDTH
20° PRESSURE ANGLE



> **MATERIAL:**
Brass

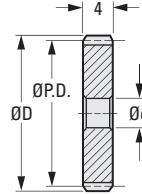

METRIC COMPONENT

Catalog Number	No. of Teeth	P.D.	D Dia.	d Bore +0.025 0
A 1B 1MY04008	8	3.2	4	1.5
A 1B 1MY04010	10	4	4.8	2
A 1B 1MY04012	12	4.8	5.6	3
A 1B 1MY04014	14	5.6	6.4	3
A 1B 1MY04016	16	6.4	7.2	3
A 1B 1MY04018	18	7.2	8	3
A 1B 1MY04024	24	9.6	10.4	3

PINION SHAFTS

UNDERSIZED DIAMETER

> **MATERIAL:**
303 Stainless Steel



> **STRAIGHTNESS:**
0.0003 mm/mm

Discounts available for large quantity orders.

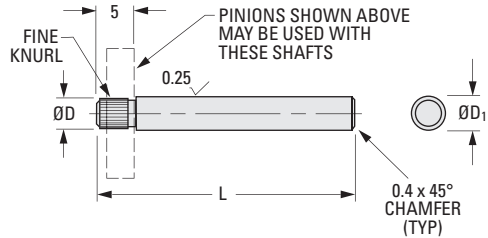

METRIC COMPONENT

Catalog Number	D Dia. +0.025 0	D ₁ Dia. -0.004 -0.012	L Length ± 0.25
A 7X 1MP0550A	1.5	5	50
A 7X 1MP0550B	2	5	50
A 7X 1MP0675	3	6	75

PINIONS – MODULE 0.5

PHONE: 516.328.3300 • FAX: 516.326.8827 • WWW.SDP-SI.COM

HUBLESS
4 mm FACE WIDTH
20° PRESSURE ANGLE



> **MATERIAL:**
Brass

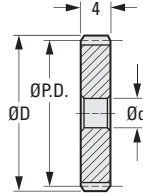

METRIC COMPONENT

Catalog Number	No. of Teeth	P.D.	D Dia.	d Bore +0.025 0
A 1B 1MY05006	6	3	4	1.5
A 1B 1MY05008	8	4	5	2
A 1B 1MY05010	10	5	6	2
A 1B 1MY05012	12	6	7	3
A 1B 1MY05014	14	7	8	3
A 1B 1MY05016	16	8	9	3
A 1B 1MY05018	18	9	10	3

PINION SHAFTS

UNDERSIZED DIAMETER

> **MATERIAL:**
303 Stainless Steel



> **STRAIGHTNESS:**
0.0003 mm/mm

Discounts available for large quantity orders.

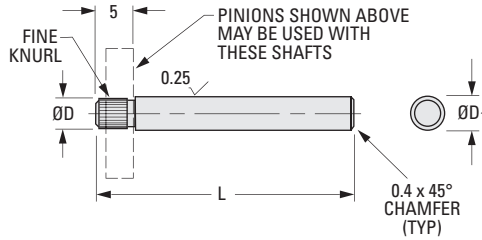

METRIC COMPONENT

Catalog Number	D Dia. +0.025 0	D ₁ Dia. -0.004 -0.012	L Length ± 0.25
A 7X 1MP0550A	1.5	5	50
A 7X 1MP0550B	2	5	50
A 7X 1MP0675	3	6	75

- I
- R
- T
- 1**
- 2
- 3
- 4
- 5
- 6
- 7
- 8
- 9
- 10
- 11
- 12
- 13
- 14
- 15
- A

PINIONS – MODULE 0.8

PHONE: 516.328.3300 • FAX: 516.326.8827 • WWW.SDP-SI.COM

HUBLESS
4 mm FACE WIDTH
20° PRESSURE ANGLE



> **MATERIAL:**
Brass

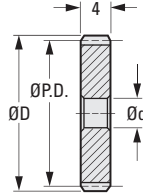

METRIC COMPONENT

Catalog Number	No. of Teeth	P.D.	D Dia.	d Bore +0.025 0
A 1B 1MY08006	6	4.8	6.4	2
A 1B 1MY08008	8	6.4	8	3
A 1B 1MY08010	10	8	9.6	3
A 1B 1MY08012	12	9.6	11.2	3
A 1B 1MY08014	14	11.2	12.8	3
A 1B 1MY08016	16	12.8	14.4	3
A 1B 1MY08018	18	14.4	16	3

PINION SHAFTS

UNDERSIZED DIAMETER

> **MATERIAL:**
303 Stainless Steel



> **STRAIGHTNESS:**
0.0003 mm/mm

Discounts available for large quantity orders.

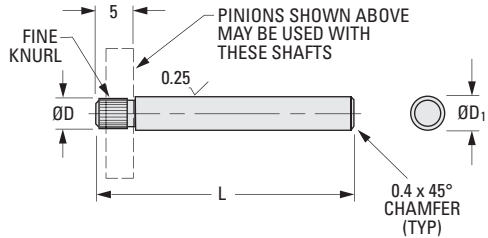

METRIC COMPONENT

Catalog Number	D Dia. +0.025 0	D ₁ Dia. -0.004 -0.012	L Length ± 0.25
A 7X 1MP0550B	2	5	50
A 7X 1MP0675	3	6	75