

# PIPE SHAFTS



PHONE: 516.328.3300 • FAX: 516.326.8827 • WWW.SDP-SI.COM

BEARINGS STEEL  
WEIGHT REDUCTION  
DESIGN FLEXIBILITY



**> MATERIAL:**

AISI 52100 Steel, Hardened  
to HRC 58...62

**> STRAIGHTNESS:**

0.0003 mm/mm

Other lengths available  
upon request.

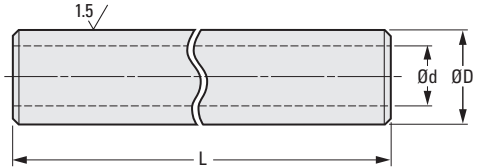

### METRIC COMPONENT

Catalog Number	d Bore ± 0.5	D Diameter g6	D Tolerance	L Length	Case Depth
S40LPSM02060100	2	6	-0.004/-0.012	100	1
S40LPSM02060150	2	6	-0.004/-0.012	150	1
S40LPSM02060200	2	6	-0.004/-0.012	200	1
S40LPSM02060300	2	6	-0.004/-0.012	300	1
S40LPSM03080100	3	8	-0.005/-0.014	100	1
S40LPSM03080150	3	8	-0.005/-0.014	150	1
S40LPSM03080200	3	8	-0.005/-0.014	200	1
S40LPSM03080300	3	8	-0.005/-0.014	300	1
S40LPSM03080400	3	8	-0.005/-0.014	400	1
S40LPSM04100100	4	10	-0.005/-0.014	100	1
S40LPSM04100150	4	10	-0.005/-0.014	150	1
S40LPSM04100200	4	10	-0.005/-0.014	200	1
S40LPSM04100300	4	10	-0.005/-0.014	300	1
S40LPSM04100400	4	10	-0.005/-0.014	400	1
S40LPSM04100500	4	10	-0.005/-0.014	500	1
S40LPSM04100600	4	10	-0.005/-0.014	600	1
S40LPSM06120200	6	12	-0.006/-0.017	200	1
S40LPSM06120300	6	12	-0.006/-0.017	300	1
S40LPSM06120400	6	12	-0.006/-0.017	400	1
S40LPSM06120500	6	12	-0.006/-0.017	500	1
S40LPSM06120600	6	12	-0.006/-0.017	600	1
S40LPSM06120800	6	12	-0.006/-0.017	800	1
S40LPSM10160300	10	16	-0.006/-0.017	300	1.5
S40LPSM10160400	10	16	-0.006/-0.017	400	1.5
S40LPSM10160500	10	16	-0.006/-0.017	500	1.5
S40LPSM10160600	10	16	-0.006/-0.017	600	1.5
S40LPSM10160800	10	16	-0.006/-0.017	800	1.5
S40LPSM10161000	10	16	-0.006/-0.017	1000	1.5
S40LPSM14200300	14	20	-0.007/-0.020	300	1.5
S40LPSM14200400	14	20	-0.007/-0.020	400	1.5
S40LPSM14200500	14	20	-0.007/-0.020	500	1.5
S40LPSM14200600	14	20	-0.007/-0.020	600	1.5
S40LPSM14200800	14	20	-0.007/-0.020	800	1.5
S40LPSM14201000	14	20	-0.007/-0.020	1000	1.5
S40LPSM17250300	17	25	-0.007/-0.020	300	1.5
S40LPSM17250400	17	25	-0.007/-0.020	400	1.5
S40LPSM17250500	17	25	-0.007/-0.020	500	1.5
S40LPSM17250600	17	25	-0.007/-0.020	600	1.5
S40LPSM17250800	17	25	-0.007/-0.020	800	1.5
S40LPSM17251000	17	25	-0.007/-0.020	1000	1.5