

ZERO DRAG WHEN DE-ENERGIZED
ANTI-BACKLASH WHEN ENERGIZED

PHONE: 516.328.3300 • FAX: 516.326.8827 • WWW.SDP-SI.COM

> COIL DATA:

Voltage: 24V DC

Other voltages available on special order.

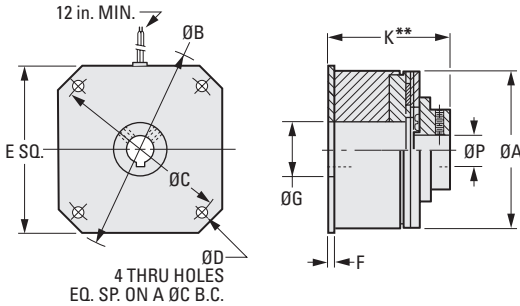

Keyway Dimensions			
Bore	.250	.375	.500
Width	.062	.094	.125
Height	.286	.425	.564

INCH COMPONENT

Catalog Number	Static Torque lbf in.	Nom. Resist. ohms	Max. wattage	Armature Inertia lbf in. sec ²	Energy Dissipation lbf ft./min.	Armature		P Bore
						Engagement msec	Disengagement msec	
S90BF9-11A04	5	128	5	3.4 x 10 ⁻⁵	175	5	18	.250
S90BF9-17A04	15	108	6	8.1 x 10 ⁻⁵	420	10	27	.250
S90BF9-22A06	40	75	8.5	33.1 x 10 ⁻⁵	1400	12	32	.375
S90BF9-26A06	80	66	9.5	81.0 x 10 ⁻⁵	2600	15	35	.375
S90BF9-26A08	80	66	9.5	81.0 x 10 ⁻⁵	2600	15	35	.500
S90BF9-30A10	125	44	15	179.5 x 10 ⁻⁵	2900	18	45	.625

Catalog Number (Ref.)	A Dia. Max.	B Dia.	C Dia.	D Dia.	E Max.	F	G Dia.	K** Max.	Weight lb.
S90BF9-11A04	1.25	1.498	1.31	.125	1.17	.05	.53	1.14	.2
S90BF9-17A04	1.78	2.436	2.13	.187	1.82	.06	.75	1.27	.5
S90BF9-22A06	2.26	2.873	2.50	.166	2.33	.06	.88	1.74	.9
S90BF9-26A06	2.63	3.499	3.13	.187	2.63	.06	1.06	1.84	1.2
S90BF9-26A08	2.63	3.499	3.13	.187	2.63	.06	1.06	1.84	1.2
S90BF9-30A10	3.27	4.186	3.75	.187	3.25	.09	1.75	1.93	3.0

* Typical torque after burnishing; units shipped burnished.
 ** For Catalog Number:
 -11A04, initial working air gap at installation shall be .004/.009.
 -17A04, -22A06, -26A06, -26A08 initial working air gap at installation shall be .006/.013.
 -30A10, 30A12, initial working air gap at installation shall be .008/.018.