

NO WEAR OR STRESS ON COMPONENT
EASY TO USE
SPACE SAVER

PHONE: 516.328.3300 • FAX: 516.326.8827 • WWW.SDP-SI.COM

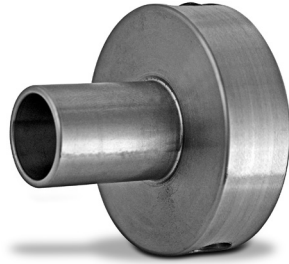

► **MATERIAL:**
Hardened Steel

► **SPECIFICATIONS:**

These connectors are designed for fast and accurate repositioning of the hub. It has just one screw for pressurizing in radial position. No space is used along the shaft for mounting tools. They are made up of a double-walled sleeve and flange filled with a pressure medium. **Pressure screw must not be tightened when not mounted or else pressure may deform the unit.**

CONNECTOR TOLERANCES

Shaft O.D. Tolerance:	15 mm 0/- .027
	19-30 mm 0/- .033
	35-45 mm 0/- .039
Hub Bore Tolerance:	18-30 mm 0/- .027
	35-50 mm 0/- .033
	54 mm 0/- .039

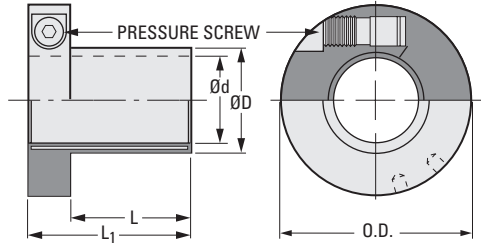

The projections shown are per ISO convention.

► **FEATURES:**

- Fast and frequent mounting / dismantling with only one set screw.
- Radial screw positioning saves space along the shaft.
- Accurate positioning. No axial movement when mounted.
- Uniform surface pressure against shaft and hub prevents damage to surfaces and enables the use of small diameter hubs.
- Handles temperature range: -30°C to +82°C.

► **OPERATION:**

When the pressure screw is tightened to the recommended tightening torque, the double-walled sleeve expands uniformly against shaft and hub and creates a rigid joint. Dismantling is done by loosening the screw which returns the connector to its original dimensions. It can then easily be dismantled.

METRIC COMPONENT

Catalog Number	d Nom. I.D.	D Dia.	D ₁ O.D.	L Length	L ₁ OAL	T Torque N • m	Screw Tightening N • m
S21BPYM154639	15	18	45	25	39	46.1	4.9
S21BPYM195042	19	23	50.5	28	42	85.4	4.9
S21BPYM205144	20	24	51.5	30	44	109.8	4.9
S21BPYM225546	22	27	55.5	32	46	130.1	4.9
S21BPYM245747	24	29	57.5	33	47	189.8	4.9
S21BPYM255849	25	30	58	35	49	229.1	4.9
S21BPYM306454	30	36	64.5	40	54	379.6	4.9
S21BPYM357359	35	42	73	45	59	639.9	4.9
S21BPYM408675	40	48	86.5	55	75	1099.5	21
S21BPYM459378	45	54	93	58	78	1399.2	21