

METAL SHIM STOCK



BRASS, STEEL AND STAINLESS STEEL
 FLAT SHEET
 EASY-TO-USE

PHONE: 516.328.3300 • FAX: 516.326.8827 • WWW.SDP-SI.COM



> MATERIAL CODE:

- B Brass, Half Hard 70/30
- C Cold Rolled Steel 1010
- S Stainless Steel 302/304

Priced per box of ten (ten 8 in. x 12 in. sheets of one thickness).

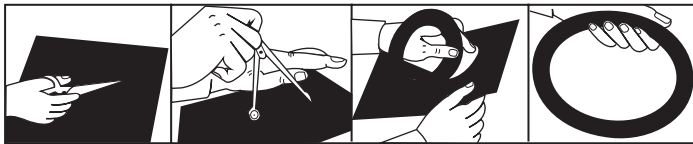

INCH COMPONENT

Catalog Number	Thickness in.
** S77 <input type="checkbox"/> 0Y-001SET	.001
** S77 <input type="checkbox"/> 0Y-002SET	.002
S77 <input type="checkbox"/> 0Y-003SET	.003
S77 <input type="checkbox"/> 0Y-004SET	.004
S77 <input type="checkbox"/> 0Y-005SET	.005
S77 <input type="checkbox"/> 0Y-007SET	.007
S77 <input type="checkbox"/> 0Y-010SET	.010
S77 <input type="checkbox"/> 0Y-012SET	.012
S77 <input type="checkbox"/> 0Y-015SET	.015
S77 <input type="checkbox"/> 0Y-020SET	.020
* S77 <input type="checkbox"/> 0Y-030SET	.030

* Not available in Cold Rolled Steel or Stainless Steel.

** Not available in Cold Rolled Steel.

You can also purchase Metal Shim Stock in an assortment package of one sheet per thickness. This package is sold as 8 in. x 12 in. sheets.

Priced per box.

INCH COMPONENT

Catalog Number	Material	Sheets Per Box
ΔΔ S77B0Y-ASSORT	Brass	11
Δ S77C0Y-ASSORT	Cold Rolled Steel	9
S77S0Y-ASSORT	Stainless Steel	10

Δ Does not include .030 thickness.

ΔΔ Does not include .002 & .030 thickness.

NOTE: Aluminum and Plastic Shim Stock also available.

- I
- R
- T
- 1
- 2
- 3
- 4
- 5
- 6
- 7
- 8
- 9
- 10
- 11
- 12
- 13
- 14
- 15
- 16

COLOR CODED THICKNESS
 FLAT SHEET
 EASY-TO-USE

PHONE: 516.328.3300 • FAX: 516.326.8827 • WWW.SDP-SI.COM



Priced per box of ten (ten sheets of one thickness).

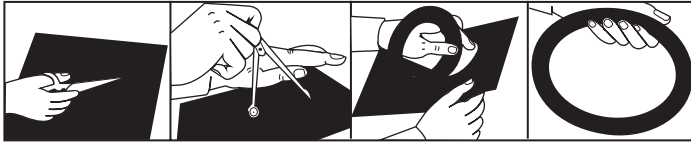

INCH COMPONENT		Thickness in.	Color
Catalog Number			
12 in. x 24 in. Sheets	6 in. x 24 in. Sheets		
S77A3Y-002SET	S77A6Y-002SET	.002	Red
S77A3Y-003SET	S77A6Y-003SET	.003	Green
S77A3Y-004SET	S77A6Y-004SET	.004	Tan
S77A3Y-005SET	S77A6Y-005SET	.005	Blue
S77A3Y-007SET	S77A6Y-007SET	.007	Natural
S77A3Y-010SET	S77A6Y-010SET	.010	Brown
S77A3Y-016SET	S77A6Y-016SET	.016	Pink
S77A3Y-020SET	S77A6Y-020SET	.020	Yellow
S77A3Y-025SET	S77A6Y-025SET	.025	White
S77A3Y-031SET	S77A6Y-031SET	.031	Coral

You can also purchase Aluminum Shim Stock in an assortment package of one sheet per thickness. This package of 10 sheets (10 colors) is available in two sizes as shown below.

Priced per box.

INCH COMPONENT	
Catalog Number	Size in.
S77A3Y-ASSORT	12 x 24
S77A6Y-ASSORT	6 x 24

NOTE: Brass, Steel, Stainless Steel and Plastic Shim Stock also available.

- I
- R
- T
- 1
- 2
- 3
- 4
- 5
- 6
- 7
- 8
- 9
- 10
- 11
- 12
- 13
- 14
- 15
- 16

COLOR CODED THICKNESS
EASY-TO-USE

PHONE: 516.328.3300 • FAX: 516.326.8827 • WWW.SDP-SI.COM



> SIZE CODE:

Using data below, insert desired size code in the box in the catalog number:

- 1 5 in. x 20 in.
- 2 10 in. x 20 in.
- 3 12 in. x 24 in.
- 4 20 in. x 20 in.



Available on special request:
.00075 Gold
.040 Clear
.050 Clear
.060 Clear

Priced per individual sheet.

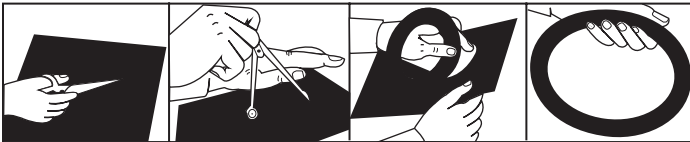

INCH COMPONENT

Catalog Number	Thickness in.	Color
S77P <input type="checkbox"/> Y-0005	.0005	Silver
S77P <input type="checkbox"/> Y-001	.001	Amber
S77P <input type="checkbox"/> Y-0015	.0015	Purple
S77P <input type="checkbox"/> Y-002	.002	Red
S77P <input type="checkbox"/> Y-003	.003	Green
S77P <input type="checkbox"/> Y-004	.004	Tan
S77P <input type="checkbox"/> Y-005	.005	Blue
S77P <input type="checkbox"/> Y-0075	.0075	Transp. Matte
S77P <input type="checkbox"/> Y-010	.010	Brown
S77P <input type="checkbox"/> Y-0125	.0125	Black
S77P <input type="checkbox"/> Y-015	.015	Pink
S77P <input type="checkbox"/> Y-020	.020	Yellow
S77P <input type="checkbox"/> Y-025	.025	Solid White
S77P <input type="checkbox"/> Y-030	.030	Coral

You can also purchase Plastic Shim Stock in an assortment package of one sheet per thickness. This package of 14 sheets (14 colors) is available in three sizes as shown below.

Priced per box.

INCH COMPONENT

Catalog Number	Size in.
S77P1Y-ASSORT	5 x 20
S77P2Y-ASSORT	10 x 20
S77P4Y-ASSORT	20 x 20

NOTE: Aluminum, Brass, Steel, and Stainless Steel Shim Stock also available.

