

► **MATERIAL:**
303 Stainless Steel

PHONE: 516.328.3300 • FAX: 516.326.8827 • WWW.SDP-SI.COM

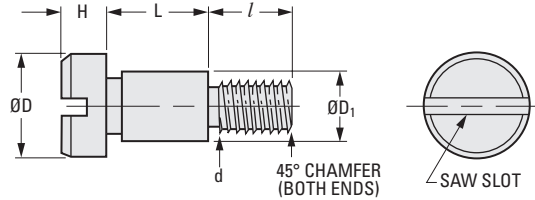

The projections shown are per ISO convention.

METRIC COMPONENT

Catalog Number	d Thread Size	D Dia.	D ₁ 0 -0.078	H	L +0.2 +0.05	l
A 9X15M0304	M3 x 0.5	6	4	3	4	4
A 9X15M0305	M3 x 0.5	6	4	3	5	4
A 9X15M0306	M3 x 0.5	6	4	3	6	4
A 9X15M0308	M3 x 0.5	6	4	3	8	4
A 9X15M0310	M3 x 0.5	6	4	3	10	4
A 9X15M0404	M4 x 0.7	8	5	4	4	5
A 9X15M0405	M4 x 0.7	8	5	4	5	5
A 9X15M0406	M4 x 0.7	8	5	4	6	5
A 9X15M0408	M4 x 0.7	8	5	4	8	5
A 9X15M0410	M4 x 0.7	8	5	4	10	5
A 9X15M0412	M4 x 0.7	8	5	4	12	5
A 9X15M0414	M4 x 0.7	8	5	4	14	5
A 9X15M0416	M4 x 0.7	8	5	4	16	5
A 9X15M0420	M4 x 0.7	8	5	4	20	5
A 9X15M0425	M4 x 0.7	8	5	4	25	5
A 9X15M0430	M4 x 0.7	8	5	4	30	5
A 9X15M0504	M5 x 0.8	10	6	5	4	6
A 9X15M0505	M5 x 0.8	10	6	5	5	6
A 9X15M0506	M5 x 0.8	10	6	5	6	6
A 9X15M0508	M5 x 0.8	10	6	5	8	6
A 9X15M0510	M5 x 0.8	10	6	5	10	6
A 9X15M0512	M5 x 0.8	10	6	5	12	6
A 9X15M0514	M5 x 0.8	10	6	5	14	6
A 9X15M0516	M5 x 0.8	10	6	5	16	6
A 9X15M0520	M5 x 0.8	10	6	5	20	6
A 9X15M0525	M5 x 0.8	10	6	5	25	6
A 9X15M0530	M5 x 0.8	10	6	5	30	6
A 9X15M0606	M6 x 1	12	8	6	6	11
A 9X15M0608	M6 x 1	12	8	6	8	11
A 9X15M0610	M6 x 1	12	8	6	10	11
A 9X15M0612	M6 x 1	12	8	6	12	11
A 9X15M0616	M6 x 1	12	8	6	16	11
A 9X15M0620	M6 x 1	12	8	6	20	11
A 9X15M0608A	M6 x 1	12	10	6	8	11
A 9X15M0616A	M6 x 1	12	10	6	16	11
A 9X15M0808	M8 x 1.25	14	10	7	8	12
A 9X15M0810	M8 x 1.25	14	10	7	10	12
A 9X15M0816	M8 x 1.25	14	10	7	16	12
A 9X15M1012	M10 x 1.5	20	12	8	12	16
A 9X15M1016	M10 x 1.5	20	12	8	16	16
A 9X15M1025	M10 x 1.5	20	12	8	25	16

DIN 923
SHALLOW HEAD

PHONE: 516.328.3300 • FAX: 516.326.8827 • WWW.SDP-SI.COM

➤ **MATERIAL:**
Steel

➤ **SPECIFICATION:**
Priced Per 100 Pieces

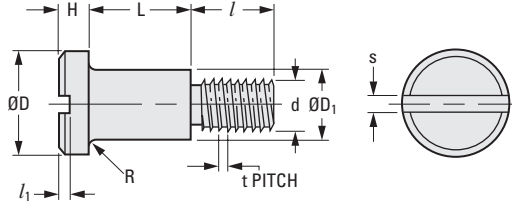
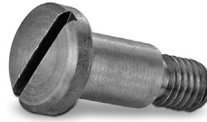

The projections shown are per ISO convention.

METRIC COMPONENT

Catalog Number	Thread Size	L Length
MD0923MCO03X002	M3	2
MD0923MCO03X0025	M3	2.5
MD0923MCO03X003	M3	3
MD0923MCO03X004	M3	4
MD0923MCO03X005	M3	5
MD0923MCO03X006	M3	6
MD0923MCO03X008	M3	8
MD0923MCO03X010	M3	10
MD0923MCO04X002	M4	2
MD0923MCO04X0025	M4	2.5
MD0923MCO04X003	M4	3
MD0923MCO04X004	M4	4
MD0923MCO04X005	M4	5
MD0923MCO04X006	M4	6
MD0923MCO04X008	M4	8
MD0923MCO04X010	M4	10
MD0923MCO04X012	M4	12
MD0923MCO04X016	M4	16
MD0923MCO05X0025	M5	2.5
MD0923MCO05X003	M5	3
MD0923MCO05X004	M5	4
MD0923MCO05X005	M5	5
MD0923MCO05X006	M5	6

Catalog Number	Thread Size	L Length
MD0923MCO05X008	M5	8
MD0923MCO05X010	M5	10
MD0923MCO05X012	M5	12
MD0923MCO05X016	M5	16
MD0923MCO06X003	M6	3
MD0923MCO06X004	M6	4
MD0923MCO06X005	M6	5
MD0923MCO06X006	M6	6
MD0923MCO06X008	M6	8
MD0923MCO06X010	M6	10
MD0923MCO06X012	M6	12
MD0923MCO06X016	M6	16
MD0923MCO06X020	M6	20
MD0923MCO08X004	M8	4
MD0923MCO08X005	M8	5
MD0923MCO08X006	M8	6
MD0923MCO08X008	M8	8
MD0923MCO08X010	M8	10
MD0923MCO08X012	M8	12
MD0923MCO08X016	M8	16
MD0923MCO08X020	M8	20
MD0923MCO08X025	M8	25

Dimensions	Thread Size				
	M3	M4	M5	M6	M8
d					
D Dia.	7	8.5	11	13	16
D ₁ Dia. h9	4	5.5	7	8	10
H	1.8	2.4	2.7	3.1	3.8
s	0.8	1	1.2	1.6	2
l ₁ Min.	0.9	1.2	1.3	1.5	1.9
l	4.5	6	7	9	11
R Max.	0.1	0.2	0.2	0.25	1.4
t	0.5	0.7	0.8	1	1.25

L Shoulder Length	Tolerance
2, 2.5, 3	+0.10 +0.06
4, 5, 6, 8, 10	+0.15 +0.07
12, 16, 20, 25	+0.2 +0.1