

CORROSIVE ENVIRONMENT
 STAINLESS STEEL PADS
 FOR LOADS OF .24 TO 4.4 lbf (0.11 TO 2 kgf)

PHONE: 516.328.3300 • FAX: 516.326.8827 • WWW.SDP-SI.COM

► MATERIAL:

- Mounting Base** - Aluminum Alloy, Anodized
- Retaining Caps** - Aluminum Alloy, Anodized
- Springs** - Stainless Steel
- Center Tube** - Stainless Steel
- Isolators** - Knitted Stainless Steel Pads

► OPERATING TEMPERATURE:

-94°F to +347°F (-70°C to +175°C)

► APPLICATIONS:

Light Electronics & Mechanical Equipment
 High Frequency Environments

► LOAD LIMITATIONS:

Mechanical resistance is equal to
 10 G of continuous acceleration.

► DYNAMIC CHARACTERISTICS:

Natural frequency = 15 to 25 Hz vertical
 = 12 to 20 Hz radial
 Allowable max. movement on mount = ± .012 (0.3)
 Transmissibility between 3 and 4:1

TYPICAL TRANSMISSIBILITY CURVE
 as a function of applied load

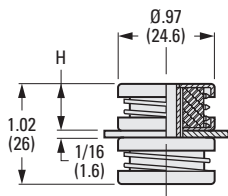
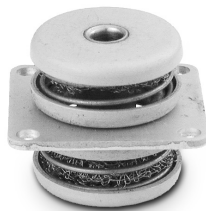
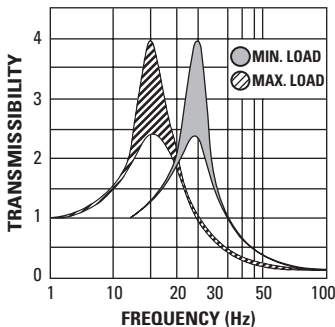

NOTE: MAX. BOLT LENGTH INTO CAP IS .275 (7)

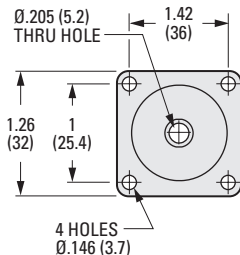

NOTE: Dimensions in () are mm.

INCH COMPONENT

Catalog Number	Static Load		H Height			
			Min. (Comp.)		Max. (Tension)	
	lbf	kgf	in.	mm	in.	mm
A10Z36-7001S02	.24 – .55	0.11 – 0.25	.354	9	.59	15
A10Z36-7001S04	.44 – .88	0.20 – 0.40	.354	9	.59	15
A10Z36-7001S07	.77 – 1.65	0.35 – 0.75	.354	9	.59	15
A10Z36-7001S22	2.20 – 3.41	1.00 – 1.55	.354	9	.59	15
A10Z36-7001S26	2.64 – 4.40	1.20 – 2.00	.354	9	.59	15