

TELESCOPING MINIATURE BALL SPLINES

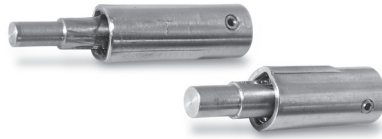

ZERO BACKLASH
 LOW INERTIA
 ACCOMMODATES 1/4" AXIAL MOTION

PHONE: 516.328.3300 • FAX: 516.326.8827 • WWW.SDP-SI.COM

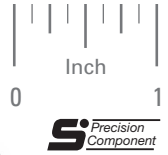

> MATERIAL:
Body & Shaft - 303 Stainless Steel
Balls - 440 Stainless Steel

> MAXIMUM OPERATING SPEED:
 10000 rpm

> FEATURES:
 Zero Backlash is attained with patented design and close dimensional control of components.
 Use where axial motion is present while transmitting rotary motion.
 Will not accommodate angular misalignment.

> LUBRICATION:
 Dry Film Plus Oil Suspension

These splines may be mated to S57PY5-... and S57PY4-... series of universal joints to make telescoping universal joints.

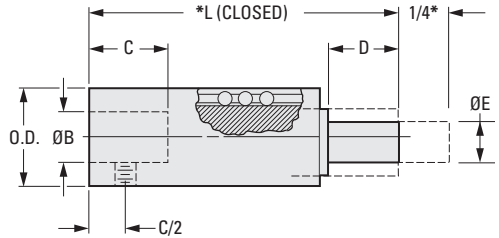

INCH COMPONENT

Catalog Number	O.D.	B Bore +.001 -.000	C Bore Depth	D Shoulder Length	E Dia. +.000 -.001	L* Closed	Set Screw Size	Torque ozf in.
S59PY5-TBS0309	9/32	.0938	1/4	1/4	.0938	1-1/16	#2-56	16
S59PY5-TBS0409	9/32	.125	1/4	1/4	.125	1-1/16	#2-56	16
S59PY5-TBS0612	3/8	.1875	5/16	5/16	.1875	1-1/4	#4-40	64
S59PY5-TBS0816	1/2	.250	3/8	3/8	.250	1-1/2	#6-32	256

* Closed dimensions for standard 1/4" of travel (min.).
 Up to 4" of travel available on special order.

See additional items on the next page

TELESCOPING MINIATURE BALL SPLINES



ZERO BACKLASH
 LOW INERTIA
 ACCOMMODATES 1/4" AXIAL MOTION

PHONE: 516.328.3300 • FAX: 516.326.8827 • WWW.SDP-SI.COM

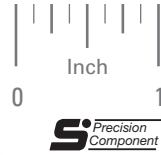

> MATERIAL:

Body & Shaft - 440 Stainless Steel
Balls - 440 Stainless Steel

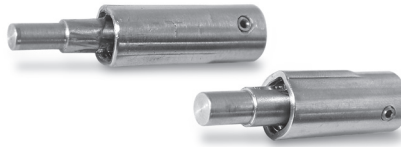

> MAXIMUM OPERATING SPEED:

8000 rpm

> FEATURES:

Zero Backlash is attained with patented design and close dimensional control of components.
 Use where axial motion is present while transmitting rotary motion.
 Will not accommodate angular misalignment.

> LUBRICATION:

Dry Film Plus Oil Suspension

These splines may be mated to S57PY5-... and S57PY4-... series of universal joints to make telescoping universal joints.

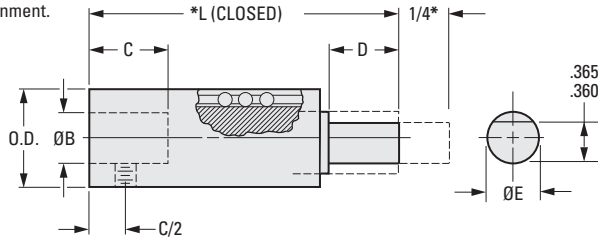

Fig. 1

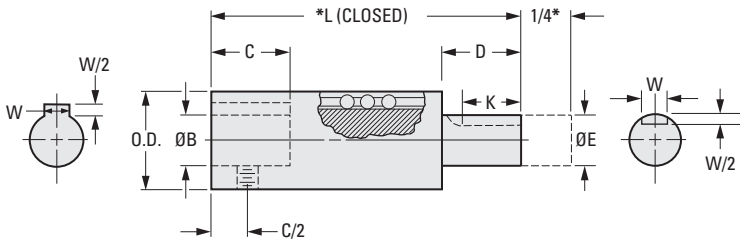

Fig. 2

INCH COMPONENT

Catalog Number	O.D.	B Bore +.001 -.000	C Bore Depth	D Shoulder Length	E Dia. +.000 -.001	L * Closed	Set Screw Size	Torque ozf in.	K Keyway Length (min.)	W Keyway Width +.0015 -.0000
Fig. 1										
S59PQ5-TBS1232	1	.375	1/2	1/2	.375	2-1/8	1/4-20	1200	—	—
Fig. 2										
S59PQ5-TBS2048	1-1/2	.625	3/4	3/4	.625	3	5/16-18	4800	1/2	.1875
S59PQ5-TBS3264	2	1.000	1-1/4	1-1/4	1.000	4-1/4	3/8-16	9600	3/4	.2500

* Closed dimensions for standard 1/4" of travel (min.).
 Up to 4" of travel available on special order.

See additional items on the previous page