

# INTERNAL TOLERANCE RINGS



ALLOWS LOOSER TOLERANCE  
LOW COST ASSEMBLY  
MOUNTS BALL BEARINGS

PHONE: 516.328.3300 • FAX: 516.326.8827 • WWW.SDP-SI.COM



**> MATERIAL:**  
301 Stainless Steel



CENTERED ARRANGEMENT  
(GROOVED HOUSING)

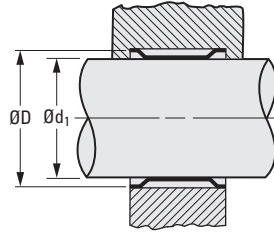
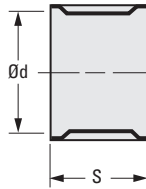

FREE ARRANGEMENT  
(NONGROOVED HOUSING)

## METRIC COMPONENT

Catalog Number	Ring Dimensions mm		D Inner Member O.D. 0 -0.050	d <sub>1</sub> Outer Member I.D. mm		Max. Radial Load Capacity N	Max. Design Torque N • m	Max. Design Thrust N
	d	S		For Mounting Ball Bearings	For Torque Transfer			
S77RY1M160X05	16	5	16	17.47/17.40	17.30/17.22	1110	3.95	495
S77RY1M190X06	19	6	19	20.98/20.90	20.75/20.68	1870	6.78	715
S77RY1M200X08	20	8	20	21.97/21.89	21.74/21.67	2490	11.86	1185
S77RY1M200X16	20	16	20	21.97/21.89	21.74/21.67	4895	23.73	2770
S77RY1M220X07	22	7	22	23.98/23.90	23.75/23.67	2445	15.25	1385
S77RY1M220X10	22	10	22	23.98/23.90	23.75/23.67	3515	21.47	1950
S77RY1M240X06	24	6	24	25.93/25.88	25.76/25.65	2315	13	1085
S77RY1M240X07	24	7	24	25.93/25.88	25.76/25.65	2715	15.25	1270
S77RY1M260X05	26	5	26	27.97/27.89	27.74/27.66	2135	13.56	1045
S77RY1M260X08	26	8	26	27.97/27.89	27.74/27.66	3425	21.47	1650
S77RY1M280X08	28	8	28	30.00/29.90	29.74/29.67	3135	26.55	1895
S77RY1M300X09	30	9	30	31.98/31.90	31.75/31.67	4360	31.07	2070
S77RY1M300X13	30	13	30	31.98/31.90	31.75/31.67	6225	44.07	2935
S77RY1M320X10	32	10	32	33.98/33.88	33.71/33.60	2980	37.85	2365
S77RY1M350X10	35	10	35	36.98/36.88	36.70/36.60	3335	42.94	2455
S77RY1M350X11	35	11	35	36.98/36.88	36.70/36.60	3645	47.46	2710
S77RY1M400X07	40	7	40	41.99/41.88	41.71/41.60	2670	45.76	2290
S77RY1M400X12	40	12	40	41.99/41.88	41.71/41.60	4450	72.32	3615
S77RY1M400X16	40	16	40	41.99/41.88	41.71/41.60	6225	91.53	4575
S77RY1M420X07	42	7	42	43.97/43.87	43.69/43.59	2760	48.59	2315
S77RY1M420X13	42	13	42	43.97/43.87	43.69/43.59	5540	79.66	3795

# INTERNAL TOLERANCE RINGS

**SDP/SI**

FOR MOUNTING SMALL,  
INSTRUMENT BEARINGS  
LIGHT DUTY

PHONE: 516.328.3300 • FAX: 516.326.8827 • WWW.SDP-SI.COM



**> MATERIAL:**  
301 Stainless Steel

**> FEATURES:**  
Allows looser tolerances.  
Prevents loss of retention of steel  
bearings in aluminum housings.  
Easier, low cost assembly.  
Open free state.

Other sizes available on special order.

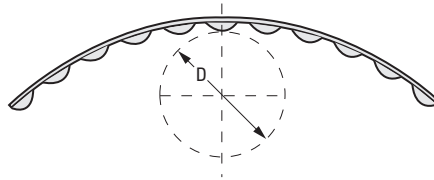

FREE  
ARRANGEMENT

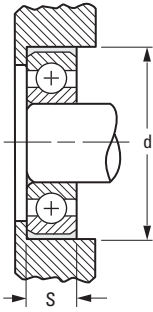

AXIAL RETENTION  
OF TOLERANCE RING

## METRIC COMPONENT

Catalog Number	D Nominal Bearing O.D.	S Nominal Bearing Width mm	d Recommended Housing Bore mm	Radial Load Capacity N
S77RY1ML127X05	12.7	5	13.38/13.33	25
S77RY1ML160X05	16	5	16.69/16.64	35
S77RY1ML220X07	22	7	22.66/22.61	60
S77RY1ML220X10	22	10	22.66/22.61	95
S77RY1ML240X10	24	10	24.66/24.61	100
S77RY1ML260X08	26	8	26.67/26.62	85
S77RY1ML320X10	32	10	32.66/32.61	135
S77RY1ML350X11	35	11	35.69/35.64	160
S77RY1ML400X12	40	12	40.69/40.64	200
S77RY1ML470X14	47	14	47.67/47.62	290
S77RY1ML520X15	52	15	52.68/52.63	335

- I
- R
- T
- 1
- 2
- 3
- 4
- 5
- 6
- 7
- 8
- 9
- 10
- 11
- 12
- 13
- 14
- 15
- A