

FLAT WASHERS

PHONE: 516.328.3300 • FAX: 516.326.8827 • WWW.SDP-SI.COM

› **MATERIAL:**

Stainless Steel

› **SPECIFICATION:**

Priced Per 100 Pieces

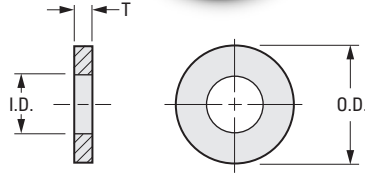

INCH COMPONENT

Catalog Number	I.D. ± .01	O.D. ± .01	T ± .006	Screw Size
A 9X20-00	.064	.156	.020	#0
A 9X20-02	.089	.187	.025	#2
A 9X20-02A	.101	.262	.031	#2
A 9X20-04	.119	.312	.031	#4
A 9X20-06	.146	.375	.031	#6
A 9X20-06A	.151	.387	.031	#6
A 9X20-08	.172	.375	.031	#8
A 9X20-10	.198	.437	.062	#10
A 9X20-14	.265	.500	.062	1/4
A 9X20-51	.328	.562	.062	5/16
A 9X20-38	.390	.625	.062	3/8

SINTERED THRUST WASHERS

› **MATERIAL:**

Oil-Impregnated Bronze, Self-Lubricating

› **SPECIFICATION:**

Priced Per Each

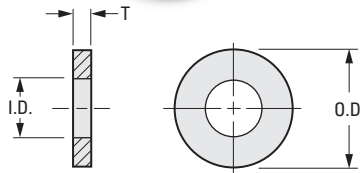

INCH COMPONENT

Catalog Number	I.D. ± .005	O.D. ± .010	T Thickness ± .0025
A 7B 7-0132	.1300	.370	.062
A 7B 7-0192	.1920	.495	.062
A 7B 7-0252	.2550	.620	.062
A 7B 7-0312	.3150	.750	.062
A 7B 7-0372	.3775	.750	.062
A 7B 7-0374	.3775	.750	.125
A 7B 7-0432	.4385	.750	.062
A 7B 7-0512	.5100	1.000	.062
A 7B 7-0514	.5100	1.000	.125

SINTERED THRUST WASHERS



"S" SERIES

PHONE: 516.328.3300 • FAX: 516.326.8827 • WWW.SDP-SI.COM

> MATERIAL:

Oil-Impregnated Bronze, Self-Lubricating

> SPECIFICATIONS:

* I.D. tolerances: up to & including 1.253 is $\pm .005$
over 1.253 & including 2.502 is $\pm .010$

** O.D. tolerances: up to & including 1.500 is $\pm .010$
over 1.500 & including 3.000 is $+.015, -0$
over 3.000 is $+.020, -0$

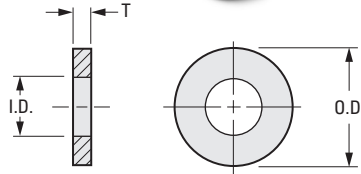

INCH COMPONENT

Catalog Number	I.D.*	O.D.**	T $\pm .0025$
A 7B 7-S080702	.2550	.4375	1/16
A 7B 7-S080802	.2550	.5000	1/16
A 7B 7-S081002	.2550	.6250	1/16
A 7B 7-S101002	.3150	.6250	1/16
A 7B 7-S101202	.3150	.7500	1/16
A 7B 7-S121002	.3850	.6250	1/16
A 7B 7-S121001	.3800	.7500	1/32
A 7B 7-S121202	.3800	.7500	1/16
A 7B 7-S121204	.3800	.7500	1/8
A 7B 7-S141202	.4400	.7500	1/16
A 7B 7-S141204	.4400	.7500	1/8
A 7B 7-S161202	.5050	.7500	1/16
A 7B 7-S161406	.5050	.8750	3/16
A 7B 7-S161602	.5100	1.0000	1/16
A 7B 7-S161603	.5100	1.0000	3/32
A 7B 7-S161604	.5100	1.0000	1/8
A 7B 7-S182002	.5650	1.2500	1/16
A 7B 7-S182004	.5650	1.2500	1/8
A 7B 7-S201602	.6280	1.0000	1/16
A 7B 7-S201604	.6280	1.0000	1/8
A 7B 7-S201902	.6280	1.1875	1/16
A 7B 7-S201903	.6280	1.1875	3/32
A 7B 7-S201904	.6280	1.1875	1/8
A 7B 7-S202002	.6280	1.2500	1/16
A 7B 7-S202004	.6280	1.2500	1/8
A 7B 7-S212402	.6560	1.5000	1/16
A 7B 7-S212404	.6560	1.5000	1/8
A 7B 7-S242002	.7530	1.2500	1/16
A 7B 7-S242004	.7530	1.2500	1/8
A 7B 7-S242202	.7530	1.3750	1/16
A 7B 7-S242204	.7530	1.3750	1/8

Catalog Number	I.D.*	O.D.**	T $\pm .0025$
A 7B 7-S242208	.7530	1.3750	1/4
A 7B 7-S242503	.7650	1.5625	3/32
A 7B 7-S282402	.8905	1.5000	1/16
A 7B 7-S282404	.8905	1.5000	1/8
A 7B 7-S283204	.8800	2.0000	1/8
A 7B 7-S283404	.8905	2.1250	1/8
A 7B 7-S322402	1.0030	1.5000	1/16
A 7B 7-S322404	1.0030	1.5000	1/8
A 7B 7-S322406	1.0030	1.5000	3/16
A 7B 7-S322602	1.0155	1.6250	1/16
A 7B 7-S322802	1.0120	1.7500	1/16
A 7B 7-S322804	1.0120	1.7500	1/8
A 7B 7-S323206	1.0160	2.0000	3/16
A 7B 7-S324604	1.0155	2.8750	1/8
A 7B 7-S343802	1.0625	2.3750	1/16
A 7B 7-S402704	1.2530	1.6900	1/8
A 7B 7-S403202	1.2650	2.0000	1/16
A 7B 7-S403204	1.2650	2.0000	1/8
A 7B 7-S403802	1.2650	2.3750	1/16
A 7B 7-S403804	1.2650	2.3750	1/8
A 7B 7-S405302	1.2550	3.3120	1/16
A 7B 7-S483204	1.5030	2.0000	1/8
A 7B 7-S484004	1.5050	2.5050	1/8
A 7B 7-S485606	1.5100	3.5000	3/16
A 7B 7-S503904	1.5780	2.4375	1/8
A 7B 7-S563904	1.7550	2.4400	1/8
A 7B 7-S564204	1.7650	2.6250	1/8
A 7B 7-S644804	2.0110	3.0000	1/8
A 7B 7-S644808	2.0110	3.0000	1/4
A 7B 7-S655806	2.0310	3.6250	3/16
A 7B 7-S805204	2.5020	3.2500	1/8



NONMETALLIC FLAT WASHERS

SDPSI

INSULATES
SEALS
DAMPENS VIBRATION
PREVENTS GALLING

PHONE: 516.328.3300 • FAX: 516.326.8827 • WWW.SDP-SI.COM



► **MATERIAL:**
Nylon, Natural (Zytel 101) or
Polyvinyl Chloride (PVC), Gray

► **SPECIFICATIONS:**
Nylon - Priced Per 1000 Pieces
PVC - Priced Per 100 Pieces

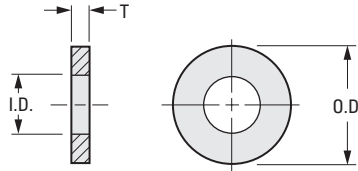

INCH COMPONENT

Catalog Number	I.D.	O.D.	T Thickness	Screw Size
Nylon, Natural (Zytel 101)				
A 9M66-0401	.065	1/8	.010	#0
A 9M66-0601	.080	3/16	.015	#1
A 9M66-0603	.093	3/16	.031	#2
A 9M66-0803	.093	1/4	.031	#2
A 9M66-0802A	.105	1/4	.020	#3
A 9M66-0903	.125	9/32	.031	#4
A 9M66-0802B	.125	1/4	.020	#5
A 9M66-1003	.156	5/16	.031	#6
A 9M66-1203	.187	3/8	.031	#8
A 9M66-1403	.195	7/16	.031	#10
A 9M66-1603A	.227	1/2	.031	#12
A 9M66-1603B	.281	1/2	.031	1/4
A 9M66-2806	.343	7/8	.062	5/16
A 9M66-3206	.406	1	.062	3/8
A 9M66-3606	.500	1-1/8	.062	7/16
A 9M66-4006	.562	1-1/4	.062	1/2
A 9M66-4209	.656	1-5/16	.093	5/8
A 9M66-4709	.812	1-15/32	.093	3/4
Polyvinyl Chloride (PVC), Gray				
A 9P67-1606	9/32	1/2	1/16	1/4
A 9P67-2806	11/32	7/8	1/16	5/16
A 9P67-3206	13/32	1	1/16	3/8
A 9P67-4006	9/16	1-1/4	1/16	1/2
A 9P67-4209	21/32	1-5/16	3/32	5/8
A 9P67-4709	13/16	1-1/2	3/32	3/4

MOLDED SHOULDER WASHERS

PHONE: 516.328.3300 • FAX: 516.326.8827 • WWW.SDP-SI.COM

- INSULATES
- SEALS
- DAMPENS VIBRATION
- PREVENTS GALLING



- › **MATERIAL:**
Nylon (ZYTEL 101)
- › **SPECIFICATION:**
Priced Per 100 Pieces

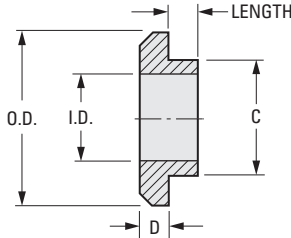

INCH COMPONENT

Catalog Number	Screw Size	I.D.	O.D.	Length	C	D
A 9M68-0904	#4	.122	.281	.040	.187	.040
A 9M68-1004	#6	.146	.328	.040	.218	.040
A 9M68-1205	#8	.174	.375	.050	.250	.050
A 9M68-1405	#10	.201	.437	.050	.281	.050
A 9M68-1806	1/4	.260	.562	.060	.375	.060
A 9M68-2406	3/8	.385	.750	.060	.500	.060

COUNTERSUNK FINISHING WASHERS

- MAXIMUM STRENGTH
- INSULATES
- DAMPENS VIBRATION
- PREVENTS SCRATCHING

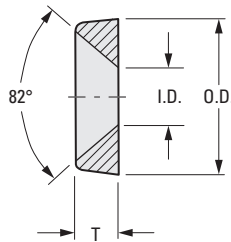

- › **MATERIAL:**
Nylon (ZYTEL 101)
- › **SPECIFICATION:**
Priced Per 100 Pieces

INCH COMPONENT

Catalog Number	Screw Size	I.D.	O.D.	Length
A 9M69-1410	#6	.143	.437	.100
A 9M69-1611	#8	.171	.515	.115
A 9M69-1815	#10	.191	.580	.152
A 9M69-2218	1/4	.251	.683	.183

> MATERIAL:

1074 Spring Steel (ASTM-A684)
302 Stainless Steel (AMS 5906)

PHONE: 516.328.3300 • FAX: 516.326.8827 • WWW.SDP-SI.COM



> SPECIFICATION:

Priced Per 10 Pieces

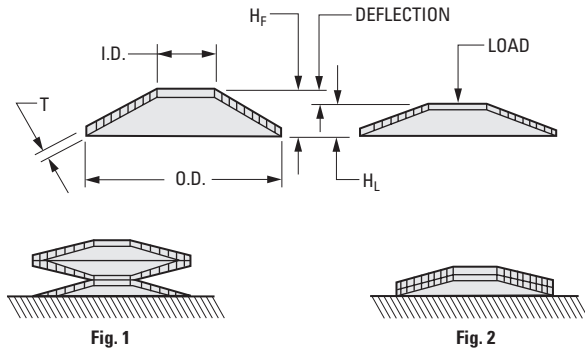

Fig. 1

Fig. 2

Fig. 1
Series Stacking (washers opposing)

For a given load, the total deflection of the stack is approximately equal to the individual washer deflection multiplied by the number of washers in the stack.

Fig. 2
Parallel Stacking (washers resting)

For a given deflection, the total load applied to the stack is approximately equal to the individual washer load multiplied by the number of washers in the stack.

INCH COMPONENT		I.D. Min.	O.D. Max.	T Stock Thick.	H _F Free Height	H _L Loaded Height	Load @ H _L lbf Min. – Max.	Load @ Flat
Catalog Number								
Spring Steel	Stainless Steel							
A 7Q 9-06010	A 7X 9-06010	.093	.187	.0100	.015	.0125	13 – 17.6	27.8
A 7Q 9-08013	A 7X 9-08013	.125	.250	.0133	.020	.0170	22 – 30	48.0
A 7Q 9-10016	A 7X 9-10016	.156	.312	.0166	.025	.0210	35 – 48	75.0
A 7Q 9-12020	A 7X 9-12020	.190	.375	.0200	.030	.0250	51 – 69	110.0
A 7Q 9-16025	A 7X 9-16025	.255	.500	.0250	.038	.0310	80 – 110	160.0
A 7Q 9-20032	A 7X 9-20032	.317	.625	.0320	.048	.0400	123 – 167	260.0
A 7Q 9-24040	A 7X 9-24040	.380	.750	.0400	.059	.0490	199 – 271	415.0
A 7Q 9-32050	A 7X 9-32050	.505	1.000	.0500	.075	.0620	289 – 391	600.0
A 7Q 9-40062	A 7X 9-40062	.630	1.250	.0620	.092	.0770	403 – 547	870.0
A 7Q 9-48072	A 7X 9-48072	.750	1.500	.0720	.107	.0890	565 – 765	1180.0

› MATERIAL:

301 Stainless Steel
Spring Steel AISI C1075 Blued

PHONE: 516.328.3300 • FAX: 516.326.8827 • WWW.SDP-SI.COM



› SPECIFICATION:

Priced Per 10 Pieces

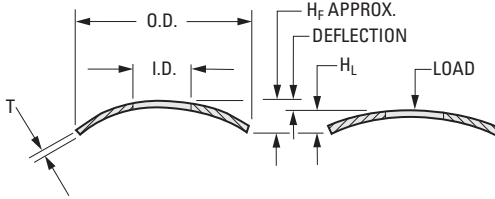

INCH COMPONENT								
Catalog Number		I.D.	O.D.	T Stock Thick.	H _f Free Height	H _L Loaded Height	Load @ H _L ± 15% lbf	For Screw Size
Stainless Steel	Steel							
A 7X 9-1W02406	—	.135	.245	.0060	.034	.020	2.00	#5
A 7X 9-1W02704	—	.148	.270	.0045	.052	.028	1.25	#6
A 7X 9-1W02707	—	.148	.270	.0070	.035	.022	2.50	#6
A 7X 9-1W03205	A 7Q 9-1W03205	.174	.322	.0050	.064	.034	1.50	#8
A 7X 9-1W03207	—	.174	.322	.0075	.042	.025	3.00	#8
A 7X 9-1W03706	—	.200	.370	.0060	.069	.035	2.25	#10
A 7X 9-1W03709	A 7Q 9-1W03709	.200	.370	.0090	.047	.028	4.50	#10
A 7X 9-1W04210	—	.231	.423	.0100	.053	.032	5.00	#12
A 7X 9-1W04907	—	.265	.490	.0075	.091	.046	3.50	1/4
—	A 7Q 9-1W04911	.265	.490	.0110	.063	.034	7.00	1/4
—	A 7Q 9-1W05512	.296	.551	.0120	.070	.038	8.00	9/32
A 7X 9-1W06109	—	.327	.612	.0090	.113	.060	4.50	5/16
A 7X 9-1W06113	A 7Q 9-1W06113	.327	.612	.0130	.077	.042	9.00	5/16
—	A 7Q 9-1W06715	.363	.672	.0150	.081	.047	11.00	11/32
A 7X 9-1W07311	A 7Q 9-1W07311	.395	.735	.0110	.129	.073	6.00	3/8
A 7X 9-1W07316	A 7Q 9-1W07316	.395	.735	.0160	.086	.050	12.00	3/8
A 7X 9-1W08518	A 7Q 9-1W08518	.462	.857	.0180	.100	.057	15.00	7/16
—	A 7Q 9-1W09814	.525	.980	.0140	.164	.083	10.00	1/2
A 7X 9-1W09821	A 7Q 9-1W09821	.525	.980	.0210	.110	.063	20.00	1/2

10

11

12

13

14

15

16

THIN WALL SERIES

PHONE: 516.328.3300 • FAX: 516.326.8827 • WWW.SDP-SI.COM

> MATERIAL:

302 Stainless Steel (MIL-S-5057), Unfinished

> SPECIFICATION:

Priced Per 10 Pieces

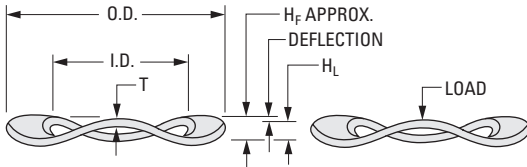

INCH COMPONENT

Catalog Number	I.D.	O.D.	T Stock Thickness	H _f Free Height	H _l Loaded Height	Load @ H _l lbf	Use Inside Bore Ref.
A 7X 9-3W03606	.265	.367	.006	.030	.015	2 – 4	3/8
A 7X 9-3W04907	.350	.492	.007	.035	.020	3 – 5	1/2
A 7X 9-3W06108	.440	.618	.008	.040	.025	3 – 5	5/8
A 7X 9-3W07309	.531	.734	.009	.050	.030	4 – 7	3/4
A 7X 9-3W08510	.650	.855	.010	.060	.030	4 – 7	7/8
A 7X 9-3W11012	.856	1.102	.012	.075	.037	9 – 13	1-1/8

NOTE: O.D. and I.D. are blank (before bend) dimensions.

SCREW SIZE SERIES

> MATERIAL:

Beryllium Copper or Stainless Steel

> SPECIFICATION:

Priced Per 100 Pieces

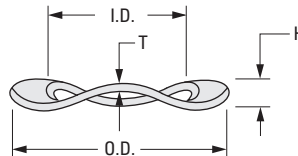

INCH COMPONENT

Catalog Number		I.D.	O.D.	T	H	Nominal Screw Size
Beryllium Copper	Stainless Steel					
AB3401-EA150X006	AB3401-XP150X006	.075	.150	.006	.017	#0
AB3401-EA206X006	AB3401-XP206X006	.095	.206	.006	.018	#2
AB3401-EA250X006	AB3401-XP250X006	.125	.250	.006	.021	#4
AB3401-EA265X006	AB3401-XP265X006	.134	.265	.006	.021	#5
AB3401-EA300X008	AB3401-XP300X008	.152	.300	.008	.028	#6
AB3401-EA340X010	AB3401-XP340X010	.176	.340	.010	.030	#8
AB3401-EA375X012	AB3401-XP375X012	.203	.375	.012	.032	#10
AB3401-EA500X014	AB3401-XP500X014	.266	.500	.014	.042	1/4
AB3401-EA600X014	AB3401-XP600X014	.332	.600	.014	.052	5/16
AB3401-EA700X022	AB3401-XP700X022	.406	.700	.022	.064	3/8
AB3401-EA950X022	AB3401-XP950X022	.531	.950	.022	.076	1/2

SPLIT LOCK WASHERS



ASME B18.21.1

PHONE: 516.328.3300 • FAX: 516.326.8827 • WWW.SDP-SI.COM

› MATERIAL:

Alloy Steel or Stainless Steel

› FINISH:

Black Oxide for Alloy Steel

› SPECIFICATION:

Priced Per 100 Pieces

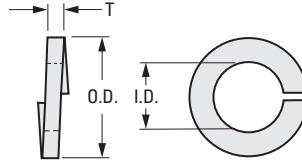

INCH COMPONENT

Catalog Number		Screw Size Ref.	I.D. Max.	O.D. Max.	T Min.
Alloy Steel with Black Oxide Finish	Stainless Steel				
A 9Q19-00	A 9X19-00	#0	.062	.137	.017
A 9Q19-02	A 9X19-02	#2	.094	.172	.020
A 9Q19-04	A 9X19-04	#4	.120	.209	.025
A 9Q19-06	A 9X19-06	#6	.148	.250	.031
A 9Q19-08	A 9X19-08	#8	.174	.293	.040
A 9Q19-10	A 9X19-10	#10	.200	.334	.047
A 9Q19-25	A 9X19-25	1/4	.260	.487	.062
A 9Q19-31	A 9X19-31	5/16	.322	.583	.078
A 9Q19-37	A 9X19-37	3/8	.385	.680	.094

> MATERIAL:

Stainless Steel

> SPECIFICATION:

Priced Per 100 Pieces

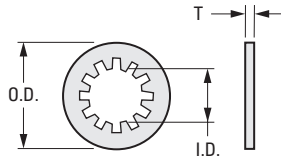

Fig. 1 Internal

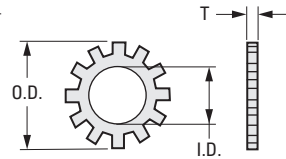

Fig. 2 External

INCH COMPONENT

Catalog Number	I.D. Screw Size	O.D.	T	
			Min.	Max.
Fig. 1 Internal				
A 9X21-I02	#2	.200	.010	.015
A 9X21-I04	#4	.270	.015	.019
A 9X21-I06	#6	.295	.017	.021
A 9X21-I08	#8	.340	.018	.023
A 9X21-I10	#10	.381	.020	.025
A 9X21-I25	1/4	.478	.023	.028
A 9X21-I31	5/16	.610	.028	.034
A 9X21-I38A	3/8	.692	.032	.040
A 9X21-I38B	3/8	.562	.032	.040
Fig. 2 External				
A 9X21-E04	#4	.260	.015	.019
A 9X21-E06	#6	.320	.016	.022
A 9X21-E08	#8	.381	.018	.023
A 9X21-E10	#10	.410	.020	.025
A 9X21-E25	1/4	.510	.023	.028
A 9X21-E38	3/8	.694	.032	.040

