

# MINIATURE FAIRLOC® BELLOWS COUPLINGS



ZERO BACKLASH  
EASY INSTALLATION  
READILY REPOSITIONED

PHONE: 516.328.3300 • FAX: 516.326.8827 • WWW.SDP-SI.COM



**> MATERIAL:**

- Hubs** - Brass
- Bellows** - Phosphor Bronze
- Socket Head Screws** - 300 Series Stainless Steel
- Finish** - Tin Plate

**> MISALIGNMENT COMPENSATION:**

**Max. Lateral Offset:** ±.005

**> FEATURES:**

- Absorbs end play in shafts
- Allows looser tolerances in mounting components
- Corrects for angular and parallel axis misalignment
- Constant angular velocity
- Dampens vibration and noise
- Fairloc® eliminates marred shafts

Fairloc® hubs require controlled shaft tolerances.  
Suggested clearance fit between the bore and shaft is .0001/.0008.

Other bores, finishes available on special order.

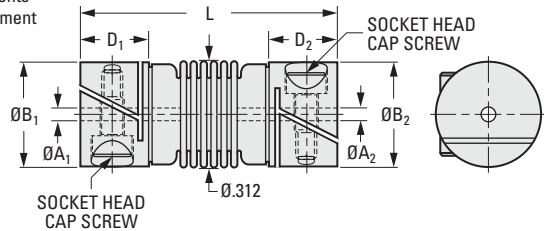

**INCH COMPONENT**

Catalog Number	A <sub>1</sub> Bore +.001 -.000	A <sub>2</sub> Bore +.001 -.000	B <sub>1</sub> Hub Dia. ± .005	B <sub>2</sub> Hub Dia. ± .005	D <sub>1</sub> ± .005	D <sub>2</sub> ± .005	L Overall Length ± .06	Cap Screw	
S50FP9-FB063063A	.0625	.0625	.359	.359	.283	.283	.853	#2-56	
S50FP9-FB063120A		.120		.391		.331	.912		
S50FP9-FB063125A		.125		.406		.331	.969		
S50FP9-FB120120A	.120	.120	.391	.391	.331	.331	#2-56		
S50FP9-FB120125A		.125		.406		.331			.969
S50FP9-FB125125A		.125		.406		.331			.969

Catalog Number (Ref. Only)	Max. Torque ozf in.	Max. Angular Offset	Max. Lateral Offset	Max. Axial Motion	Torsional Deflection @ Max. Load
S50FP9-FB063063A S50FP9-FB063120A S50FP9-FB063125A	30	3°	± .005	+ .010 / - .020	.2° .4°
S50FP9-FB120120A S50FP9-FB120125A S50FP9-FB125125A	60	3°	± .005	+ .010 / - .020	.4°

- I
- R
- T
- 1
- 2
- 3
- 4
- 5
- NEW
- 7
- 8
- 9
- 10
- 11
- 12
- 13
- 14
- 15
- 16