

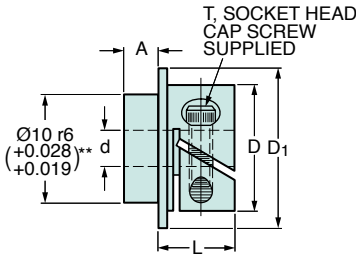

Precision Gear & Dial Hubs – Fairloc® Type

Stock Drive Products/Sterling Instrument ■ Phone: 516-328-3300 ■ Fax: 516-326-8827



NOTE: d bore and mounting diameter are concentric to 0.005 mm.

MATERIAL: 303 Stainless Steel

Catalog Number	A	d* Bore H7	L	D	T	D ₁	Clear. Radius						
S2F0MYM016025 S2F0MYM032025	1.6 3.2	2.5	8.5	11	M2	14	6.4						
S2F0MYM016030 S2F0MYM032030 S2F0MYM060030 S2F0MYM080030 S2F0MYM100030	1.6 3.2 6 8 10	3											
S2F0MYM016040 S2F0MYM032040 S2F0MYM060040 S2F0MYM080040 S2F0MYM100040	1.6 3.2 6 8 10	4											
S2F0MYM016050 S2F0MYM032050 S2F0MYM048050	1.6 3.2 4.8	5						8.5	14	M2.5	17	8.3	
S2F0MYM050050 S2F0MYM060050 S2F0MYM080050 S2F0MYM100050	5 6 8 10												
S2F0MYM016060 S2F0MYM032060 S2F0MYM048060	1.6 3.2 4.8												6
S2F0MYM050060 S2F0MYM060060 S2F0MYM080060 S2F0MYM100060	5 6 8 10												
S2F0MYM016080 S2F0MYM032080 S2F0MYM048080 S2F0MYM050080	1.6 3.2 4.8 5	8											

*Bore Tolerance: 2.5 & 3 mm + 0.01
4, 5 & 6 mm + 0.012
8 mm + 0.015

**To provide press fit, use tolerance according to H7 for the mating part bore diameter.

NOTE: Fairloc® hubs require controlled shaft tolerances. Suggested tolerance according to g6, h6 or h7.