

CLOCKWISE
PRECISION LASER ENGRAVED

PHONE: 516.328.3300 • FAX: 516.326.8827 • WWW.SDP-SI.COM

> MATERIAL:

2024 Aluminum, Black Hard Anodized

> MODIFICATION:

Assembled with hubs upon request at nominal charge.

See index for hubs

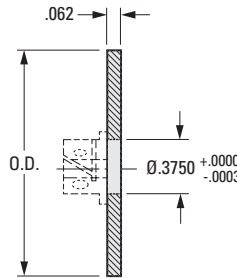
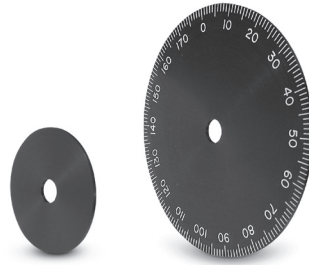

INCH COMPONENT

Catalog Number	O.D. +.000 -.003	No. of Graduations	Steps in Degrees	Dial Range
S1228Y-GA-02	1.500	180	2°	0 ... 360
S1228Y-GA-04	1.500	60	6°	0 ... 60
S1228Y-GA-05	1.500	50	7°12'	0 ... 50
S1228Y-GA-06	1.500	25	14°24'	0 ... 25
S1228Y-GA-07	1.500	10	36°	0 ... 10
S1228Y-GA-10	2.000	120	3°	0 ... 120
S1228Y-GA-11	2.000	100	3°36'	0 ... 100
S1228Y-GA-12	2.000	72	5°	0 ... 72
S1228Y-GA-13	2.000	60	6°	0 ... 60
S1228Y-GA-14	2.000	50	7°12'	0 ... 50
S1228Y-GA-15	2.000	25	14°24'	0 ... 25
S1228Y-GA-16	2.000	10	36°	0 ... 10
S1228Y-GA-17	3.000	BLANK	—	—
S1228Y-GA-18	3.000	360	1°	0 ... 360
S1228Y-GA-19	3.000	180	2°	0 ... 360
S1228Y-GA-20	3.000	200	1°48'	0 ... 200
S1228Y-GA-21	3.000	180	2°	0 ... 180
S1228Y-GA-22	3.000	120	3°	0 ... 120
S1228Y-GA-23	3.000	100	3°36'	0 ... 100
S1228Y-GA-24	3.000	72	5°	0 ... 72
S1228Y-GA-25	3.000	50	7°12'	0 ... 50
S1228Y-GA-26	3.000	10	36°	0 ... 10
S1228Y-GA-27	4.000	BLANK	—	—
S1228Y-GA-29	4.000	180	2°	0 ... 360
S1228Y-GA-30	4.000	200	1°48'	0 ... 200
S1228Y-GA-31	4.000	180	2°	0 ... 180
S1228Y-GA-32	4.000	100	3°36'	0 ... 100
S1228Y-GA-33	4.000	50	7°12'	0 ... 50
S1228Y-GA-34	4.000	10	36°	0 ... 10



CLOCKWISE
PRECISION LASER ENGRAVED

PHONE: 516.328.3300 • FAX: 516.326.8827 • WWW.SDP-SI.COM

> MATERIAL:

2024 Aluminum, Black Hard Anodized

> MODIFICATION:

Assembled with hubs upon request at nominal charge.

See index for hubs

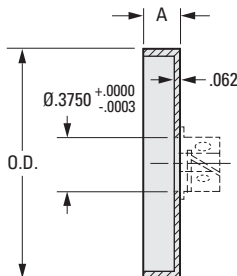

INCH COMPONENT

Catalog Number	A	O.D. ± .005	No. of Graduations	Steps in Degrees	Dial Range
S5189Y-GB-02	3/8	.990	100	3° 36'	0 ... 100
S5189Y-GB-06		1.490	100	3° 36'	0 ... 100
S5189Y-GB-07		1.990	180	2°	0 ... 360
S5189Y-GB-12				1°	0 ... 180
S5189Y-GB-13	1/2	2.490	180	2°	0 ... 360
S5189Y-GB-18			360	1°	0 ... 360
S5189Y-GB-19		100	3° 36'	0 ... 100	
S5189Y-GB-24		2.990	360	1°	0 ... 360
S5189Y-GB-25			180	2°	

- I
- R
- T
- 1
- 2
- 3
- 4
- 5
- 6
- 7
- 8
- 9
- 10**
- 11
- 12
- 13
- 14
- 15
- 16