

> **MATERIAL:**
Carbon Steel

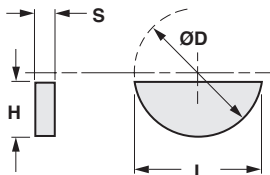

METRIC COMPONENT

Catalog Number	Width		Height		L Length	D Dia.	For Shaft Dia.			
	S	Tol.	H	Tol.			Over	To		
A 9C49M01507	1.5	0/-0.025	2.6	0/-0.1	6.76	7	4	6		
A 9C49M02007	2		3.7				6	8		
A 9C49M02010	2	0/-0.025	5	0/-0.12	9.66	10	6	8		
A 9C49M02013			12.65		13					
A 9C49M02510	2.5	0/-0.025	3.7	0/-0.12	9.66	10	8	10		
A 9C49M03010	3		5						12.65	13
A 9C49M03013	3	0/-0.025	6.5	0/-0.15	15.72	16	8	10		
A 9C49M03016			7.5		18.57				19	
A 9C49M03019			5		12.65				13	
A 9C49M04013			6.5		0/-0.15				15.72	16
A 9C49M04016	4	0/-0.03	7.5	0/-0.15	18.57	19	10	12		
A 9C49M04019			9		0/-0.15				21.63	22
A 9C49M04022			6.5		15.72				16	
A 9C49M05016			7.5		0/-0.15				18.57	19
A 9C49M05019	5	0/-0.03	9	0/-0.15	21.63	22	12	17		
A 9C49M05022			10		24.49				25	
A 9C49M05025			9		0/-0.15				21.63	22
A 9C49M06022			10		0/-0.15				24.49	25
A 9C49M06025	6	0/-0.03	11	0/-0.18	27.35	28	17	22		
A 9C49M06028			9		0/-0.15				21.63	22
A 9C49M08028	8	0/-0.036	11	0/-0.18	27.35	28	22	30		
A 9C49M08032			13		31.43				32	
A 9C49M10032			13		31.43				32	
A 9C49M10045	10	0/-0.036	16	0/-0.18	43.08	45	30	38		

DIN 6885A
ROUND ENDED

PHONE: 516.328.3300 • FAX: 516.326.8827 • WWW.SDP-SI.COM



> **MATERIAL:**
Carbon Steel



> **SPECIFICATION:**
b Tolerance:

- 3 mm 0/-0.025
- 4 to 6 mm 0/-0.030
- 8 & 10 mm 0/-0.036
- 12, 14 & 16 mm 0/-0.043

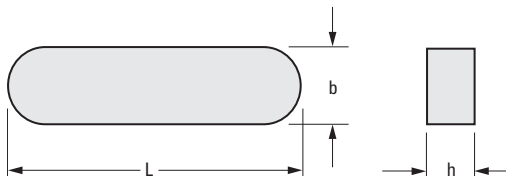

- I
- R
- T
- 1
- 2
- 3
- 4
- 5
- 6
- 7
- 8
- 9
- 10
- 11
- 12
- 13
- 14
- 15
- A

METRIC COMPONENT

Catalog Number	b Width h9	h Height	L Length
A 9C39M030306	3	3	6
A 9C39M030308			8
A 9C39M030310			10
A 9C39M030314			14
A 9C39M030320			20
A 9C39M030325			25
A 9C39M040408	4	4	8
A 9C39M040410			10
A 9C39M040414			14
A 9C39M040416			16
A 9C39M040420			20
A 9C39M040425			25
A 9C39M050510	5	5	10
A 9C39M050514			14
A 9C39M050516			16
A 9C39M050520			20
A 9C39M050525			25
A 9C39M050536			36
A 9C39M060610	6	6	10
A 9C39M060614			14
A 9C39M060616			16
A 9C39M060620			20
A 9C39M060628			28

Catalog Number	b Width h9	h Height	L Length		
A 9C39M060636	6	6	36		
A 9C39M080710	8	7	10		
A 9C39M080716			16		
A 9C39M080720			20		
A 9C39M080725			25		
A 9C39M080736			36		
A 9C39M080745			45		
A 9C39M100825	10	8	25		
A 9C39M100828			28		
A 9C39M100836			36		
A 9C39M100845			45		
A 9C39M100856			56		
A 9C39M120828			12	8	28
A 9C39M120836	36				
A 9C39M120845	45				
A 9C39M120856	56				
A 9C39M120863	63				
A 9C39M140936	14	9			36
A 9C39M140945			45		
A 9C39M140956			56		
A 9C39M140963			63		
A 9C39M161056			16	10	56
A 9C39M161063					63