

NEEDLE ROLLER BEARINGS



FOR 1/8 TO 1 INCH HARDENED SHAFTS
EXTREMELY HIGH-SPEED
HIGH LOAD CAPACITY

PHONE: 516.328.3300 • FAX: 516.326.8827 • WWW.SDP-SI.COM



► MATERIAL:

- Roller Cup** - Case-Hardened Steel
- Needle Bearing** - 52100 Hardened Chrome Steel
- Bearing Cage** - Low Carbon Steel

► FEATURES:

- Low profile, lightweight caged.
- Caged needle bearings offer up to 3 times the speed of uncaged designs.
- Extremely low rolling friction.
- High lubrication capacity.
- Low sensitivity to misalignment.
- Needles have high length to diameter ratios.

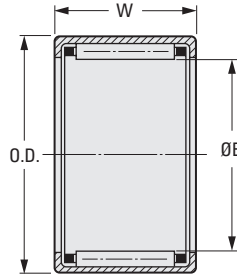

INCH COMPONENT

Catalog Number	B Bore	O.D.	Housing ^Δ Bore Dia.	W +.000 -.010	Max.* Speed rpm	Load Rating lbf		Shaft [§] Diameter	Inner Race Available See Series S99RH2-...
						Dynamic	Static		
S99NH2-BN0408	1/8	.2500	.2505/.2500	.250	48000	240	165	.1250/.1247	—
S99NH2-BN0608	3/16	.3438	.3437/.3432	.250	40000	400	305	.1875/.1872	—
S99NH2-BN0612	3/16	.3438	.3437/.3432	.375	40000	620	530	.1875/.1872	—
S99NH2-BN0808	1/4	.4375	.4380/.4370	.250	35000	360	260	.2500/.2495	—
S99NH2-BN0814	1/4	.4375	.4380/.4370	.438	35000	920	870	.2500/.2495	—
S99NH2-BN1010	5/16	.5000	.5005/.4995	.312	29000	650	590	.3125/.3120	—
S99NH2-BN1018	5/16	.5000	.5005/.4995	.562	29000	1340	1480	.3125/.3120	—
S99NH2-BN1210	3/8	.5625	.5630/.5620	.312	25000	650	610	.3750/.3745	—
S99NH2-BN1220	3/8	.5625	.5630/.5620	.625	25000	1660	2040	.3750/.3745	—
S99NH2-BN1610	1/2	.6875	.6880/.6870	.312	19000	820	890	.5000/.4995	—
S99NH2-BN1612	1/2	.6875	.6880/.6870	.375	19000	1040	1210	.5000/.4995	—
S99NH2-BN1624	1/2	.6875	.6880/.6870	.750	19000	2230	3200	.5000/.4995	—
S99NH2-BN2014	5/8	.8125	.8130/.8120	.438	16000	1480	2100	.6250/.6245	—
S99NH2-BN2024	5/8	.8125	.8130/.8120	.750	16000	2700	4450	.6250/.6245	S99RH2-BNR1220A
S99NH2-BN2412	3/4	1.0000	1.0005/.9995	.375	13000	1600	1860	.7500/.7495	—
S99NH2-BN2416	3/4	1.0000	1.0005/.9995	.500	13000	2210	2800	.7500/.7495	S99RH2-BNR1624
S99NH2-BN2424	3/4	1.0000	1.0005/.9995	.750	13000	3450	5000	.7500/.7495	S99RH2-BNR1624A
S99NH2-BN3216	1	1.2500	1.2505/1.2495	.500	10000	2850	4300	1.0000/.9995	S99RH2-BNR2432
S99NH2-BN3232	1	1.2500	1.2505/1.2495	1.000	10000	5600	10200	1.0000/.9995	S99RH2-BNR2432A

[§] Shaft surface hardness must be Rc 58 minimum; or use inner race over softer shaft, where available.

^Δ For ferrous materials.

* Represents speed values of bearings lubricated with oil. With grease lubricant, 60% of given values are permissible. Standard bearings are oiled or greased, at our option, with general purpose lubricants. Other lubricants are available on special order.

INNER RACES FOR NEEDLE BEARINGS



USED AS INNER RACE ON SOFT SHAFTS
CAN BE USED AS HARDENED BUSHINGS

PHONE: 516.328.3300 • FAX: 516.326.8827 • WWW.SDP-SI.COM



> MATERIAL:

Alloy Steel, Hardened To Rc 58 Min.

> FEATURES:

- O.D. ground to 16 µin. AA surface roughness.
- All corners chamfered for easy assembly.
- Wider units to accommodate shaft translation.

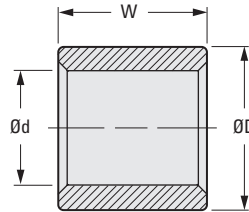
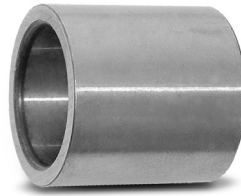

INCH COMPONENT

Catalog Number	d I.D. +.0000 -.0005	D O.D. +.0000 -.0005	W Width +.015 -.005	Shaft Diameter Press Fit	Shaft Diameter Slip Fit
S99RH2-BNR1218A	.3750	.5625	.750	.3755/.3752	.3748/.3744
S99RH2-BNR1220A	.3750	.6250	.750	.3755/.3752	.3748/.3744
S99RH2-BNR1624A	.5000	.7500	.750	.5006/.5003	.4998/.4993
S99RH2-BNR1624C	.5000	.7500	1.000	.5006/.5003	.4998/.4993
S99RH2-BNR2028B	.6250	.8750	.750	.6256/.6253	.6248/.6243
S99RH2-BNR2028C	.6250	.8750	1.000	.6256/.6253	.6248/.6243
S99RH2-BNR2432	.7500	1.0000	.500	.7507/.7503	.7497/.7492
S99RH2-BNR2432B	.7500	1.0000	.750	.7507/.7503	.7497/.7492
*S99RH2-BNR2432A	.7500	1.0000	1.000	.7507/.7503	.7497/.7492

* To be discontinued when present stock is depleted

