

SINGLE-POINT CONTACT

PHONE: 516.328.3300 • FAX: 516.326.8827 • WWW.SDP-SI.COM

> MATERIAL / FINISH:

Body - Carbon Steel, Black Oxide Finish;
304 Stainless Steel

Ball - Carbon Steel, HRC 56...60;
440C Stainless Steel, HRC 55...60

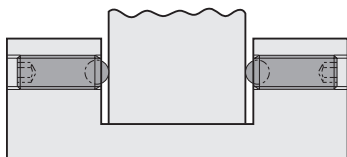

Example of application to fasten workpiece that damages easily.

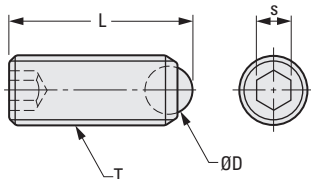

The projections shown are per ISO convention.

METRIC COMPONENT

Catalog Number		T Thread Size	L	D Dia.	s Hex Size	Mass g
Carbon Steel	Stainless Steel					
S705CBM0305	S705YBM0305	M3 x 0.5	5.2	1.5	1.5	0.3
S705CBM0310	S705YBM0310		10.2			0.6
S705CBM0407	S705YBM0407	M4 x 0.7	6.5	2.5	2	0.4
S705CBM0411	S705YBM0411		10.5			0.7
S705CBM0417	S705YBM0417		16.5			1
S705CBM0509	S705YBM0509	M5 x 0.8	8.6	3	2.5	0.8
S705CBM0513	S705YBM0513		12.6			1.3
S705CBM0521	S705YBM0521		20.6			2.3
S705CBM0611	S705YBM0611	M6 x 1	10.8	4	3	1.5
S705CBM0617	S705YBM0617		16.8			2.5
S705CBM0621	S705YBM0621		20.8			3.4
S705CBM0626	S705YBM0626		25.8			4
S705CBM0811	S705YBM0811	M8 x 1.25	11.2	5.5	4	2.5
S705CBM0813	S705YBM0813		13.2			3.2
S705CBM0821	S705YBM0821		21.2			5.7
S705CBM0826	S705YBM0826		26.2			7.7
S705CBM0831	S705YBM0831		31.2			9
S705CBM1014	S705YBM1014	M10 x 1.5	13.7	7	5	5
S705CBM1018	S705YBM1018		17.7			7
S705CBM1022	S705YBM1022		21.7			9.5
S705CBM1027	S705YBM1027		26.7			11
S705CBM1037	S705YBM1037		36.7			16
S705CBM1218	S705YBM1218	M12 x 1.75	18	8.5	6	10
S705CBM1222	S705YBM1222		22			12.5
S705CBM1232	S705YBM1232		32			20
S705CBM1242	S705YBM1242		42			28
S705CBM1623	S705YBM1623		23.3			22
S705CBM1628	S705YBM1628	M16 x 2	28.3	12	8	28
S705CBM1638	S705YBM1638		38.3			41
S705CBM1653	S705YBM1653		53.3			48

FLAT-BALL TIP SET SCREWS



CAN ACCOMMODATE TILTED SURFACES

PHONE: 516.328.3300 • FAX: 516.326.8827 • WWW.SDP-SI.COM

> MATERIAL / FINISH:

Body - Carbon Steel, Black Oxide Finish;
304 Stainless Steel

Ball - Carbon Steel, HRC 56...60;
440C Stainless Steel, HRC 55...60

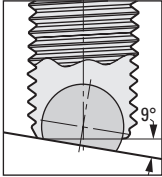

The ball can rotate up to 9° to securely fasten the object.

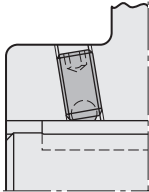

Application Example

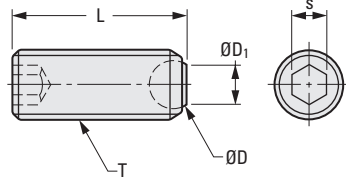

The projections shown are per ISO convention.

METRIC COMPONENT

Catalog Number		T Thread Size	L	D Dia.	D ₁ Dia.	s Hex Size	Mass g
Carbon Steel	Stainless Steel						
S705CFM0406	S705YFM0406	M4 x 0.7	6	2.5	2	2	0.4
S705CFM0410	S705YFM0410		10				0.7
S705CFM0416	S705YFM0416		16				1
S705CFM0508	S705YFM0508	M5 x 0.8	8	3	2.5	2.5	0.8
S705CFM0512	S705YFM0512		12				1.3
S705CFM0520	S705YFM0520		20				2.3
S705CFM0610	S705YFM0610	M6 x 1	10	4	3.2	3	1.5
S705CFM0616	S705YFM0616		16				2.5
S705CFM0620	S705YFM0620		20				3.4
S705CFM0625	S705YFM0625		25				4
S705CFM0810	S705YFM0810	M8 x 1.25	10	5.5	4.5	4	2.5
S705CFM0812	S705YFM0812		12				3.2
S705CFM0820	S705YFM0820		20				5.7
S705CFM0825	S705YFM0825		25				7.7
S705CFM0830	S705YFM0830		30				9
S705CFM1012	S705YFM1012	M10 x 1.5	12	7	6	5	5
S705CFM1016	S705YFM1016		16				7
S705CFM1020	S705YFM1020		20				9.5
S705CFM1025	S705YFM1025		25				11
S705CFM1035	S705YFM1035		35				16
S705CFM1216	S705YFM1216	M12 x 1.75	16	8.5	7.2	6	10
S705CFM1220	S705YFM1220		20				12.5
S705CFM1230	S705YFM1230		30				20
S705CFM1240	S705YFM1240		40				28
S705CFM1620	S705YFM1620		20				22
S705CFM1625	S705YFM1625	M16 x 2	25	12	10.7	8	28
S705CFM1635	S705YFM1635		35				41
S705CFM1650	S705YFM1650		50				48

I

R

T

1

2

3

4

5

6

7

8

9

10

11

12

13

14

15

A

DIN 916
CUP POINT

PHONE: 516.328.3300 • FAX: 516.326.8827 • WWW.SDP-SI.COM

➤ MATERIAL / FINISH:

Hardened Steel, Black Oxide Finish
or 304 Stainless Steel

➤ SPECIFICATION:

Priced Per 100 Pieces

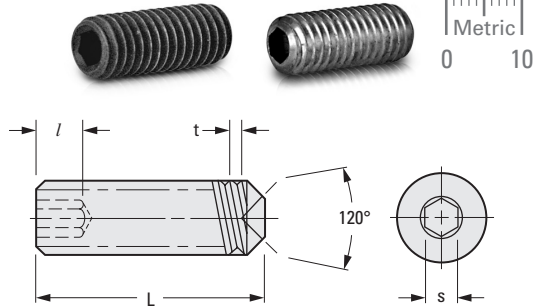

The projections shown are per ISO convention.

METRIC COMPONENT		T Thread Size	L	l min.	s	t
Catalog Number						
Hardened Steel	304 Stainless Steel					
MD0916MQB020X003	MD0916MXO020X003	M2	3	0.8	0.9	0.4
MD0916MQB020X004	MD0916MXO020X004		4			
MD0916MQB020X005	MD0916MXO020X005		5			
MD0916MQB025X003	MD0916MXO025X003	M2.5	3	1.2	1.3	0.45
MD0916MQB025X004	MD0916MXO025X004		4			
MD0916MQB025X005	MD0916MXO025X005		5			
MD0916MQB025X006	MD0916MXO025X006	6				
MD0916MQB030X003	MD0916MXO030X003	M3	3	1.2	1.5	0.5
MD0916MQB030X004	MD0916MXO030X004		4			
MD0916MQB030X005	MD0916MXO030X005		5			
MD0916MQB030X006	MD0916MXO030X006	6				
MD0916MQB030X008	MD0916MXO030X008	8				
MD0916MQB040X004	MD0916MXO040X004	M4	4	1.5	2	0.7
MD0916MQB040X005	MD0916MXO040X005		5			
MD0916MQB040X006	MD0916MXO040X006		6			
MD0916MQB040X008	MD0916MXO040X008	8				
MD0916MQB040X010	MD0916MXO040X010	10				
MD0916MQB050X005	MD0916MXO050X005	M5	5	2	2.5	0.8
MD0916MQB050X006	MD0916MXO050X006		6			
MD0916MQB050X008	MD0916MXO050X008		8			
MD0916MQB050X010	MD0916MXO050X010	10				
MD0916MQB050X012	MD0916MXO050X012	12				
MD0916MQB060X006	MD0916MXO060X006	M6	6	2	3	1
MD0916MQB060X008	MD0916MXO060X008		8			
MD0916MQB060X010	MD0916MXO060X010		10			
MD0916MQB060X012	MD0916MXO060X012	12				
MD0916MQB060X016	MD0916MXO060X016	16				
MD0916MQB080X008	MD0916MXO080X008	M8	8	3	4	1.25
MD0916MQB080X010	MD0916MXO080X010		10			
MD0916MQB080X012	MD0916MXO080X012		12			
MD0916MQB080X016	MD0916MXO080X016	16				
MD0916MQB080X020	MD0916MXO080X020	20				



NYLON TIPPED SET SCREWS



SELF-LOCKING
NONMARRING

PHONE: 516.328.3300 • FAX: 516.326.8827 • WWW.SDP-SI.COM



> MATERIAL:

Screw - 300 Series Stainless Steel (18-8)
Tip - Nylon

> SPECIFICATIONS:

Slotted Head Style: Class 2A
Socket Head Style: Class 3A

For engineering assistance for all SDP components, call on our application engineers.

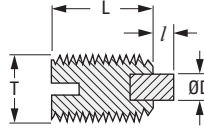

SLOTTED HEAD STYLE

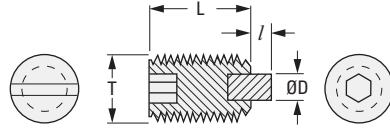

SOCKET HEAD STYLE

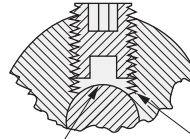

CONFORMS TO SHAFT
WITHOUT MARRING

COMPRESSES INTO THREADS
BECOMING SELF-LOCKING

METRIC COMPONENT						
Catalog Number	T Thread Size	L	l	D Dia.		
Slotted Head Style - Class 2A						
A 9X93MSL030050	M3 x 0.5	5	0.8	1.6		
A 9X93MSL050110	M5 x 0.8	11	1.2	2.4		
A 9X93MSL060075	M6 x 1	7.5	1.6	3.2		
Socket Head Style - Class 3A						
A 9X93MSO020040	M2 x 0.4	3	0.8	0.8		
A 9X93MSO020050		4				
A 9X93MSO020060		5				
A 9X93MSO020070		6				
A 9X93MSO030040	M3 x 0.5	3		1.6	1.6	
A 9X93MSO030050		4				
A 9X93MSO030060		5				
A 9X93MSO030070		6				
A 9X93MSO040050	M4 x 0.7	4	1.2		2.4	
A 9X93MSO040070		6				
A 9X93MSO040110		10				
A 9X93MSO050070	M5 x 0.8	6				1.6
A 9X93MSO050110		10				
A 9X93MSO050150		14				
A 9X93MSO050210		20				
A 9X93MSO060075	M6 x 1	6		1.6		
A 9X93MSO060115		10				
A 9X93MSO060175		16				
A 9X93MSO060265		25				

