

GEARLESS SPEED REDUCER  
 HIGH EFFICIENCY  
 LOW NOISE LEVEL  
 MAINTENANCE FREE  
 BUILT-IN OVERRUNNING CLUTCH OPTION  
 INFINITE RATIOS UP TO 5:1

PHONE: 516.328.3300 • FAX: 516.326.8827 • WWW.SDP-SI.COM



**> MATERIAL:**

- Housing** - Aluminum, Anodized
- Mounting Flanges** - Aluminum, Anodized
- Output Shaft** - 52100 Steel, Hardened
- Bearings** - Precision Angular Contact

**> OPERATING TEMPERATURE:**

+32°F to +180°F

**> FEATURES:**

- Standard NEMA sizes or Custom
- 84% reduction of motor torque ripple at output shaft
- No dynamic friction
- Smooth operation
- Long product life



**> SPECIFICATIONS:**

**Shaft Loading - Radial:** 50 lbs.  
**Axial:** 50 lbs.

**Min. Efficiency:** 75%  
**Backlash:** 15 arc min.

**Fig. 1:**  
 1-Way Direction with  
 Overrunning Clutch

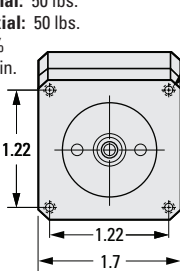

**Fig. 2:**  
 2-Way Direction

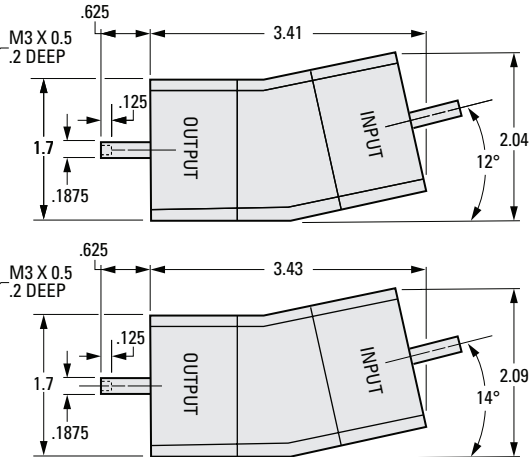
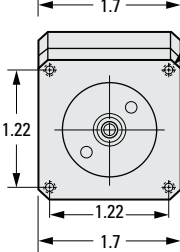

**INCH COMPONENT**

Catalog Number	Ratio	Max. Rated Input rpm	Torque lbf in.
<b>Fig. 1. - 1-Way Direction with Overrunning Clutch</b>			
S9117T-A002	2:1	3600	10-20
S9117T-A003	3:1		
S9117T-A004	4:1		
S9117T-A005	5:1		
<b>Fig. 2. - 2-Way Direction</b>			
S9117T-B002	2:1	3600	20-30
S9117T-B003	3:1		
S9117T-B004	4:1		
S9117T-B005	5:1		

**NOTE:** Other ratios available on special order.

- I
- R
- T
- 1
- 2
- 3
- 4
- 5
- 6
- 7
- 8
- 9
- 10
- NEW**
- 12
- 13
- 14
- 15
- 16