

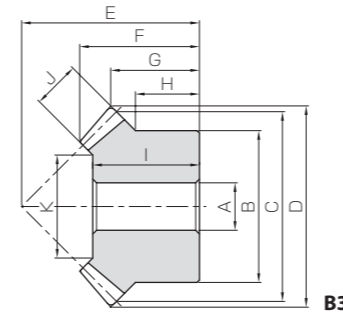

Specifications	
Precision grade	JIS B 1704: 1978 grade 3
Gear teeth	Gleason
Pressure angle	20°
Material	S45C
Heat treatment	—
Tooth hardness	(less than 194HB)
Surface treatment	Black oxide coating

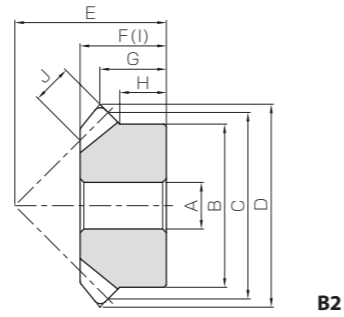

Catalog No.	Gear ratio	Module	No. of teeth	Shape	Bore	Hub dia.	Pitch dia.	Outside dia.	Mounting distance	Total length	Crown to back length	Hub width
					A _{H7}	B	C	D	E	F	G	H
KSM2-16	1	m2	16	B2	10	27	32	34.83	30	19	15.41	11.5
KSM2.5-16		m2.5	16	B2	12	34	40	43.53	35	21	16.77	12
KSM3-16		m3	16	B2	14	42	48	52.24	40	23	18.12	13
KSM4-16		m4	16	B2	16	55	64	69.66	50	28	20.83	13.5
KSM5-16		m5	16	B2	20	70	80	87.07	65	37	28.54	20
KSM1-20	1	m1	20	B3	6	16	20	21.41	20	13.94	10.71	8
KSM1.25-20		m1.25	20	B3	8	22	25	26.77	23	15.27	11.38	9
KSM1.5-20		m1.5	20	B3	8	26	30	32.12	30	21.24	16.06	13
KSM2-20		m2	20	B3	12	34	40	42.83	37	24.89	18.41	14
KSM2.5-20		m2.5	20	B3	14	42	50	53.54	48	32.54	24.77	19
KSM3-20	1	m3	20	B3	16	50	60	64.24	58	39.84	30.12	23
KSM3.5-20		m3.5	20	B3	20	60	70	74.95	65	44.13	32.47	25
KSM4-20		m4	20	B3	20	64	80	85.65	75	50.78	37.83	27
KSM5-20		m5	20	B3	25	80	100	107.07	90	60.38	43.54	30
KSM6-20		m6	20	B3	28	100	120	128.48	104	67.67	48.24	34
KSM8-20	m8	20	B3	30	130	160	171.31	125	73.33	50.66	30	
KSM1-25	1	m1	25	B3	6	20	25	26.41	23	15.16	11.21	8
KSM1.25-25		m1.25	25	B3	8	25	31.25	33.02	28	17.88	13.26	9.25
KSM1.5-25		m1.5	25	B3	10	30	37.5	39.62	34	22.25	16.31	11.5
KSM2-25		m2	25	B3	12	40	50	52.83	40	24.33	16.41	10
KSM2.5-25		m2.5	25	B3	16	50	62.5	66.04	50	30.41	20.52	12.5
KSM3-25	1	m3	25	B3	20	60	75	79.24	60	37.81	24.62	15
KSM3.5-25		m3.5	25	B3	25	70	87.5	92.45	70	43.23	28.72	17.5
KSM4-25		m4	25	B3	28	80	100	105.66	80	49.32	32.83	20
KSM5-25		m5	25	B3	28	100	125	132.07	100	60.82	41.04	25
KSM6-25		m6	25	B3	28	120	150	158.48	120	72.32	49.24	30
KSM1-30	1	m1	30	B3	8	24	30	31.41	28	17.71	13.71	10
KSM1.25-30		m1.25	30	B3	10	30	37.5	39.27	36	23.47	18.13	13.5
KSM1.5-30		m1.5	30	B3	10	36	45	47.12	43	28.24	21.56	16
KSM2-30		m2	30	B3	12	45	60	62.83	50	29.42	21.41	12.5
KSM2.5-30		m2.5	30	B3	16	60	75	78.54	62	36.28	26.27	17
KSM3-30	1	m3	30	B3	20	70	90	94.24	75	45.47	32.12	20
KSM3.5-30		m3.5	30	B3	25	90	105	109.95	85	49.66	34.97	25
KSM4-30		m4	30	B3	28	100	120	125.66	95	54.52	37.83	25
KSM5-30		m5	30	B3	28	130	150	157.07	120	68.56	48.54	35

Length of bore	Face width	Holding surface dia.	Allowable torque (N-m)		Allowable torque (kgf-m)		Backlash (mm)	Weight (kg)	Catalog No.
			Bending strength	Surface durability	Bending strength	Surface durability			
I	J	K							
19	7	—	3.84	0.33	0.39	0.034	0.06~0.16	0.076	KSM2-16
21	9	—	7.63	0.68	0.78	0.069	0.07~0.17	0.14	KSM2.5-16
23	11	—	13.3	1.21	1.36	0.12	0.08~0.18	0.22	KSM3-16
28	14	—	30.7	2.87	3.13	0.29	0.12~0.27	0.49	KSM4-16
37	17	—	58.9	5.62	6.00	0.57	0.14~0.34	1.03	KSM5-16
12	5	9.86	0.89	0.084	0.091	0.0086	0.03~0.13	0.019	KSM1-20
13	6	13.03	1.70	0.16	0.17	0.017	0.04~0.14	0.036	KSM1.25-20
19	8	15.37	3.12	0.30	0.32	0.031	0.05~0.15	0.074	KSM1.5-20
22	10	21.72	7.13	0.72	0.73	0.073	0.06~0.16	0.15	KSM2-20
29	12	28.06	13.6	1.41	1.39	0.14	0.07~0.17	0.30	KSM2.5-20
35	15	31.57	24.1	2.54	2.45	0.26	0.08~0.18	0.53	KSM3-20
40	18	39.09	38.8	4.15	3.96	0.42	0.10~0.25	0.82	KSM3.5-20
45	20	43.43	57.0	6.19	5.82	0.63	0.12~0.27	1.15	KSM4-20
54	26	54.46	114	12.6	11.6	1.29	0.14~0.34	2.15	KSM5-20
60	30	67.15	191	21.8	19.4	2.22	0.16~0.36	3.68	KSM6-20
62	35	95	413	49.6	42.1	5.06	0.20~0.45	7.05	KSM8-20
14	6	15.03	1.47	0.16	0.15	0.017	0.03~0.13	0.035	KSM1-25
16	7	18.7	2.75	0.31	0.28	0.032	0.04~0.14	0.063	KSM1.25-25
19	9	19.54	4.96	0.57	0.51	0.059	0.05~0.15	0.11	KSM1.5-25
20	12	26.06	11.8	1.41	1.20	0.14	0.06~0.16	0.22	KSM2-25
26	15	34.57	23.0	2.81	2.34	0.29	0.07~0.17	0.42	KSM2.5-25
32	20	37.43	42.1	5.24	4.29	0.53	0.08~0.18	0.74	KSM3-25
37	22	46.77	64.7	8.19	6.60	0.83	0.10~0.25	1.15	KSM3.5-25
43	25	55.29	96.3	12.4	9.82	1.26	0.12~0.27	1.73	KSM4-25
50	30	65.15	184	24.2	18.7	2.47	0.14~0.34	3.41	KSM5-25
61	35	83	309	42.1	31.5	4.29	0.16~0.36	6.03	KSM6-25
16	6	19.03	1.99	0.26	0.20	0.026	0.03~0.13	0.057	KSM1-30
21	8	22.37	4.05	0.54	0.41	0.055	0.04~0.14	0.12	KSM1.25-30
25	10	25.71	7.19	0.97	0.73	0.099	0.05~0.15	0.21	KSM1.5-30
25	12	36.06	15.9	2.22	1.62	0.23	0.06~0.16	0.37	KSM2-30
32	15	47.57	31.1	4.43	3.17	0.45	0.07~0.17	0.76	KSM2.5-30
40	20	53.43	57.5	8.33	5.87	0.85	0.08~0.18	1.32	KSM3-30
45	22	67.77	88.0	13.0	8.97	1.32	0.10~0.25	2.20	KSM3.5-30
50	25	79.29	131	19.6	13.3	2.00	0.12~0.27	3.09	KSM4-30
62	30	99.15	249	38.3	25.4	3.91	0.14~0.34	6.47	KSM5-30

[Caution on Product Characteristics] ① The allowable torques shown in the table are the calculated values according to the assumed usage conditions. Please see page 272 for more details.
② Dimensions of the outside diameter, the overall length and crown to back length are all theoretical values, and some differences will occur due to the corner chamfering of the gear tips.

[Caution on Secondary Operations] ① Please read "Caution on Performing Secondary Operations" (Page 274) when performing modifications and/or secondary operations for safety concerns.