

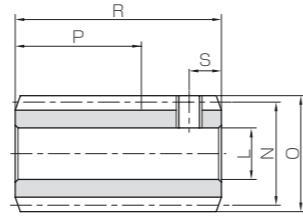

Specifications	
Precision grade	KHK W 001 grade 4 *
Reference section of gear	Normal plane
Gear teeth	Standard full depth
Normal pressure angle	20°
Material	SUS303
Heat treatment	—
Tooth hardness	(less than 187HB)

* The precision grade of J Series products is equivalent to the value shown in the table.



W2

Catalog No.	Norma module	Number of starts	Lead angle	Hand thread	Shape	Bore		Pitch dia.	Outside dia.	Face width	Hub width	Total length
						LH7(H8)	M					
KSUW1-R1 KSUW1-R2	m1	1	3°35'	R	W2	6 H8	—	16	18	(20)	—	32
		2	7°11'	R	W2	6 H8	—	16	18	(20)	—	32
KSUW1.5-R1 KSUW1.5-R1J8 KSUW1.5-R1J10	m1.5	1	3°26'	R	W1	8	—	25	28	30	10	40
W1T					8	20	25	28	30	10	40	
W1K					10	—	—	—	—	—	—	—
KSUW1.5-R2 KSUW1.5-R2J8 KSUW1.5-R2J10	m1.5	2	6°54'	R	W1	8	—	25	28	30	10	40
W1T					8	20	25	28	30	10	40	
W1K					10	—	—	—	—	—	—	—

- [Caution on Product Characteristics] ① For W2-shaped products, a set screw is included. When setting up the mating wheel, make sure no friction occurs within the set screw.
② These worms produce axial thrust forces. See Page 362 for more details.

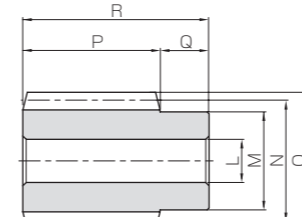

W1

J Series

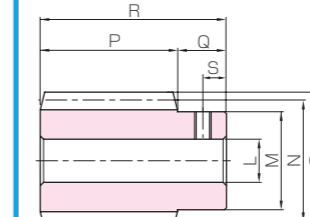

W1T

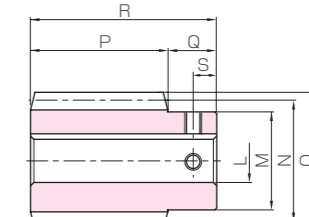

W1K



Keyway	Set Screw		Weight (kg)	Catalog No.
	Size	S		
—	M4	5	0.042	KSUW1-R1 KSUW1-R2
—	M4	5	0.042	KSUW1-R1 KSUW1-R2
—	—	—	0.12	KSUW1.5-R1 KSUW1.5-R1J8 KSUW1.5-R1J10
4 x 1.8	M5	5	0.12	KSUW1.5-R1 KSUW1.5-R1J8 KSUW1.5-R1J10
—	M4	5	0.11	KSUW1.5-R1 KSUW1.5-R1J8 KSUW1.5-R1J10
—	—	—	0.12	KSUW1.5-R2 KSUW1.5-R2J8 KSUW1.5-R2J10
4 x 1.8	M5	5	0.12	KSUW1.5-R2 KSUW1.5-R2J8 KSUW1.5-R2J10
—	M4	5	0.11	KSUW1.5-R2 KSUW1.5-R2J8 KSUW1.5-R2J10

[Caution on J series]

- ① As available-on-request products, requires a lead-time for shipping within 2 working-days (excludes the day ordered), after placing an order. Please allow additional shipping time to get to your local distributor.
② Number of products we can process for one order is 1 to 20 units. For quantities of 21 or more pieces, we need to quote price and lead time.
③ Keyways are made according to JIS B1301 standards, Js9 tolerance.
④ For products having a tapped hole, a set screw is included.



Specifications	
Precision grade	KHK W 002 grade 5 *
Reference section of gear	Normal plane
Gear teeth	Standard full depth
Normal pressure angle	20°
Material	MC901 Nylon
Heat treatment	—
Tooth hardness	—

* The precision grade of this product is equivalent to the value shown in the table.

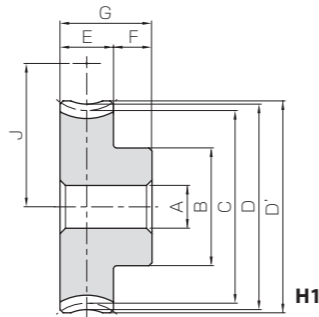

H1

Catalog No.	Reduction ratio	No. of teeth	Number of starts	Helix angle	Hand thread	Shape	Bore		Pitch dia.	Throat dia.	Outside dia.	Face width	Hub width	Total length	Mounting distance	Allowable torque (N·m)	Allowable torque (kgf·m)	Backlash (mm)	Weight (kg)
							A	B											
KPG1-20R1	20	20	1	3°35'	R	H1	6	16	20.04	22	23	—	—	—	18	0.62	0.060	0~0.28	0.0058
KPG1-20R2	10	20	2	7°11'	R	H1	6	16	20.16	22	23	—	—	—	18	0.62	0.060	0~0.28	0.0058
KPG1-30R1	30	30	1	3°35'	R	H1	6	20	30.06	32	33	10	10	20	23	1.03	0.10	0~0.28	0.012
KPG1-40R1	40	40	1	3°35'	R	H1	8	26	40.08	42	43	—	—	—	28	1.49	0.15	0~0.28	0.021
KPG1-50R1	50	50	1	3°35'	R	H1	8	30	50.1	52	53	—	—	—	33	1.96	0.20	0~0.28	0.031
KPG1.5-20R1	20	20	1	3°26'	R	H1	8	22	30.05	33	34.5	12	10	22	27.5	1.66	0.17	0~0.30	0.014
KPG1.5-20R2	10	20	2	6°54'	R	H1	8	22	30.22	33	34.5	—	—	—	27.5	1.68	0.17	0~0.30	0.014

- [Caution on Product Characteristics] ① Worm Wheels are profile shifted to create the proper center distance.
② Significant variations in temperature or humidity can cause dimensional changes in plastic gears (MC Nylon gears), for bore size (H8 when produced), tooth diameter, and backlash. Please see the section "Design of Plastic Gears" in separate technical reference book (Page 101).
③ The allowable torques shown in the table are the calculated values according to the assumed usage conditions. Please see Page 358 for more details.
- [Caution on Secondary Operations] ① Please read "Caution on Performing Secondary Operations" (Page 362) when performing modifications and/or secondary operations for safety concerns.
② Plastic gears are susceptible to the effects of temperature and moisture. Dimensional changes may occur while performing secondary operations and during post-machining operations.

J Series

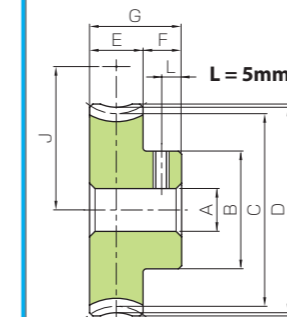

H1T

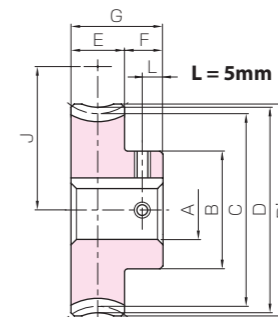

H1K



Bore	* The product shapes of J Series items are identified by background color.							
Keyway Js9	6	8	10	12	14	15	16	17
Screw size	—			4 x 1.8		5 x 2.3		
Catalog No.	M4	M5	M4			M4		
KPG1-20R1 J BORE	H1T							
KPG1-20R2 J BORE	H1T							
KPG1-30R1 J BORE	H1T	H1T						
KPG1-40R1 J BORE		H1T	H1K	H1K				
KPG1-50R1 J BORE		H1T	H1K	H1K	H1K	H1K	H1K	H1K
KPG1.5-20R1 J BORE		H1T	H1K					
KPG1.5-20R2 J BORE		H1T	H1K					

- [Caution on J series] ① As available-on-request products, requires a lead-time for shipping within 2 working-days (excludes the day ordered), after placing an order. Please allow additional shipping time to get to your local distributor.
② Number of products we can process for one order is 1 to 20 units. For quantities of 21 or more pieces, we need to quote price and lead time.
③ Keyways are made according to JIS B1301 standards, Js9 tolerance.
④ Certain products which would otherwise have a very long tapped hole are counterbored to reduce the length of the tap.
⑤ For products having a tapped hole, a set screw is included.
⑥ When using H1T set screws for fastening gears to a shaft, only use this method for applications with light loads. For secure fastening, please use dowel pins in combination.

To order J Series products, please specify: Catalog No. + J + BORE

* In regards to MC Nylon gears, other materials are available, including Ultra High Molecular Weight Polyethylene (UHMW-PE), which has excellent abrasion resistance, and resin conforming to the Plastic Implementation Measure (PIM).